

NO.	REVISION	BY	CH	SUP	APPROVED	DATE

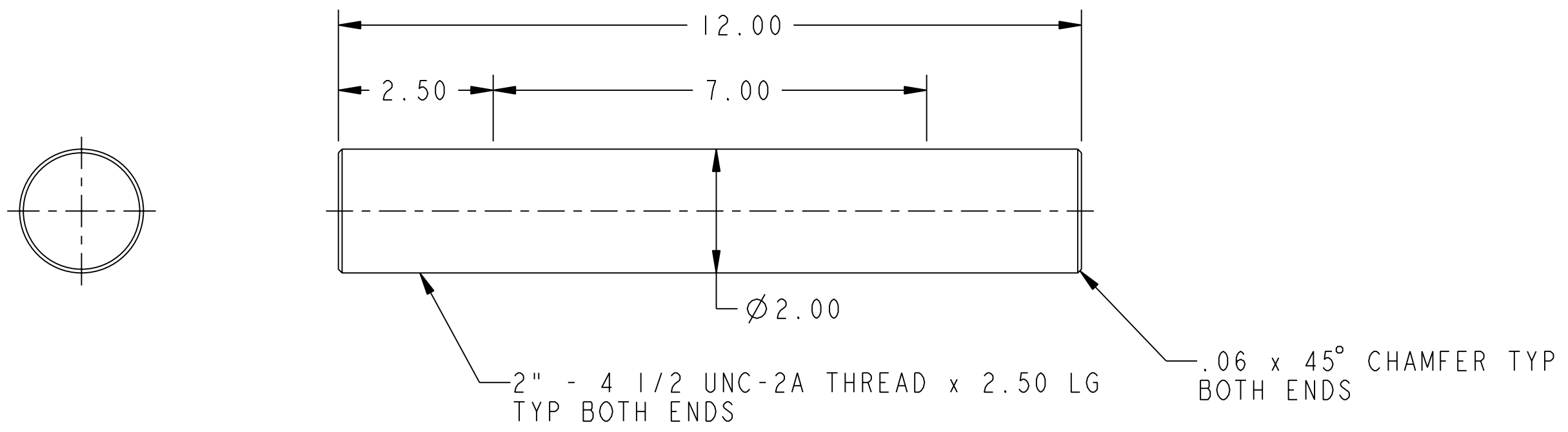

1 STUD

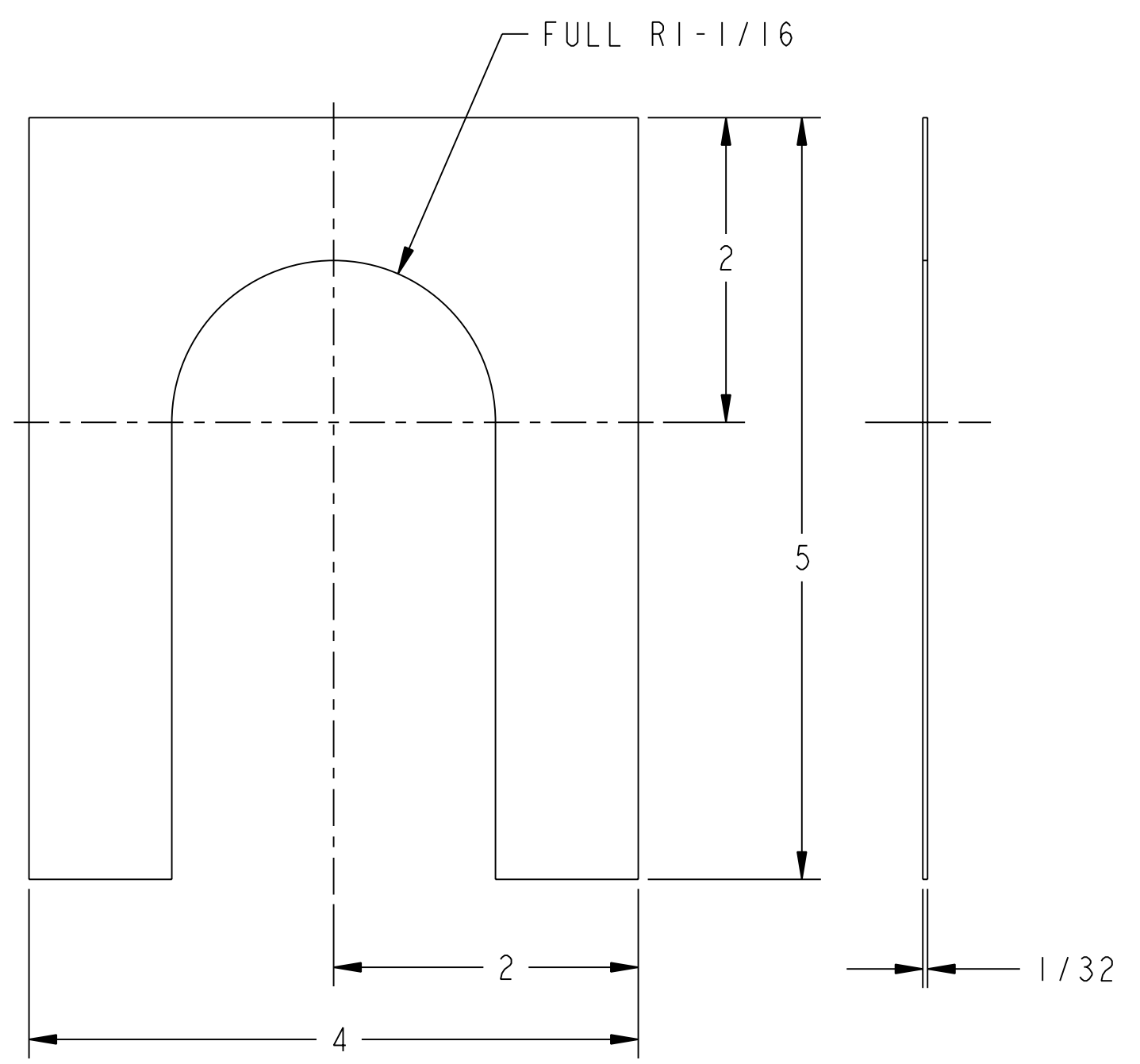

2 SHIM

**RELEASED FOR  
FABRICATION / INSTALLATION**

**PPPL Drafting:**

2	SC185-119-2	SHIM	ASTM A36	16
1	SC185-119-1	STUD - 2"-4 1/2UNC-2A x 12" LG	ASTM A36	8
ITEM NO.	DRAWING NO	NOMENCLATURE OR DESCRIPTION	MATERIAL	QTY REQD

PARTS LIST

COMPUTER GENERATED DRAWING MANUAL CHANGES NOT PERMITTED	CENTRAL FILES:		PRINCETON PLASMA PHYSICS LABORATORY PRINCETON UNIVERSITY <b>NATIONAL COMPACT STELLARATOR EXPERIMENT</b> FIELD PERIOD ASSEMBLY MCWF ASSEMBLY FIXTURE MISCELLANEOUS DETAILS		
	UNLESS OTHERWISE SPECIFIED				
Pro E	DIMENSIONS ARE IN INCHES MACHINE SURFACES $\sqrt{}$		DIV: MECH. ENG. DATE: 10-3-06		
DO NOT VERIFY INFORMATION BY SCALING DRAWING	BREAK SHARP EDGES .005/.020		APPROVED T. BROWN		
	TOLERANCES NON-CUMULATIVE		SC185-119		
NEXT ASSEMBLY	DECIMAL - INCH	FRACTIONS	ENG: T. BROWN	CHK: M. COLE	
	.X   .100	0"-12"   1/16	DSN: L. MORRIS	CHK MC	SUPV JS
	.XX   .030	12"-72"   1/8			
	.XXX   .005	72"-120"   1/4			
	ANGULAR   0°-15'	OVER 120"   1/2			

**RELEASE LEVEL: FABRICATION**  
**DWG VERSION NO: 3**

WELDING ENGINEER  
APPVD: \_\_\_\_\_ DATE \_\_\_\_\_