

5 MANPORT FLANGE TO BE MARKED USING STRAP, F/N 3, AS TEMPLATE AND DRILLED AND TAPPED FOR BOLTS. (OPTION TO USE WELD STUDS, F/N 6, AND NUTS IN PLACE OF BOLTS)

REF MODULAR COIL WALL

FILLER PLATE CLIPS TO BE FORMED AND TACK WELDED AFTER SEAL INSTALLATION

FLANGE COVER OR MANPORT (NOT SHOWN) MAY BE INSTALLED WITH SEAL IN PLACE.

REF VVSA MANPORT FLANGE

SECTION A-A
SCALE .50

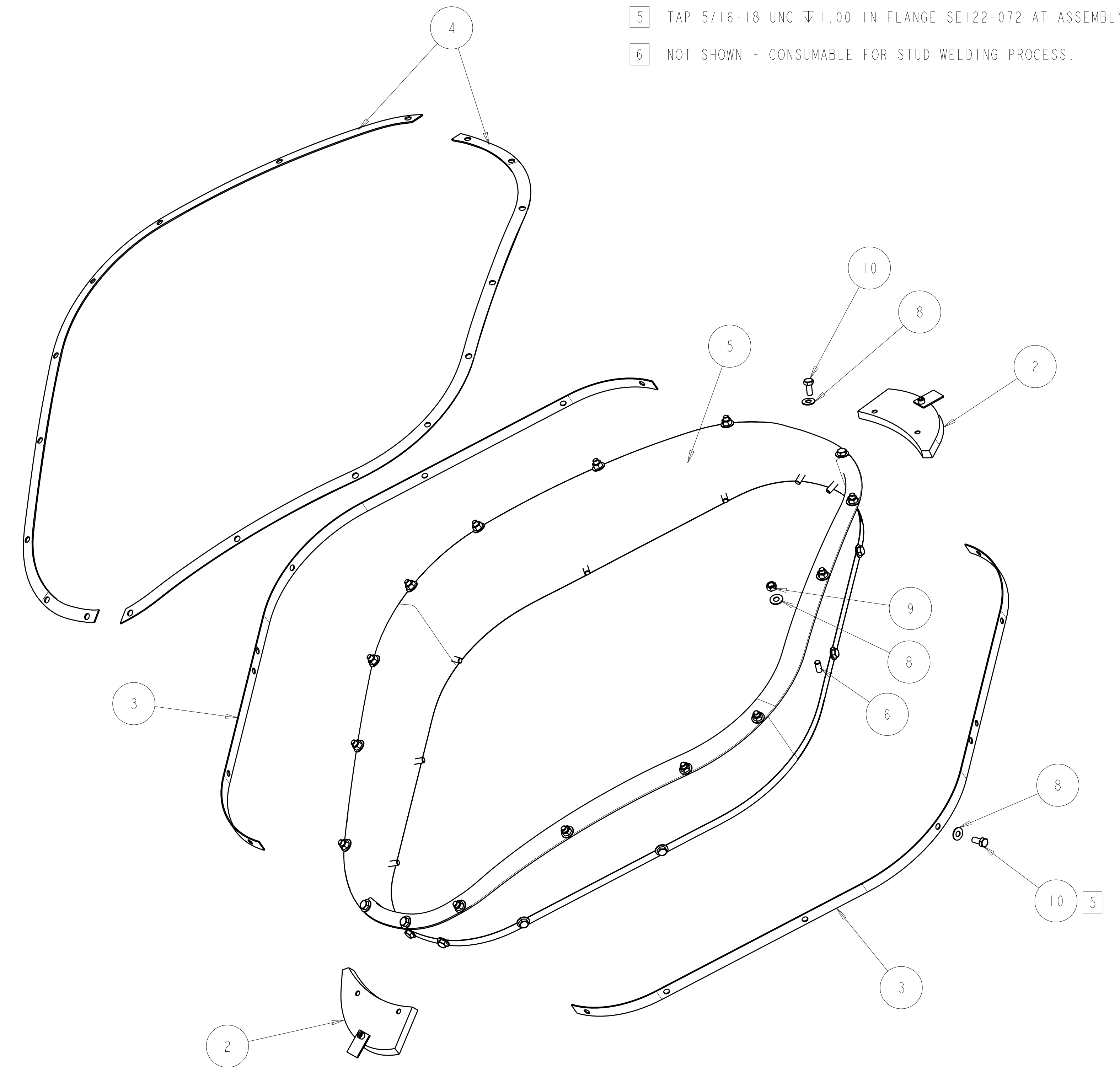
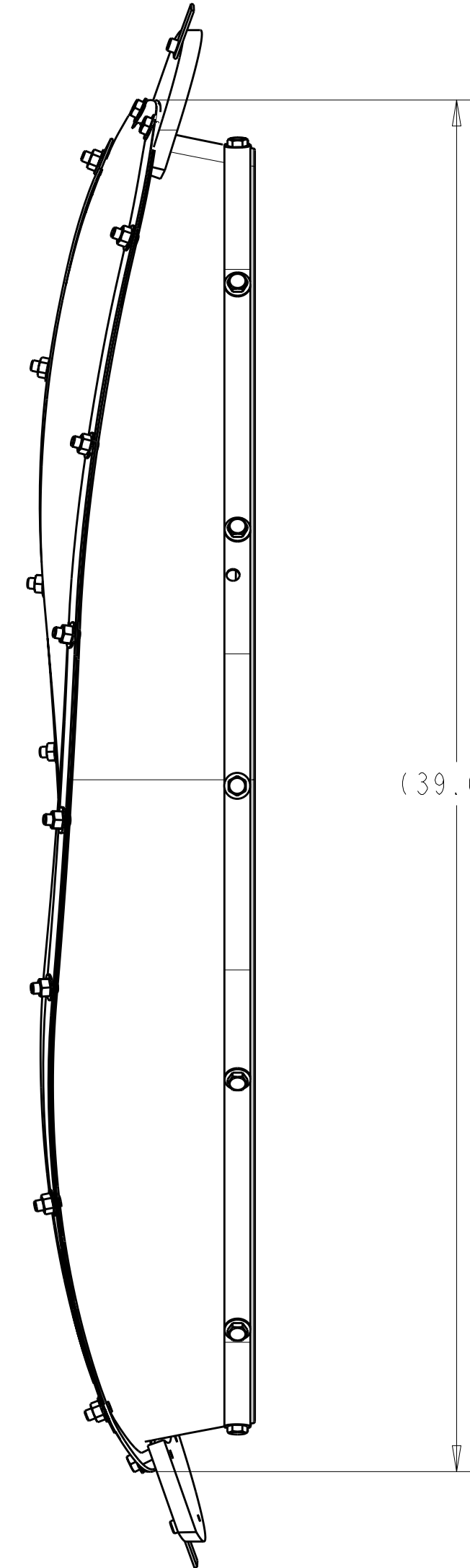
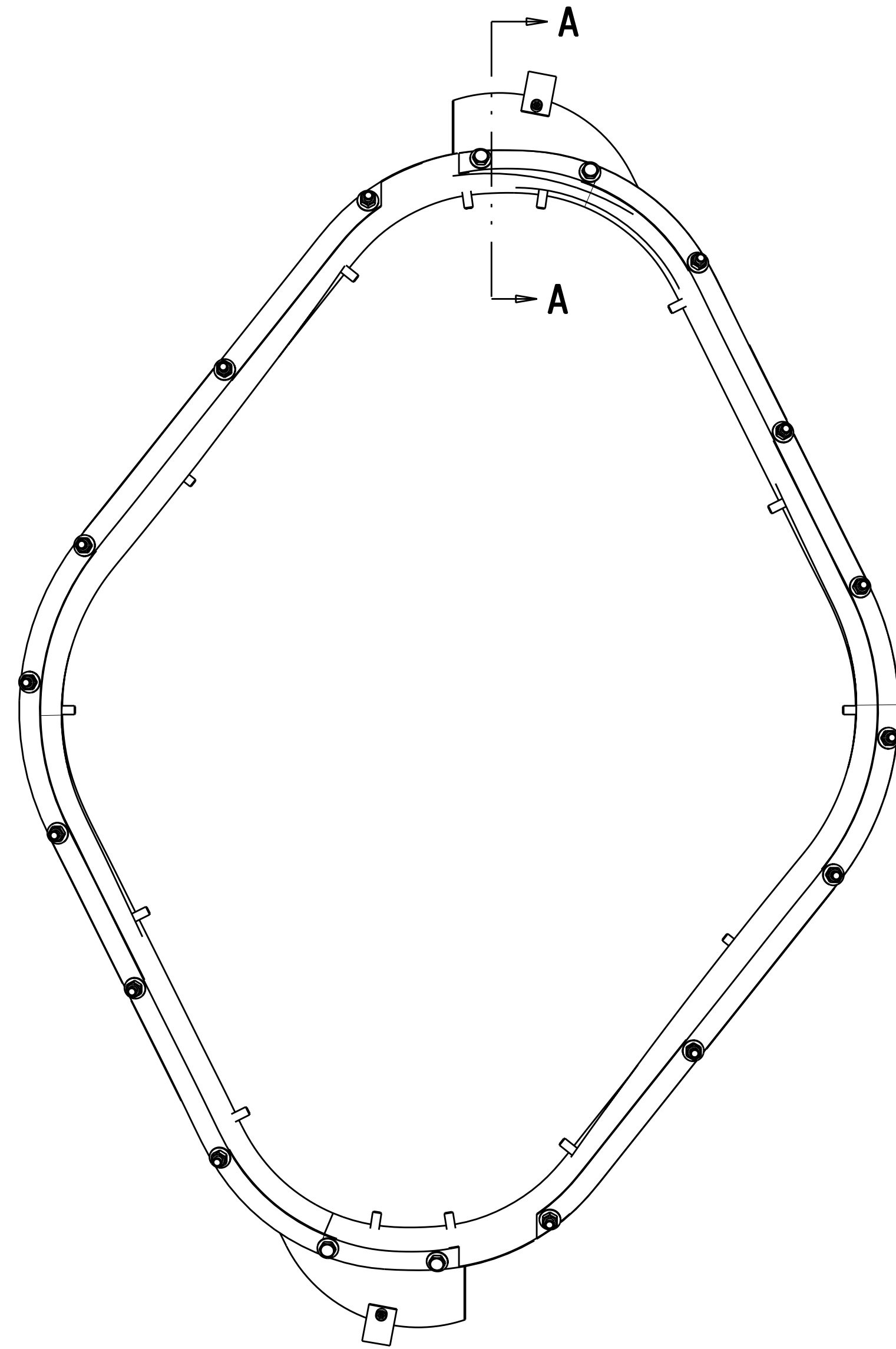

EXPLODED ISOMETRIC VIEW

**RELEASED FOR
FABRICATION / INSTALLATION**
PPPL Drafting:

LABEL PART NUMBER AND REVISION USING PERMANENT INK

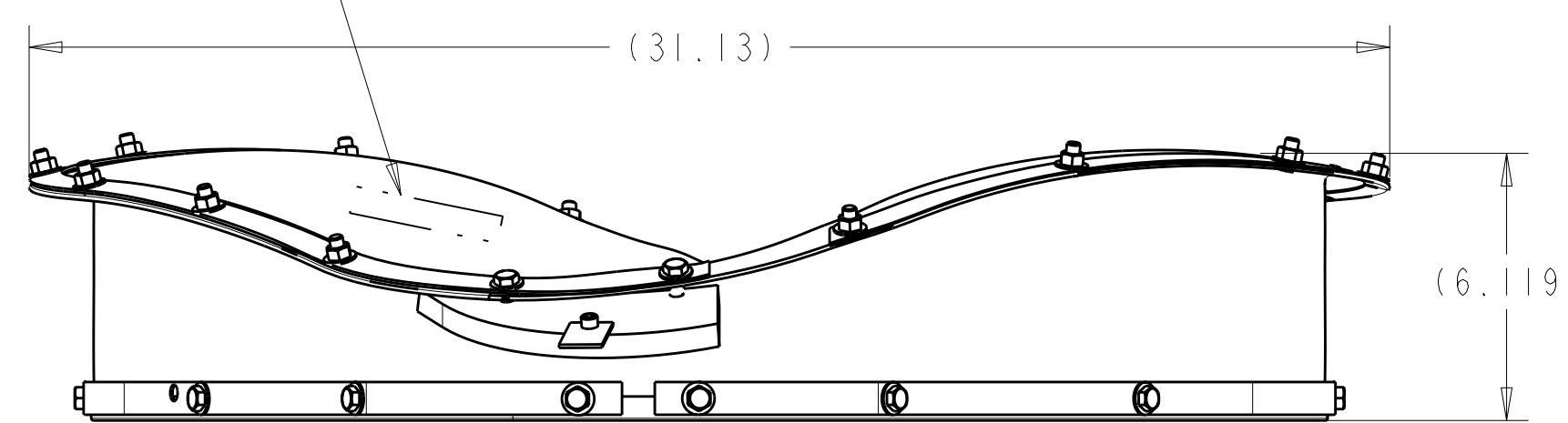

-1 NEUTRAL BEAM PORT SEAL ASSEMBLY 4

SCALE .25

REV	DESCRIPTION	BY	DATE	CHK	DEPT	DATE	PE	REQ	DATE	ORNL	DOE	DATE
0	ORIGINAL ISSUE	MTR	01/07	SP		01/07						
1												
2												
3												
4												
5												
6												
7												
8												
9												
10												

QTY	CAGE CODE	PART OR IDENTIFYING NO	NOMENCLATURE OR DESCRIPTION	MATERIAL	SPECIFICATION	FIND NO
18	93190A581	5/16-18 UNC X .75 LG HEX BOLT	316 SST			10
14	90545A030	5/16-18 UNC HEX NUT	TITANIUM			9
32	93490A017	5/16 ID X .75 OD FLAT WASHER	BRONZE			8
14	009-689	5/16 FERRULE	CERAMIC			7
14	006-932	5/16-18 UNC X .75 CD WELD STUD	SST			6
1	SE122-396-1	NEUTRAL BEAM SEAL BOOT				5
2	SE122-395-1	NEUTRAL BEAM PORT BOOT RETAINER STRAP AT WINDING FORM				4
2	SE122-394-1	NEUTRAL BEAM PORT BOOT RETAINER STRAP AT MAN PORT				3
2	SE122-356-1	NEUTRAL BEAM PORT BOOT FILL PLATE ASSY				2
AR		-1	NEUTRAL BEAM PORT SEAL ASSEMBLY			1

PARTS LIST

NO REPRESENTATION OR WARRANTY, EXPRESSED OR IMPLIED, IS MADE AS TO THE ACCURACY, COMPLETENESS OR USEFULNESS OF THE INFORMATION OR STATEMENTS CONTAINED IN THESE DRAWINGS, OR THAT THE USE OR DISCLOSURE OF ANY INFORMATION, APPARATUS, METHOD OR PROCESS DISCLOSED IN THESE DRAWINGS MAY NOT INFRINGE PRIVATE RIGHTS OF OTHERS. NO LIABILITY IS ASSUMED WITH RESPECT TO THE USE OF, OR FOR DAMAGES RESULTING FROM THE USE OF, ANY INFORMATION, APPARATUS, METHOD OR PROCESS DISCLOSED IN THESE DRAWINGS. DRAWINGS MADE AVAILABLE FOR INFORMATION TO BIDDER ARE NOT TO BE USED FOR OTHER PURPOSES, AND ARE TO BE RETURNED UPON REQUEST OF THE FORWARDING CONTRACTOR.

P THIS DRAWING PRODUCED ON PRO-ENGINEER

SCALE NOTED

DES PL GORANSON 01/07
DRW MT BROWN 01/07
CHK S PARSON 01/07

FRACTIONS :
XX DECIMALS ±.01
XXX DECIMALS ±.005
ANGLES ±0°15'
BREAK SHARP EDGES OR MAX
FINISH .125 UNLESS OTHERWISE SPECIFIED

PPPL DRFT J SIEGEL 01/07

VERSION NO. 12
PLANT ORNL
BLDG 5700
FL 3
SHT 1
OF 1
TYPE A
CLASS U

RELEASE LEVEL Fabrication

SE122-392

REV 0

Oak Ridge National Laboratory managed for the DEPARTMENT OF ENERGY under U.S. GOVERNMENT contract DE-AC05-00OR22725 UT-BATTELLE, LLC. Oak Ridge, Tennessee
PROJECT NAME
NATIONAL COMPACT STELLARATOR EXPERIMENT

NEUTRAL BEAM PORT INSULATION SEAL ASSEMBLY

SE122-392

REV 0