

- NOTES
1. DRAWING PREPARED IN ACCORDANCE WITH ASME Y14.100-2004.
 2. INTERPRET DIMENSIONS AND TOLERANCES PER ASME Y14.5M-1994.
 3. DIMENSIONS ARE IN INCHES

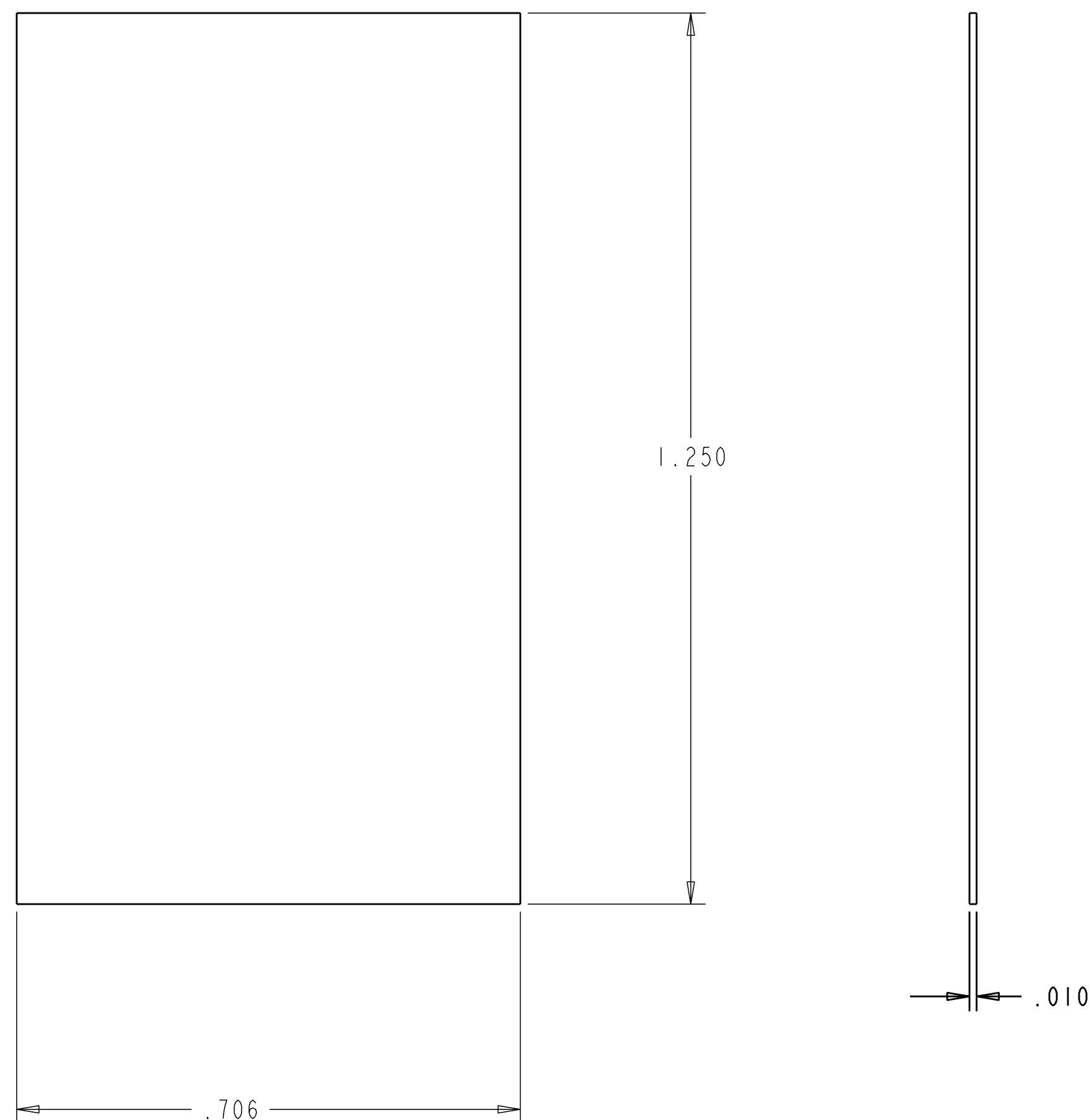

FLAT PATTERN

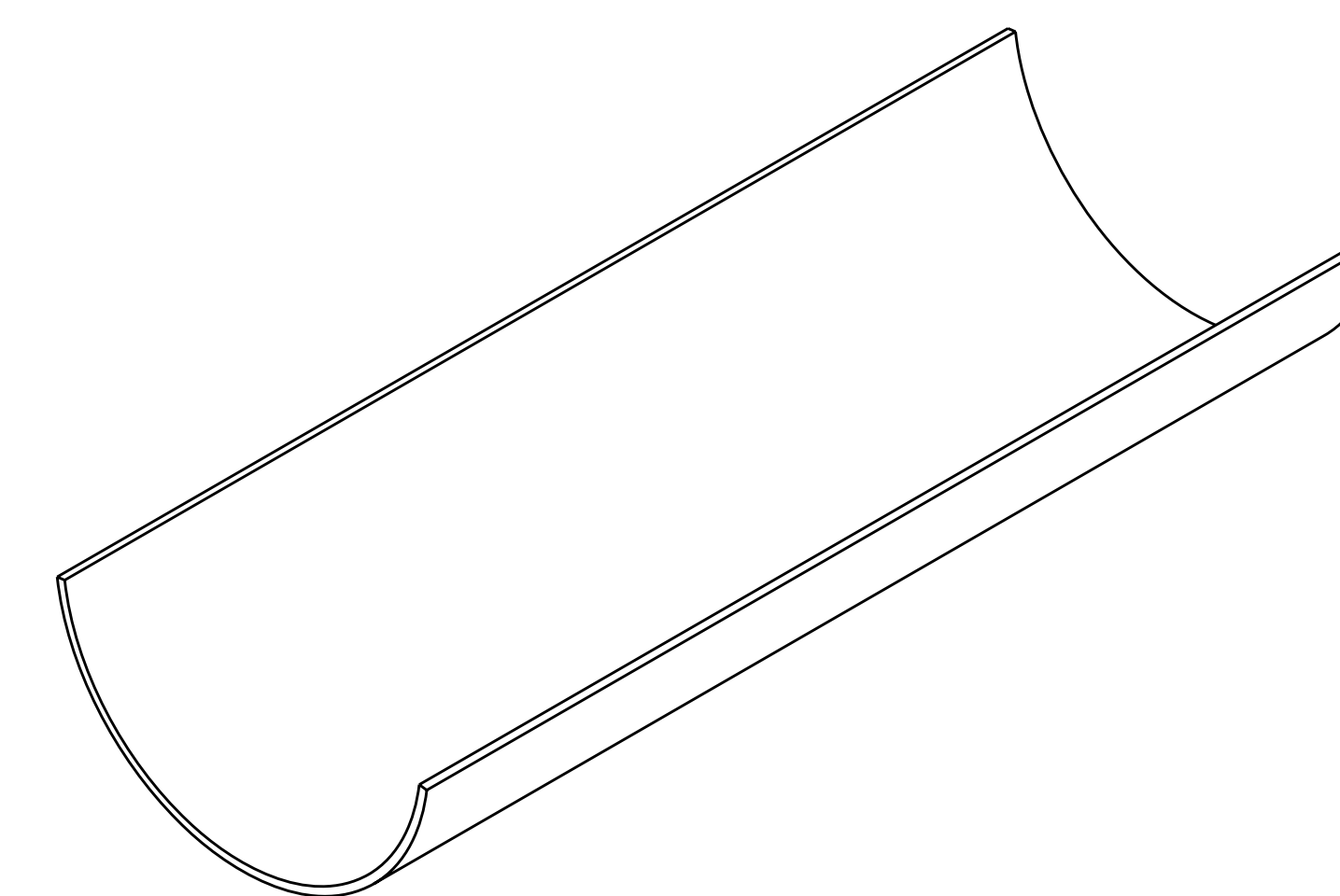

ISOMETRIC VIEW
REFERENCE TO BE ROLLED AT ASSEMBLY

**RELEASED FOR
FABRICATION / INSTALLATION**
PPPL Drafting:

-1 HOSE GASKET
SCALE 6.000

AR	X	-1	HOSE GASKET	TYPE TG401	UCAR CARBON COMPANY, INC COLUMBIA, TN 38402 931-380-4360 WWW.UCAR.COM	I
SE123-008	CAGE CODE	PART OR IDENTIFYING NO	NOMENCLATURE OR DESCRIPTION	MATERIAL	SPECIFICATION	FIND NO
		NEXT ASSEMBLY	PARTS LIST			

NO REPRESENTATION OR WARRANTY, EXPRESSED OR IMPLIED, IS MADE AS TO THE ACCURACY, COMPLETENESS OR USEFULNESS OF THE INFORMATION OR STATEMENTS CONTAINED IN THESE DRAWINGS, OR THAT THE USE OR DISCLOSURE OF ANY INFORMATION, APPARATUS, METHOD OR PROCESS DISCLOSED IN THESE DRAWINGS MAY NOT INFRINGE PRIVATE RIGHTS OF OTHERS. NO LIABILITY IS ASSUMED WITH RESPECT TO THE USE OF, OR FOR DAMAGES RESULTING FROM THE USE OF, ANY INFORMATION, APPARATUS, METHOD OR PROCESS DISCLOSED IN THESE DRAWINGS. DRAWINGS MADE AVAILABLE FOR INFORMATION TO BIDDER ARE NOT TO BE USED FOR OTHER PURPOSES, AND ARE TO BE RETURNED UPON REQUEST OF THE FORWARDING CONTRACTOR.

P THIS DRAWING PRODUCED ON PRO-ENGINEER

SCALE NOTED		DES P GORANSON 3-22-06	Oak Ridge National Laboratory managed for the DEPARTMENT OF ENERGY under U.S. GOVERNMENT contract DE-AC05-00OR22725 UT-BATTELLE, LLC. Oak Ridge, Tennessee			
TOLERANCES UNLESS OTHERWISE SPECIFIED		DRW G MCGINNIS 3-22-06	PROJECT NAME			
FRACTIONS		CHK P GORANSON 05/06	NATIONAL COMPACT STELLARATOR EXPERIMENT			
XX DECIMALS ±.01		SECT :	VACUUM VESSEL HEATING/COOLING HOSE GASKET			
XXX DECIMALS ±.005		DEPT :	DETAIL			
ANGLES ±0°15'		PE :	VERSION NO.			
BREAK SHARP EDGES OR MAX FINISH .125 UNLESS OTHERWISE SPECIFIED		CR :	0+			
		PJ :	PLANT ORNL			
		RD :	BLDG 5700			
		REV :	FL 3			
		PPPL DRFT J. SIEGEL 05/06	SHT 1			
			OF 1			
			TYPE I			
			CLASS U			
			RELEASE LEVEL			
			Fabrication			
			SE123-059			
			REV 0			