

NO.	REVISION	BY	CH	SUP	APPROVED	DATE

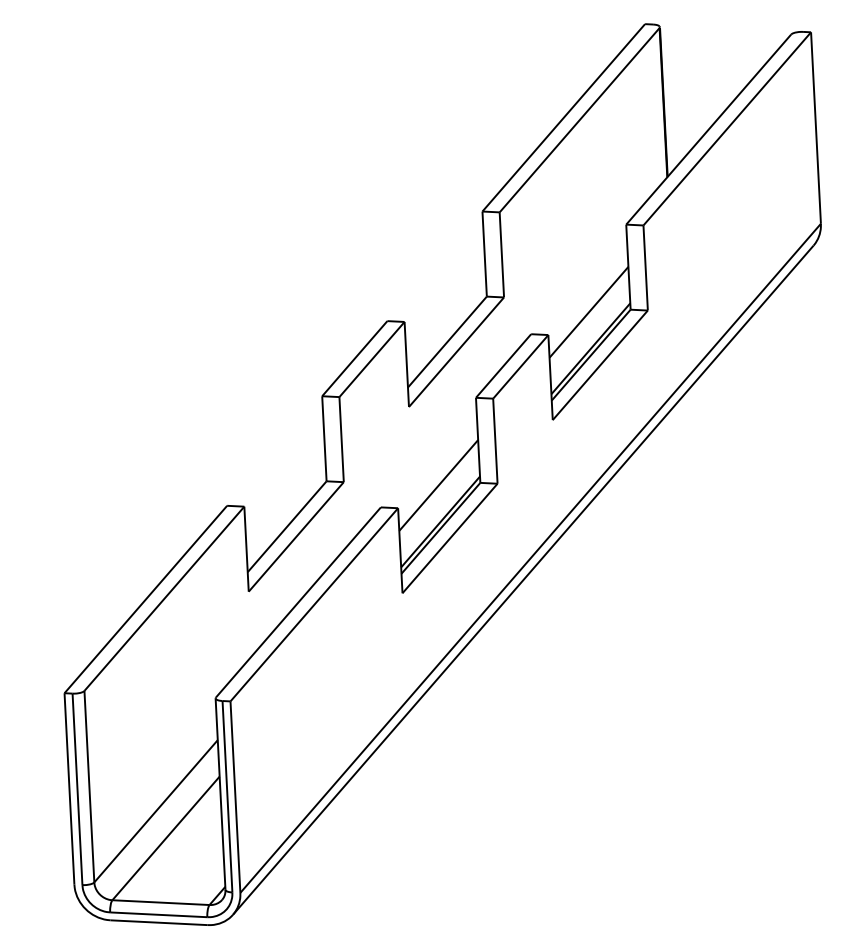

1

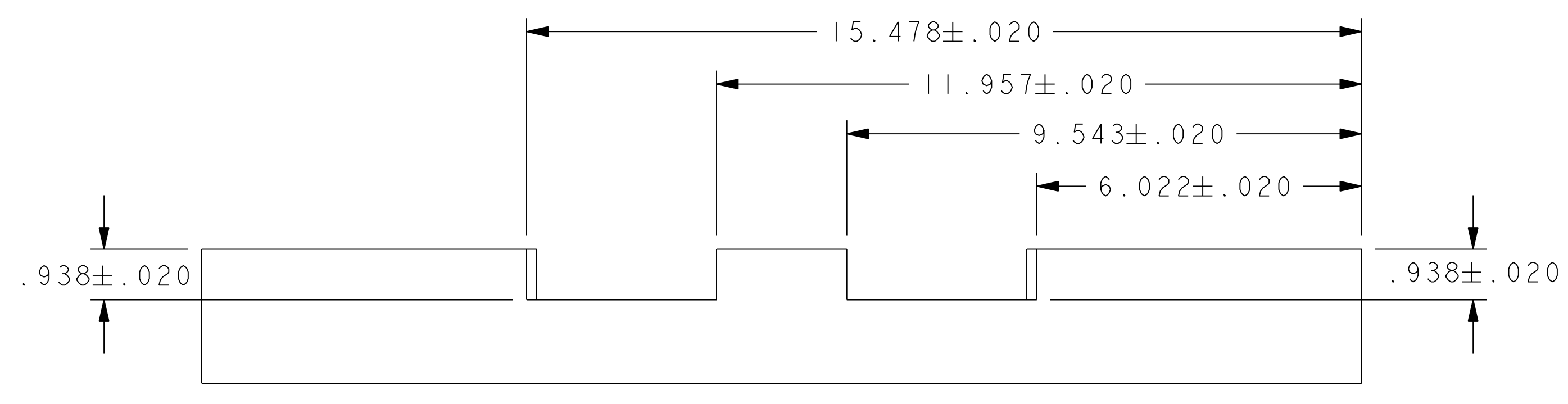
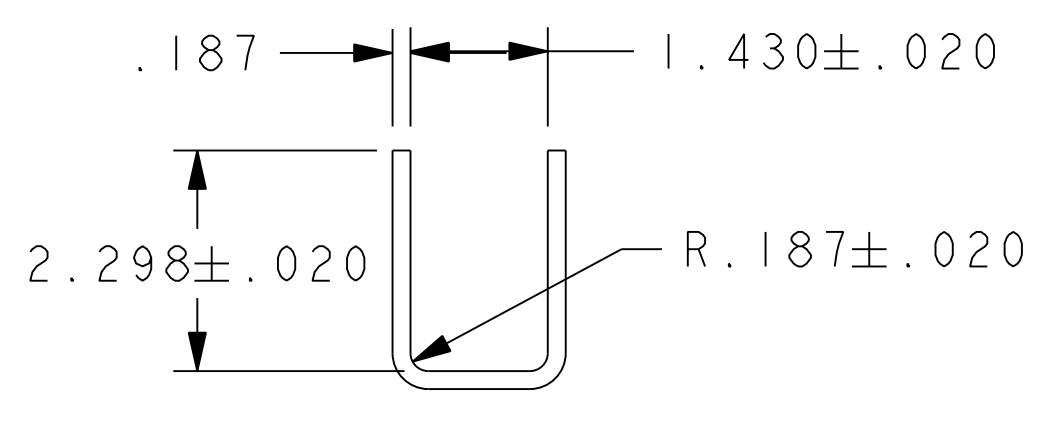
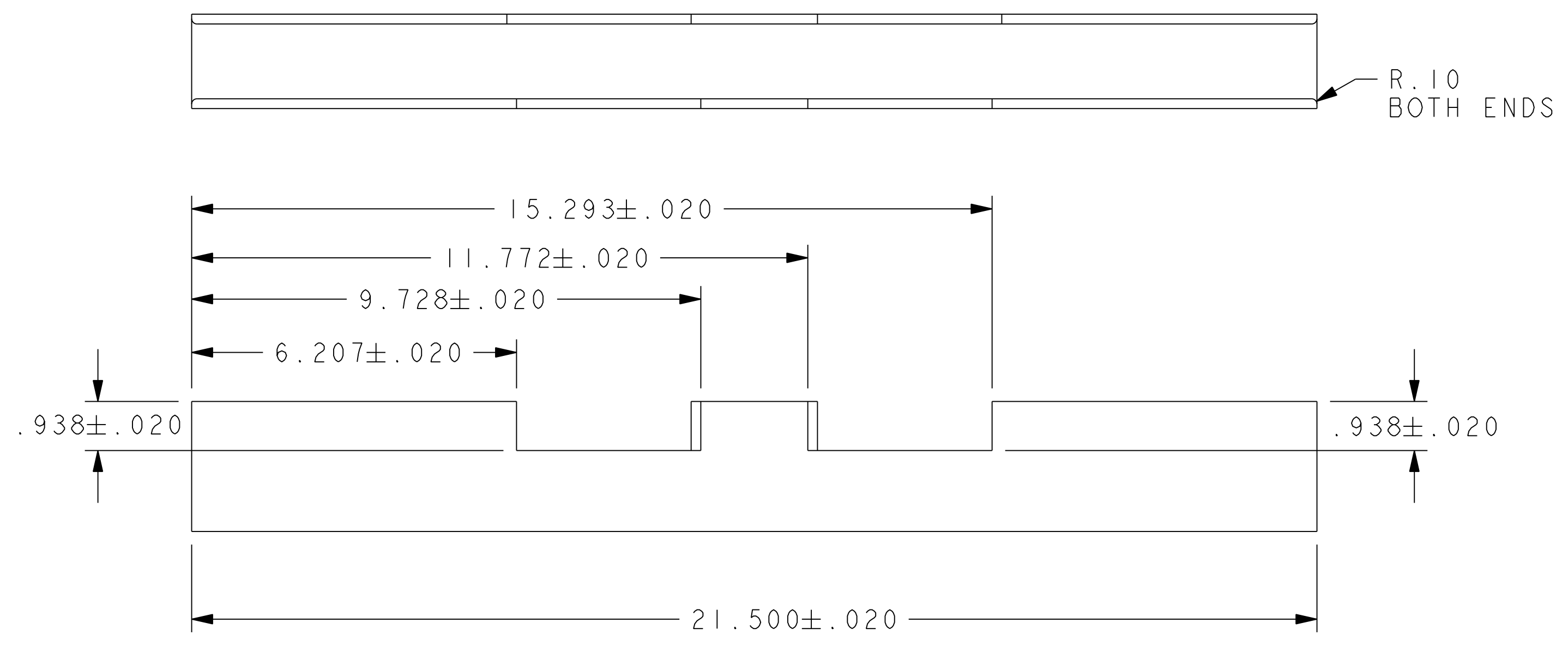
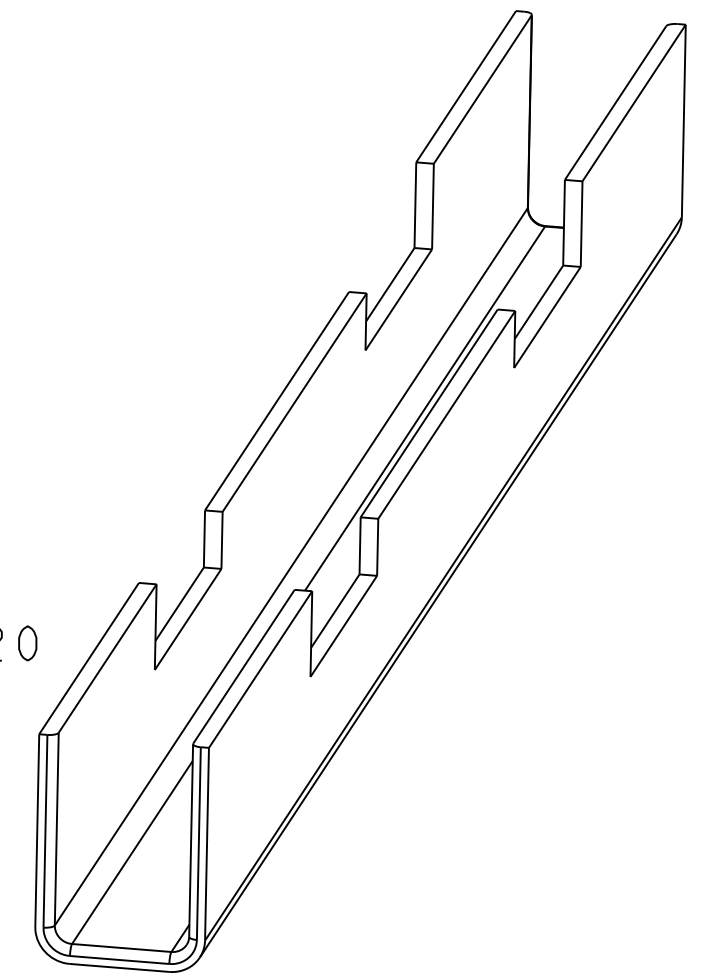
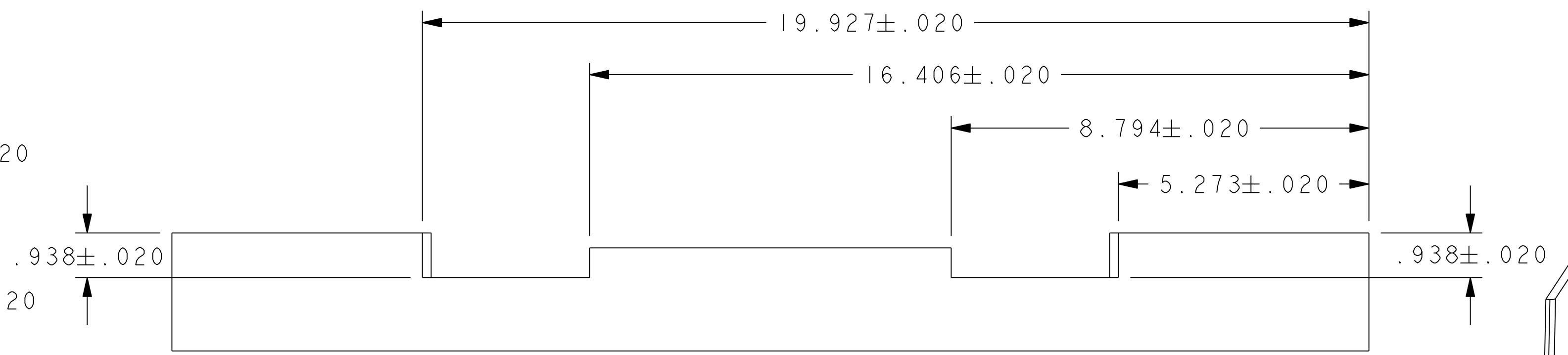
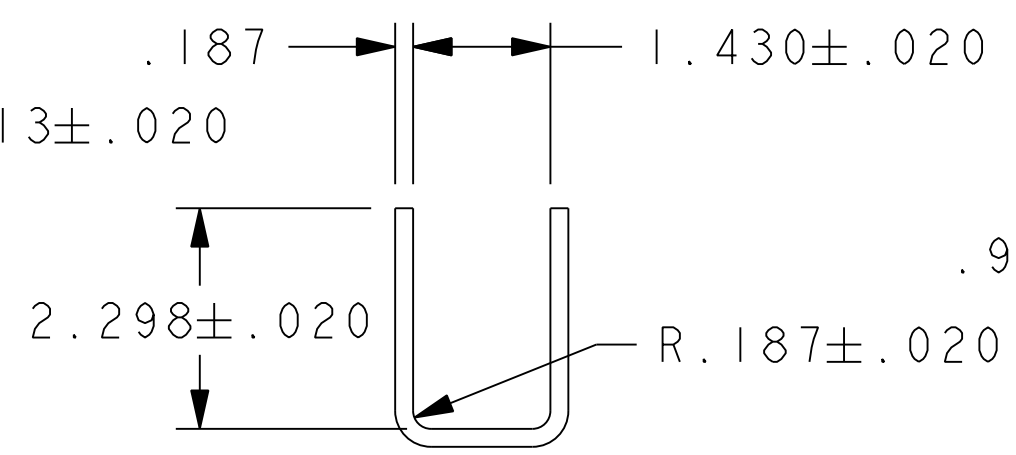
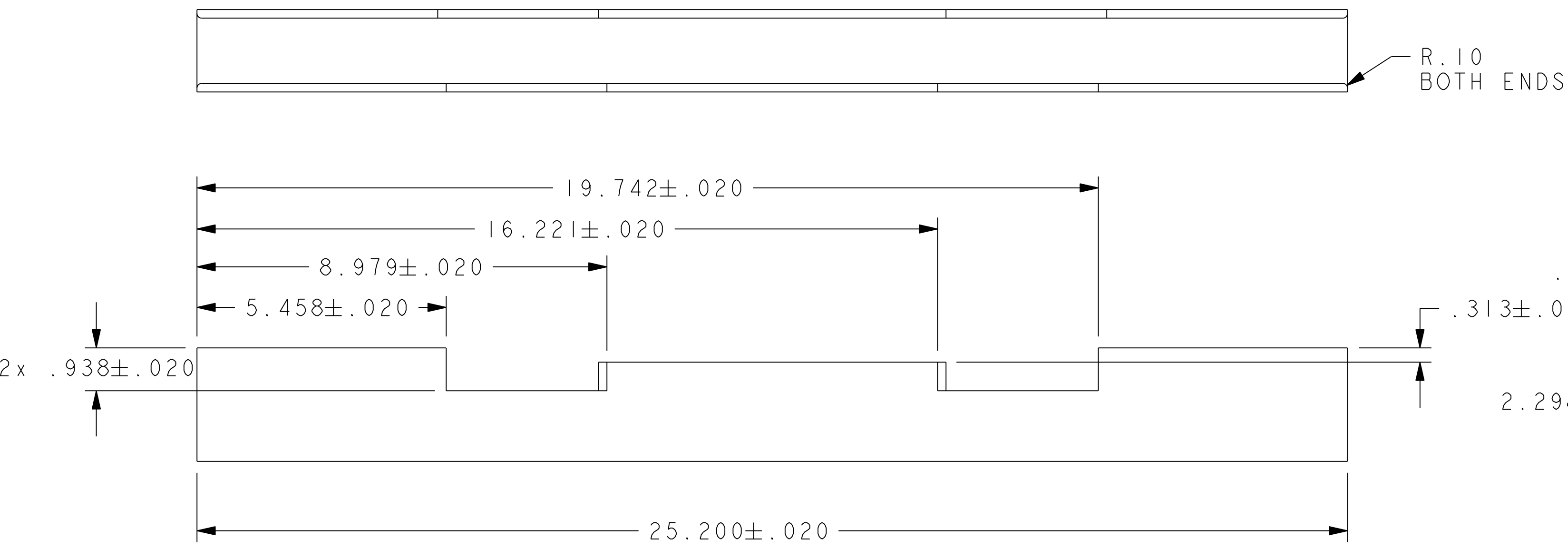

2

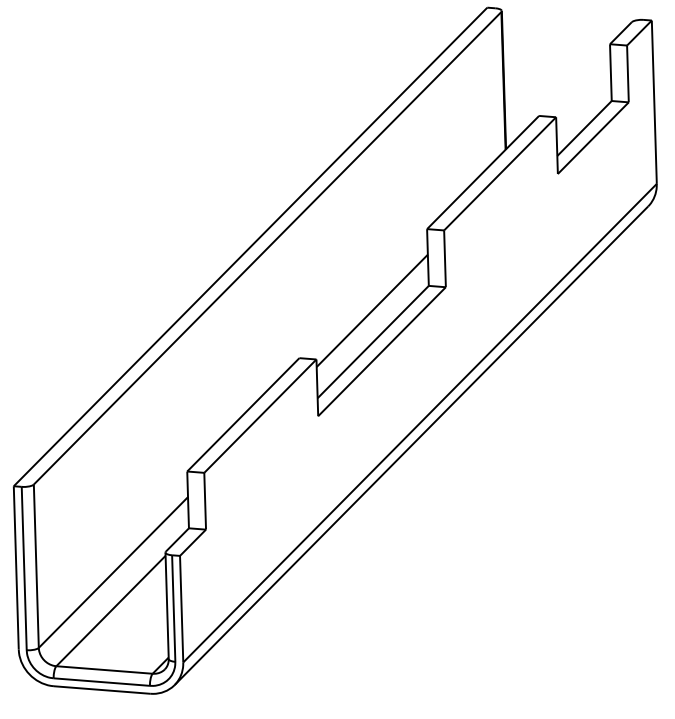
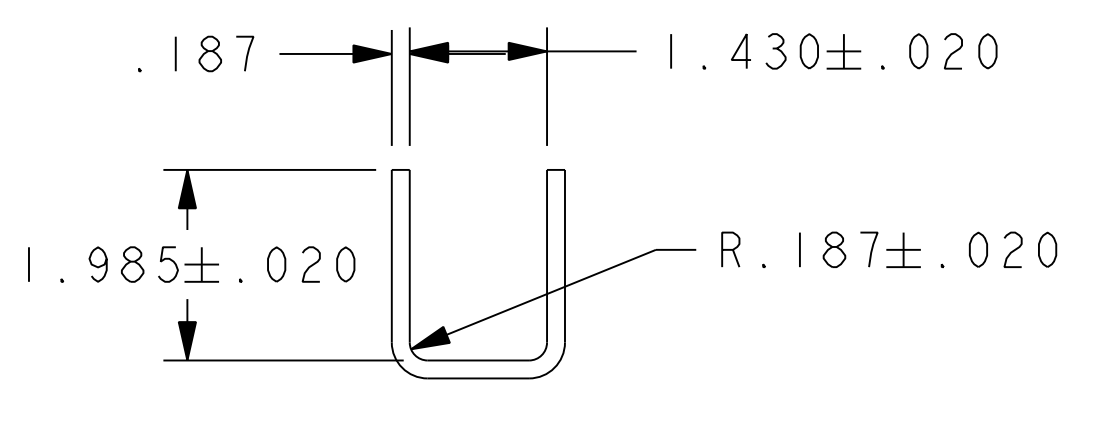
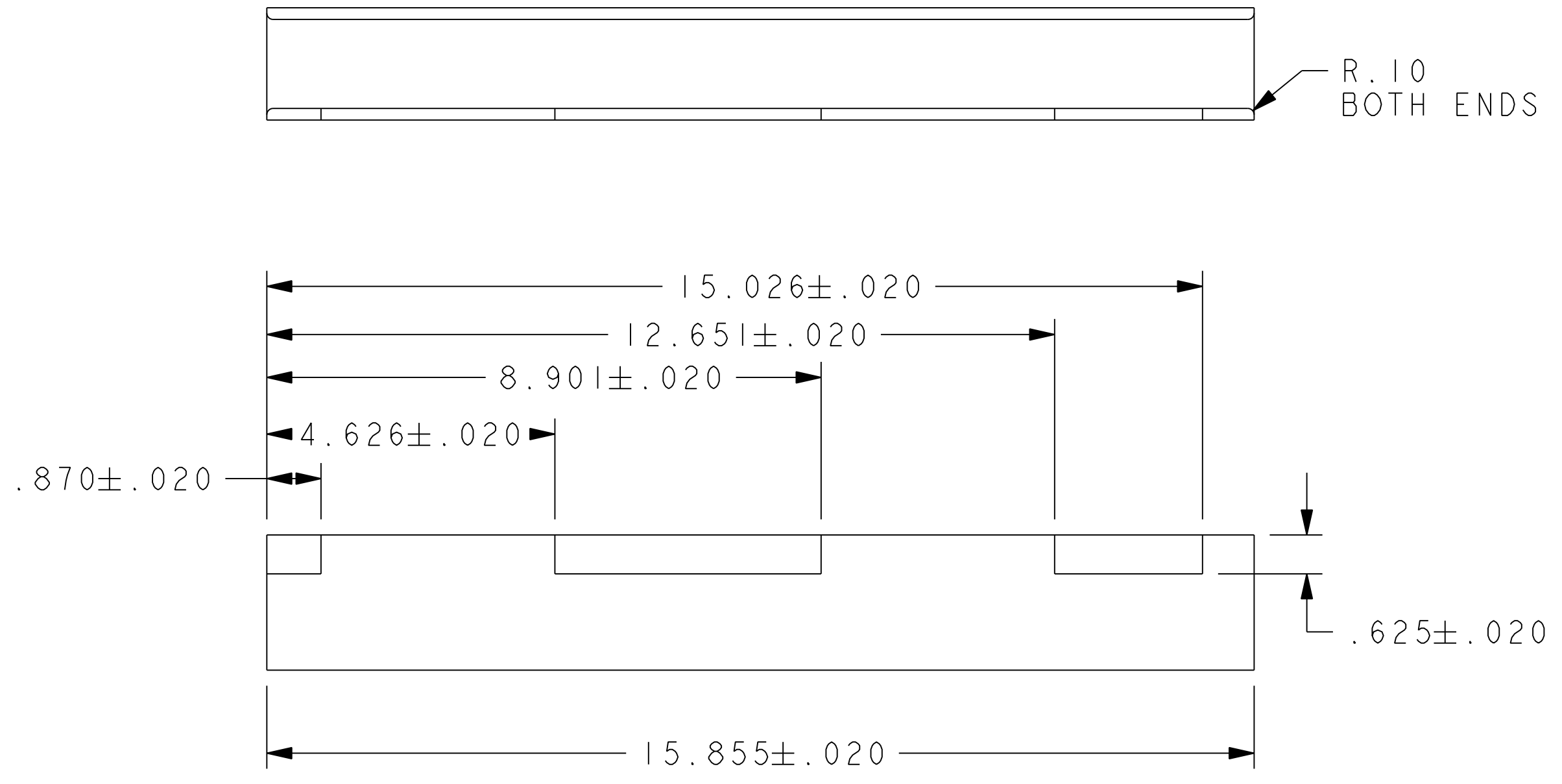

3

RELEASED FOR FABRICATION / INSTALLATION  
PPPL Drafting

- NOTES:  
 1. BREAK ALL SHARP CORNERS WITH A .020" MINIMUM RADIUS.  
 2. VENDOR TO CERTIFY THAT STOCK MATERIAL EXHIBITED MAGNETIC PERMEABILITY OF LESS THAN 1.02 Mu.  
 3. IF AFTER WORKING OR MACHINING PART HAS MAGNETIC PERMEABILITY GREATER THAN 1.02 Mu, THEN PART IS TO BE VACUUM HEAT TREATED AT 1100°C FOR 2.5 HRS TO BRING THE MAGNETIC PERMEABILITY BELOW 1.02 Mu.

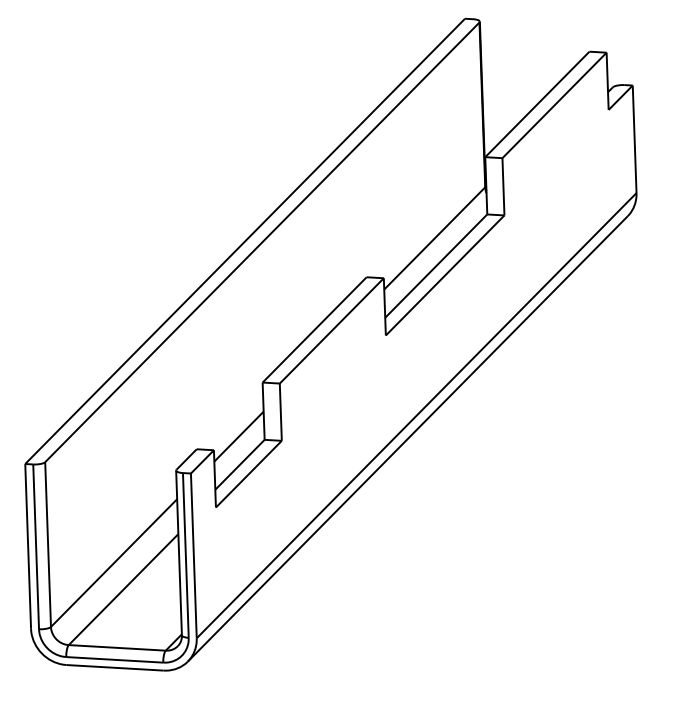
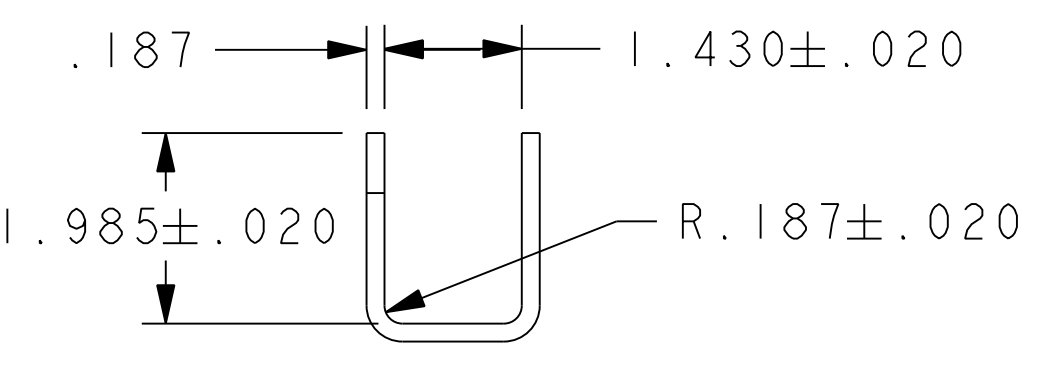
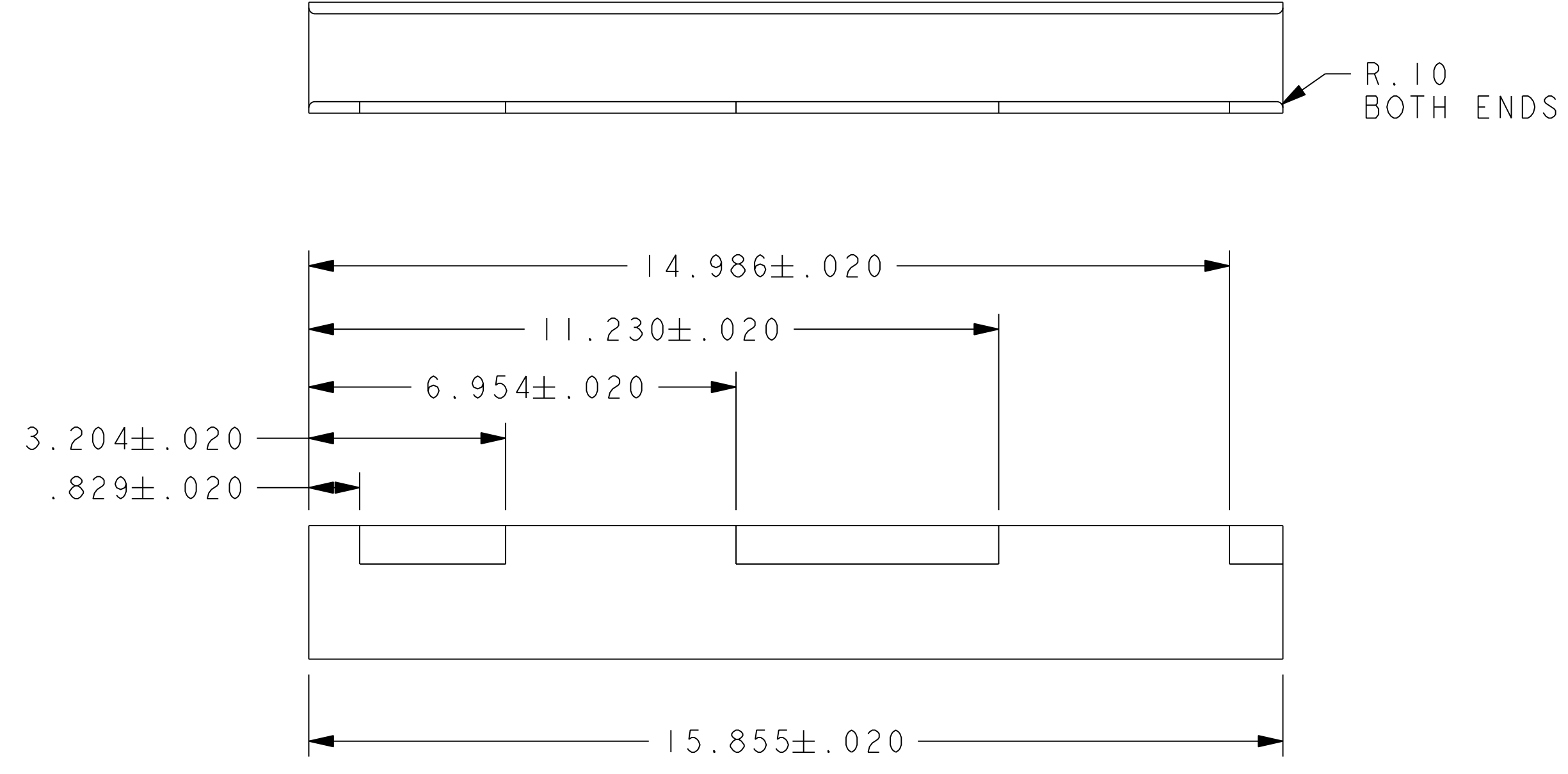

4

RELEASE LEVEL: Fabrication  
DWG VERSION NO: 14

WEIGHT	4.5 lbs
MODEL NAME	SEI33-044-4
WELDING ENGINEER	

PART NO.	DRAWING/MODEL NO	NOMENCLATURE OR DESCRIPTION	MATERIAL	QTY RECD
3	SEI33-044-4	TRIM COIL #1, CHANNEL SUPPORT CAP #4	316 SS/STL	24
3	SEI33-044-3	TRIM COIL #1, CHANNEL SUPPORT CAP #3	316 SS/STL	24
2	SEI33-044-2	TRIM COIL #1, CHANNEL SUPPORT CAP #2	316 SS/STL	12
1	SEI33-044-1	TRIM COIL #1, CHANNEL SUPPORT CAP #1	316 SS/STL	12

PARTS LIST

COMPUTER GENERATED DRAWING MANUAL CHANGES NOT PERMITTED Pro E	CENTRAL FILES: UNLESS OTHERWISE SPECIFIED DIMENSIONS ARE IN INCHES MACHINE SURFACES BREAK SHARP EDGES .005/.020	PRINCETON PLASMA PHYSICS LABORATORY PRINCETON UNIVERSITY NATIONAL COMPACT STELLARATOR EXPERIMENT STELLARATOR CORE TRIM COILS TRIM COIL #1, CHANNEL SUPPORT CAP
DO NOT VERIFY INFORMATION BY SCALING DRAWING	TOLERANCES NON-CUMULATIVE DECIMAL-INCH FRACTIONS .XX +/- .000 .XXX +/- .005 ANGULAR +/- 0°15' OVER	DSN: R. UPCAUGE 6/9/08 CHK: M. KALISH 6/9/08 ENGR: M. KALISH 6/9/08 SUPV: J. SIEGEL 6/9/08

SEI33-044

SHEET 1 OF 1 REV 0.5

NCSX-SEI33-044