

.490	-36
.488	-35
.486	-34
.484	-33
.482	-32
.480	-31
.478	-30
.476	-29
.474	-28
.472	-27
.470	-26
.468	-25
.466	-24
.464	-23
.462	-22
.460	-21
.458	-20
.456	-19
.454	-18
.452	-17
.450	-16
.448	-15
.446	-14
.444	-13
.442	-12
.440	-11
.438	-10
.436	-9
.434	-8
.432	-7
.430	-6
.428	-5
.426	-4
.424	-3
.422	-2
.420	-1

DIM A	PART NO
THICKNESS OF SS ± .001	

NOTES

- DRAWING PREPARED IN ACCORDANCE WITH ASME Y14.100-2004.
- INTERPRET DIMENSIONS AND TOLERANCES PER ASME Y14.5M-1994.
- DIMENSIONS ARE IN INCHES
- MAGNETIC PERMEABILITY NOT TO EXCEED 1.02 AS TESTED BY A SEVERN INDICATOR. AVAILABLE FROM:
SEVERN ENGINEERING
AUBURN, ALABAMA 36830
WWW.SEVERNGINEERING.COM

IF PERMEABILITY SPEC IS NOT ACHIEVED THEN SOLUTION ANNEAL PART.

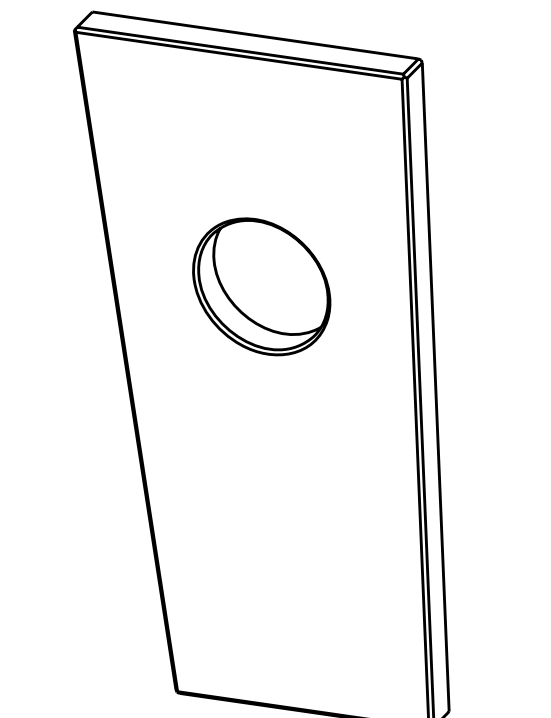
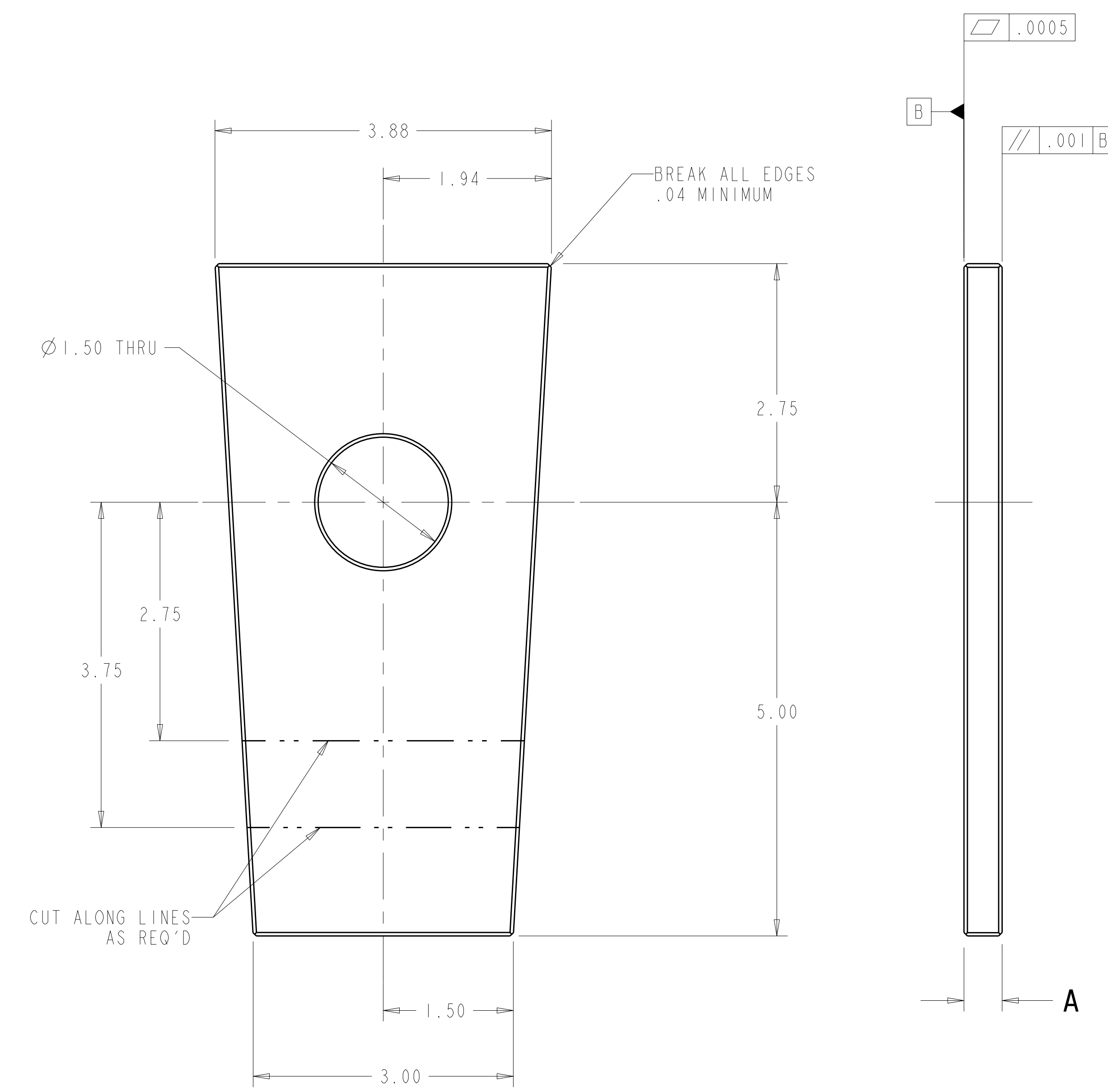

1 SHIM PLATE
SCALE 1.00

NOTE: PART TO BE CUT FROM FULL SIZE TEMPLATE CREATED BY DXF FILE SEI140-042.DXF, SEE SHEET 2.

AR	SEE CHART	SHIM PLATE	316 SST [4]	ASTM A240	I
CAGE CODE SEI140-041	PART OR IDENTIFYING NO	NOMENCLATURE OR DESCRIPTION	MATERIAL	SPECIFICATION	FOUND NO
NEXT ASSEMBLY		PARTS LIST			

RELEASED FOR FABRICATION/INSTALLATION
PPPL Drafting

NO REPRESENTATION OR WARRANTY, EXPRESSED OR IMPLIED, IS MADE AS TO THE ACCURACY, COMPLETENESS OR USEFULNESS OF THE INFORMATION OR STATEMENTS CONTAINED IN THESE DRAWINGS, OR THAT THE USE OR DISCLOSURE OF ANY INFORMATION, APPARATUS, METHOD OR PROCESS DISCLOSED IN THESE DRAWINGS MAY NOT INFRINGE PRIVATE RIGHTS OF OTHERS. NO LIABILITY IS ASSUMED WITH RESPECT TO THE USE OF, OR FOR DAMAGES RESULTING FROM THE USE OF, ANY INFORMATION, APPARATUS, METHOD OR PROCESS DISCLOSED IN THESE DRAWINGS. DRAWINGS MADE AVAILABLE FOR INFORMATION TO BIDDER ARE NOT TO BE USED FOR OTHER PURPOSES, AND ARE TO BE RETURNED UPON REQUEST OF THE FORWARDING CONTRACTOR.	P THIS DRAWING PRODUCED ON PRO-ENGINEER	SCALE NOTED TOLERANCES UNLESS OTHERWISE SPECIFIED FRACTIONS : XX DECIMALS ±.01 XXX DECIMALS ±.005 ANGLES ±0'15" BREAK SHARP EDGES OR MAX FINISH : .125 UNLESS OTHERWISE SPECIFIED	DES: D WILLIAMSON DRW: G MCGINNIS CHK: M COLE SECT: DEPT: PE: CR: PJ: REQ: PPPL DRFT J SIEGEL	02/2008 02/2008 02/2008 : : : : : : : : : : : : : : 02/2008 : : : : : : : : : : : : : :	Oak Ridge National Laboratory managed for the DEPARTMENT OF ENERGY under U.S. GOVERNMENT CONTRACT DE-AC05-00OR22725 UT-BATTELLE, LLC, Oak Ridge, Tennessee PROJECT NAME NATIONAL COMPACT STELLARATOR EXPERIMENT SHIM PLATE VERSION NO. 5 PLANT ORNL BLDG 5700 FL 3 SHT 1 OF 2 TYPE S CLASS U RELEASE LEVEL Fabrication SEI140-042 REV 0										
REV	DESCRIPTION	BY	DATE	CHK	DEPT	DATE	PE	REQ	DATE	ORNL	DOE	DATE	DRAWING APPROVALS		DATE
0	ORIGINAL ISSUE	GM	02/08	MC		02/08									

NO REPRESENTATION OR WARRANTY, EXPRESSED OR IMPLIED, IS MADE AS TO THE ACCURACY, COMPLETENESS OR USEFULNESS OF THE INFORMATION OR STATEMENTS CONTAINED IN THESE DRAWINGS, OR THAT THE USE OR DISCLOSURE OF ANY INFORMATION, APPARATUS, METHOD OR PROCESS DISCLOSED IN THESE DRAWINGS MAY NOT INFRINGE PRIVATE RIGHTS OF OTHERS. NO LIABILITY IS ASSUMED WITH RESPECT TO THE USE OF, OR FOR DAMAGES RESULTING FROM THE USE OF, ANY INFORMATION, APPARATUS, METHOD OR PROCESS DISCLOSED IN THESE DRAWINGS. DRAWINGS MADE AVAILABLE FOR INFORMATION TO BIDDER ARE NOT TO BE USED FOR OTHER PURPOSES, AND ARE TO BE RETURNED UPON REQUEST OF THE FORWARDING CONTRACTOR.

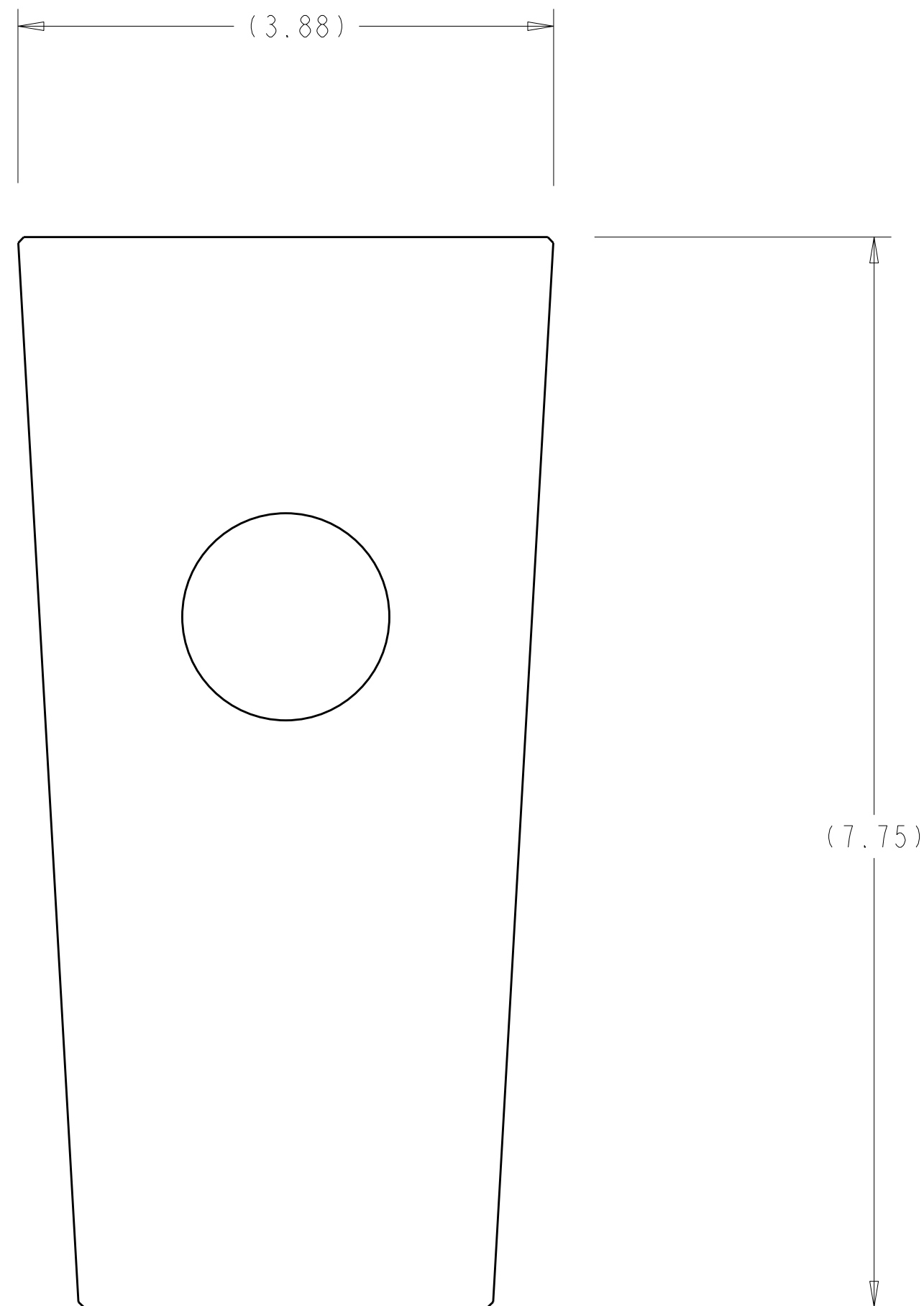

FULL SIZE TEMPLATE - CREATED FROM DXF FILE SE140-042.DXF

SCALE 1 : 1

NOTE: PART SIZE AND HOLE LOCATIONS MUST NOT DEVIATE FROM DXF FILE BY MORE THAN $\pm .01$

**RELEASED FOR
FABRICATION / INSTALLATION**
PPPL Drafting:

UT-BATTELLE		Oak Ridge National Laboratory managed for the DEPARTMENT OF ENERGY under U. S. GOVERNMENT contract DE-AC05-000R22725 UT-BATTELLE, LLC. Oak Ridge, Tennessee					
		<small>PROJECT NAME</small> NATIONAL COMPACT STELLARATOR EXPERIMENT					
SHIM PLATE							
<small>VERSION NO.</small> 5	<small>PLANT</small> ORNL	<small>BLDG</small> 5700	<small>FL</small> 3	<small>SHT OF</small> 2 2	<small>TYPE</small> S	<small>CLASS</small> U	
<small>RELEASE LEVEL</small> Fabrication		SE140-042				<small>REV</small> 0	