

NOTES:

- 1. INTERPRET DIMENSIONS AND TOLERANCES PER ANSI Y14.5M
- 2. DIMENSIONS ARE IN INCHES
- 3. DIMENSIONS APPLY AT ROOM TEMPERATURE. OPERATING TEMP 80 K
- 4. GEOMETRY IS DEFINED IN PRO ENGINEER CAD MODELS/FILES
- 5. DRAWING AND MODELS COMBINED DEFINE FINISHED MACHINED PART

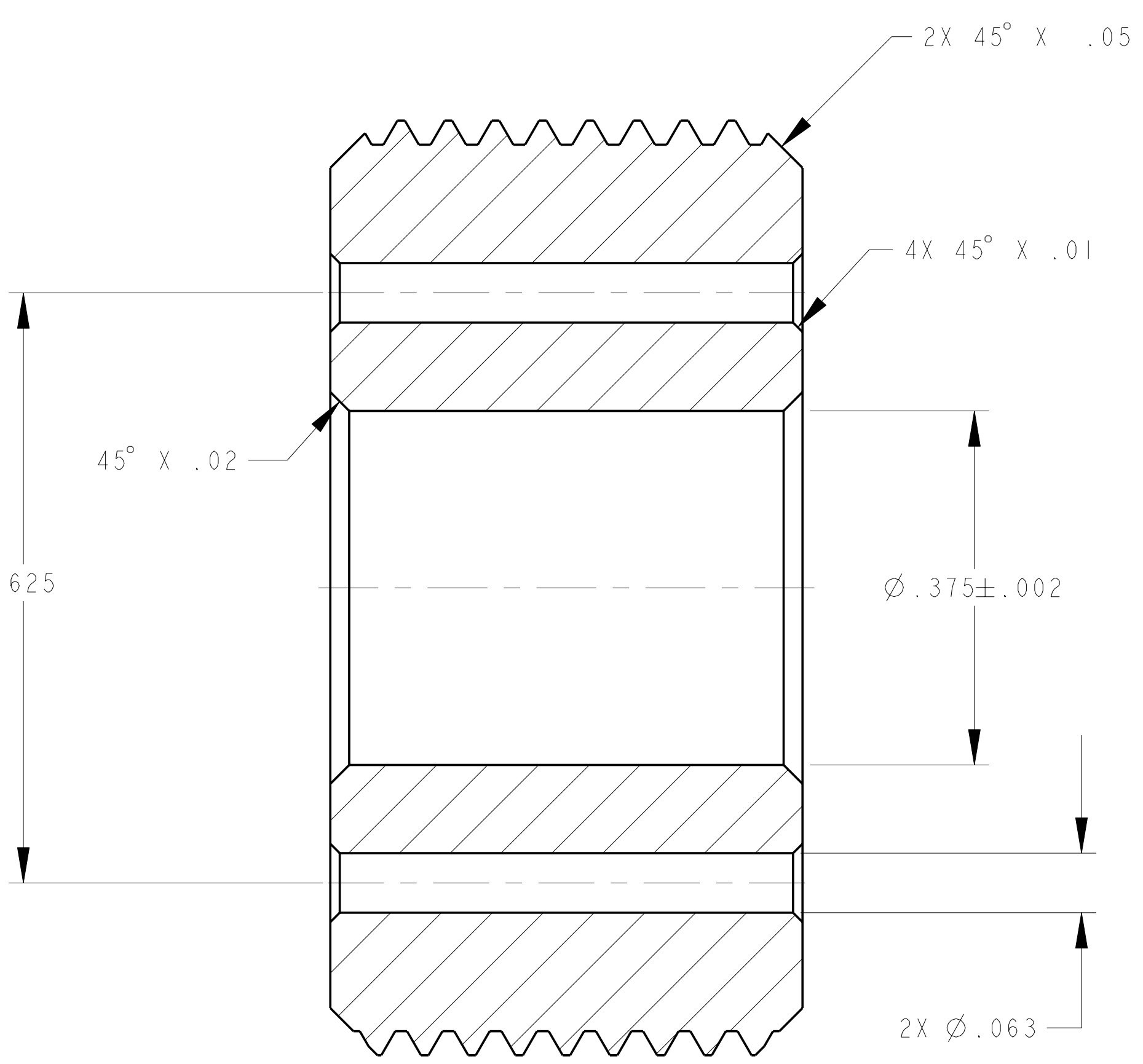

SECTION A-A

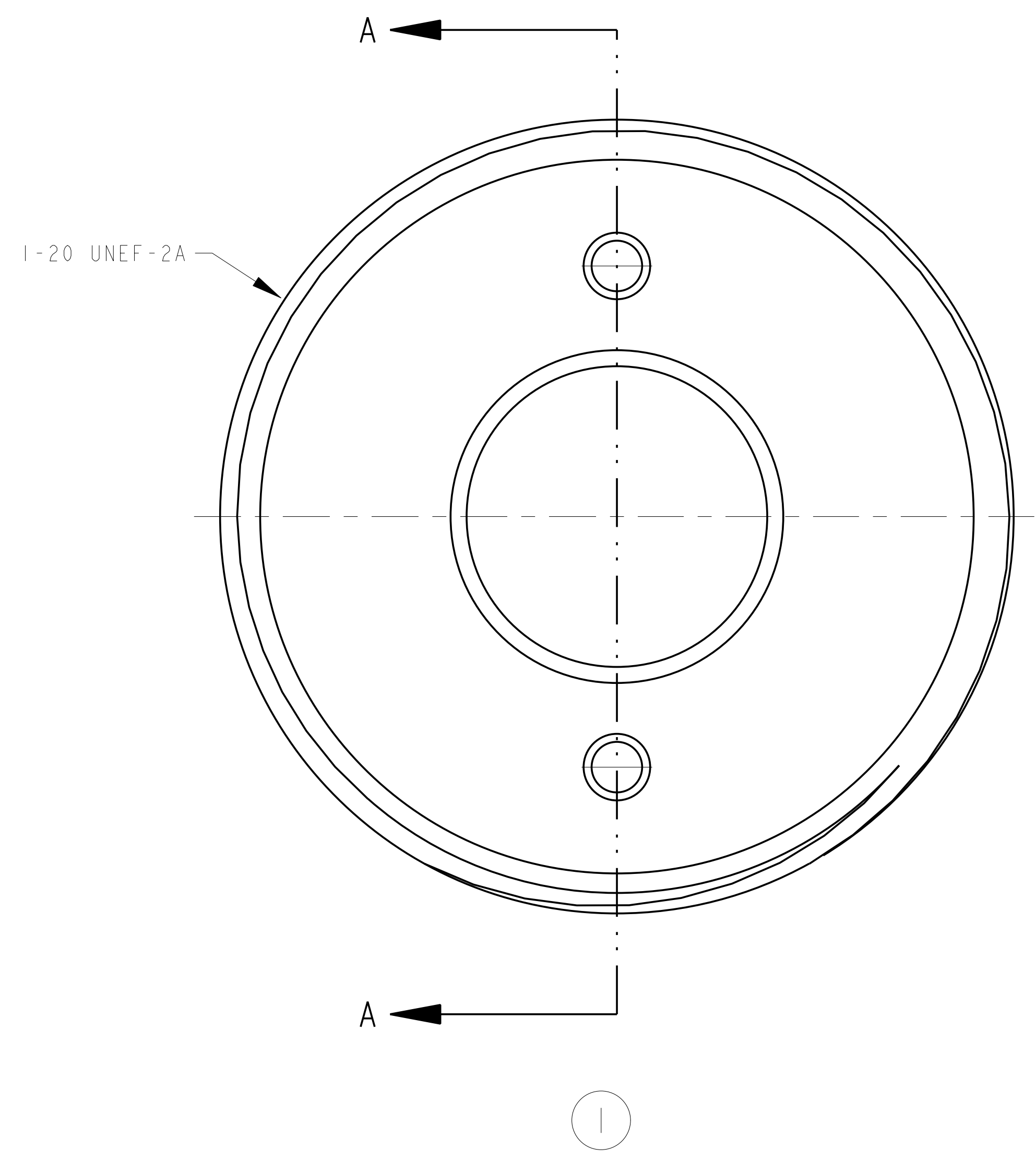
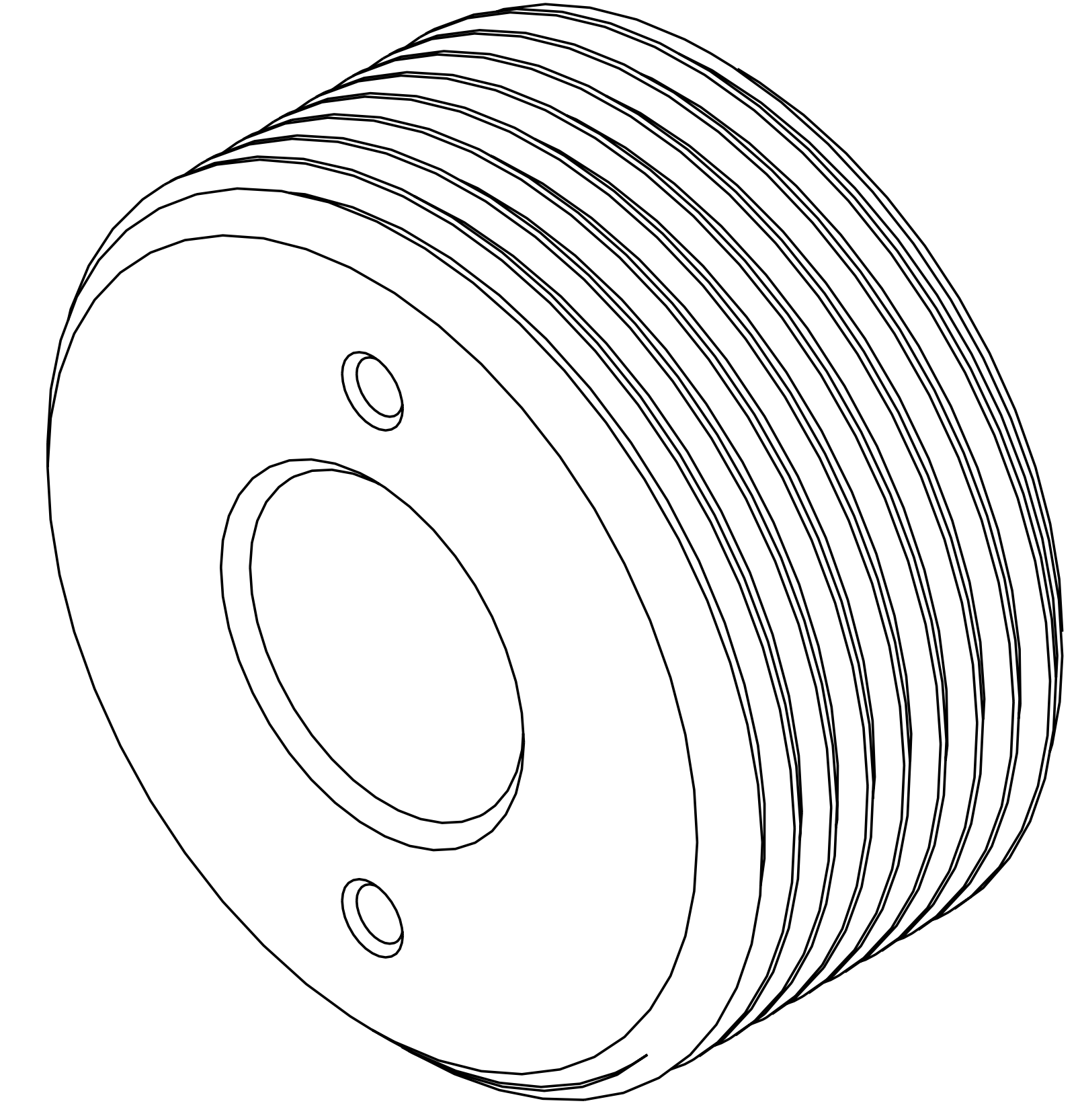
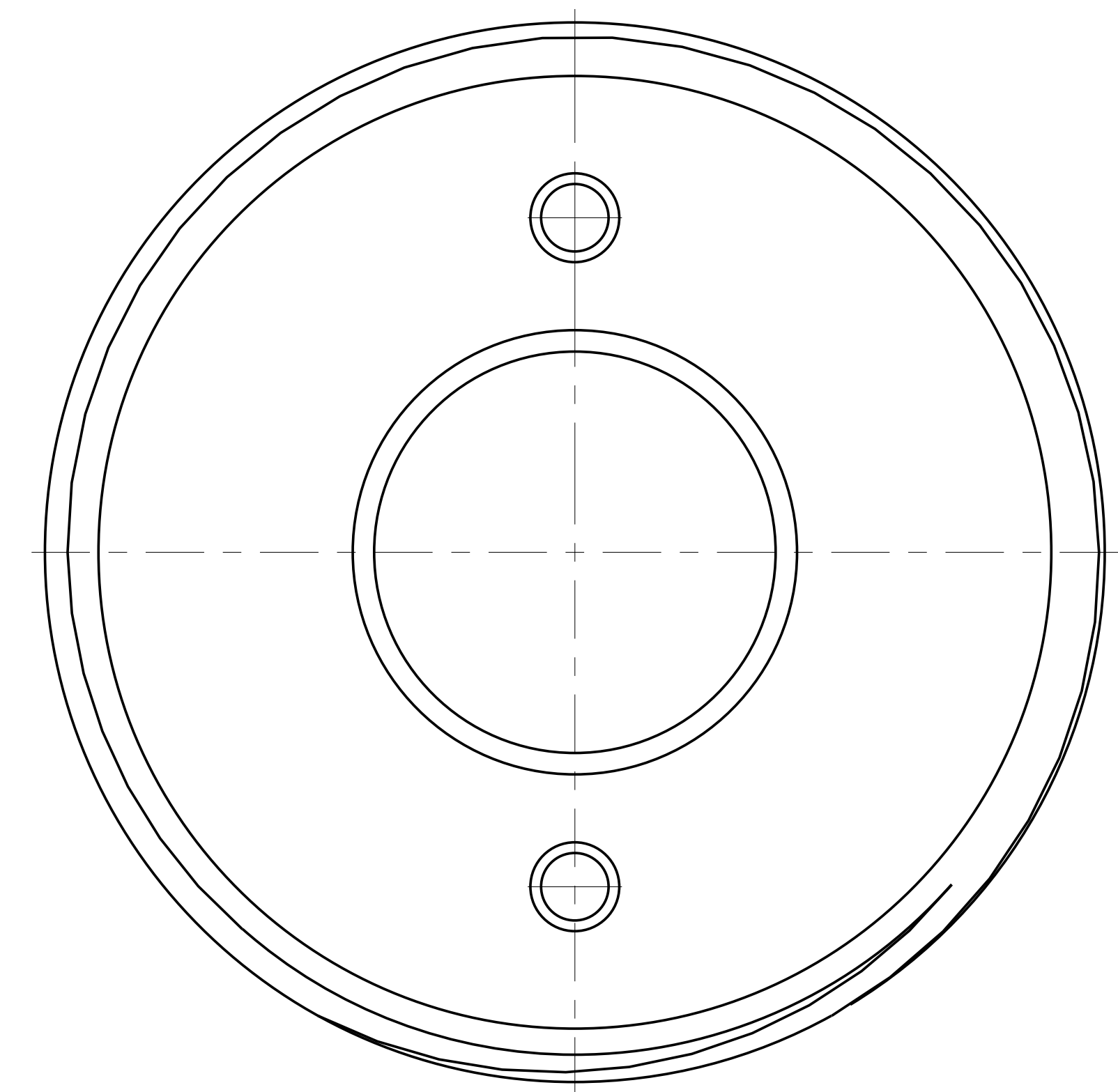

RELEASED FOR FABRICATION / INSTALLATION

AR	SE1405-255P	SCREW, SET, 1-20 UNEF-2A X 1/2	316L SS AG PLATED	--	--
CAGE CODE	PART OR IDENTIFYING NO	NOMENCLATURE OR DESCRIPTION	MATERIAL	SPECIFICATION	FIND NO
SE1405-250	← NEXT ASSEMBLY	PARTS LIST			

NO REPRESENTATION OR WARRANTY, EXPRESSED OR IMPLIED, IS MADE AS TO THE ACCURACY, COMPLETENESS OR USEFULNESS OF THE INFORMATION OR STATEMENTS CONTAINED IN THESE DRAWINGS, OR THAT THE USE OR DISCLOSURE OF ANY INFORMATION, APPARATUS, METHOD OR PROCESS DISCLOSED IN THESE DRAWINGS MAY NOT INFRINGE PRIVATE RIGHTS OF OTHERS. NO LIABILITY IS ASSUMED WITH RESPECT TO THE USE OF, OR FOR DAMAGES RESULTING FROM THE USE OF, ANY INFORMATION, APPARATUS, METHOD OR PROCESS DISCLOSED IN THESE DRAWINGS. DRAWINGS MADE AVAILABLE FOR INFORMATION TO BIDDER ARE NOT TO BE USED FOR OTHER PURPOSES, AND ARE TO BE RETURNED UPON REQUEST OF THE FORWARDING CONTRACTOR.

**P** THIS DRAWING PRODUCED ON PRO-ENGINEER

SCALE	8	DES	PAUL MILLER	4-12-04	Oak Ridge National Laboratory managed for the DEPARTMENT OF ENERGY under U.S. GOVERNMENT contract DE-AC05-00OR22725 UT-BATTELLE, LLC., Oak Ridge, Tennessee											
TOLERANCES UNLESS OTHERWISE SPECIFIED		CHK	PAUL MILLER	4-13-04	UT-BATTELLE											
FRACTIONS		SECT			NATIONAL COMPACT STELLARATOR EXPERIMENT											
XX DECIMALS	± .01	DEPT			SCREW, SET, 1-20 UNEF-2A X 1/2											
XXX DECIMALS	± .005	PE			VERSION NO.	PLANT	BLDG	FL	SHT OF	TYPE	CLASS					
ANGLES	± 0°15'	CR			3	X-10	5700	3	1	S	U					
BREAK SHARP EDGES	06 MAX	PJ			RELEASE LEVEL											
FINISH	.125 UNLESS OTHERWISE SPECIFIED	REG			WIP											
		DR			DRAWING APPROVALS											
REV	DESCRIPTION	BY	DATE	CHK	DEPT	DATE	PE	REG	DATE	DRNL	DOE	DATE	SE1405-255P			
	REVISION OR ISSUE PURPOSE	REVISION APPROVAL														