

WELDING ENGINEER  
 APPROVED: \_\_\_\_\_  
 DATE: \_\_\_\_\_

NO	BY	DATE	REVISION	CH	APPROVED

NOTES  
 1. ALL WELDS PER PROC ENG-037  
 2. VISUAL WELD INSPECTION PER AWS D1.1

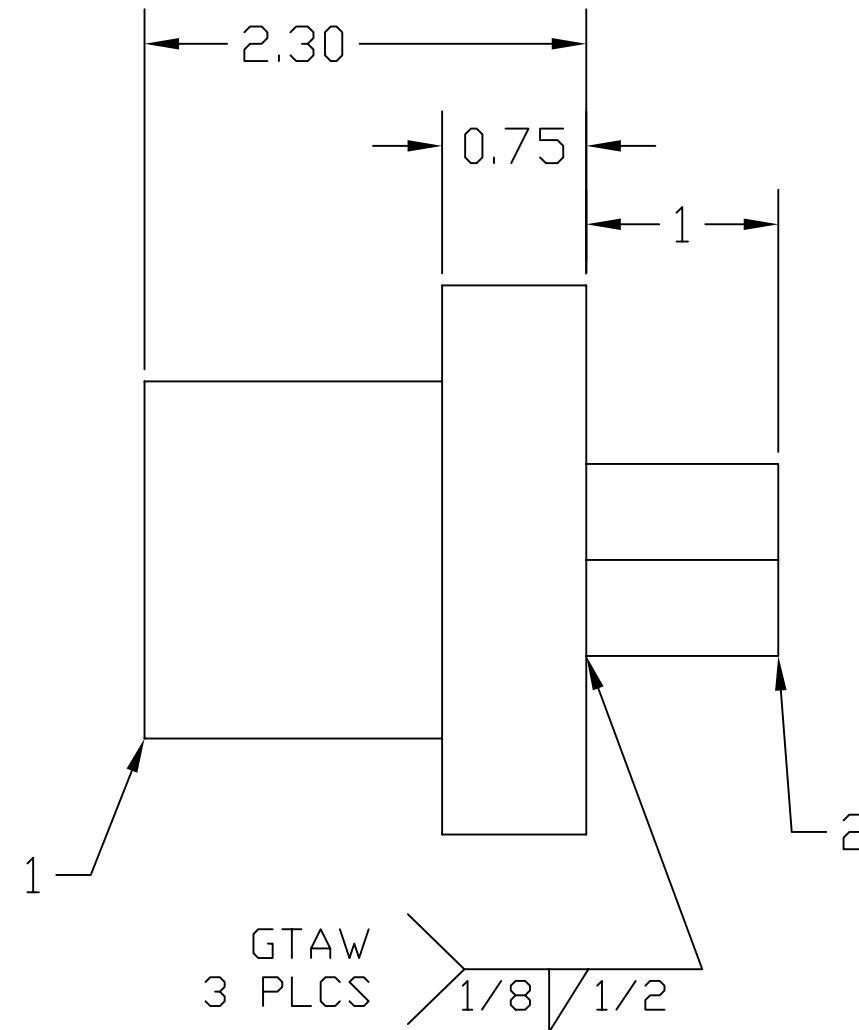
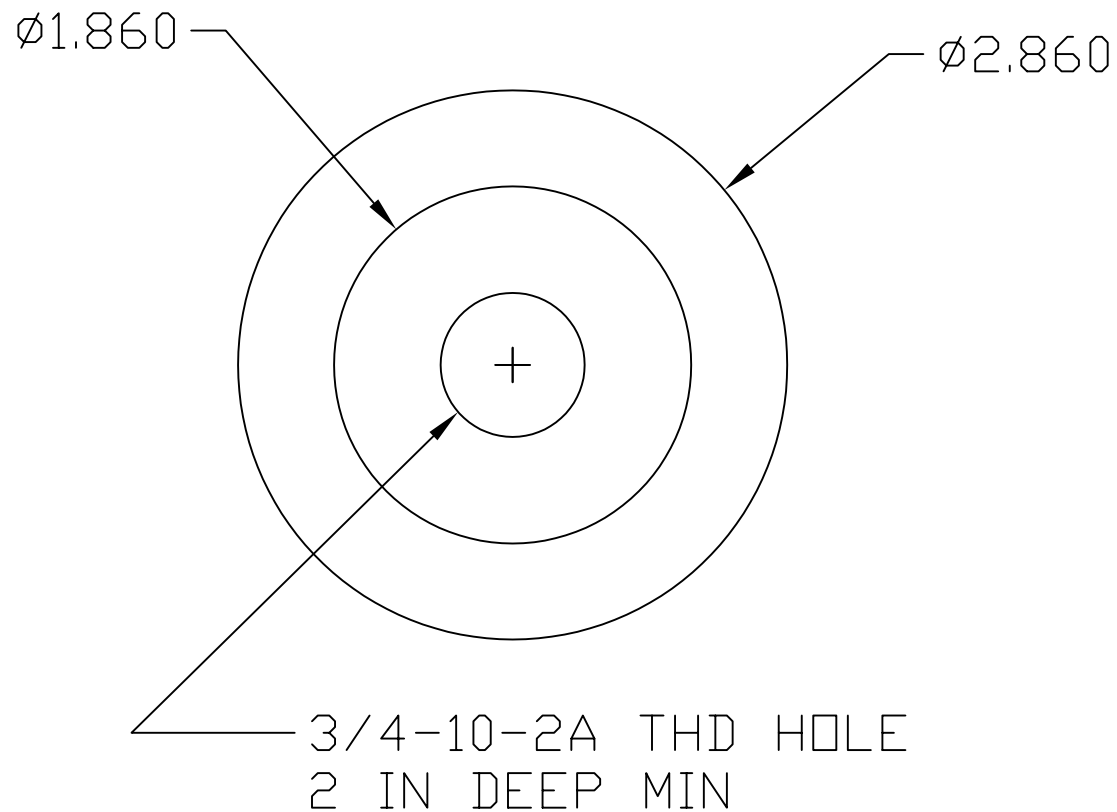

**RELEASED FOR  
 FABRICATION / INSTALLATION**  
 PPPL Drafting:

COMPUTER GENERATED DRAWING MANUAL CHANGES NOT PERMITTED	CENTRAL FILES:	PRINCETON PLASMA PHYSICS LABORATORY PRINCETON UNIVERSITY NATIONAL COMPACT STELLARATOR EXPERIMENT			
DO NOT VERIFY INFORMATION BY SCALING DRAWING	UNLESS OTHERWISE SPECIFIED DIMENSIONS ARE IN INCHES MACHINE SURFACES $\neq$	WBS 14, MODULAR COILS WINDING FORM LIFT NUT			
AutoCAD 2000	BREAK SHARP EDGES .005/.020	TOLERANCES NON-CUMULATIVE		DIV: FOM	DATE: 03/24/06
NEXT ASSEMBL	DECIMAL - INCH	FRACTIONS	ENG:	APPROVED	
	.X +.100'	0'-12" +1/16	DWN:	SE1409-014	
	.XX +.030	12'-72" +1/8	CHK:		
	.XXX +.005	72'-120" +1/4		CHK	SUPV
	ANGULAR +0 -15'	OVER 120" +1/2			
					SHEET 1 OF 1
					REV 0

QTY	PART NO.	NOMENCLATURE OR DESCRIPTION	DRAWING NO.	MATERIAL
N/A	2	1 IN HEX STOCK	THIS DWG	CARBON STEEL
N/A	1	NUT BODY	THIS DWG	CARBON STEEL