

WELDING ENGINEER
 APPROVED: _____
 DATE: _____

NO	BY	DATE	REVISION	CH	APPROVED

MAT'L: 1 IN
 CARBON STEEL

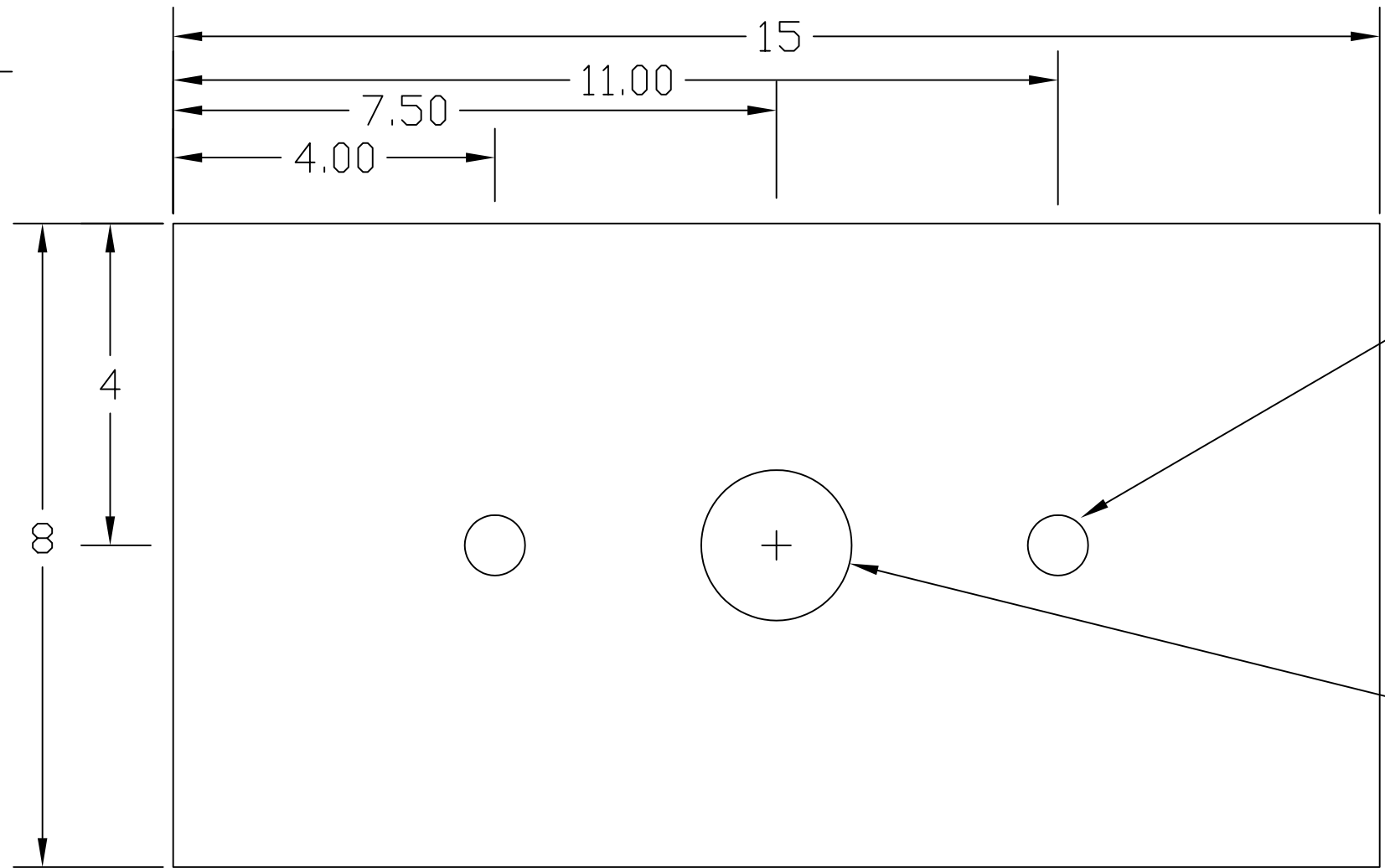

3/4-10 THD THROUGH
 2 PLCS

Ø1.870

**RELEASED FOR
 FABRICATION / INSTALLATION**
 PPPL Drafting:

COMPUTER GENERATED DRAWING MANUAL CHANGES NOT PERMITTED		CENTRAL FILES:		PRINCETON PLASMA PHYSICS LABORATORY PRINCETON UNIVERSITY NATIONAL COMPACT STELLARATOR EXPERIMENT			
DO NOT VERIFY INFORMATION BY SCALING DRAWING		UNLESS OTHERWISE SPECIFIED DIMENSIONS ARE IN INCHES MACHINE SURFACES $\pm .005$		WBS 14, MODULAR COILS WINDING FORM LIFT NUT TEST PLATE			
AutoCAD 2000		BREAK SHARP EDGES .005/.020					
NEXT ASSEMBL		TOLERANCES NON-CUMULATIVE		DIV: FOM	DATE: 03/16/06	CADD FILE:	
		DECIMAL - INCH		APPROVED		SE1409-015	
		FRACTIONS		DWN:			
		.X +.100' 0'-12" +1/16		CHK MV		SHEET 1 OF 1	
		.XX +.030 12'-72" +1/8		SUPV		REV 0	
		.XXX +.005 72'-120" +1/4					
		ANGULAR +0 -15' OVER 120" +1/2					

QTY	PART NO.	NOMENCLATURE OR DESCRIPTION	DRAWING NO.	MATERIAL