

1 TYPE-A SIDE-A ASM
 SCALE 0.25

- NOTES:
1. DRAWING PREPARED IN ACCORDANCE WITH ASME Y14.100-2000.
 2. INTERPRET DIMENSIONS AND TOLERANCES PER ASME Y14.5M-1994.
 3. DIMENSIONS ARE IN INCHES.
 4. DRAWING DEPICTS FLAT PATTERN OF FORMED PARTS DEFINED BY PRO/E MODELS SE142A-255.PRT AND SE142A-257.PRT.
 5. PROFILE TOLERANCE OF FLAT PATTERN IS +/- .010 IN.
 6. THICKNESS IS 0.040 +/- .006 IN. PER ASTM B248.
 7. REMOVE ALL BURRS AND SHARP EDGES.
 8. IDENTIFY PARTS WITH LABEL SHOWN BY ETCHING OR PERMANENT MARKER.

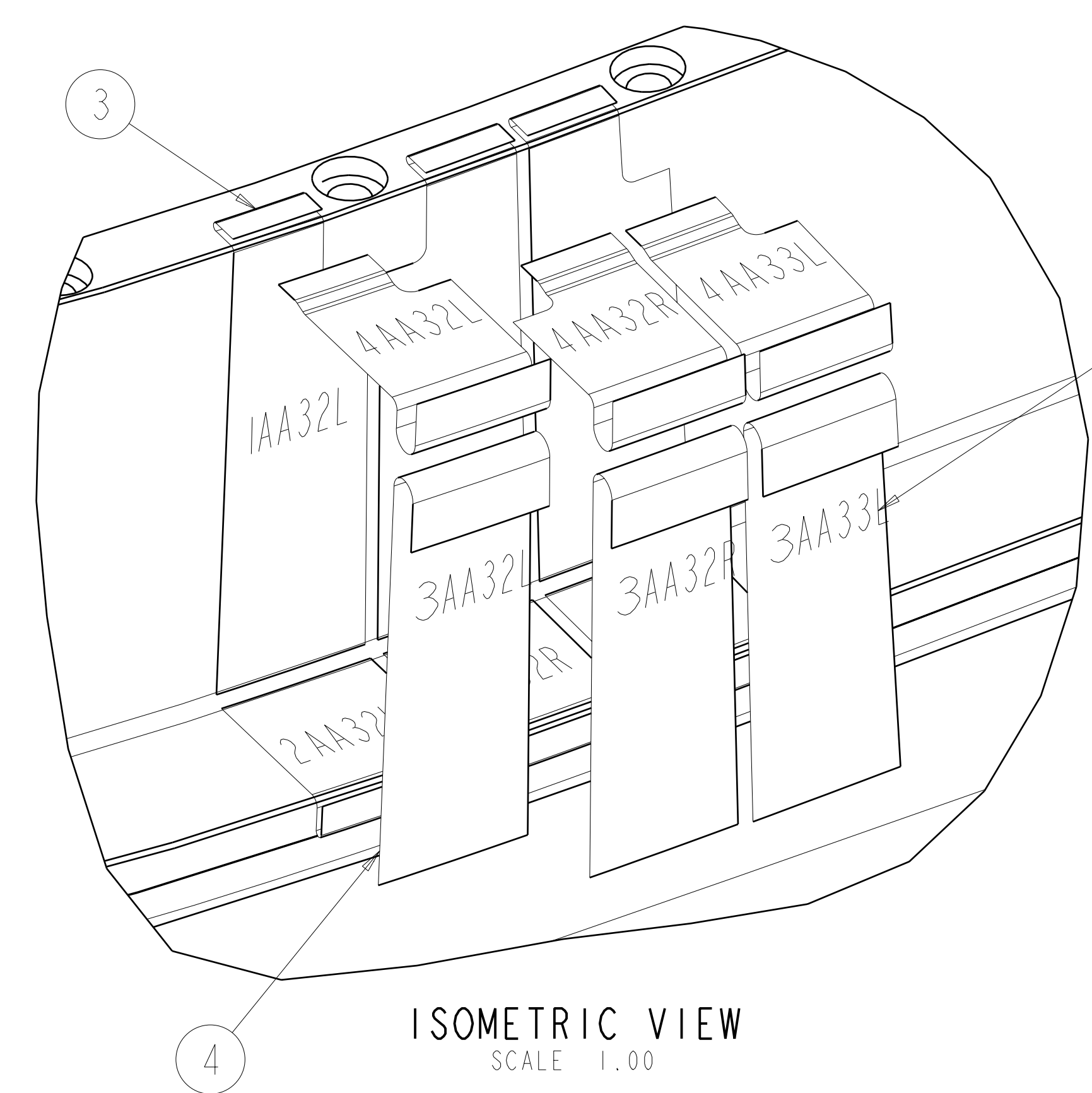

PART LABEL:
 1 - A - A - XX - L
 2 - B - B - - R
 3 - C - - -
 4 - - - -
 LEFT RIGHT
 HOLE NO.
 COIL SIDE
 COIL TYPE

WEB CLADDING 1
 BASE CLADDING 2
 LOWER CHILL PLATE 3
 UPPER CHILL PLATE 4

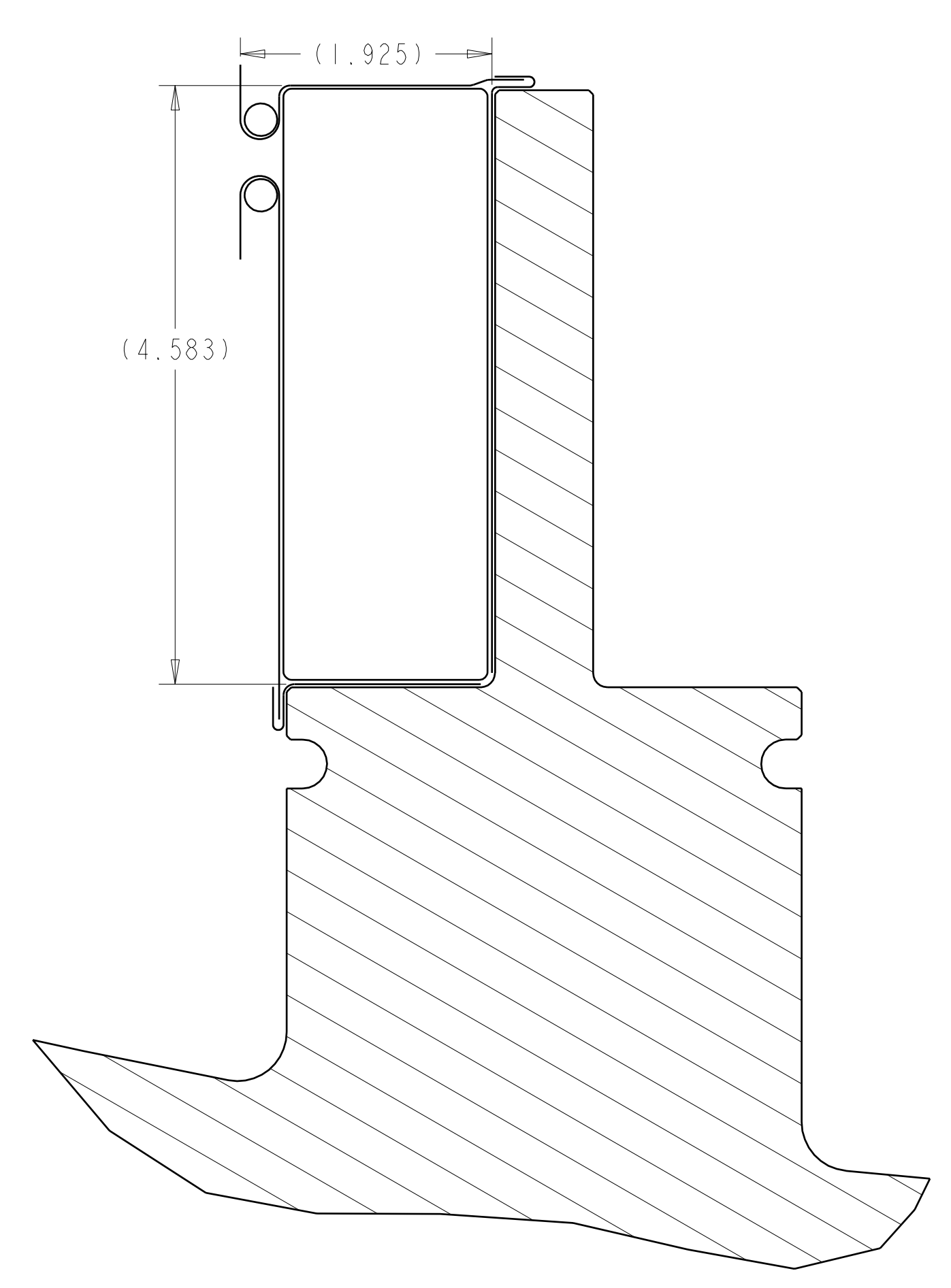

Rev 0-a: RFD-14-021 authorized substitution of chiller plate material to UNS C11000 ETP copper in a dead soft temper. Applicable to all Type A and B Castings

RELEASED FOR FABRICATION / INSTALLATION
 PPPL Drafting:

| | | | | | |
|-----------|-----------|------------------------|---|-------------------------------------|---------|
| 6 | 378 | SE142A-257 | CHILL PLATES | COPPER, ANNEALED UNS C10100, C10200 | 4 |
| 6 | 386 | SE142A-255 | CLADDING | COPPER, ANNEALED UNS C10100, C10200 | 3 |
| I | | SE141-114-SIM | TYPE-A MODULAR COIL WINDING FORM | | 2 |
| AR | X | -1 | TYPE-A SIDE-A CLADDING AND CHILL PLATES | | 1 |
| SE140-101 | | | | | |
| | CAGE CODE | PART OR IDENTIFYING NO | NOMENCLATURE OR DESCRIPTION | MATERIAL / SPECIFICATION | FIND NO |
| | | | NEXT ASSEMBLY | | |

PARTS LIST

NO REPRESENTATION OR WARRANTY, EXPRESSED OR IMPLIED, IS MADE AS TO THE ACCURACY, COMPLETENESS OR USEFULNESS OF THE INFORMATION OR STATEMENTS CONTAINED IN THESE DRAWINGS, OR THAT THE USE OR DISCLOSURE OF ANY INFORMATION, APPARATUS, METHOD OR PROCESS DISCLOSED IN THESE DRAWINGS MAY NOT INFRINGE PRIVATE RIGHTS OF OTHERS. NO LIABILITY IS ASSUMED WITH RESPECT TO THE USE OF, OR FOR DAMAGES RESULTING FROM THE USE OF, ANY INFORMATION, APPARATUS, METHOD OR PROCESS DISCLOSED IN THESE DRAWINGS. DRAWINGS MADE AVAILABLE FOR INFORMATION TO BIDDER ARE NOT TO BE USED FOR OTHER PURPOSES, AND ARE TO BE RETURNED UPON REQUEST OF THE FORWARDING CONTRACTOR.

P THIS DRAWING PRODUCED ON PRO-ENGINEER

| REV | DESCRIPTION | BY | DATE | CHK | DEPT | DATE | PE | REG | DATE | DRNL | DOE | DATE |
|---------------------------|-------------|-------------------|------|-----|------|------|----|-----|------|------|-----|------|
| REVISION OR ISSUE PURPOSE | | REVISION APPROVAL | | | | | | | | | | |
| | | | | | | | | | | | | |

SCALE NOTED

TOLERANCES UNLESS OTHERWISE SPECIFIED

FRACTIONS ±.01
 XX DECIMALS ±.005
 XXX DECIMALS ±0.015
 ANGLES ±0.15
 BREAK SHARP EDGES 06 MAX
 FINISH UNLESS OTHERWISE SPECIFIED

| | | |
|------|---------------|-------|
| DES | T. HARGROVE | 02-06 |
| DRW | D. WILLIAMSON | 02-06 |
| CHK | M. COLE | 02-06 |
| SECT | | |
| DEPT | | |
| PE | D. WILLIAMSON | 02-06 |
| CR | | |
| PJ | | |
| RED | | |
| PPPL | DRFTJ. SIEGEL | 02-06 |
| | | |
| | | |
| | | |

Oak Ridge National Laboratory managed for the DEPARTMENT OF ENERGY under U.S. GOVERNMENT CONTRACT DE-AC05-00OR22725 UT-BATTELLE, LLC. Oak Ridge, Tennessee

UT-BATTELLE

NATIONAL COMPACT STELLARATOR EXPERIMENT

MODULAR COIL TYPE-A SIDE-A CLADDING AND CHILL PLATES FLAT PATTERN LAYOUT

| | | | | | | | | | | | | | |
|---------------|-------------|-------|------|------|------|----|---|--------|----|------|---|-------|---|
| VERSION NO. | 13 | PLANT | X-10 | BLDG | 5700 | FL | 3 | SHT OF | 12 | TYPE | S | CLASS | U |
| RELEASE LEVEL | Fabrication | | | | | | | | | | | | |
| | SE142A-252 | | | | | | | | | | | | |
| REV | 0 | | | | | | | | | | | | |

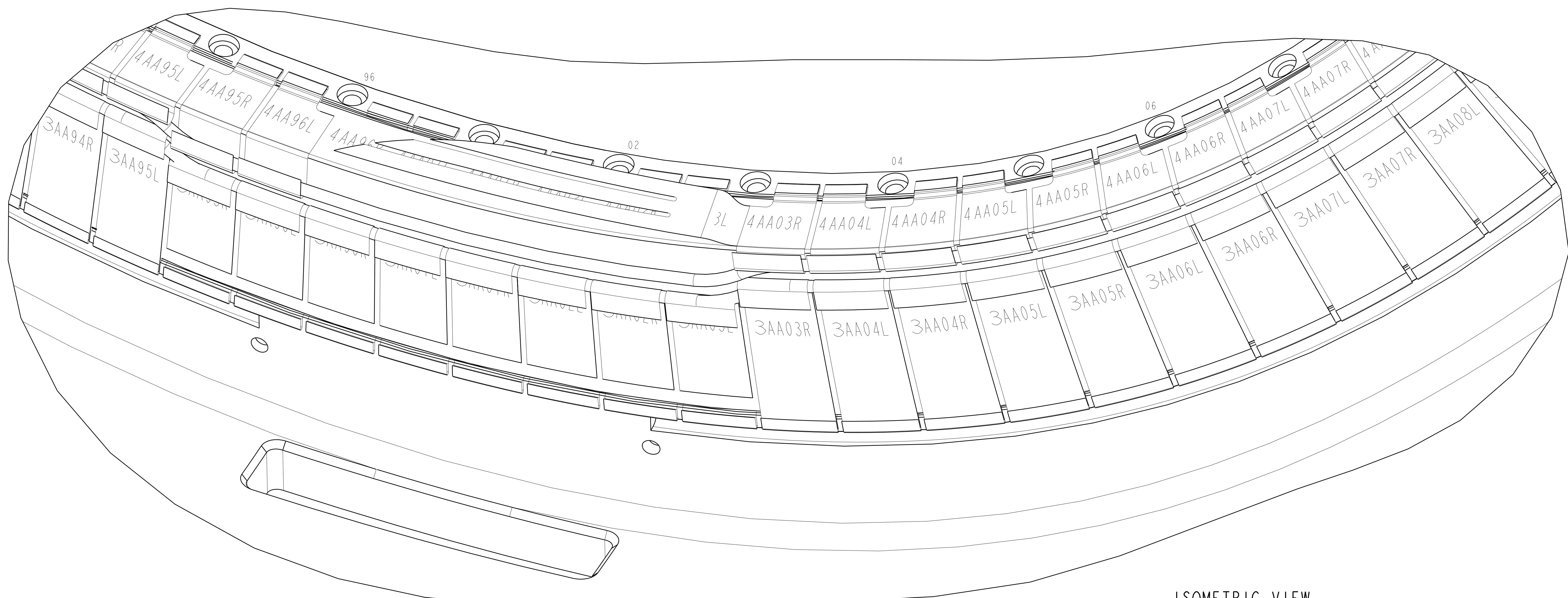
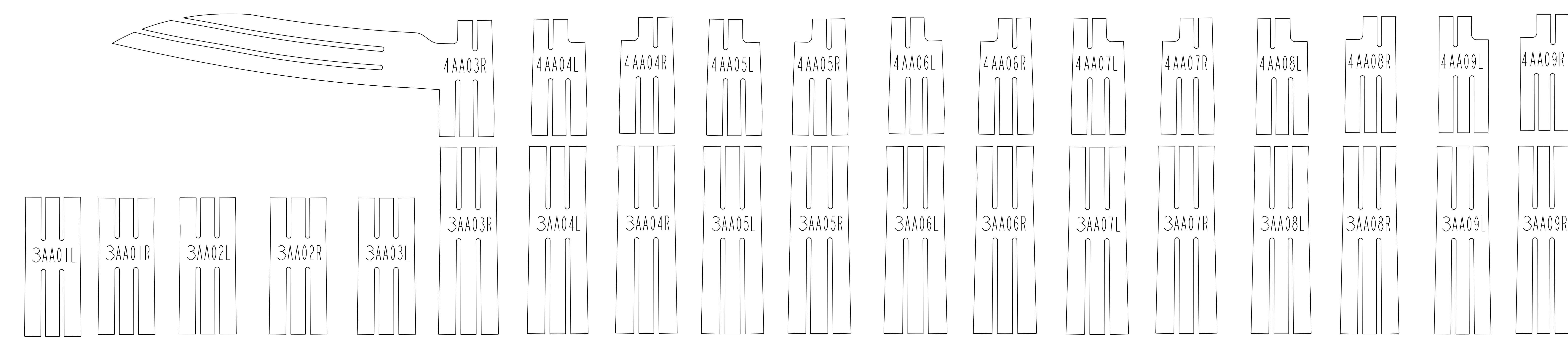
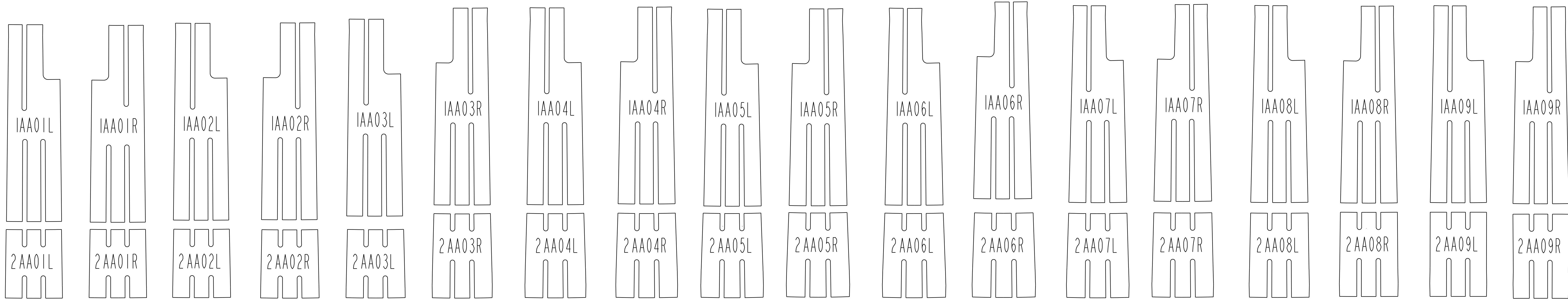

ISOMETRIC VIEW
 SCALE 1:00

**RELEASED FOR
 FABRICATION / INSTALLATION**
 PPPL Drafting:

| | | | | | | | |
|---|-------|---|----|--------|------|-------|-----|
| UT-BATTELLE | | Oak Ridge National Laboratory managed for the DEPARTMENT OF ENERGY under U.S. GOVERNMENT contract DE-AC05-00OR22725 UT-BATTELLE, LLC, Oak Ridge, Tennessee | | | | | |
| PROJECT NAME | | | | | | | |
| NATIONAL COMPACT STELLARATOR EXPERIMENT | | | | | | | |
| MODULAR COIL TYPE-A | | | | | | | |
| SIDE-A CLADDING AND CHILL PLATES | | | | | | | |
| FLAT PATTERN LAYOUT | | | | | | | |
| VERSION NO. | PLANT | BLDG | FL | SHT OF | TYPE | CLASS | |
| 13 | X-10 | 5700 | 3 | 2 | 12 | S | U |
| RELEASE LEVEL | | | | | | | REV |
| Fabrication | | SE142A-252 | | | | | 0 |

SE142A-252

8

7

6

5

4

3

2

1

NEXT ASS'Y: 1 FINAL ASS'Y:

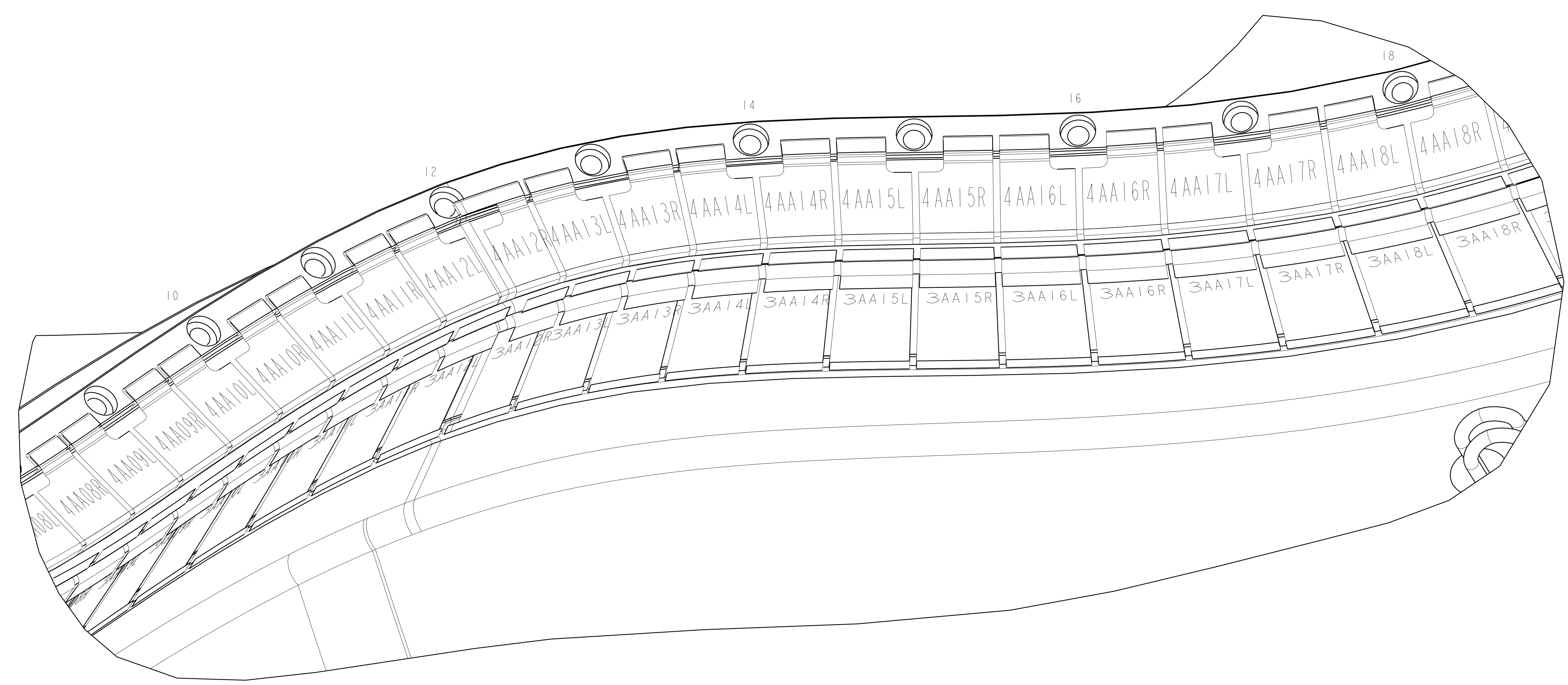
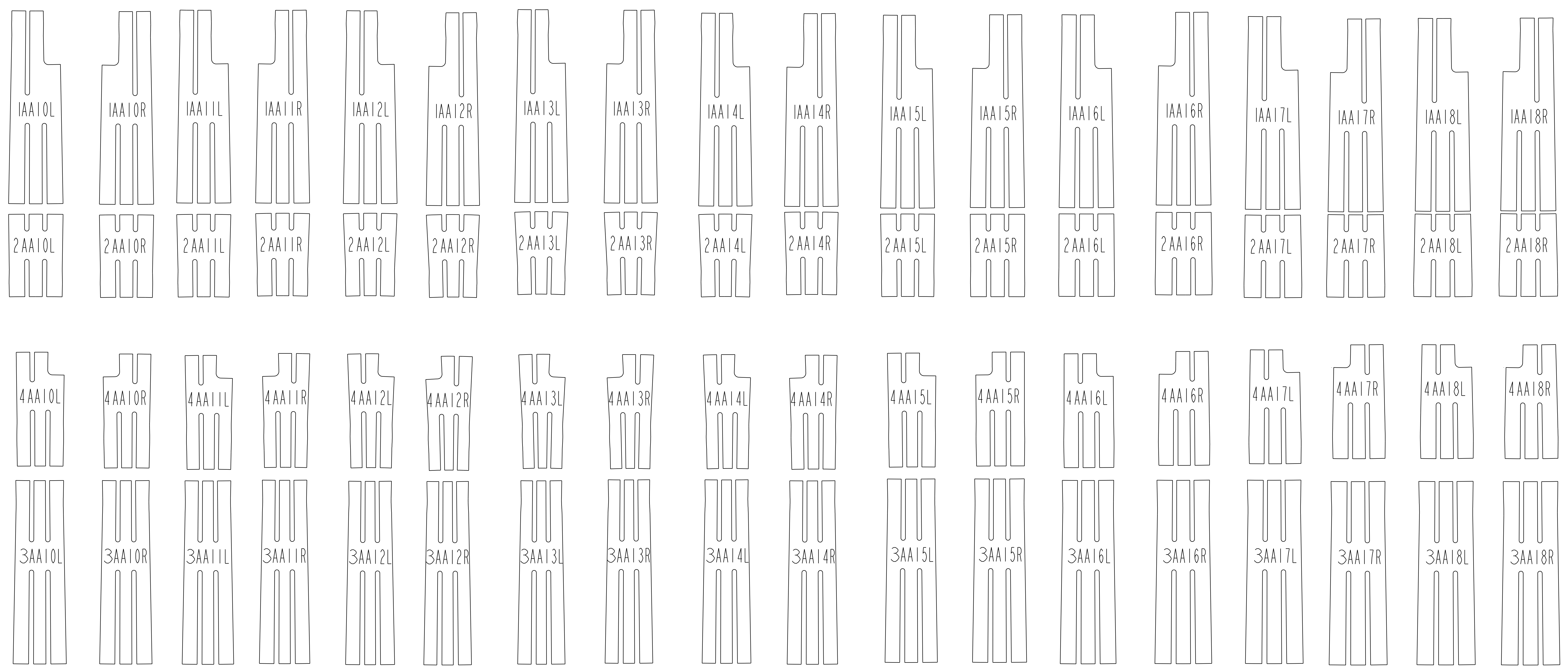

**RELEASED FOR
FABRICATION / INSTALLATION**
PPPL Drafting:

| | | | | | | |
|--|-------|------------|----|--------|------|-------|
| Oak Ridge National Laboratory managed for the DEPARTMENT OF ENERGY under U.S. GOVERNMENT contract DE-AC05-00OR22725 UT-BATTELLE, LLC, Oak Ridge, Tennessee PROJECT NAME: | | | | | | |
| NATIONAL COMPACT STELLARATOR EXPERIMENT MODULAR COIL TYPE-A SIDE-A CLADDING AND CHILL PLATES FLAT PATTERN LAYOUT | | | | | | |
| VERSION NO. | PLANT | BLDG | FL | SHT OF | TYPE | CLASS |
| 13 | X-10 | 5700 | 3 | 3 | 12 | S U |
| RELEASE LEVEL | | REV | | | | |
| Fabrication | | SE142A-252 | | | | |

ISOMETRIC VIEW
SCALE 1.00

H
G
F
E
D
C
B
A

SE142A-252

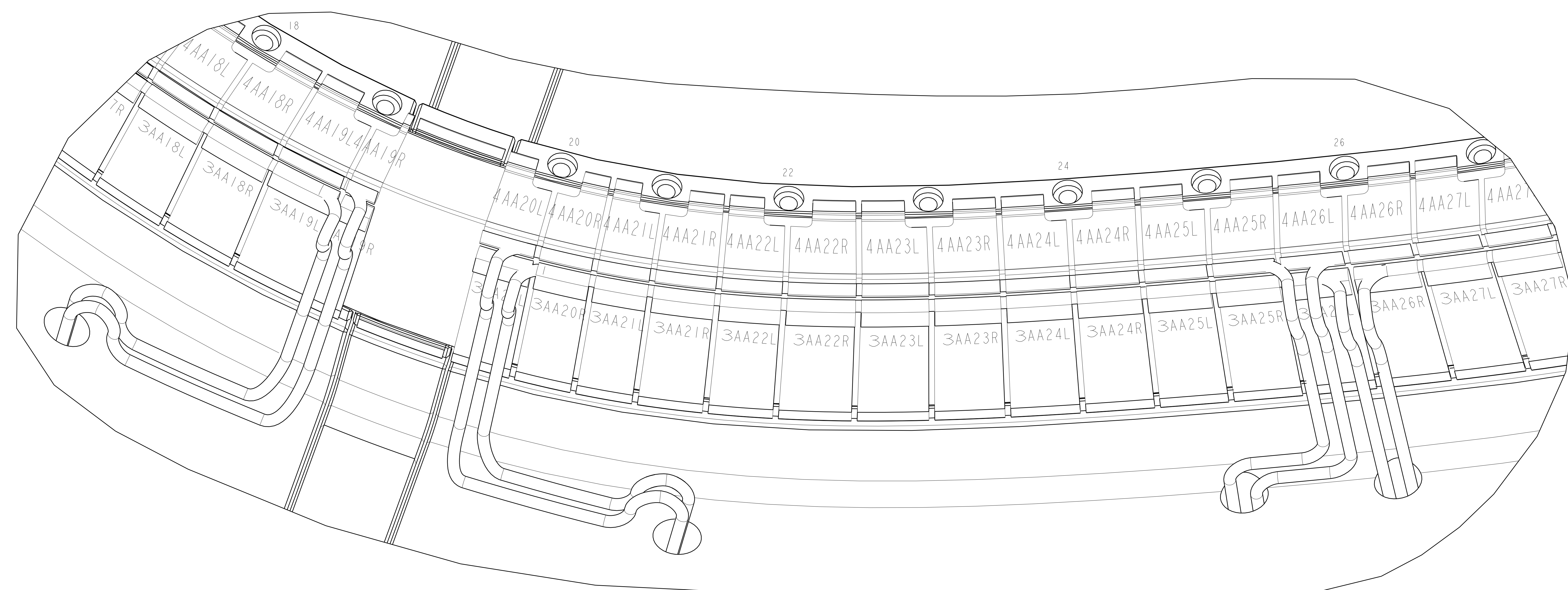
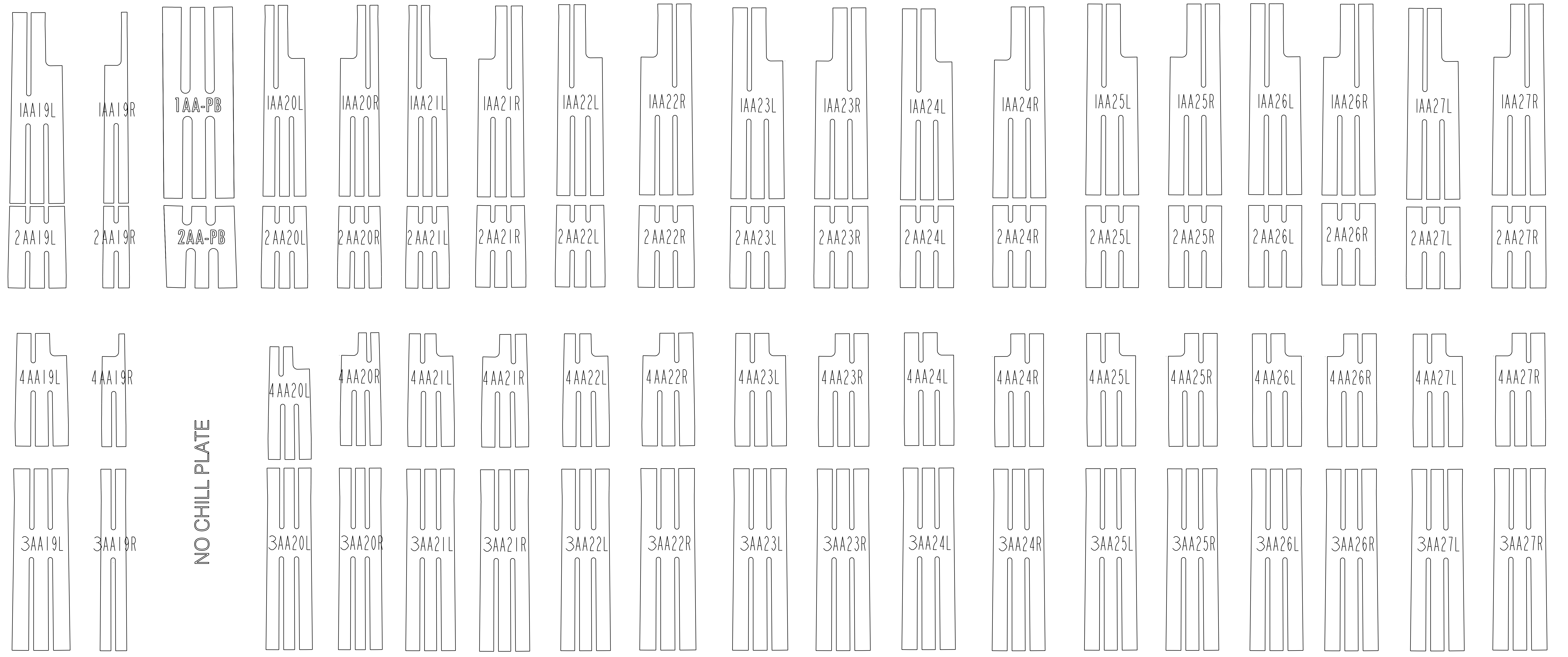

ISOMETRIC VIEW
 SCALE 1.00

**RELEASED FOR
 FABRICATION / INSTALLATION**
 PPPL Drafting:

| | | | | | | | |
|--|-------|------------|----|-----|----|------|-------|
| Oak Ridge National Laboratory managed for the DEPARTMENT OF ENERGY under U.S. GOVERNMENT contract DE-AC05-00OR22725 UT-BATTELLE, LLC. Oak Ridge, Tennessee PROJECT NAME: | | | | | | | |
| NATIONAL COMPACT STELLARATOR EXPERIMENT MODULAR COIL TYPE-A SIDE-A CLADDING AND CHILL PLATES FLAT PATTERN LAYOUT | | | | | | | |
| VERSION NO. | PLANT | BLDG | FL | SHT | OF | TYPE | CLASS |
| 13 | X-10 | 5700 | 3 | 4 | 12 | S | U |
| RELEASE LEVEL | | SE142A-252 | | REV | | U | |
| Fabrication | | | | | | 0 | |

SE142A-252

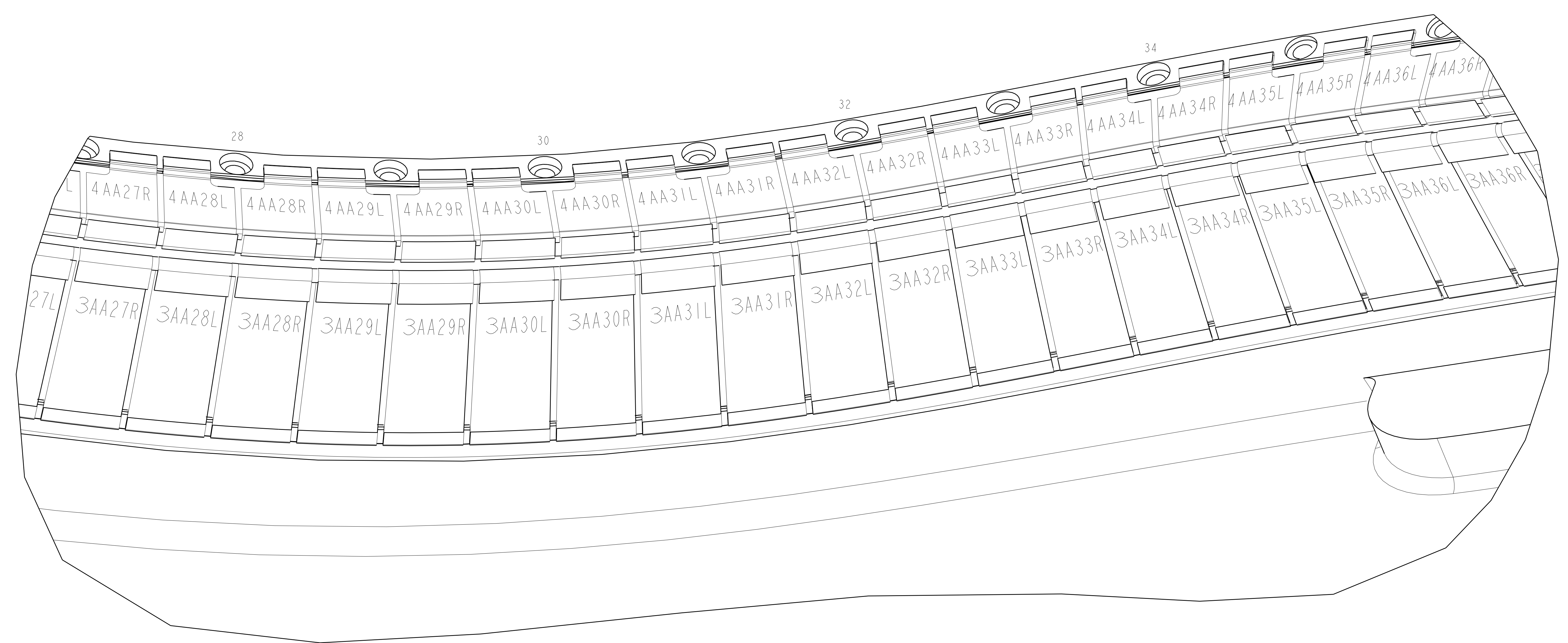
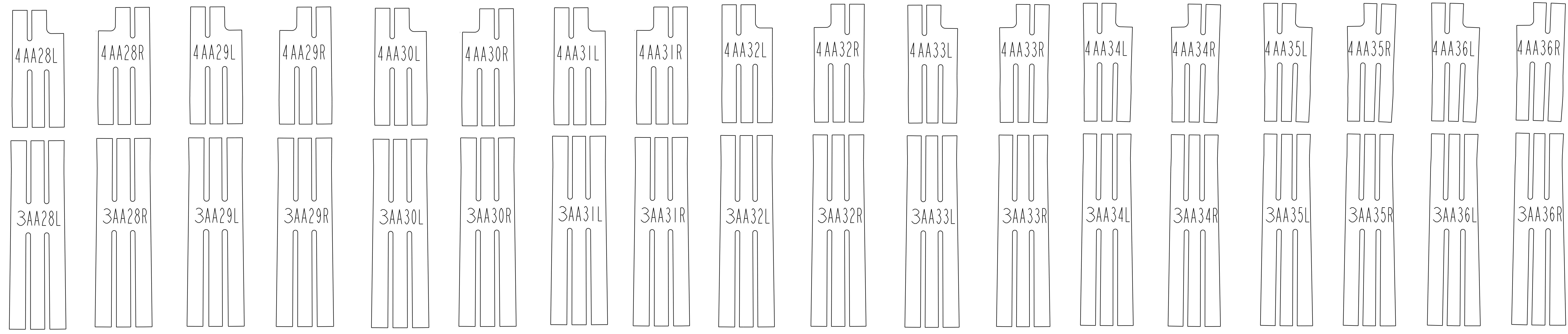
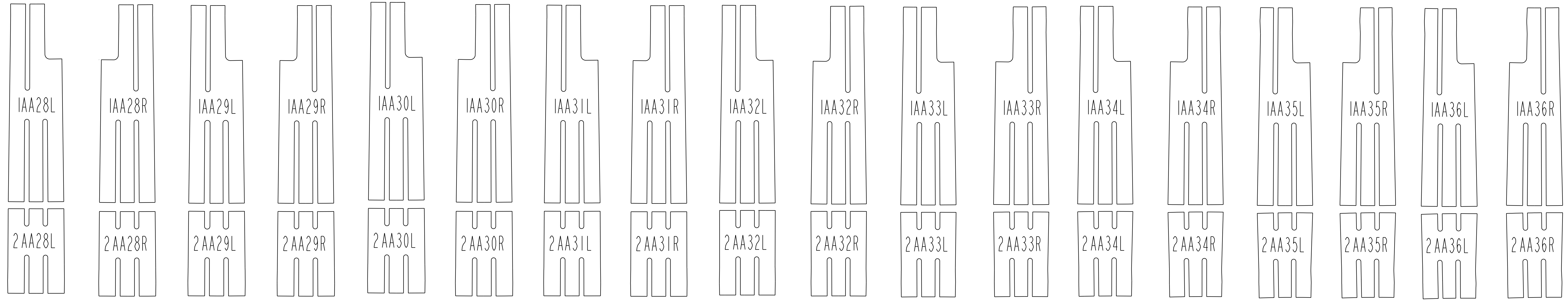

ISOMETRIC VIEW
SCALE 1.00

**RELEASED FOR
FABRICATION / INSTALLATION**
PPPL Drafting:

| | | | | | | | |
|---|-------|--------------|----|-----|----|------|-------|
| Oak Ridge National Laboratory managed for the DEPARTMENT OF ENERGY under U.S. GOVERNMENT contract DE-AC05-00OR22725 UT-BATTELLE, LLC, Oak Ridge, Tennessee | | | | | | | |
| UT-BATTELLE NATIONAL COMPACT STELLARATOR EXPERIMENT MODULAR COIL TYPE-A SIDE-A CLADDING AND CHILL PLATES FLAT PATTERN LAYOUT | | | | | | | |
| VERSION NO. | PLANT | BLDG | FL | SHT | OF | TYPE | CLASS |
| 13 | X-10 | 5700 | 3 | 5 | 12 | S | U |
| RELEASE LEVEL | | REV | | | | | |
| Fabrication | | SE142A-252 0 | | | | | |

SE142A-252

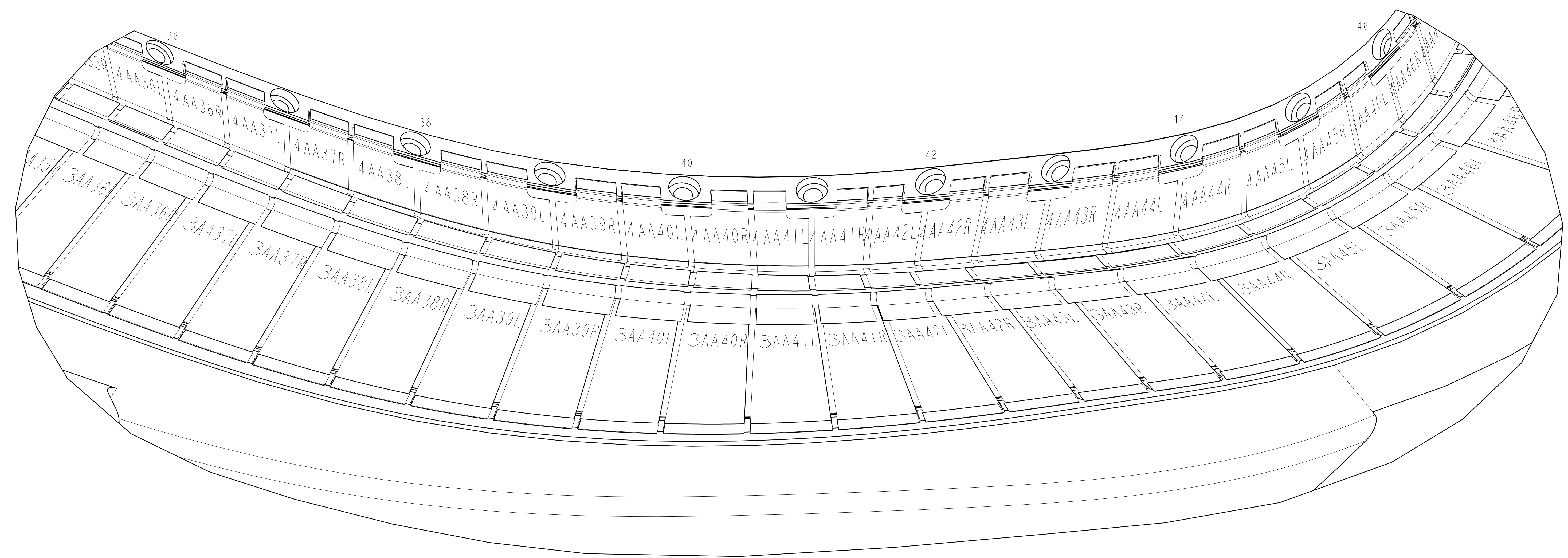
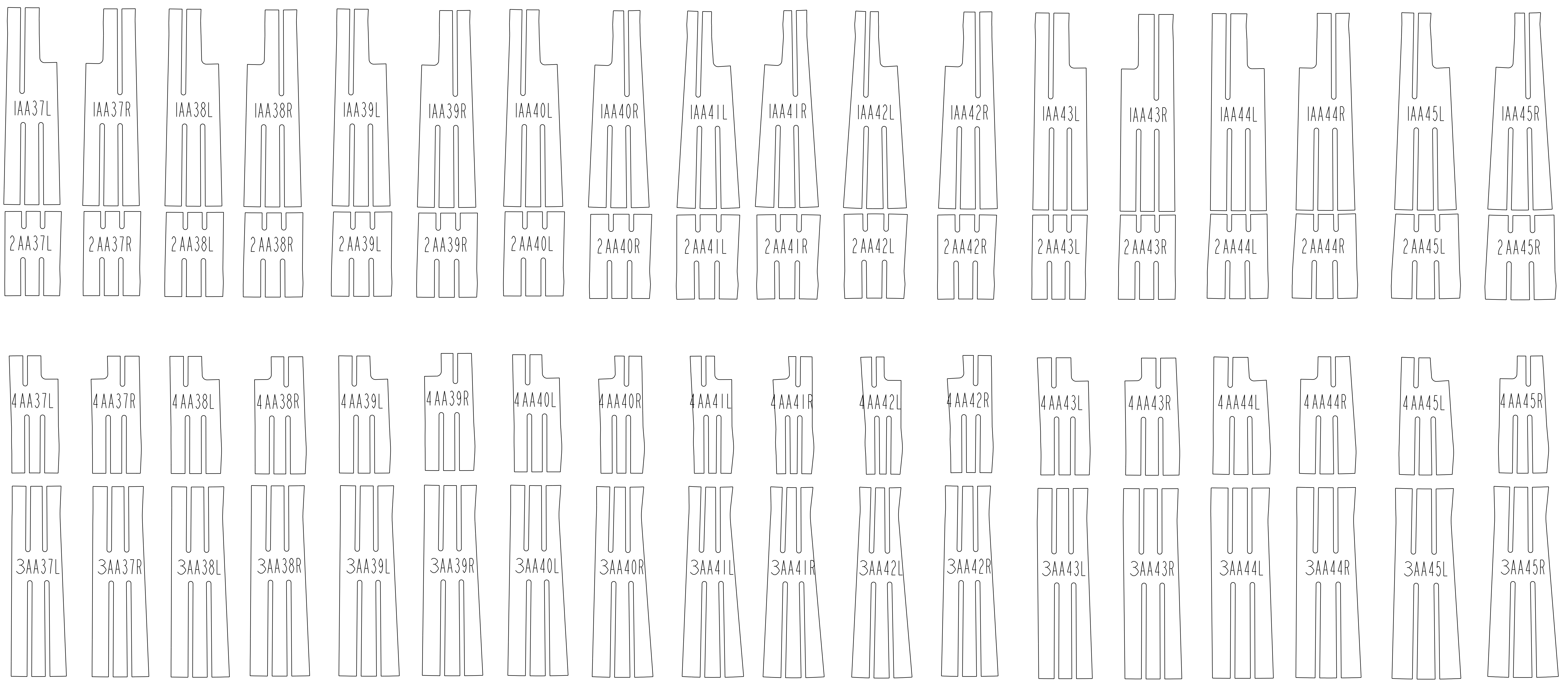

ISOMETRIC VIEW
 SCALE 1.00

**RELEASED FOR
 FABRICATION / INSTALLATION**
 PPPL Drafting:

| | | | | | | | |
|---|-------|------------|----|-----|----|------|-------|
| Oak Ridge National Laboratory managed for the DEPARTMENT OF ENERGY under U.S. GOVERNMENT contract DE-AC05-00OR22725 UT-BATTELLE, LLC, Oak Ridge, Tennessee | | | | | | | |
| UT-BATTELLE | | | | | | | |
| NATIONAL COMPACT STELLARATOR EXPERIMENT MODULAR COIL TYPE-A SIDE-A CLADDING AND CHILL PLATES FLAT PATTERN LAYOUT | | | | | | | |
| VERSION NO. | PLANT | BLDG | FL | SHT | OF | TYPE | CLASS |
| 13 | X-10 | 5700 | 3 | 6 | 12 | S | U |
| RELEASE LEVEL | | REV | | | | | |
| Fabrication | | SE142A-252 | | | | | |
| | | | | | | | 0 |

SE142A-252

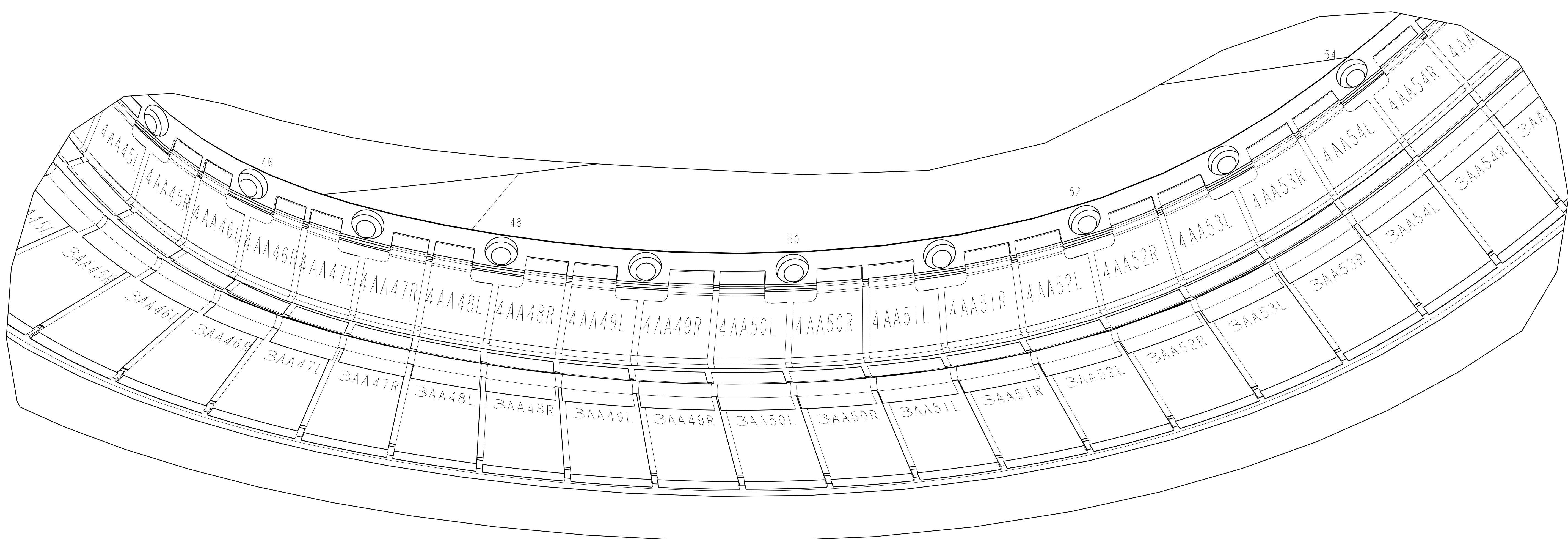
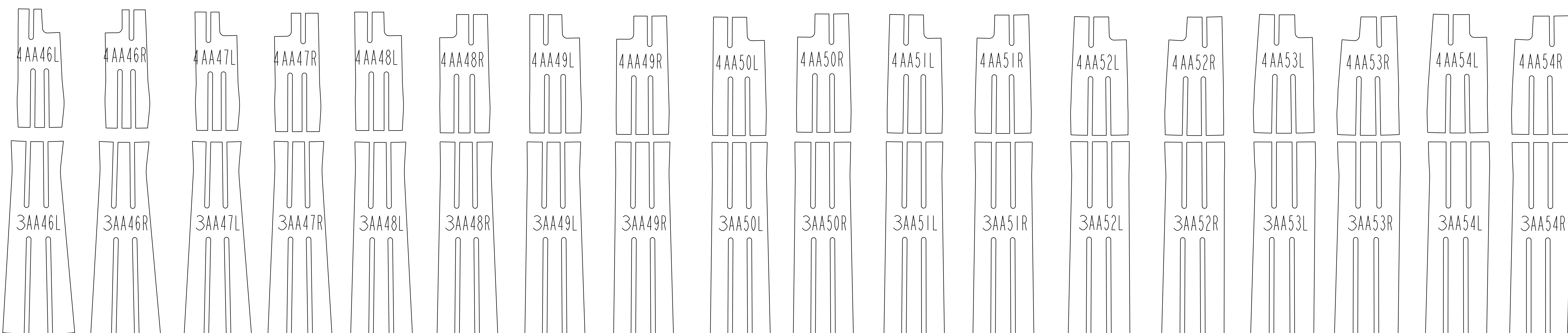
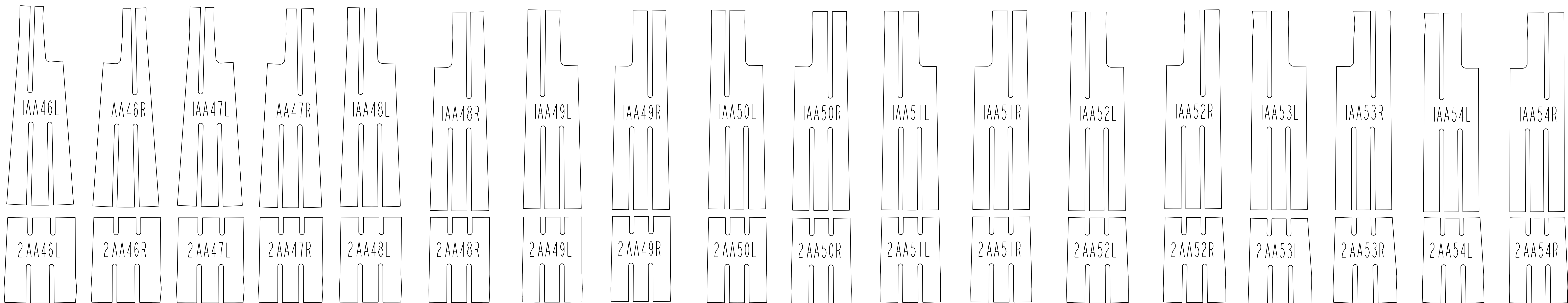

ISOMETRIC VIEW
 SCALE 1.00

**RELEASED FOR
 FABRICATION / INSTALLATION**
 PPPL Drafting:

| | | | | | | | |
|--|-------|---|----|--------|------|-------|--|
| UT-BATTELLE | | Oak Ridge National Laboratory managed for the DEPARTMENT OF ENERGY under U.S. GOVERNMENT contract DE-AC05-00OR22725 UT-BATTELLE, LLC, Oak Ridge, Tennessee | | | | | |
| PROJECT NAME | | | | | | | |
| NATIONAL COMPACT STELLARATOR EXPERIMENT | | | | | | | |
| MODULAR COIL TYPE-A | | | | | | | |
| SIDE-A CLADDING AND CHILL PLATES | | | | | | | |
| FLAT PATTERN LAYOUT | | | | | | | |
| VERSION NO. | PLANT | BLDG | FL | SHT OF | TYPE | CLASS | |
| 13 | X-10 | 5700 | 3 | 7 | 12 | S | |
| RELEASE LEVEL | | SE142A-252 | | | | REV | |
| Fabrication | | | | | | 0 | |

SE142A-252

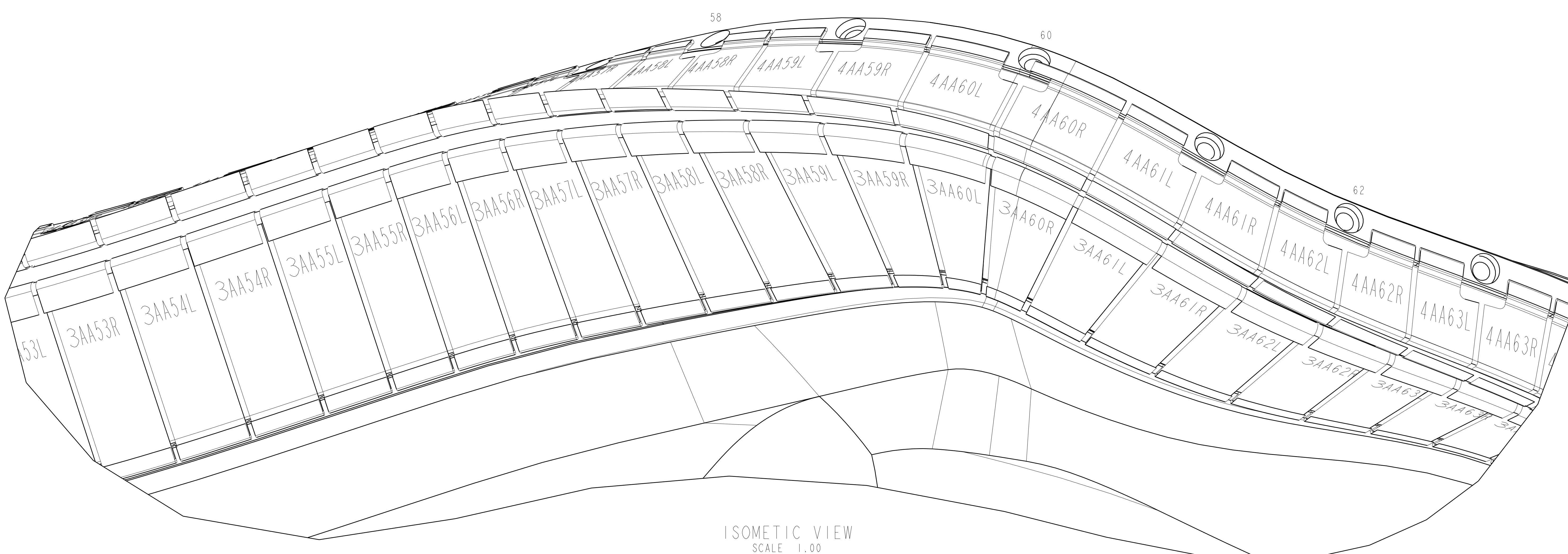
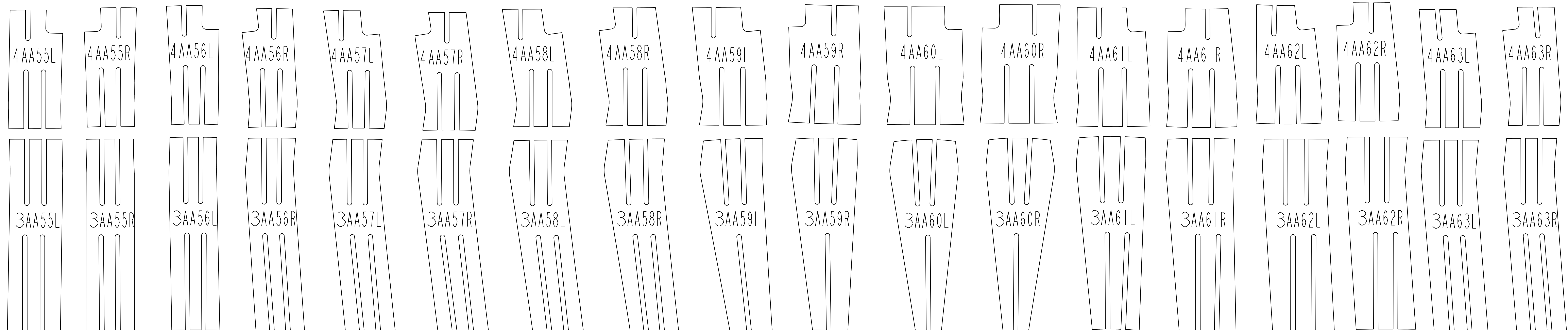
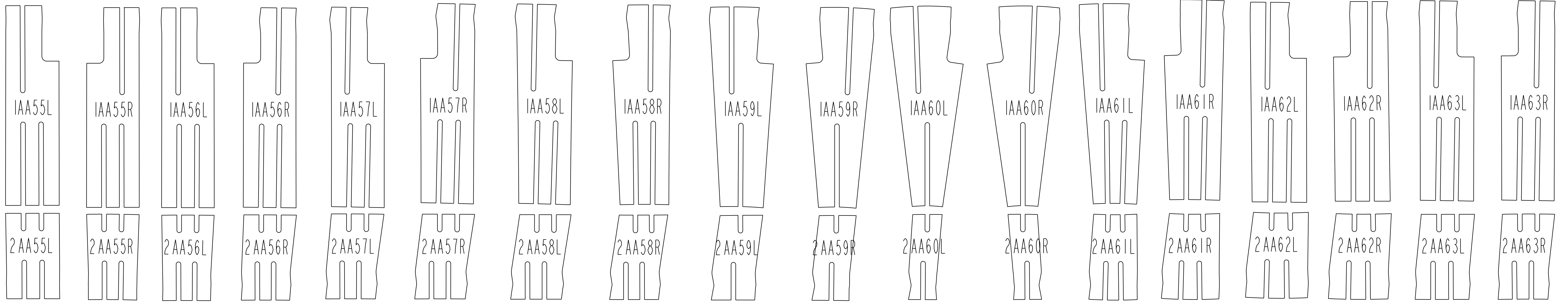

**RELEASED FOR
FABRICATION / INSTALLATION**
PPPL Drafting:

| | | | | | | |
|---|-------|------------|----|--------|------|-------|
| Oak Ridge National Laboratory managed for the DEPARTMENT OF ENERGY under U.S. GOVERNMENT contract DE-AC05-00OR22725 UT-BATTELLE, LLC, Oak Ridge, Tennessee | | | | | | |
| UT-BATTELLE NATIONAL COMPACT STELLARATOR EXPERIMENT MODULAR COIL TYPE-A SIDE-A CLADDING AND CHILL PLATES FLAT PATTERN LAYOUT | | | | | | |
| VERSION NO. | PLANT | BLDG | FL | SHT OF | TYPE | CLASS |
| 13 | X-10 | 5700 | 3 | 8 | 12 | S U |
| RELEASE LEVEL | | SEI42A-252 | | REV | | |
| Fabrication | | | | 0 | | |

H
G
F
E
D
C
B
A

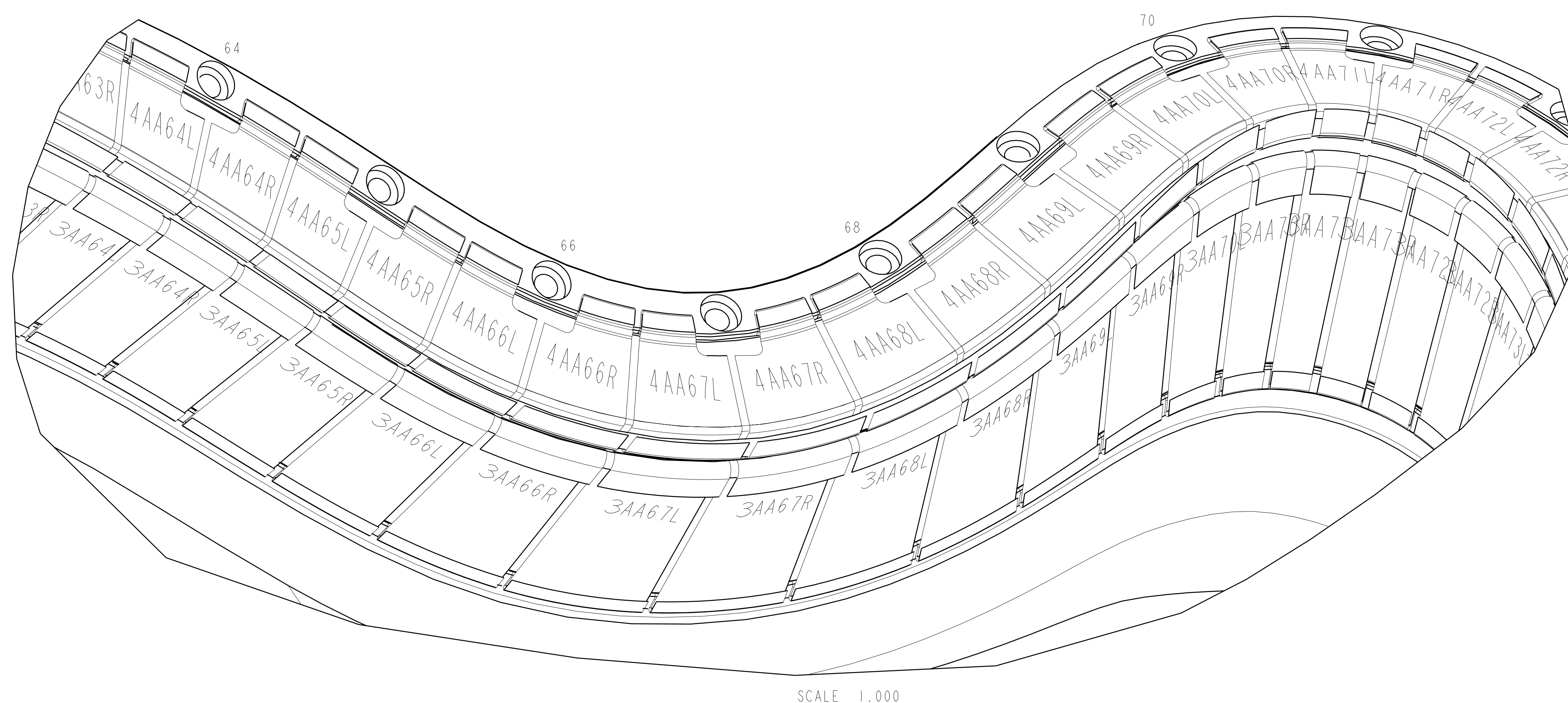
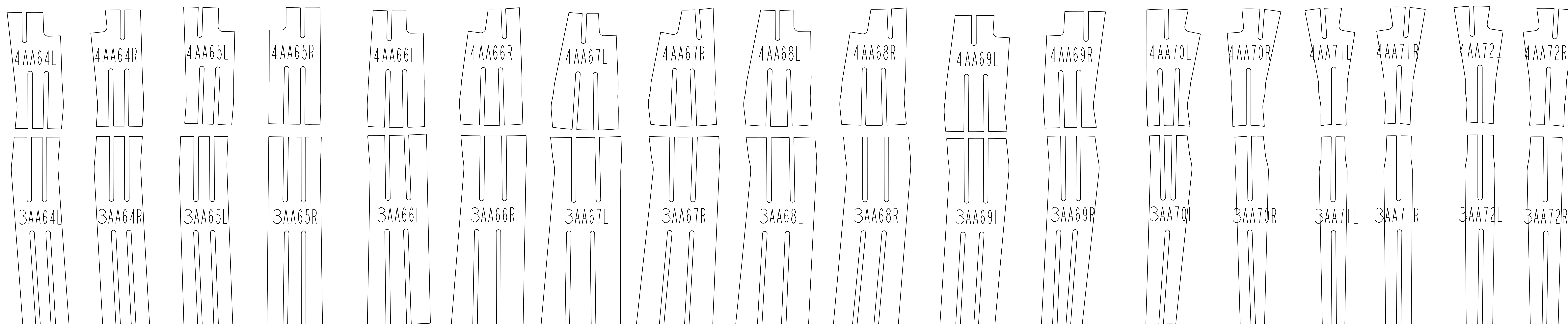
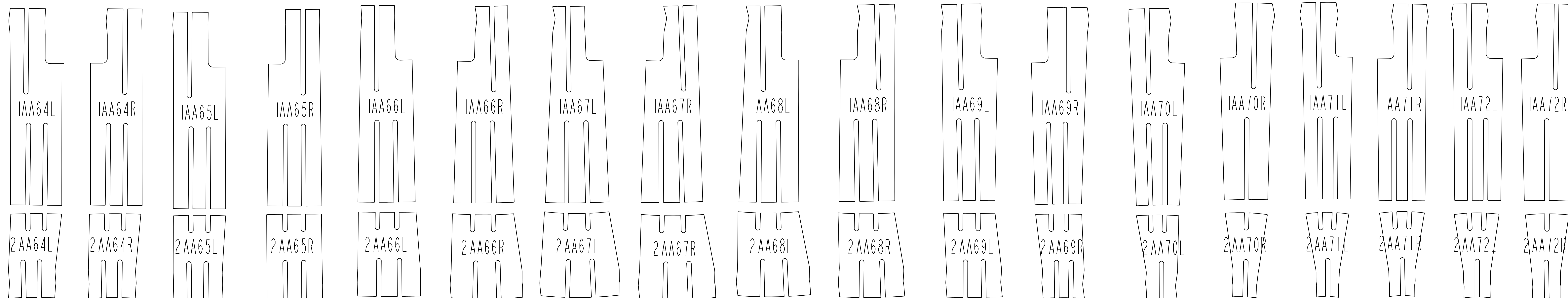

**RELEASED FOR
FABRICATION / INSTALLATION**
PPPL Drafting:

| | | | | | | |
|--|-------|------------|----|--------|------|-------|
| Oak Ridge National Laboratory managed for the DEPARTMENT OF ENERGY under U.S. GOVERNMENT contract DE-AC05-00OR22725 UT-BATTELLE, LLC., Oak Ridge, Tennessee | | | | | | |
| UT-BATTELLE | | | | | | |
| NATIONAL COMPACT STELLARATOR EXPERIMENT MODULAR COIL TYPE-A SIDE-A CLADDING AND CHILL PLATES FLAT PATTERN LAYOUT | | | | | | |
| VERSION NO. | PLANT | BLDG | FL | SHT OF | TYPE | CLASS |
| 13 | X-10 | 5700 | 3 | 9 | 12 | S |
| RELEASE LEVEL | | SE142A-252 | | REV | | U |
| Fabrication | | | | | | 0 |

SE142A-252

A

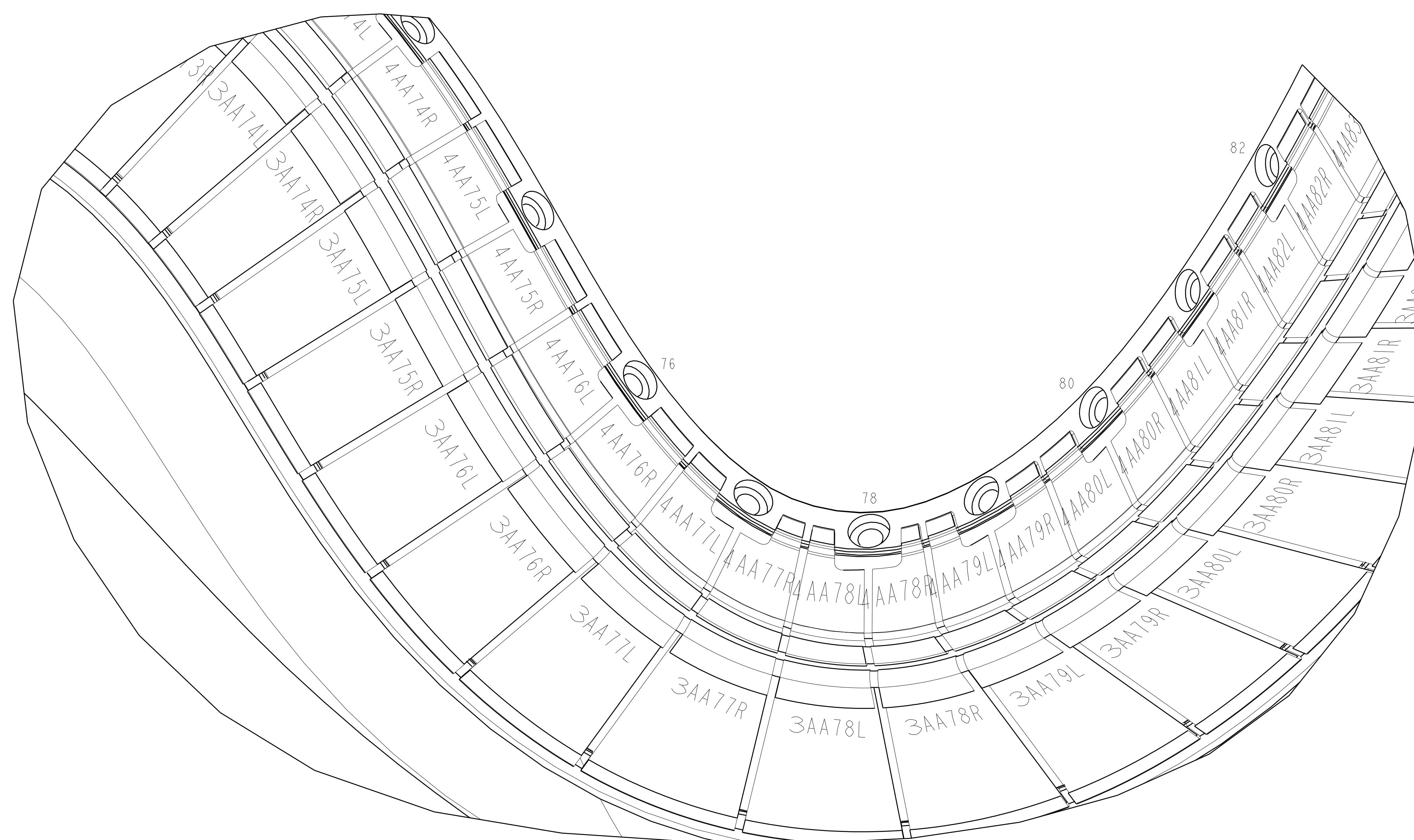
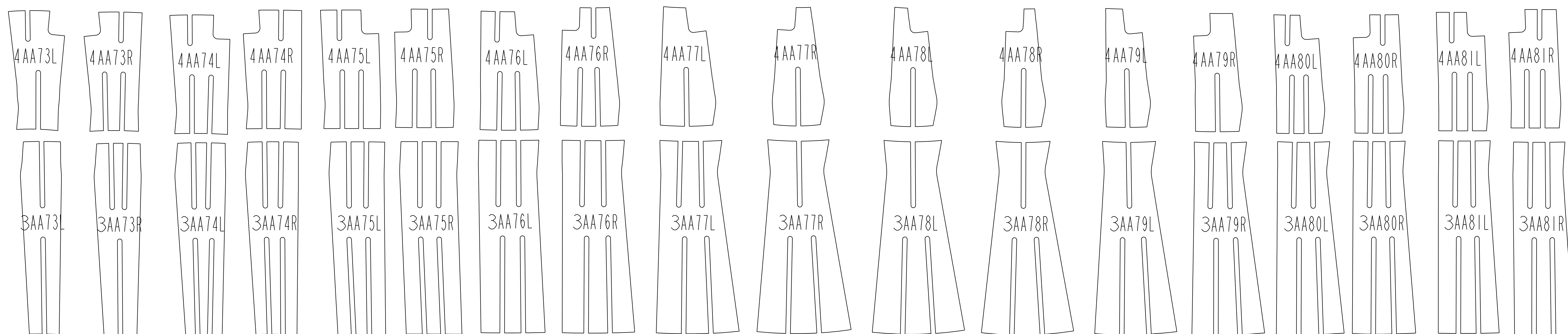
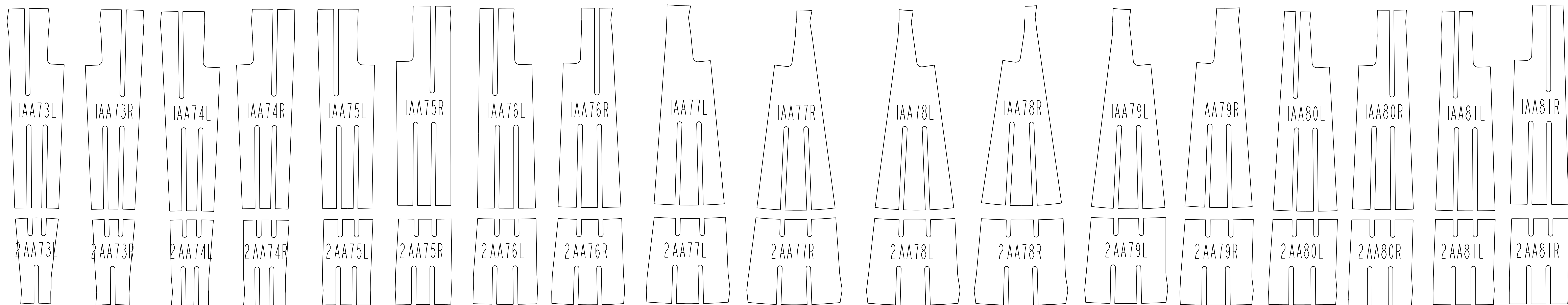

**RELEASED FOR
 FABRICATION / INSTALLATION**
 PPPL Drafting:

| | | | | | | | |
|--|---------------|---|---------|--------------|-----------|------------|--|
| UT-BATTELLE | | Oak Ridge National Laboratory managed for the DEPARTMENT OF ENERGY under U.S. GOVERNMENT contract DE-AC05-00OR22725 UT-BATTELLE, LLC, Oak Ridge, Tennessee | | | | | |
| NATIONAL COMPACT STELLARATOR EXPERIMENT | | | | | | | |
| MODULAR COIL TYPE-A SIDE-A CLADDING AND CHILL PLATES FLAT PATTERN LAYOUT | | | | | | | |
| VERSION NO. 13 | PLANT X-10 | BLDG 5700 | FL 3 | SHT OF 10 | TYPE S | CLASS U | |
| RELEASE LEVEL Fabrication | | SE142A-252 | | | REV 0 | | |

SE142A-252
 A

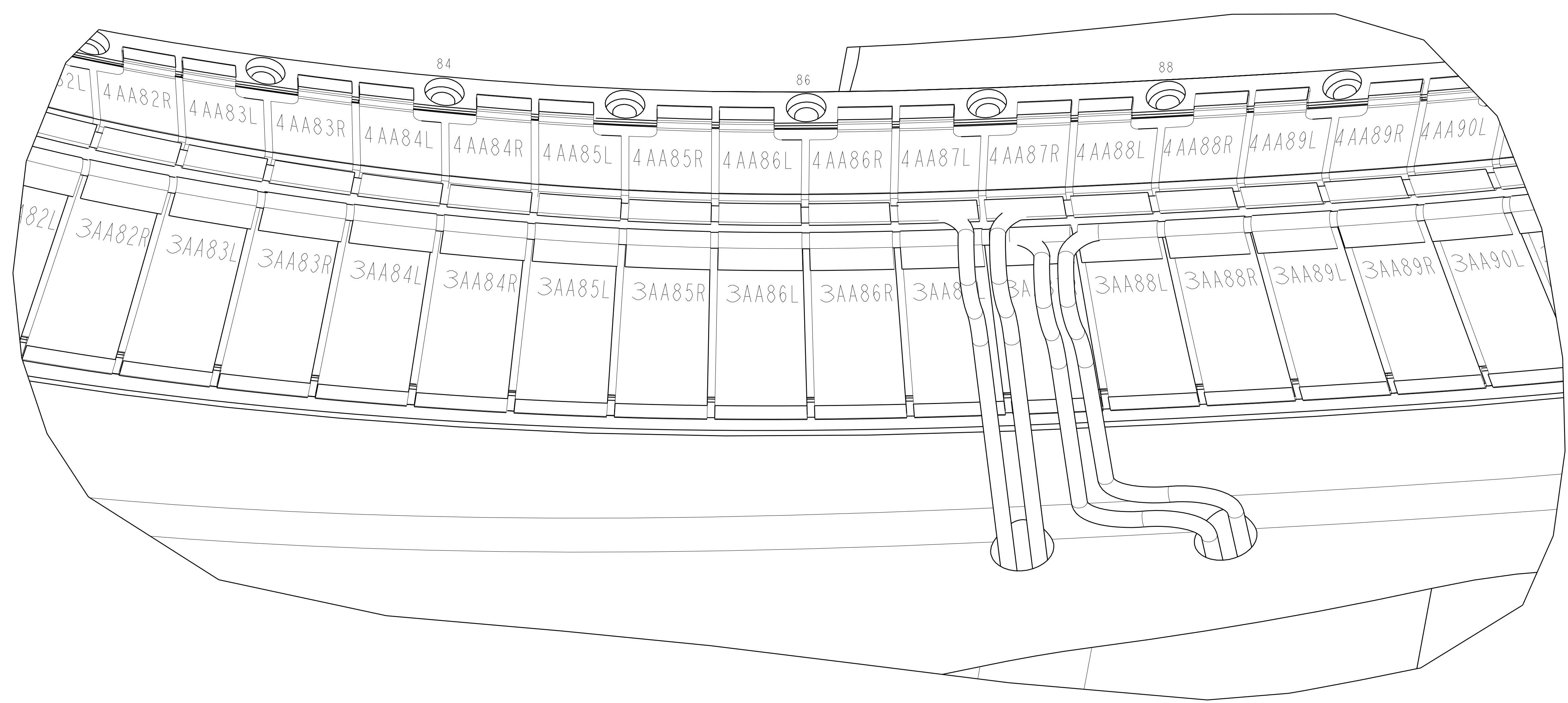
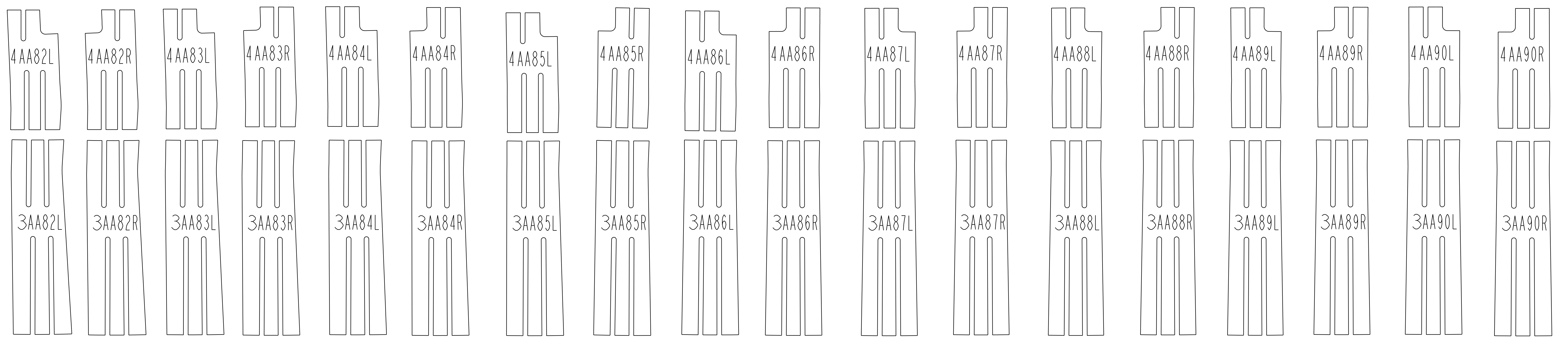
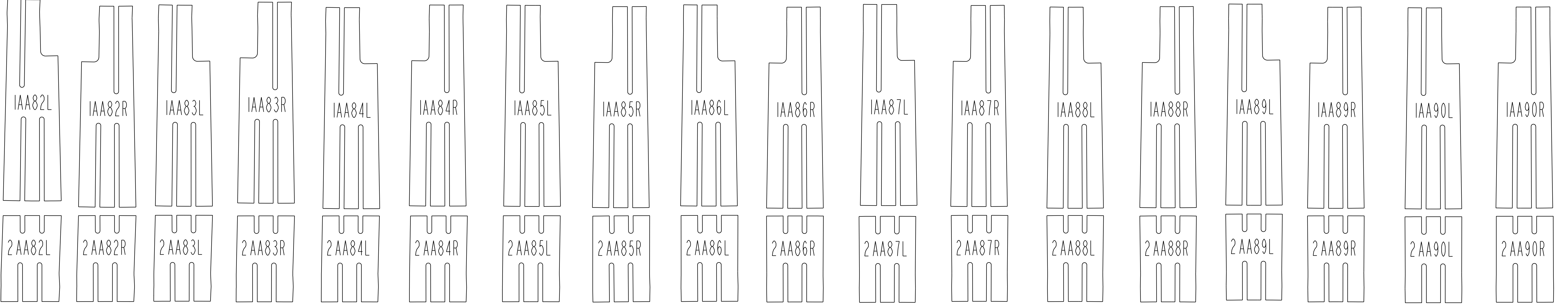

ISOMETRIC VIEW
SCALE 1.00

**RELEASED FOR
FABRICATION / INSTALLATION**
PPPL Drafting:

| | | | | | | | |
|--|---------------|---|---------|--------------|--------------|------------|--|
| UT-BATTELLE | | Oak Ridge National Laboratory managed for the DEPARTMENT OF ENERGY under U.S. GOVERNMENT contract DE-AC05-00OR22725 UT-BATTELLE, LLC, Oak Ridge, Tennessee | | | | | |
| NATIONAL COMPACT STELLARATOR EXPERIMENT | | | | | | | |
| MODULAR COIL TYPE-A SIDE-A CLADDING AND CHILL PLATES FLAT PATTERN LAYOUT | | | | | | | |
| VERSION NO. 13 | PLANT X-10 | BLDG 5700 | FL 3 | SHT OF 11 | TYPE 12 S | CLASS U | |
| RELEASE LEVEL Fabrication | | SE142A-252 | | | | REV 0 | |

H
G
F
E
D
C
B
A

SE142A-252

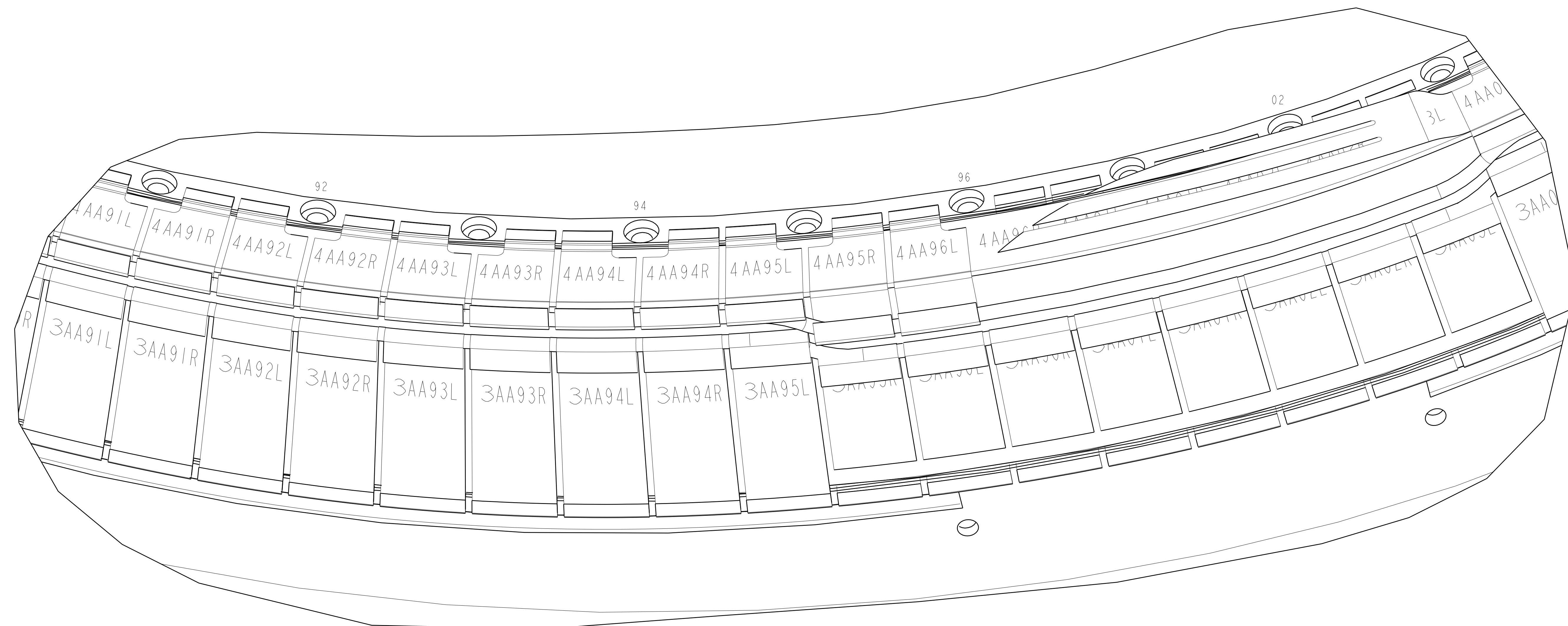
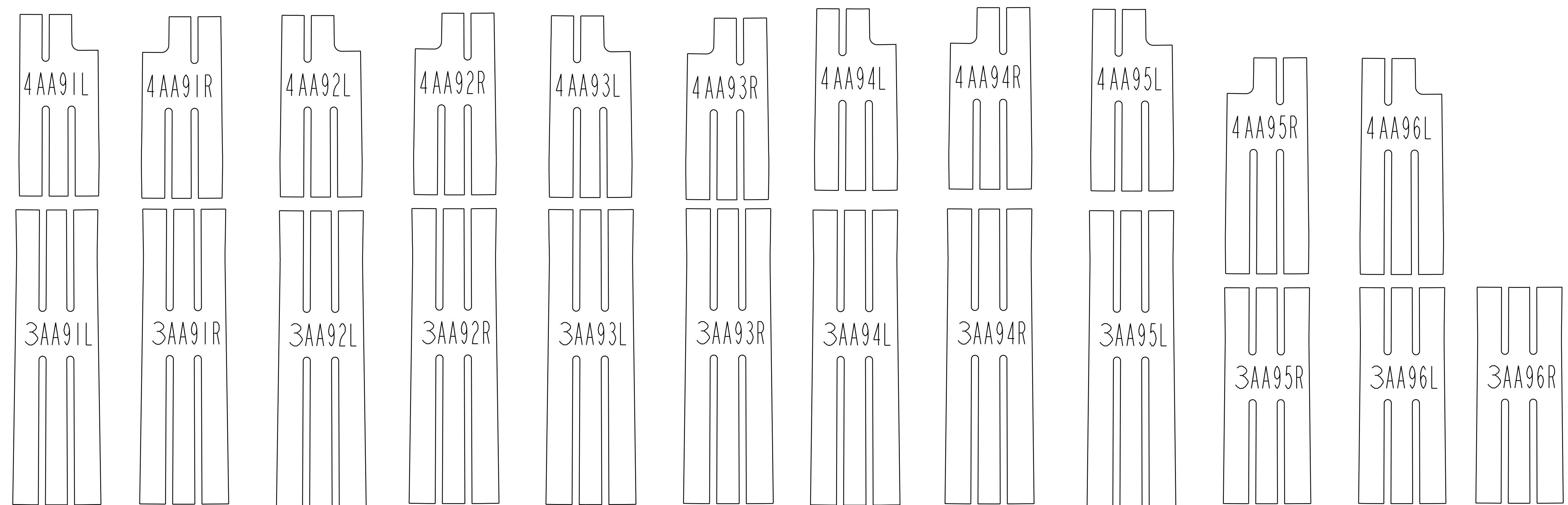
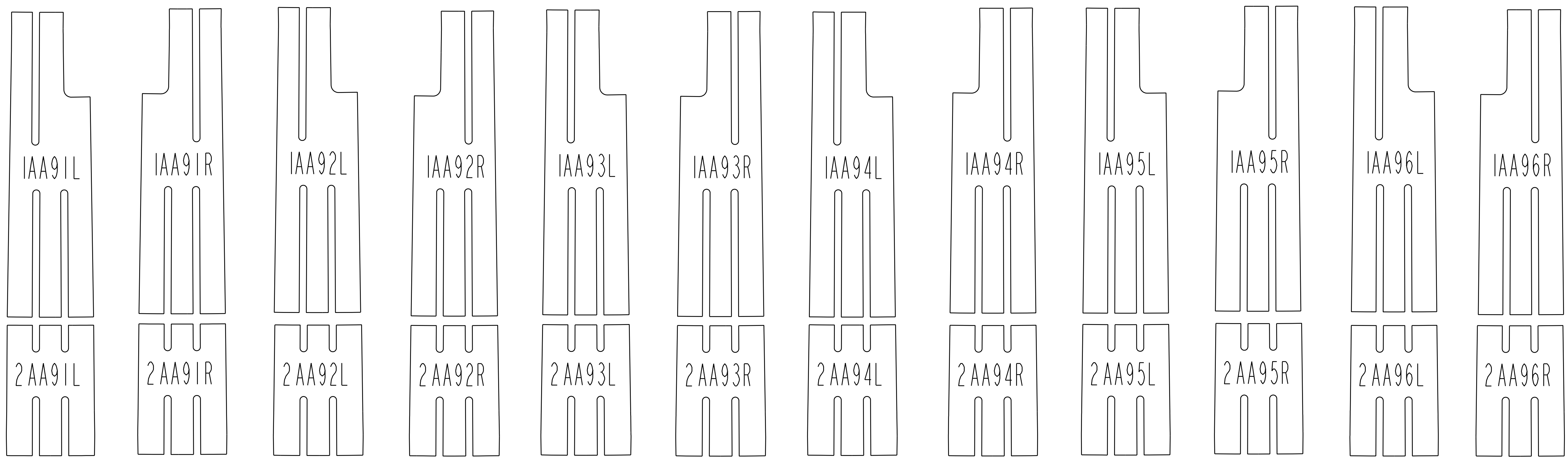

ISOMETRIC VIEW
SCALE 1.00

**RELEASED FOR
FABRICATION / INSTALLATION**
PPPL Drafting:

| | | | | | | | |
|--|-------|---|----|--------|------|-------|--|
| UT-BATTELLE | | Oak Ridge National Laboratory managed for the DEPARTMENT OF ENERGY under U.S. GOVERNMENT contract DE-AC05-00OR22725 UT-BATTELLE, LLC, Oak Ridge, Tennessee | | | | | |
| PROJECT NAME | | | | | | | |
| NATIONAL COMPACT STELLARATOR EXPERIMENT | | | | | | | |
| MODULAR COIL TYPE-A | | | | | | | |
| SIDE-A CLADDING AND CHILL PLATES | | | | | | | |
| FLAT PATTERN LAYOUT | | | | | | | |
| VERSION NO. | PLANT | BLDG | FL | SHT OF | TYPE | CLASS | |
| 13 | X-10 | 5700 | 3 | 12 | 12 S | U | |
| RELEASE LEVEL | | REV | | | | | |
| Fabrication | | SE142A-252 0 | | | | | |

H
G
F
E
D
C
B
A

H
G
F
E
D
C
B
A