

NO.	REVISION	BY	CH	SUP	APPROVED	DATE

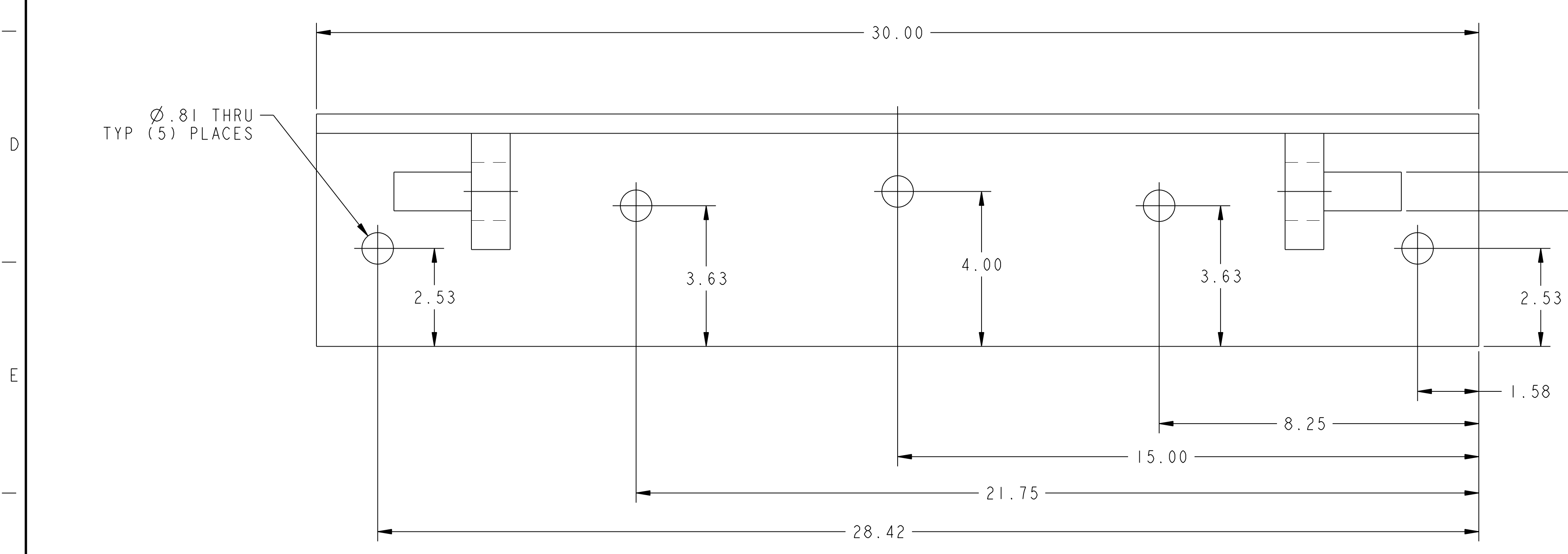

01 ASSEMBLY SUPPORT RING CLEVIS MOUNTING PLATE WELDMENT

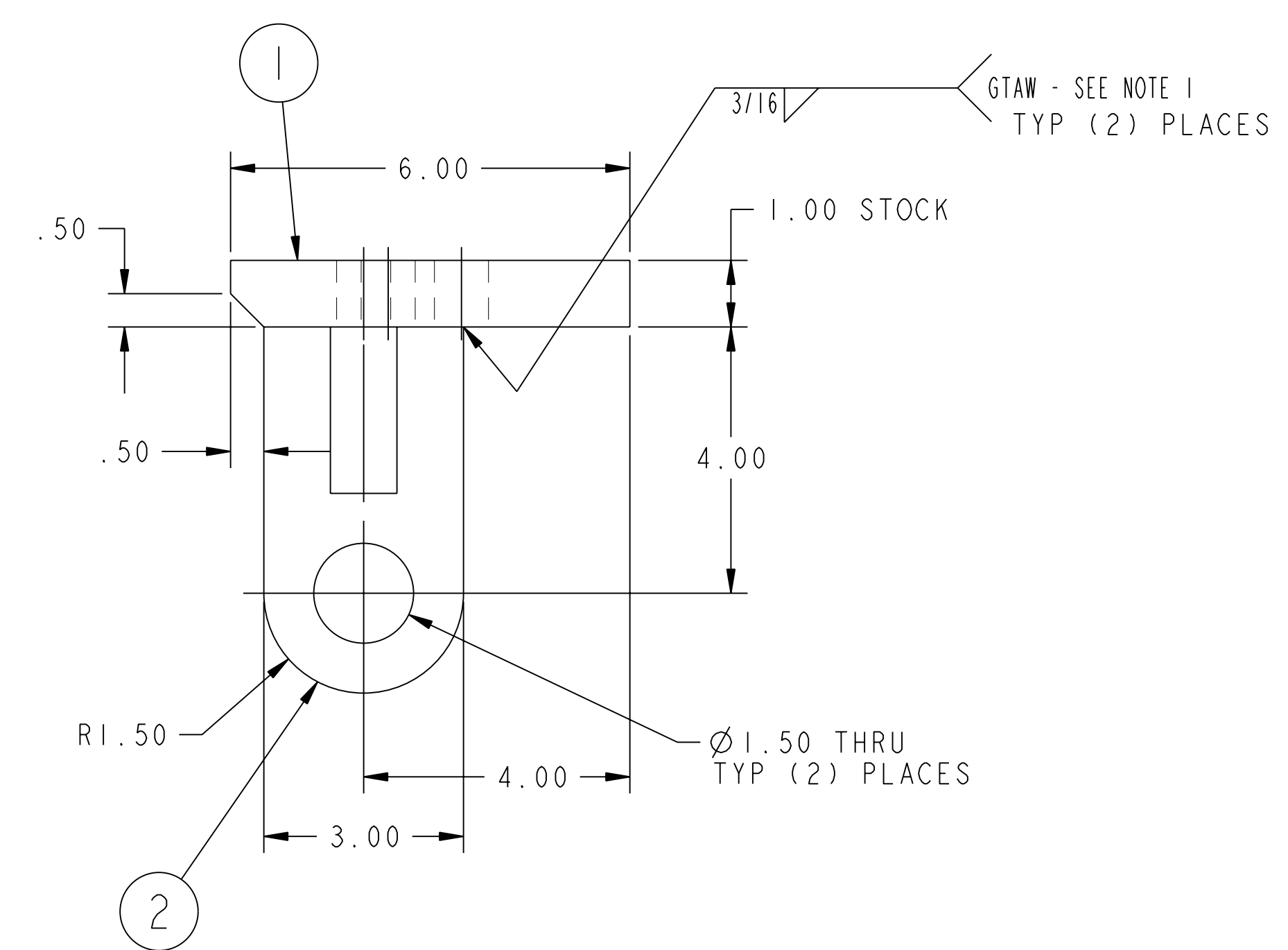
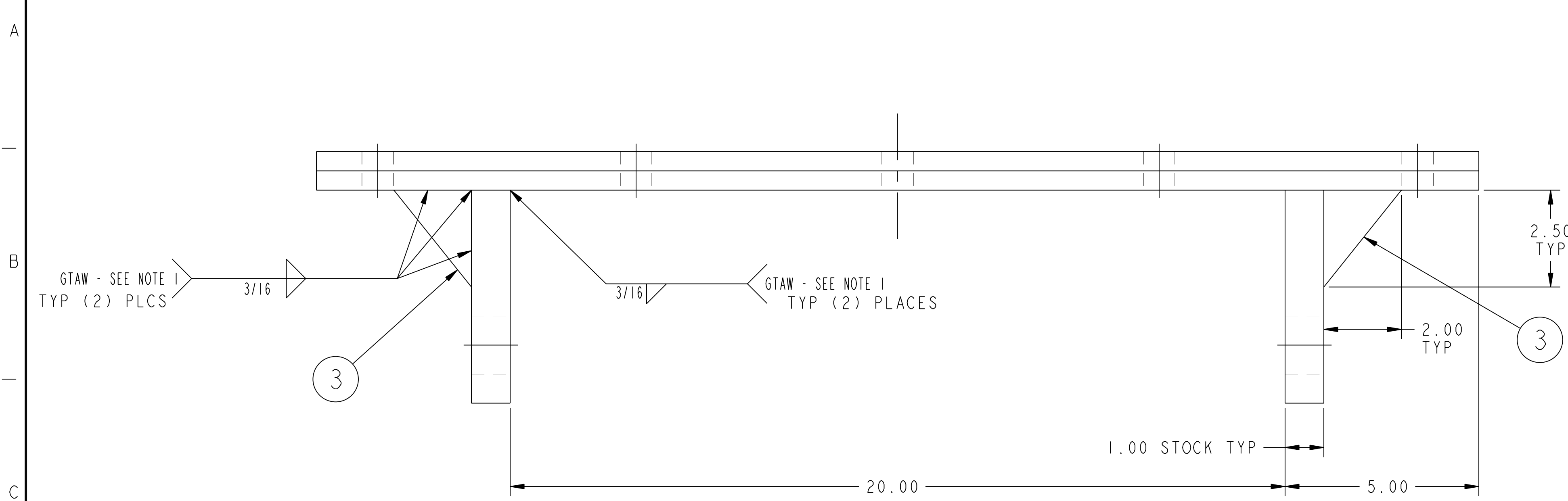
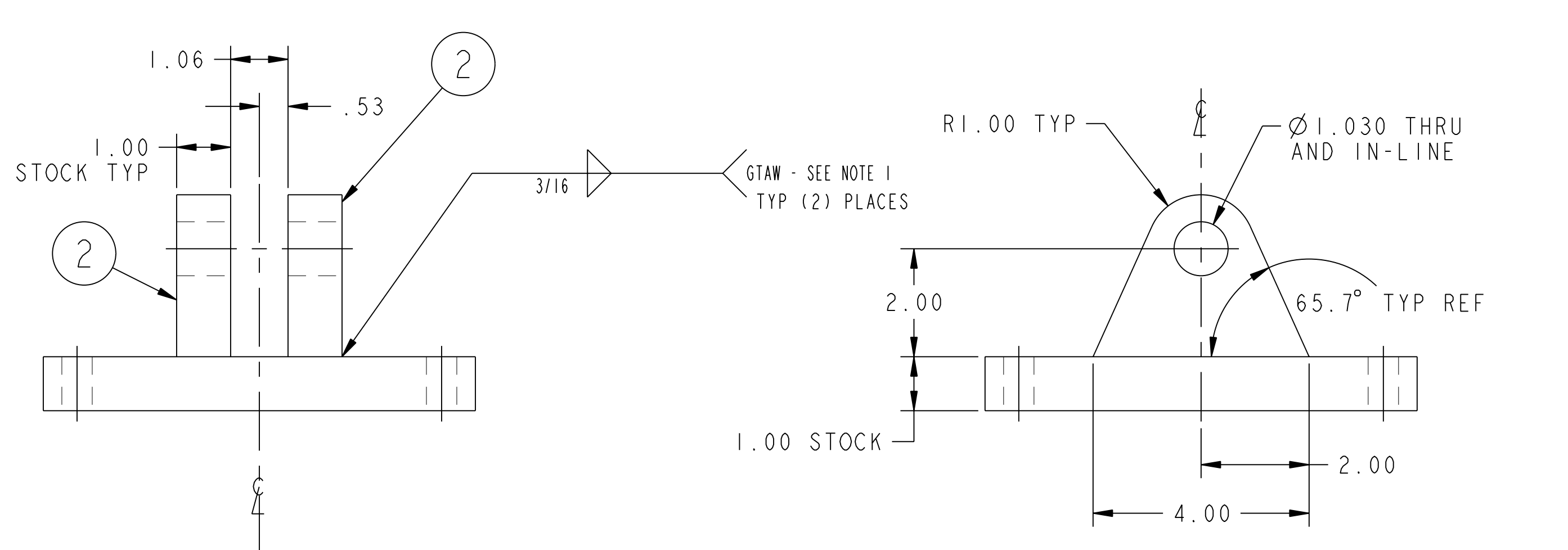
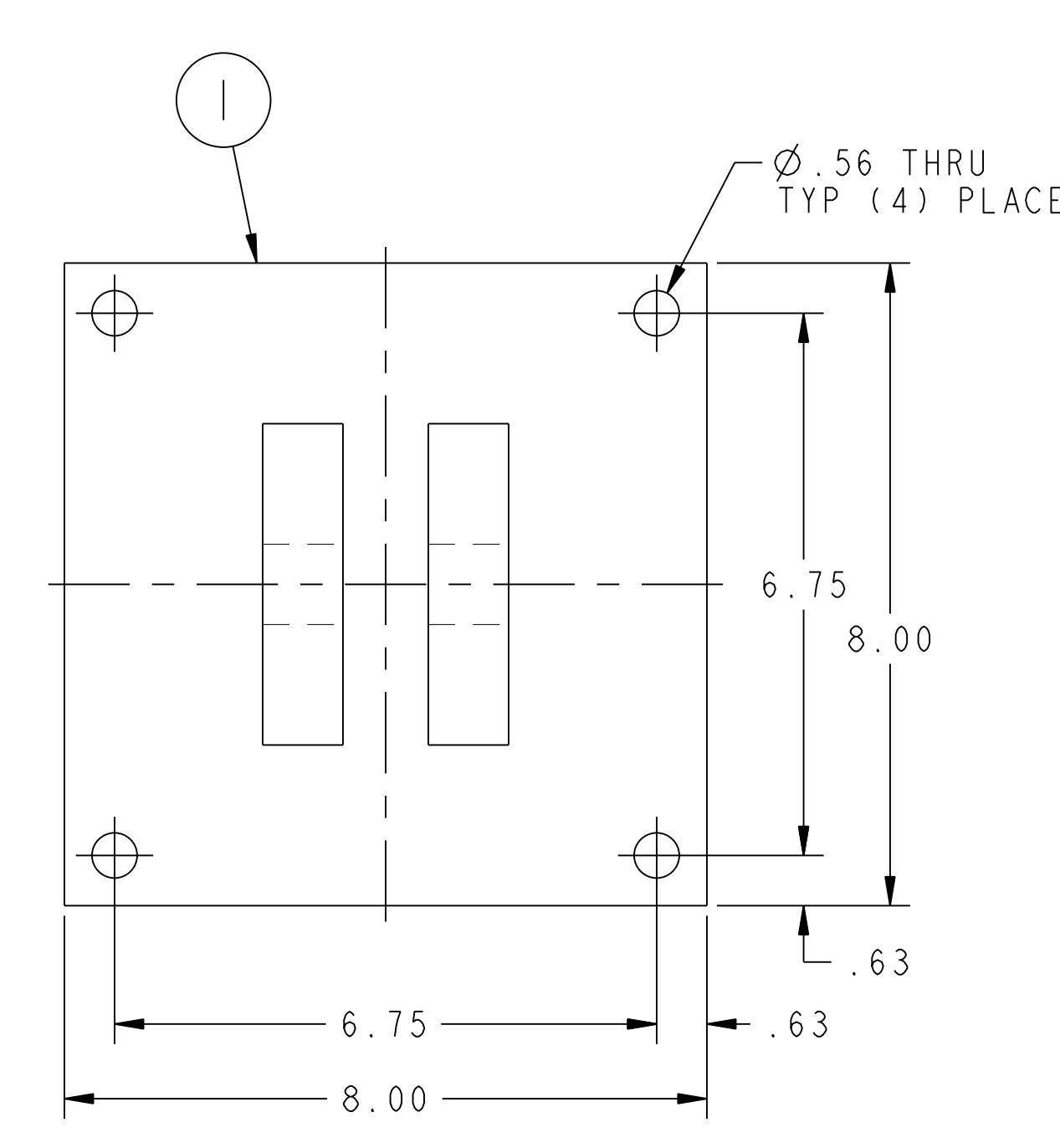

02 ASSEMBLY SUPPORT FRAME CLEVIS MOUNTING PLATE WELDMENT

NOTES

1. WELDING SHALL BE PERFORMED IN ACCORDANCE WITH THE REQUIREMENTS OF AWS D1.1 AND/OR PPPL PROCEDURE EM-002. VISUAL WELD INSPECTION SHALL BE PERFORMED IN ACCORDANCE WITH THE ACCEPTANCE CRITERIA OF AWS D1.1 Section 6.
2. ALL HOLES TO BE MACHINED AFTER ALL WELDING IS COMPLETE.

**RELEASED FOR
FABRICATION / INSTALLATION**
PPPL Drafting:

2	5	THIS DWG	CLEVIS PLATE	ASTM A36	4	
1	4	THIS DWG	MOUNTING PLATE	ASTM A36	2	
2	3	THIS DWG	GUSSET	ASTM A36	2	
2	2	THIS DWG	VERTICAL SUPPORT	ASTM A36	2	
1	1	THIS DWG	BASE PLATE	ASTM A36	1	
		THIS DWG	SUPPORT FRAME CLEVIS MOUNTING PLATE WELDMENT		2	
		THIS DWG	SUPPORT RING CLEVIS MOUNTING PLATE WELDMENT		1	
02	01	PART	DRAWING NO.	NOMENCLATURE OR DESCRIPTION	MATERIAL	QTY REQD
ASSY	ASSY	NO.				

COMPUTER GENERATED DRAWING DRAWING CHANGES NOT PERMITTED Pro E	CENTRAL FILES: UNLESS OTHERWISE SPECIFIED DIMENSIONS ARE IN INCHES MACHINE SURFACES BREAK SHARP EDGES .005/.020	PRINCETON PLASMA PHYSICS LABORATORY PRINCETON UNIVERSITY NATIONAL COMPACT STELLARATOR EXPERIMENT MODULAR COIL ASSEMBLY WINDING RING ASSEMBLY SUPPORT FRAME CLEVIS WELDMENTS			
WEIGHT 57.7 lbs	DO NOT VERIFY INFORMATION BY SCALING DRAWING	TOLERANCES NON-CUMULATIVE DECIMAL-INCH FRACTIONS .XX ±.005 .XXX ±.005 ANGULAR ±.0°-15'	DSN: L. MORRIS 8-30-04 CHK: S. RAFTOPOULOS 8-30-04 ENGR: J. CHRZANOWSKI 8-30-04 SUPV: J. SIEGEL 8-30-04	DRAWING NO: SE144-053	
MODEL NAME SE144-053-01	WELDING ENGINEER R. PARSELLS 8-30-04	NEXT ASSEMBLY		SHEET 1 OF 1 REV 0	

RELEASE LEVEL:
DWG VERSION NO:

NCSX-SE144-053