

| | | | | | | |
|-----|----------|----|----|-----|----------|------|
| NO. | REVISION | BY | CH | SUP | APPROVED | DATE |
| | | | | | | |

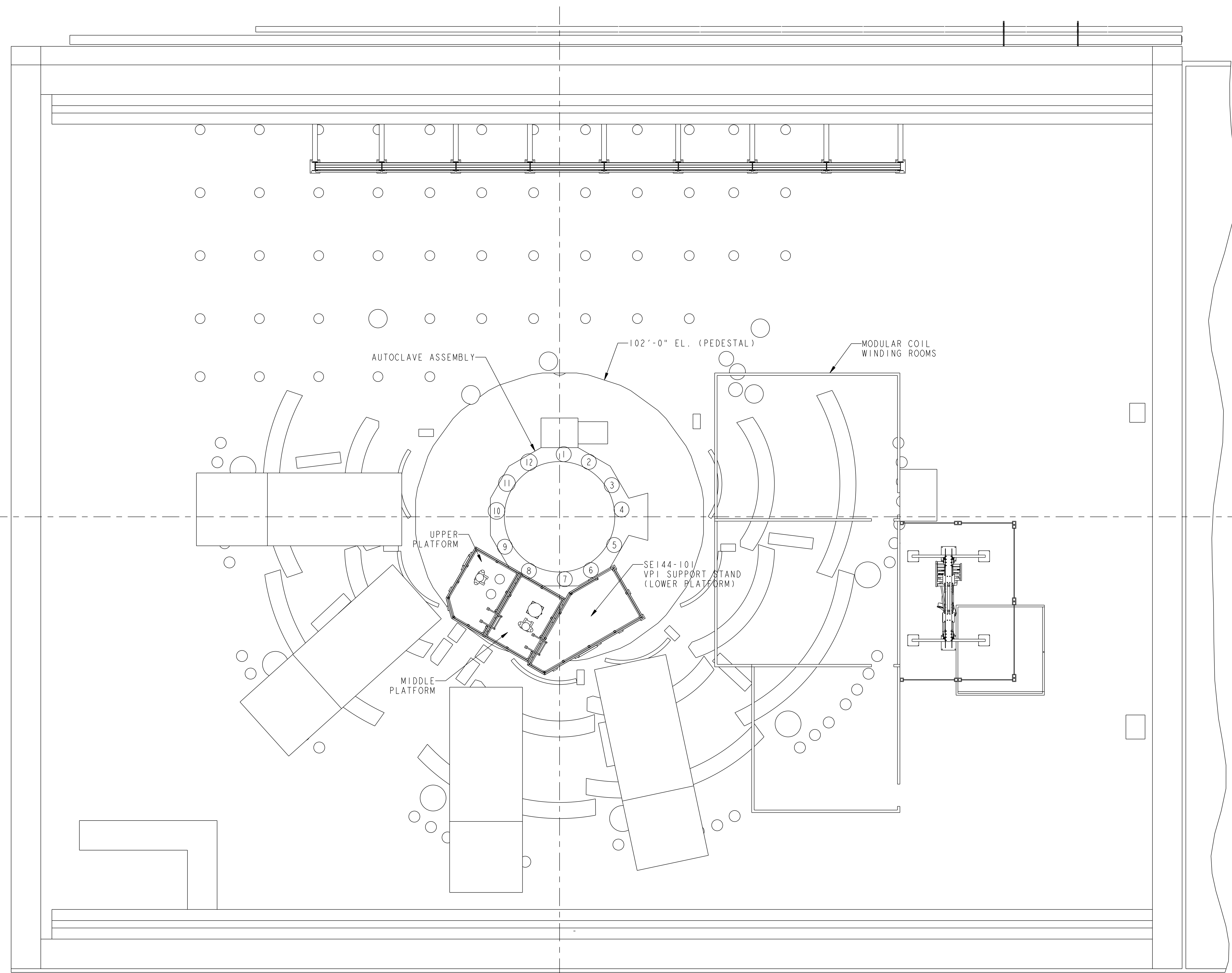
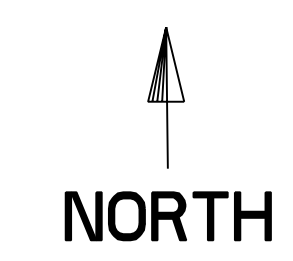

**RELEASED FOR
FABRICATION / INSTALLATION**
PPPL Drafting:

PLAN VIEW - MODULAR COIL WINDING FACILITY

NOTE

VPI SUPPORT STAND ASSEMBLY (SEI144-101) IS TO BE LOCATED ON THE PEDESTAL (102'-0" EL.) SUCH THAT THE LOWER PLATFORM IS ADJACENT TO THE AUTOCLAVE CATWALK SEGMENT #6 (AS INDICATED) AND THE MIDDLE PLATFORM IS ADJACENT TO THE AUTOCLAVE CATWALK SEGMENT #8. CLEARANCE IS TO BE PROVIDED BETWEEN THE PLATFORMS AND AUTOCLAVE IN SUCH A MANNER AS TO PREVENT ANY POSSIBLE OVERHANG OR INTERFERENCE BETWEEN THE TWO ASSEMBLIES.

WELDED

| | | | | | | |
|---|--------------------------|---------------------|---|--|---|----------------------------------|
| RELEASE LEVEL: *** DWG VERSION NO: *** | MODEL NAME SEI144-100 | WELDING ENGINEER | COMPUTER GENERATED DRAWING MANUAL CHANGES NOT PERMITTED Pro E | CENTRAL FILES: UNLESS OTHERWISE SPECIFIED | PRINCETON PLASMA PHYSICS LABORATORY PRINCETON UNIVERSITY NATIONAL COMPACT STELLARATOR EXPERIMENT | |
| | | | DO NOT VERIFY INFORMATION BY SCALING DRAWING | DIMENSIONS ARE IN INCHES MACHINE SURFACES BREAK SHARP EDGES .005/.020 | MODULAR COIL WINDING FACILITY WINDING FACILITY LAYOUT VPI SUPPORT STAND LOCATION/INSTALLATION | |
| | | | NEXT ASSEMBLY | TOLERANCES NON-CUMULATIVE DECIMAL-INCH FRACTIONS .X +/- .100 0°-120° +/- .010 .XX +/- .030 120°-120° +/- .010 .XXX +/- .005 120°-120° +/- .010 ANGULAR +/- .0°-15° OVER 120° +/- .12° | DSN: L. MORRIS | DRAWING NO: SEI144-100 |
| | | | | | CHK: S. RAFTOPOULOS | |
| | | | | | ENGR: J. CHRZANOWSKI | |
| | | | | | SUPV: J. SIEGEL | SHEET 1 OF 1 REV 0 |

NCSX-SEI144-100