

NO.	REVISION	BY	CH	SUP	APPROVED	DATE
1	REVISED PER ECN-4853	LM	SR	JS	S. RAFTOPOULOS	4-22-04

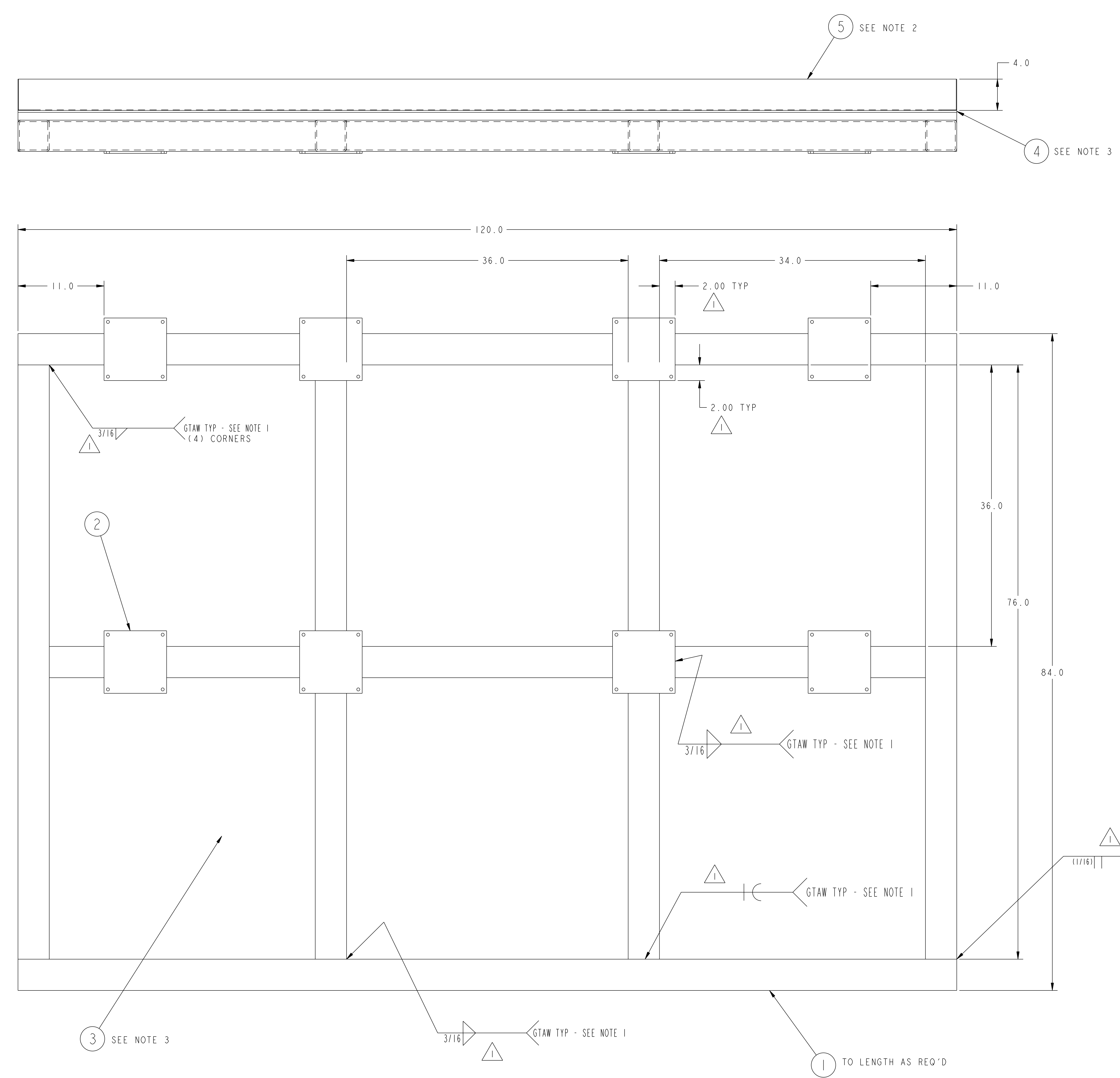

- NOTES**
1. WELDING SHALL BE PERFORMED IN ACCORDANCE WITH THE REQUIREMENTS OF AWS D1.1 Section 6 AND PPPL PROCEDURE EM-002. VISUAL WELD INSPECTION SHALL BE PERFORMED IN ACCORDANCE WITH THE ACCEPTANCE CRITERIA OF AWS D1.1 Section 6.
  2. KICK ANGLE, PART 5, TO BE FORMED IN SHOP AND HOLES PRE-PUNCHED FOR MOUNTING TO PLYWOOD THROUGH MASONITE.
  3. SELF-TAPPING SCREWS TO BE USED TO SECURE PLYWOOD AND MASONITE PANELS TO SQUARE TUBE FRAMING.

**RELEASED FOR  
FABRICATION / INSTALLATION**  
PPPL Drafting:

BOTTOM VIEW

A/R	NO.	DRAWING NO.	NOMENCLATURE OR DESCRIPTION	MATERIAL	QTY REQD
A/R	5	THIS DWG	4" X 2" X 14 GAUGE FORMED ANGLE	ASTM A569	A/R
A/R	4	THIS DWG	48" X 96" X 1/4" MASONITE		A/R
A/R	3	THIS DWG	48" X 96" X 1" PLYWOOD		A/R
	8	SE144-109-5	BASE PLATE	SEE DWG	8
A/R	1	THIS DWG	4" X 4" X 3/16" WALL SQ. STRUCT. TUBE	ASTM A36	A/R
			MIDDLE PLATFORM WELDMENT		1

COMPUTER GENERATED DRAWING CHANGES NOT PERMITTED		CENTRAL FILES:		PRINCETON PLASMA PHYSICS LABORATORY	
Pro E		UNLESS OTHERWISE SPECIFIED		NATIONAL COMPACT STELLARATOR EXPERIMENT	
DO NOT VERIFY INFORMATION BY SCALING DRAWING		DIMENSIONS ARE IN INCHES MACHINE SURFACES		MODULAR COIL WINDING FACILITY	
		BREAK SHARP EDGES .005/.020		VPI SUPPORT STAND	
		TOLERANCES NON-CUMULATIVE		MIDDLE PLATFORM WELDMENT	
NEXT ASSEMBLY		DECIMAL-INCH FRACTIONS	DSN: L. MORRIS	DRAWING NO:	
		.XX +/- .010 0"-12" +/- .010	CHK: S. RAFTOPOULOS	SE144-107	
		.XX +/- .030 12"-120" +/- .010	ENGR: S. RAFTOPOULOS		
		.XX +/- .005 OVER 120" +/- .010	SUPV: J. SIEGEL	SHEET 1 OF 2 REV 1	

**RELEASE LEVEL: Fabrication**  
**DWG VERSION NO: 0**

WEIGHT  
717.6 lbs

MODEL NAME  
SE144-107

WELDING ENGINEER  
R. PARSELLS 4-22-04

NCSX-SE144-107

NO.	REVISION	BY	CH	SUP	APPROVED	DATE



TOP VIEW

**RELEASED FOR  
FABRICATION / INSTALLATION**  
PPPL Drafting:

FOR NOTES AND BILL OF MATERIAL SEE SHEET 1

**RELEASE LEVEL: Fabrication**  
**DWG VERSION NO: 0**

WEIGHT  
717.6 lbs  
MODEL NAME  
SE144-107

COMPUTER GENERATED DRAWING MANUAL CHANGES NOT PERMITTED Pro E	CENTRAL FILES: UNLESS OTHERWISE SPECIFIED	PRINCETON PLASMA PHYSICS LABORATORY PRINCETON UNIVERSITY <b>NATIONAL COMPACT STELLARATOR EXPERIMENT</b>	
DO NOT VERIFY INFORMATION BY SCALING DRAWING	DIMENSIONS ARE IN INCHES MACHINE SURFACES BREAK SHARP EDGES .005/.020	MODULAR COIL WINDING FACILITY VPI SUPPORT STAND MIDDLE PLATFORM WELDMENT	
NEXT ASSEMBLY	TOLERANCES NON-CUMULATIVE DECIMAL-INCH FRACTIONS .XX +/- .030 0°-120° +/- .120 .XXX +/- .005 72°-120° +/- .124 ANGULAR +/- .0°-15° OVER 120° +/- .122	DSN: L. MORRIS CHK: S. RAFTOPOULOS ENGR: S. RAFTOPOULOS SUPV: J. SIEGEL	DRAWING NO: <b>SE144-107</b> SHEET 2 OF 2 REV 1

NCSX-SE144-107