

NO.	REVISION	BY	CH	SUP	APPROVED	DATE

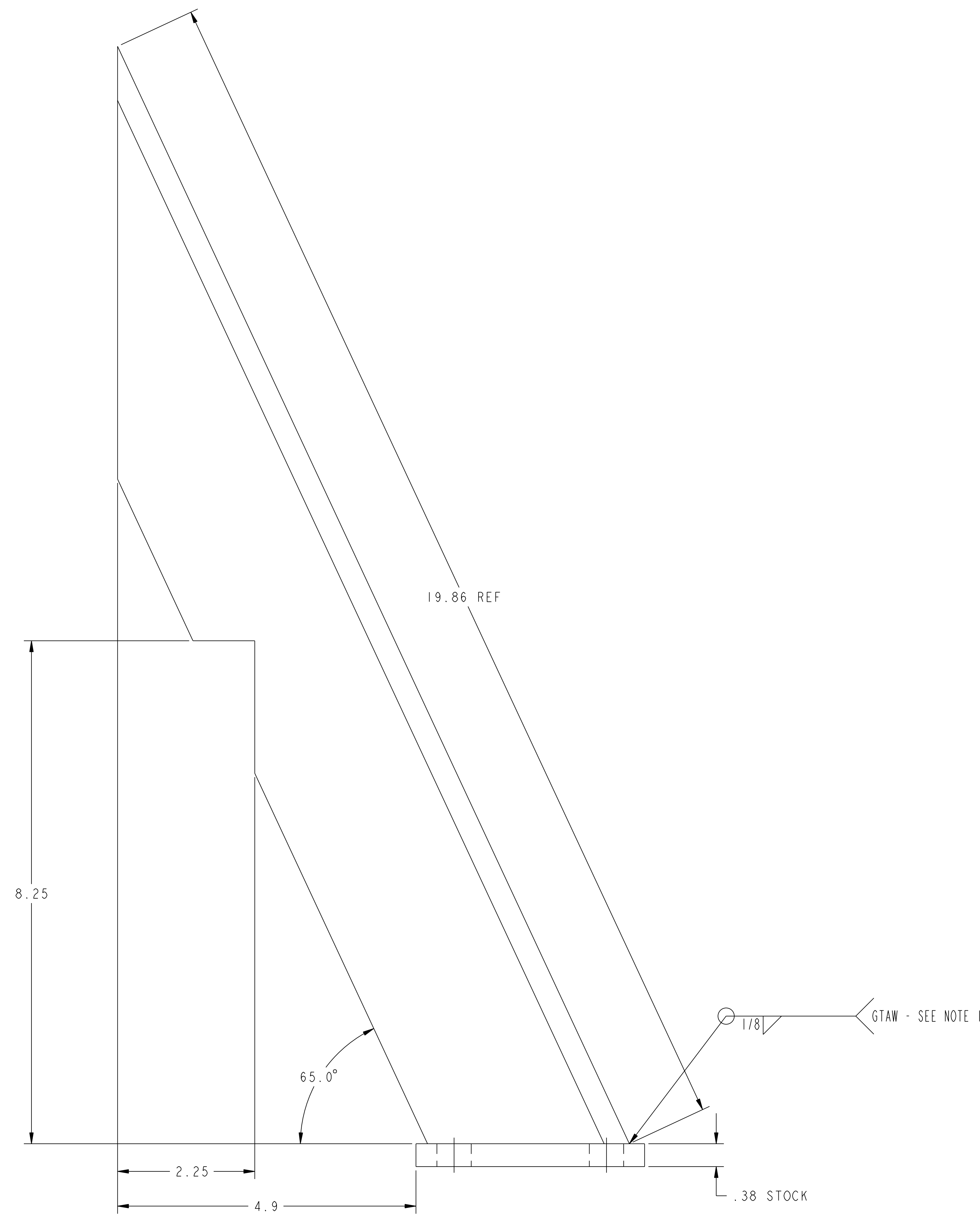
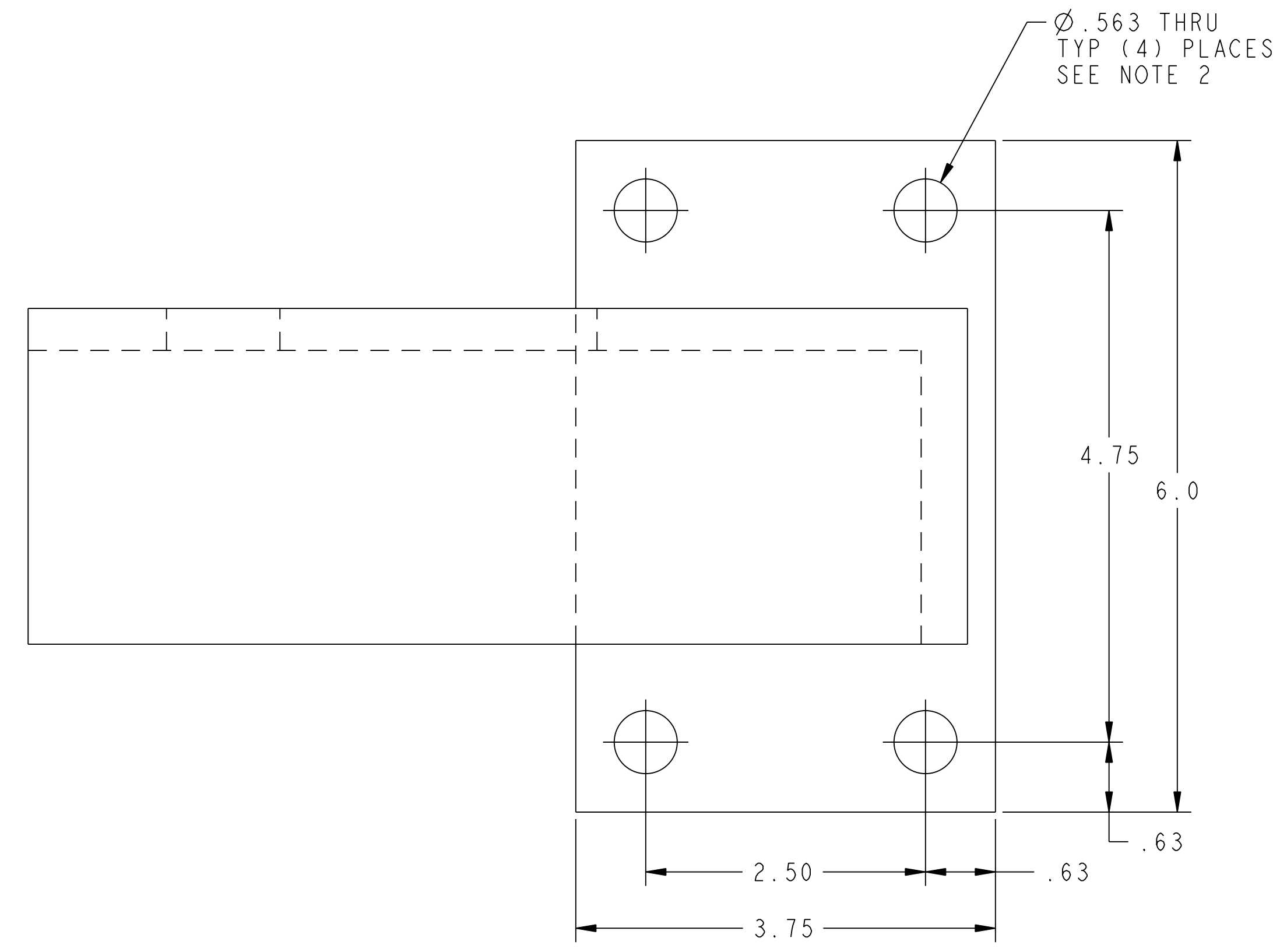

**RELEASED FOR
FABRICATION / INSTALLATION**

FOR NOTES AND BILL OF MATERIAL SEE SHEET 1

02 ASSEMBLY - SUPPORT STAND BRACE WELDMENT - AS SHOWN
03 ASSEMBLY - SUPPORT STAND BRACE WELDMENT - OPPOSITE

RELEASE LEVEL: Fabrication
DWG VERSION NO: 2

COMPUTER GENERATED DRAWING MANUAL CHANGES NOT PERMITTED Pro E	CENTRAL FILES:	PRINCETON PLASMA PHYSICS LABORATORY NATIONAL COMPACT STELLARATOR EXPERIMENT	
	UNLESS OTHERWISE SPECIFIED	DIMENSIONS ARE IN INCHES MACHINE SURFACES	
DO NOT VERIFY INFORMATION BY SCALING DRAWING	BREAK SHARP EDGES .005/.020	TOLERANCES NON-CUMULATIVE	DSN: L. MORRIS
NEXT ASSEMBLY	DECIMAL-INCH FRACTIONS .XX +/- .000 .XXX +/- .005 ANGULAR +/- .0°-15°	0°-12° +/- .12° 12°-72° +/- .12° 72°-120° +/- .12° OVER 120° +/- .12°	CHK: S. RAFTOPOULOS ENGR: J. CHRZANOWSKI SUPV: J. SIEGEL
WEIGHT 61.6 lbs	MODEL NAME SE144-125	WELDING ENGINEER	DRAWING NO: SE144-125
			SHEET 2 OF 2 REV 0

NCSX-SE144-125