

NO.	REVISION	BY	CH	SUP	APPROVED	DATE

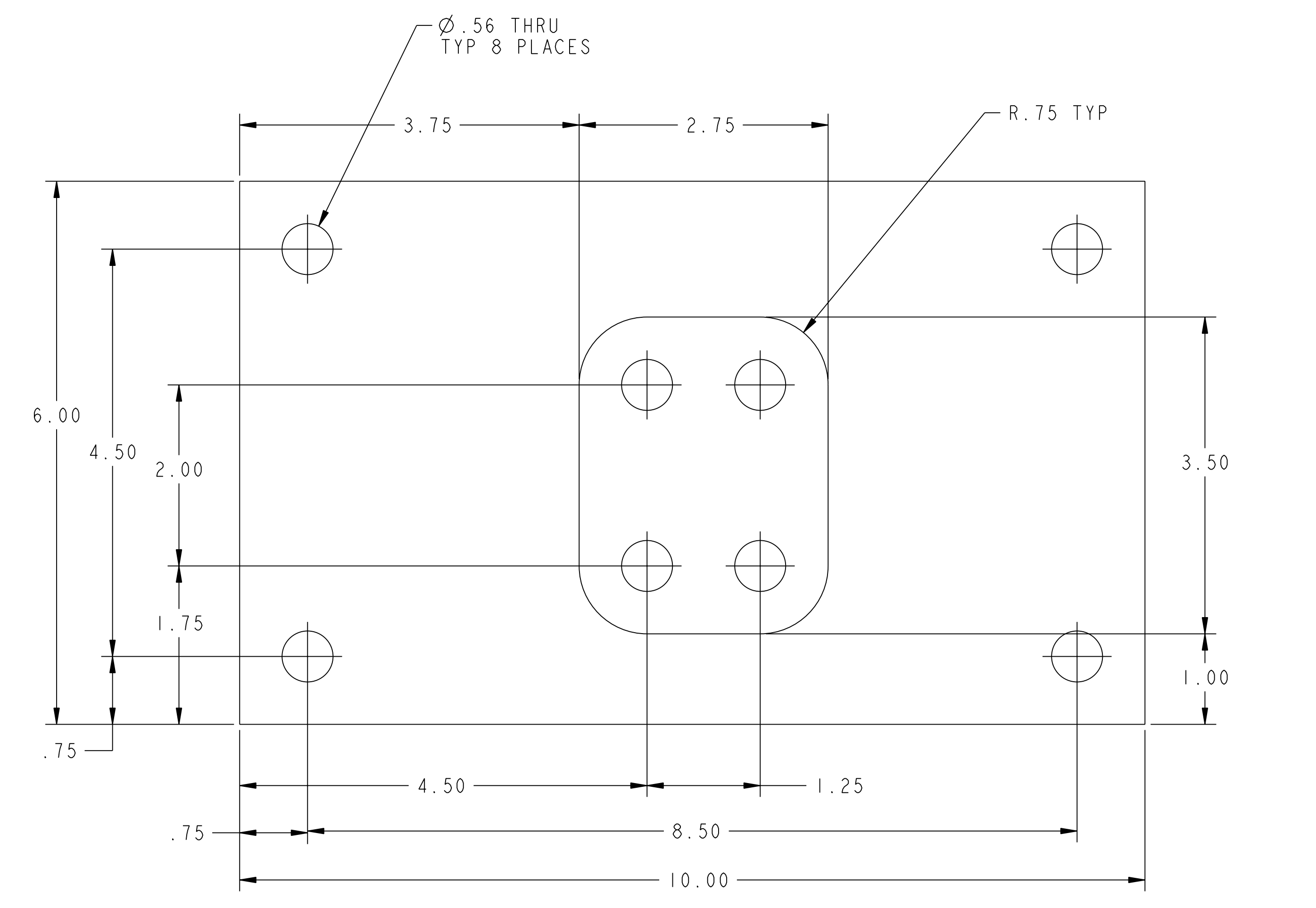

1 BASE ADAPTER PLATE - TYPE A

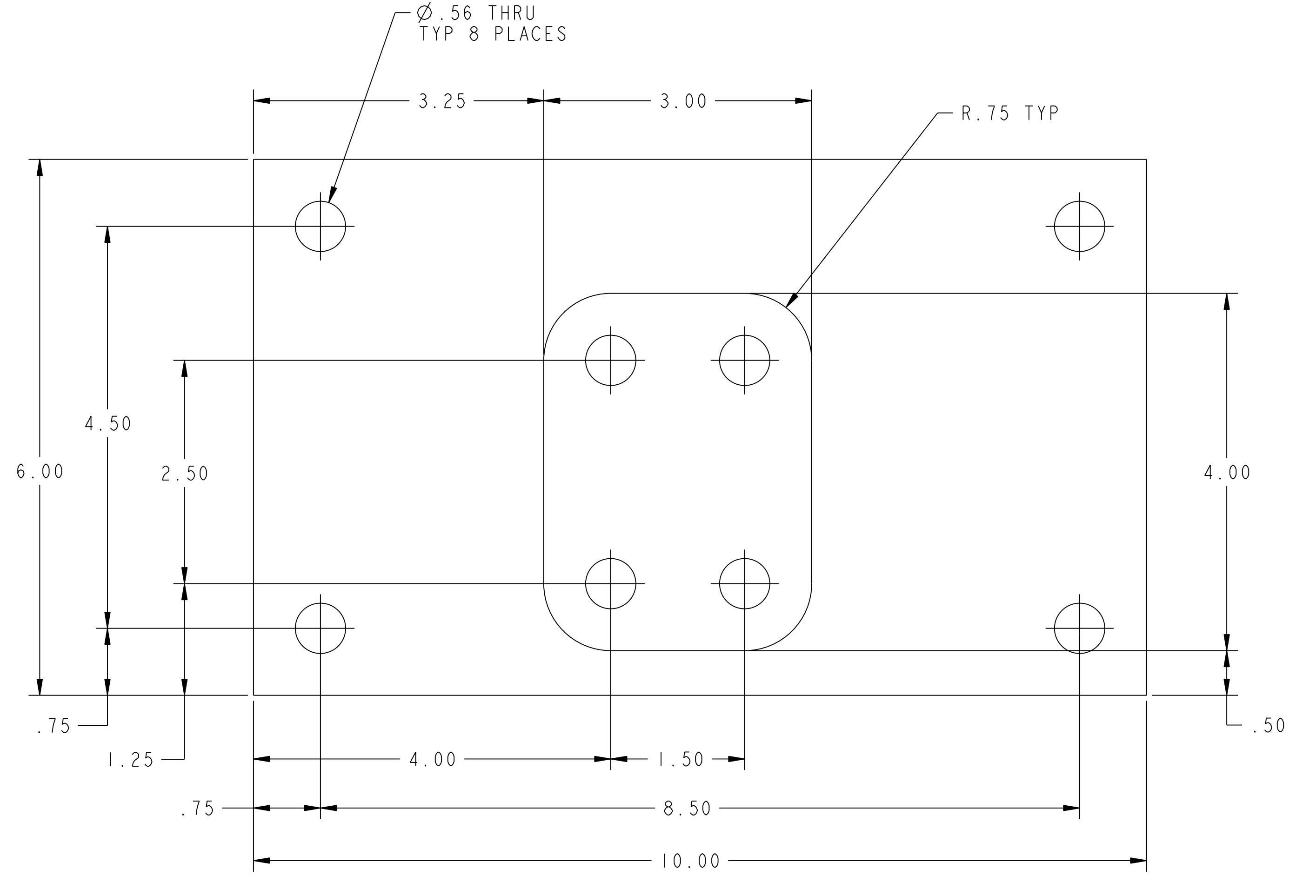

2 BASE ADAPTER PLATE - TYPE B

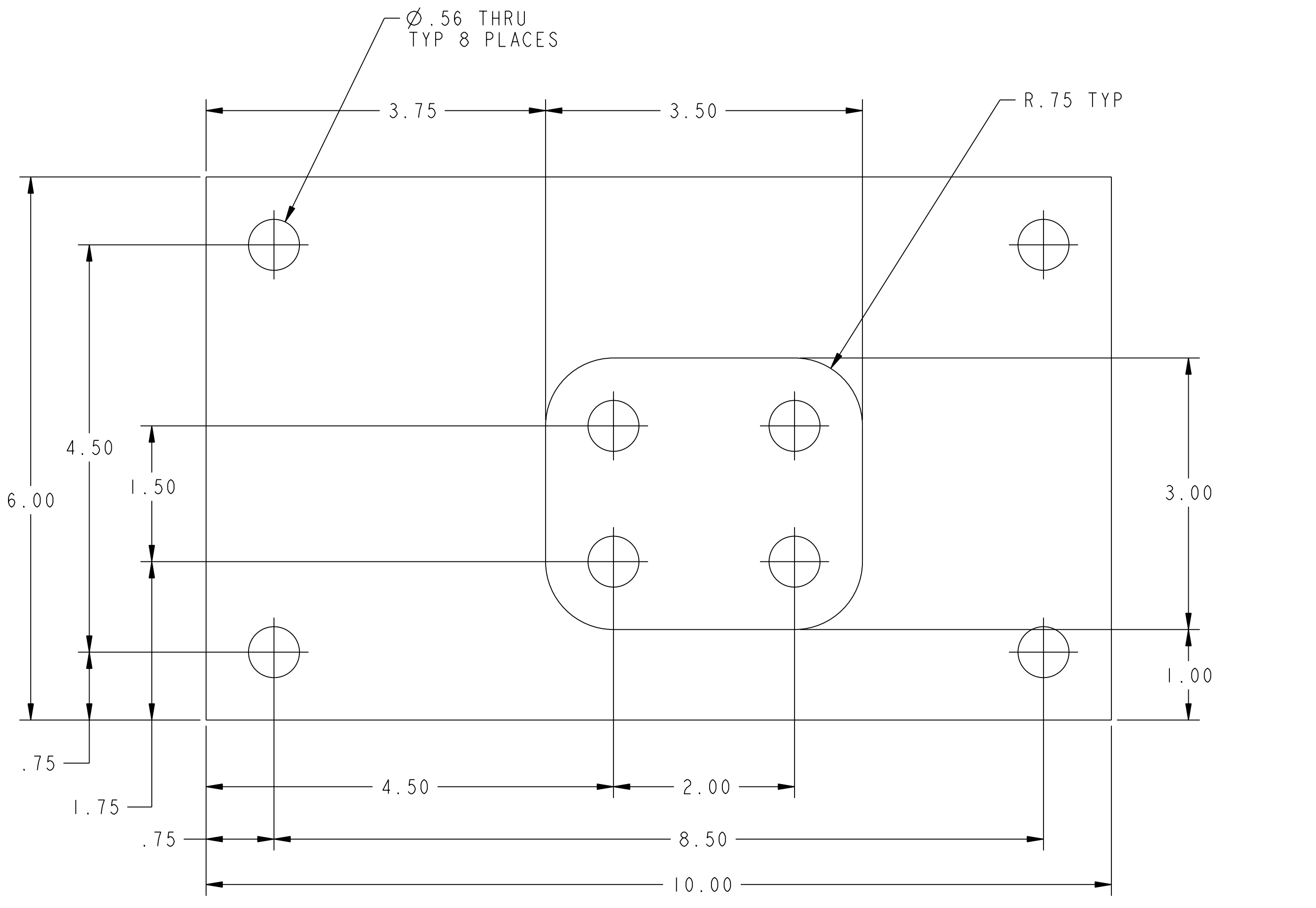

3 BASE ADAPTER PLATE - TYPE C

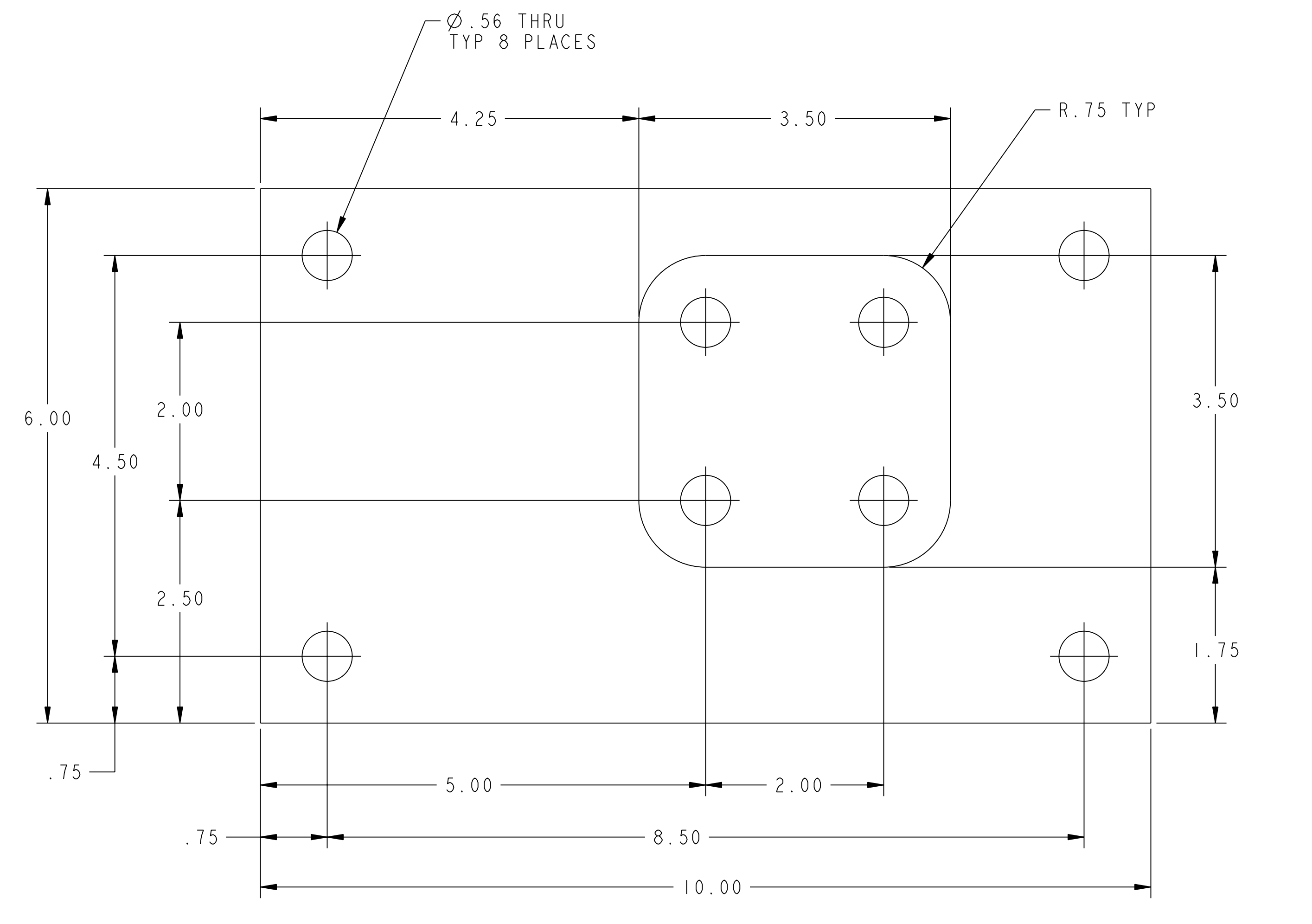

4 BASE ADAPTER PLATE - TYPE D

**RELEASED FOR
FABRICATION / INSTALLATION**

PART NO.	DRAWING NO	NOMENCLATURE OR DESCRIPTION	MATERIAL	QTY	REQD
4	THIS DWG	BASE ADAPTER PLATE - TYPE D	ASTM A569	1	
3	THIS DWG	BASE ADAPTER PLATE - TYPE C	ASTM A569	1	
2	THIS DWG	BASE ADAPTER PLATE - TYPE B	ASTM A569	1	
1	THIS DWG	BASE ADAPTER PLATE - TYPE A	ASTM A569	1	

PARTS LIST

COMPUTER GENERATED DRAWING MANUAL CHANGES NOT PERMITTED Pro E	CENTRAL FILES: UNLESS OTHERWISE SPECIFIED	PRINCETON PLASMA PHYSICS LABORATORY PRINCETON UNIVERSITY NATIONAL COMPACT STELLARATOR EXPERIMENT	
DO NOT VERIFY INFORMATION BY SCALING DRAWING	BREAK SHARP EDGES .005/.020	DIMENSIONS ARE IN INCHES MACHINE SURFACES	
TOLERANCES NON-CUMULATIVE	DECIMAL-INCH FRACTIONS	DSN: L. MORRIS	DRAWING NO:
NEXT ASSEMBLY	.XX +/- .010 .XXX +/- .005 ANGULAR +/- .0°-15°	CHK: S. RAFTOPOULOS ENGR: J. CHRZANOWSKI SUPV: J. SIEGEL	SE144-202
WEIGHT 15.4 lbs		SHEET 1 OF 1 REV 0	
MODEL NAME SE144-202-1		WELDING ENGINEER	

RELEASE LEVEL: Fabrication
DWG VERSION NO: