

NO.	REVISION	BY	CH	SUP	APPROVED	DATE
1	REVISED PER ECN-5370	LM	TB	JS	T. BROWN	6-13-08

TRANSFER DRILL AND TAP 1/2-13UNC-2B THRU HOLES IN THESE (2) LOCATIONS IN LOWER PORT 12 BLANK-OFF COVER. USE PART 2, SUPPORT "TEE" BAR WELDMENT, AS TEMPLATE.

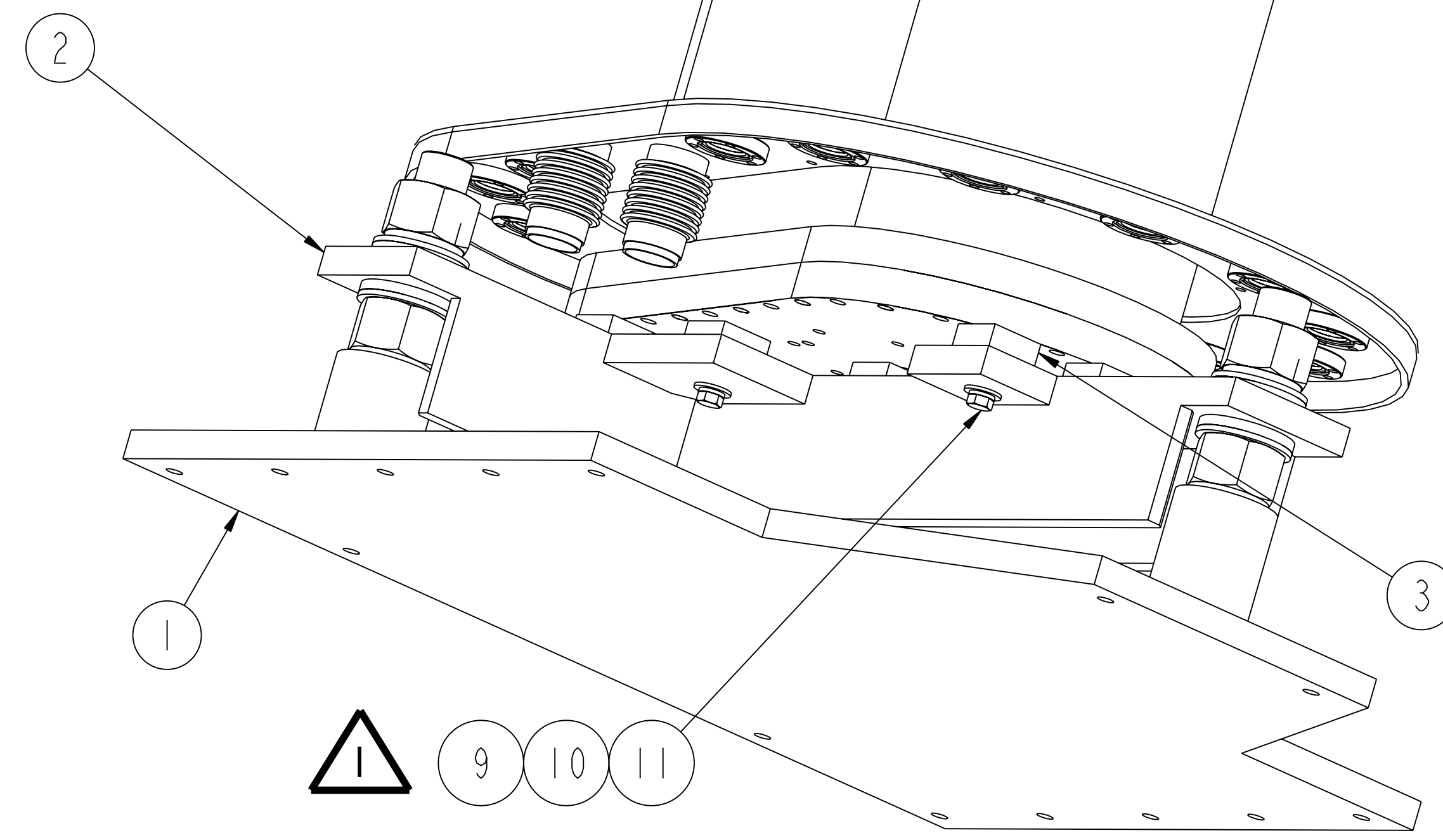

PARTIAL VIEW - FOR CLARITY
SCALE 0.250

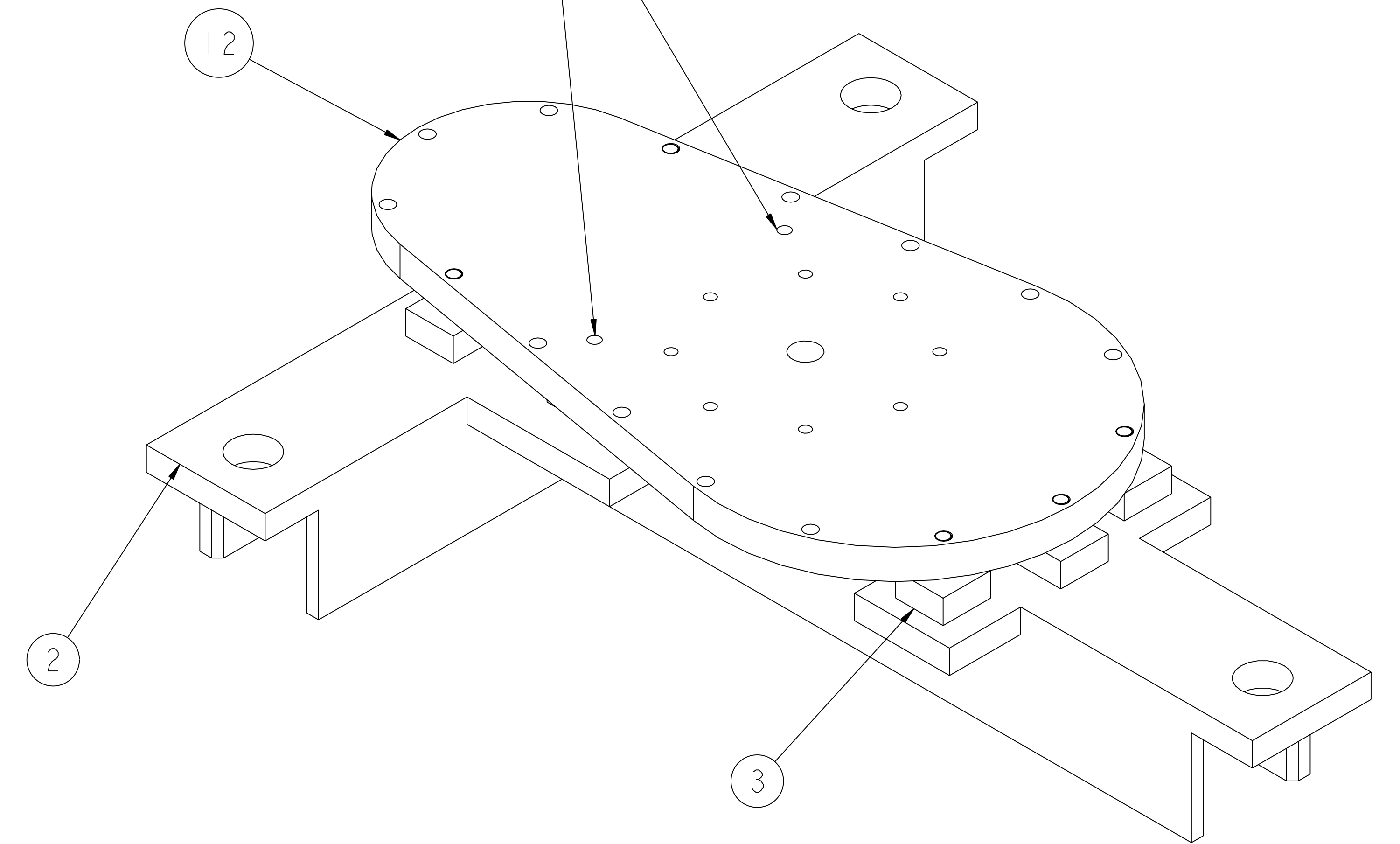

PARTIAL VIEW - LOWER VERTICAL PORT COVER W/ "TEE"
SCALE 0.375

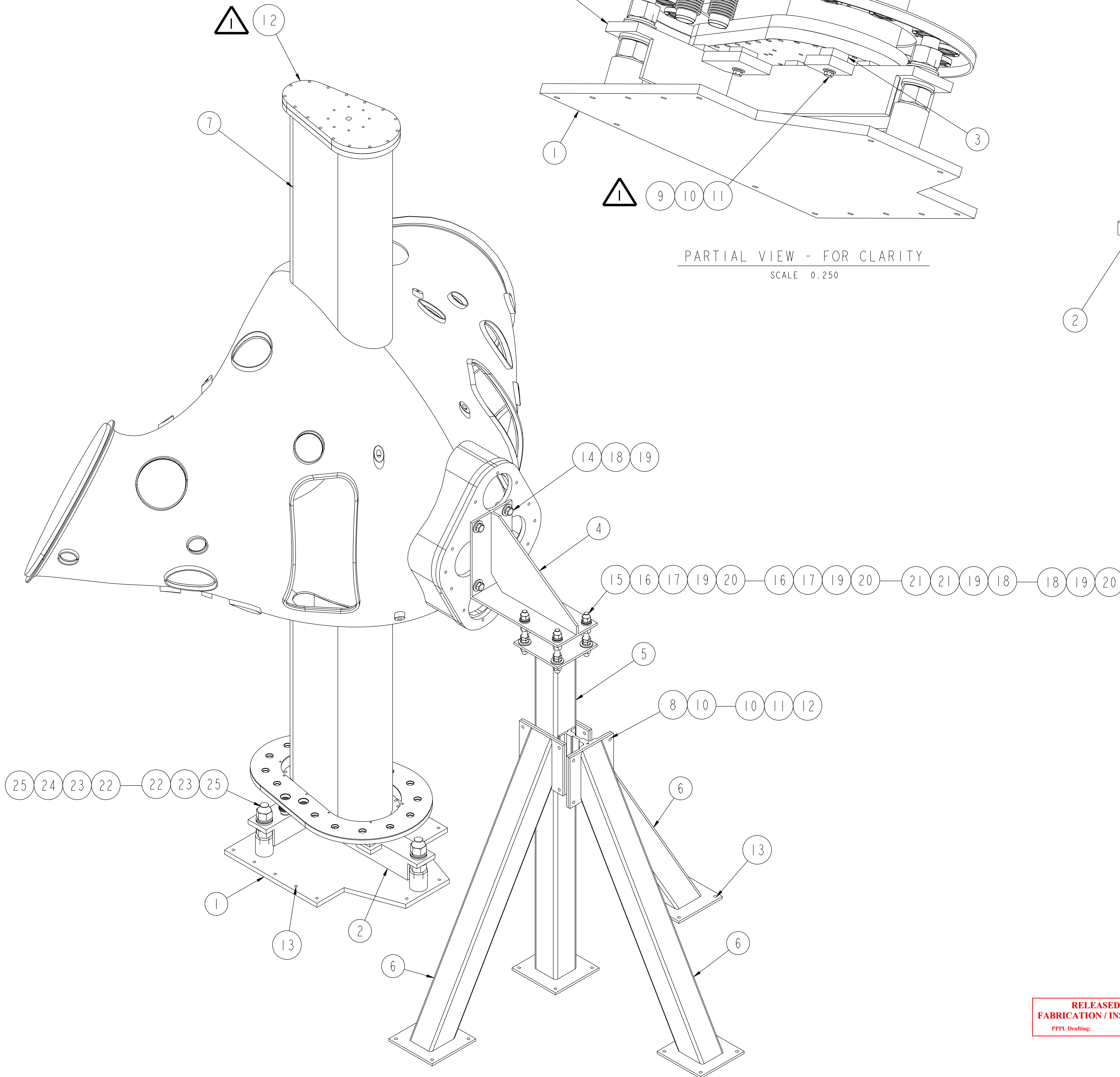

6	25	COMM	1 3/4"-8UNC-2B HEX NUT	C' STL - ZN PLT	
3	24	COMM	1 3/4" SPLIT LOCK WASHER	C' STL - ZN PLT	
6	23	COMM	1 3/4" SPHERICAL WASHER - MALE	STEEL	
6	22	COMM	1 3/4" SPHERICAL WASHER - FEMALE	STEEL	
8	21	COMM	1"-8UNC-2B HEX JAM NUT	C' STL - ZN PLT	
12	20	COMM	1"-8UNC-2B HEX NUT	C' STL - ZN PLT	
12	19	COMM	1" SPLIT LOCK WASHER	C' STL - ZN PLT	
8	18	COMM	1" (NOM) FLAT WASHER	C' STL - ZN PLT	
8	17	COMM	1" SPHERICAL WASHER - MALE	STEEL	
8	16	COMM	1" SPHERICAL WASHER - FEMALE	STEEL	
4	15	THIS DWG	1"-8UNC-2A x 10" LG THREADED ROD	C' STL - ZN PLT	
4	14	COMM	1"-8UNC-2A x 3" LG HEX HD BOLT	C' STL - ZN PLT	
22	13	COMM	1/2" CONCRETE ANCHOR BOLT/NUT 5 1/2" LG	STEEL	
2	12	SE184-003-1	PORT 12 BLANK-OFF COVER	SEE DWG	
28	11	COMM	1/2 SPLIT LOCK WASHER	C' STL - ZN PLT	
34	10	COMM	1/2 (NOM) FLAT WASHER	C' STL - ZN PLT	
7	9	COMM	1/2-13UNC-2A x 5 1/2" LG HEX HD BOLT	C' STL - ZN PLT	
12	8	COMM	1/2-13UNC-2A x 2" LG HEX HD BOLT	C' STL - ZN PLT	
1	7	SE121-009	VVSA ASSEMBLY- PHASE 3		
3	6	SE184-056-03	OUTRIGGER WELDMENT		
1	5	SE184-056-02	VERTICAL SUPPORT WELDMENT		
1	4	SE184-056-01	SUPPORT BRACKET WELDMENT		
8	3	SE184-052-7	SHIM BLOCK		
1	2	SE184-052-01	SUPPORT "TEE" BAR WELDMENT		
1	1	SE184-051-01	BASE SUPPORT WELDMENT		
1	1	THIS DWG	VACUUM VESSEL SUPPORT FIXTURE ASSEMBLY		
01	PART NO.	DRAWING NO.	NOMENCLATURE OR DESCRIPTION	MATERIAL	QTY RECD

RELEASED FOR FABRICATION / INSTALLATION
PPPL Drafting

WEIGHT	9377.7 lbs
MODEL NAME	SE184-050-01
WELDING ENGINEER	

RELEASE LEVEL: Fabrication
DWG VERSION NO: 0

COMPUTER GENERATED DRAWING CHANGES NOT PERMITTED	CENTRAL FILES:	PRINCETON PLASMA PHYSICS LABORATORY	
Pro E	UNLESS OTHERWISE SPECIFIED	PRINCETON UNIVERSITY	
DO NOT VERIFY INFORMATION BY SCALING DRAWING	DIMENSIONS ARE IN INCHES MACHINE SURFACES	NATIONAL COMPACT STELLARATOR EXPERIMENT	
	BREAK SHARP EDGES .005/.020	FIELD PERIOD ASSEMBLY	
	TOLERANCES NON-CUMULATIVE	VACUUM VESSEL SUPPORT ASSEMBLY	
	DECIMAL-INCH FRACTIONS	DSN: L. MORRIS	8-2-2007
	NEXT ASSEMBLY	CHK: M. COLE	8-2-2007
	.XX +/- .030	ENGR: T. BROWN	8-2-2007
	.XXX +/- .005	SUPV: J. SEIGEL	8-2-2007
	ANGULAR +/- 0°15'		

PARTS LIST

SE184-050

SHEET 1 OF 1

NCSX-ASSY-FORMAT.E