

NO.	REVISION	BY	CH	SUP	APPROVED	DATE
-----	----------	----	----	-----	----------	------

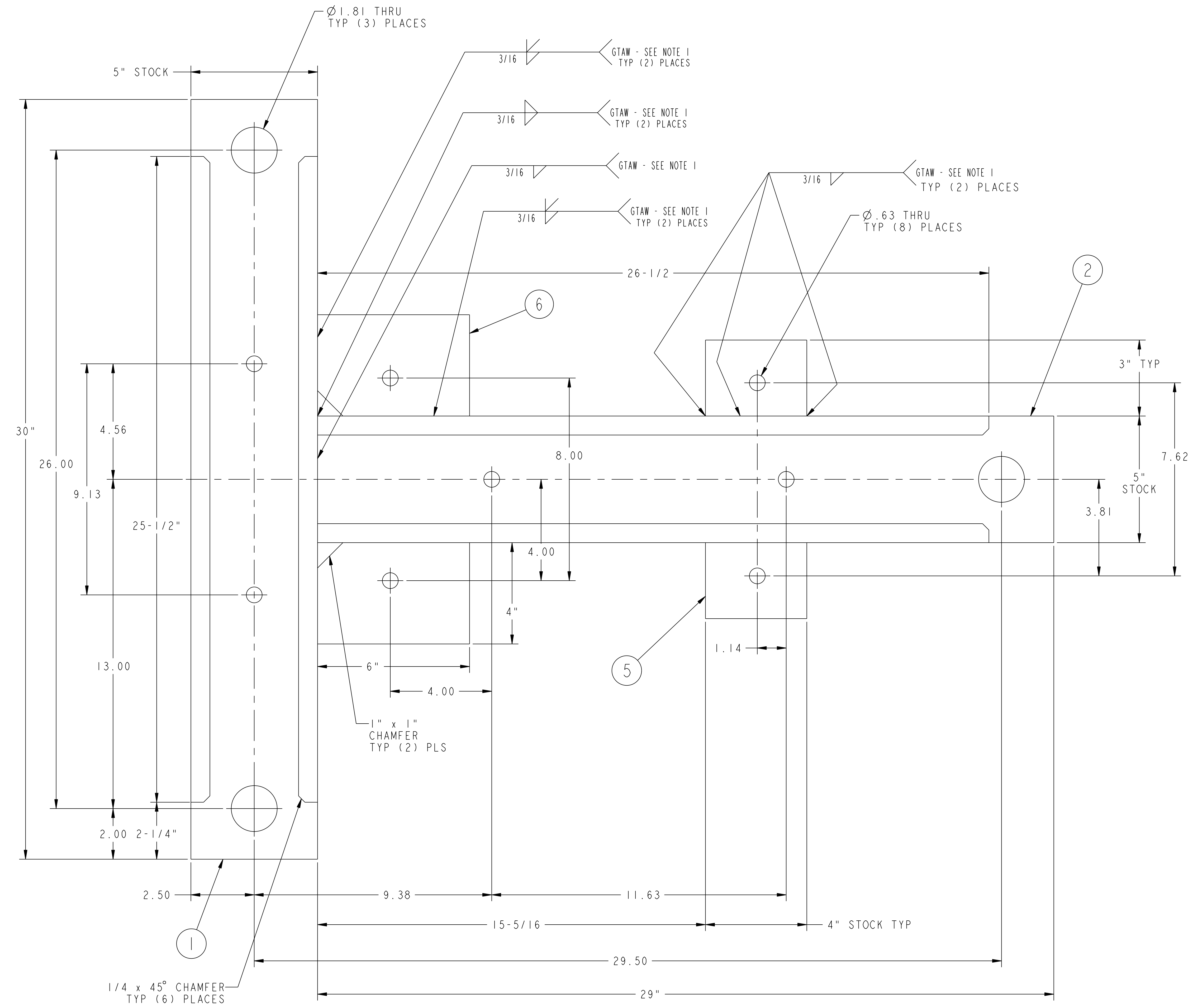

NOTES

1. WELDING SHALL BE PERFORMED IN ACCORDANCE WITH THE REQUIREMENTS OF AWS D1.1 OR PPPL PROCEDURE ENG-037. VISUAL WELD INSPECTION SHALL BE PERFORMED IN ACCORDANCE WITH THE ACCEPTANCE CRITERIA OF AWS D1.1 Section 6.
2. ALL HOLES TO BE MACHINED AFTER ALL WELDS ARE COMPLETE.

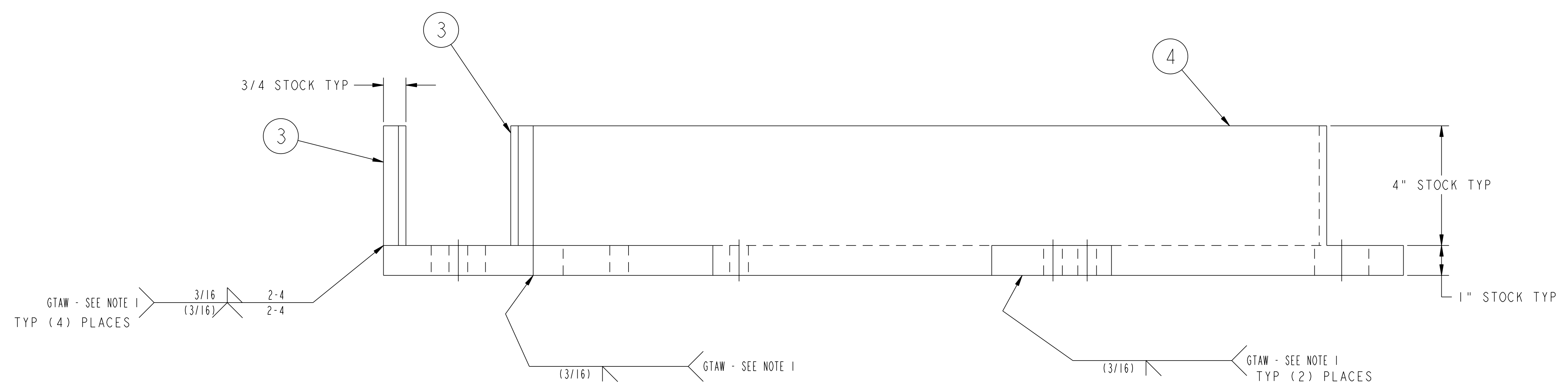
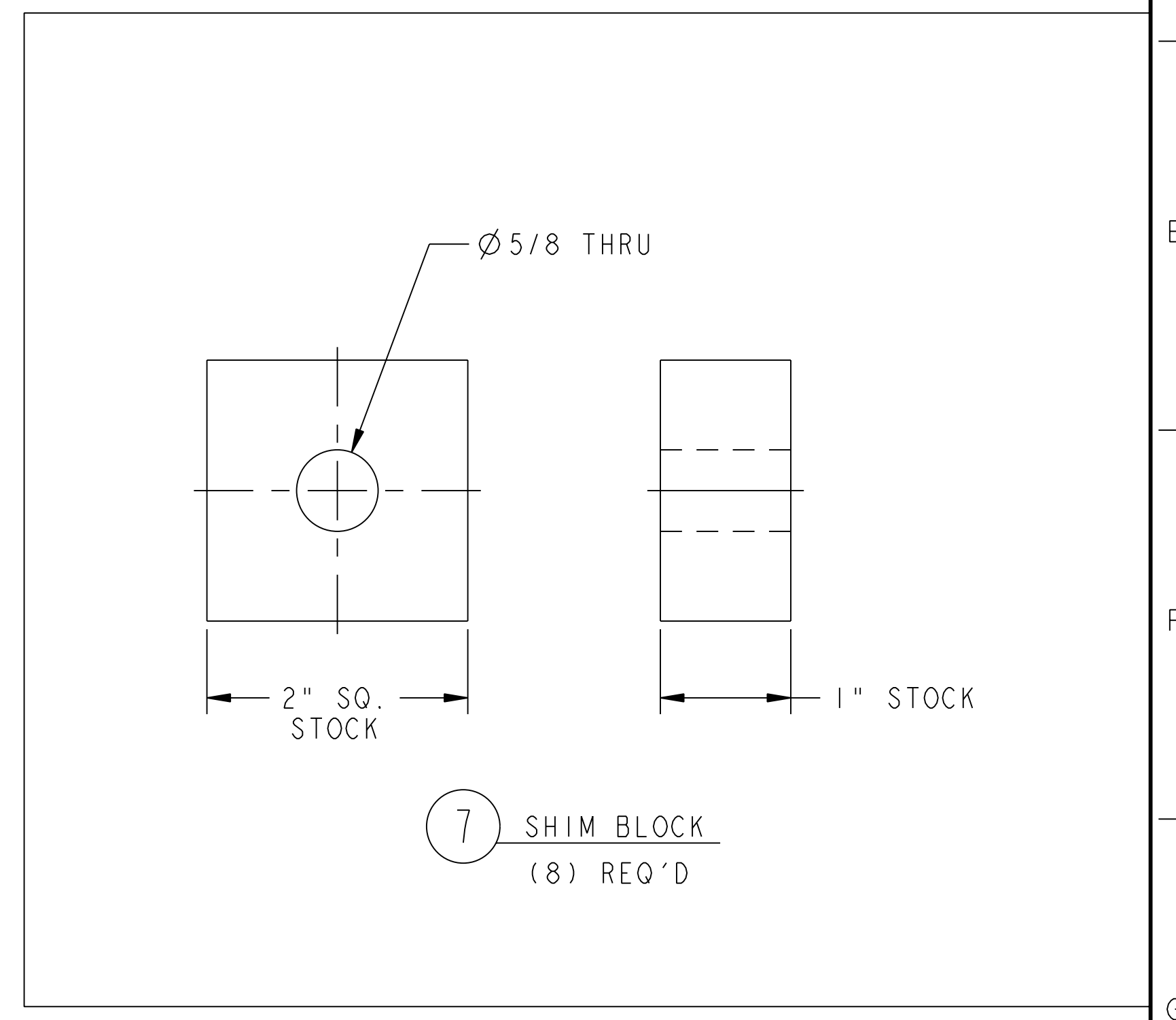

RELEASED FOR FABRICATION / INSTALLATION
 PPPL Drafting

QTY	PART NO.	DRAWING NO.	NOMENCLATURE OR DESCRIPTION	MATERIAL	QTY REQD
—	7	THIS DWG	SHIM BLOCK	ASTM A36	8
2	6	THIS DWG	SUPPORT BLOCK	ASTM A36	
2	5	THIS DWG	SUPPORT WING	ASTM A36	
2	4	THIS DWG	REINFORCING BAR - LONG	ASTM A36	
2	3	THIS DWG	REINFORCING BAR - SHORT	ASTM A36	
1	2	THIS DWG	BASE BAR - LONG	ASTM A36	
1	1	THIS DWG	BASE BAR - SHORT	ASTM A36	
—	—	THIS DWG	SUPPORT "TEE" BAR WELDMENT	—	1

COMPUTER GENERATED DRAWING		CENTRAL FILES:		PRINCETON PLASMA PHYSICS LABORATORY	
DRAWING CHANGES NOT PERMITTED		UNLESS OTHERWISE SPECIFIED		NATIONAL COMPACT STELLARATOR EXPERIMENT	
DO NOT VERIFY INFORMATION BY SCALING DRAWING		DIMENSIONS ARE IN INCHES MACHINE SURFACES		FIELD PERIOD ASSEMBLY VACUUM VESSEL SUPPORT ASSEMBLY SUPPORT "TEE" BAR WELDMENT	
NEXT ASSEMBLY		TOLERANCES NON-CUMULATIVE		DSN: L. MORRIS 8-2-2007 DRAWING NO:	
		DECIMAL-INCH FRACTIONS		CHK: M. COLE 8-2-2007	
		.XX ±.030		ENGR: T. BROWN 8-2-2007	
		.XXX ±.005		SUPV: J. SIEGEL 8-2-2007	
		ANGULAR ±.015		8-2-2007 SHEET 1 OF 1 REV 0	

RELEASE LEVEL: Fabrication
DWG VERSION NO: 11

WEIGHT
 194.7 lbs
 MODEL NAME
 SE184-052-01
 WELDING ENGINEER
 G. GETTELFINGER 8-2-2007

NCSX-SE184-052