

NO.	REVISION	BY	CH	SUP	APPROVED	DATE
1	REVISED PER ECN-5253	LM	TB	JS	T. BROWN	11-21-07

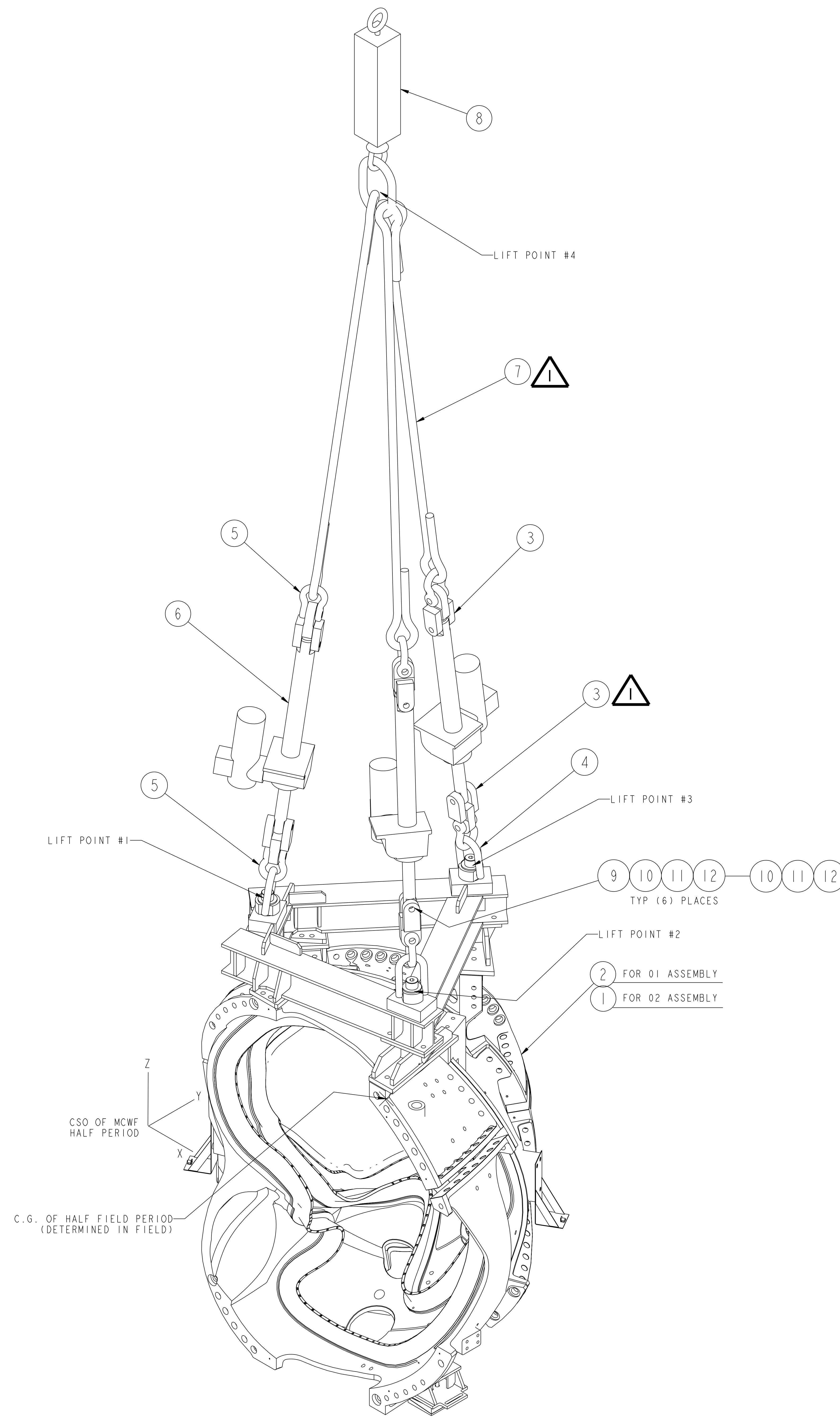

LIFT POINT DATA LOCATIONS FROM CSO

- LIFT POINT #1:
dX = -25.9808
dY = -15.0000
dZ = -69.2150
- LIFT POINT #2:
dX = -77.3074
dY = -13.6314
dZ = -69.2150
- LIFT POINT #3:
dX = -50.7802
dY = -60.5175
dZ = -69.2150
- LIFT POINT #4:
dX = -49.000
dY = -30.000
dZ = -285.630

NOTES

- LIFT POINT CO-ORDINATES ARE TO BE DETERMINED IN FIELD.
- LIFT POINTS FOR RIGHT HALF PERIOD ASSEMBLY AND LEFT HALF PERIOD ASSEMBLY WILL BE UNIQUE PER ASSEMBLY.
- THIS DISTANCE (SHEET 2) TO BE DETERMINED IN FIELD.

RELEASED FOR FABRICATION / INSTALLATION
PPPL Drafting

12	12	12	COMM	1-3/8-6UNC-2B HEX NUT	SAE J429 GRADE 8
12	12	11	COMM	1 3/8" SPLIT LOCK WASHER	C'STL - ZN PLT GRADE 8
12	12	10	COMM	1 3/8" FLAT WASHER	C'STL - ZN PLT GRADE 8
6	6	9	SC185-325	LIFT LINK PIN	SEE DWG
1	1	8	COMM	HYDRASET - 25 TON CAP.	
1	1	7	COMM	3 LEGGED BRIDLE - 50 TON MASTER LINK WITH (3) 17 TON WIRE ROPES 120" LG	STEEL
1	1	6	COMM	SISSCO - TRIPLE ACTUATOR COORDINATED LIFTING SYSTEM HCHS-15-3-WD	
6	6	5	COMM	SCREW PIN ANCHOR SHACKLE - 1 1/2" NOMINAL 17 TON WORKING LOAD LIMIT	STEEL (GALVANIZED)
3	3	4	COMM	SWIVEL HOIST RING - 30,000# (2"-4 1/2" THREAD) CROSBY #1016997 OR EQUIV.	
6	6	3	SE185-317	1 1/2" LIFTING SHACKLE LINK WELDMENT	SEE DWG
	1	2	SE185-302-02 SE185-314-02	RIGHT HALF PERIOD ASSY W/ SUPTS AND LASER POINTERS AND LIFTING FIXTURE FRAME ASSEMBLY	
1		1	SE185-302-01 SE185-314-01	LEFT HALF PERIOD ASSY W/ SUPTS AND LASER POINTERS AND LIFTING FIXTURE FRAME ASSEMBLY	
			THIS DWG	MCWF LEFT HALF PERIOD ASSY W/ SISSCO LIFTING SYSTEM	I
			THIS DWG	MCWF RIGHT HALF PERIOD ASSY W/ SISSCO LIFTING SYSTEM	I

02 ASSY	01 ASSY	PART NO.	DRAWING NO.	NOMENCLATURE OR DESCRIPTION	MATERIAL	QTY REQD
PARTS LIST						
COMPUTER GENERATED DRAWING MANUAL CHANGES NOT PERMITTED			CENTRAL FILES: UNLESS OTHERWISE SPECIFIED		PRINCETON PLASMA PHYSICS LABORATORY PRINCETON UNIVERSITY	
DO NOT VERIFY INFORMATION BY SCALING DRAWING			DIMENSIONS ARE IN INCHES MACHINE SURFACES UNLESS OTHERWISE SPECIFIED		FIELD PERIOD ASSEMBLY WITH SISSCO LIFTING SYSTEM FOR POSITIONING OVER V.V.	
WEIGHT			TOLERANCES NON-CUMULATIVE		DSN: L. MORRIS 2-15-07 DRAWING NO:	
MODEL NAME SE185-304			DECIMAL-INCH FRACTIONS		CHK: M. VIOLA 2-15-07	
NEXT ASSEMBLY			.XX +/- .030 .125-.125 +/- .110		ENGR: T. BROWN 2-15-07	
WELDING ENGINEER			.XXX +/- .005 .75"-1.25" +/- .114 OVER .120" +/- .112		SUPV: J. SIEGEL 2-15-07 SHEET 1 OF 2 REV 1.8	

RELEASE LEVEL: Fabrication
DWG VERSION NO: 10

01 ASSEMBLY - SHOWN
02 ASSEMBLY - SIMILAR TO 01 ASSEMBLY EXCEPT AS INDICATED

NCSX-SE185-304

NO.	REVISION	BY	CH	SUP	APPROVED	DATE

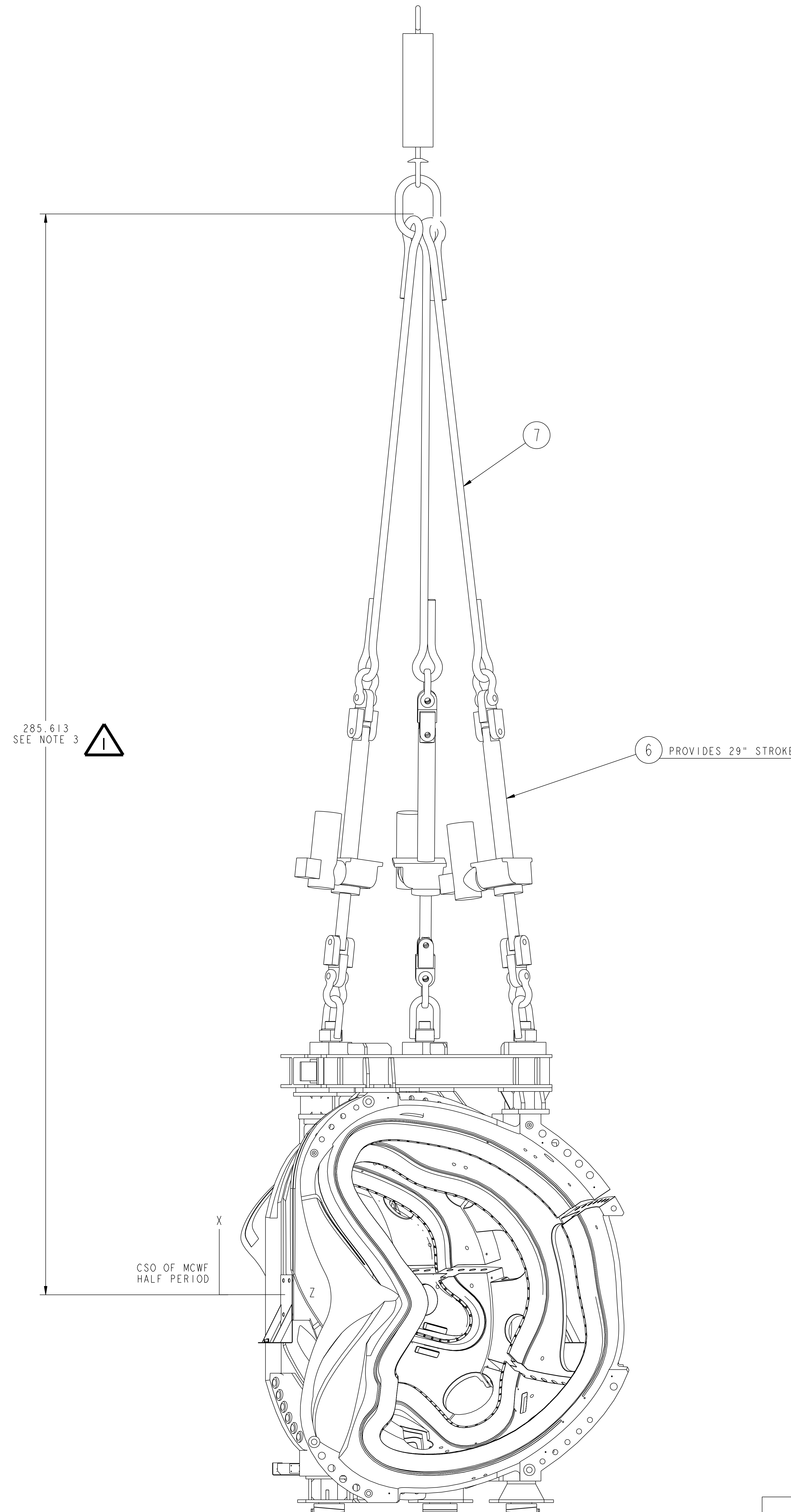

**RELEASED FOR
FABRICATION / INSTALLATION**
 PPPL Drafting

FOR NOTES AND BILL OF MATERIAL SEE SHEET 1

RELEASE LEVEL: Fabrication
DWG VERSION NO: 10

WEIGHT	
MODEL NAME	SE185-304
WELDING ENGINEER	

COMPUTER GENERATED DRAWING MANUAL CHANGES NOT PERMITTED Pro E	CENTRAL FILES: UNLESS OTHERWISE SPECIFIED	PRINCETON PLASMA PHYSICS LABORATORY PRINCETON UNIVERSITY	
DO NOT VERIFY INFORMATION BY SCALING DRAWING	DIMENSIONS ARE IN INCHES MACHINE SURFACES BREAK SHARP EDGES .005/.020	FIELD PERIOD ASSEMBLY NATIONAL COMPACT STELLARATOR EXPERIMENT FIELD PERIOD ASSEMBLY WITH SISSCO LIFTING SYSTEM FOR POSITIONING OVER V.V.	
NEXT ASSEMBLY	TOLERANCES NON-CUMULATIVE DECIMAL-INCH FRACTIONS .XX ±.000 0°-12° ±.125 .XXX ±.005 12°-120° ±.125 ANGULAR ±.0°-15° OVER 120° ±.125	DSN: L. MORRIS	2-15-07
		CHK: M. VIOLA	2-15-07
		ENGR: T. BROWN	2-15-07
		SUPV: J. SIEGEL	2-15-07
		DRAWING NO:	SE185-304
		SHEET 2 OF 2	REV 1.8

NCSX-SE185-304