

NO.	REVISION	BY	CH	SUP	APPROVED	DATE
1	REVISED PER ECN-5008	LM	TB	JS	T. BROWN	7-19-05

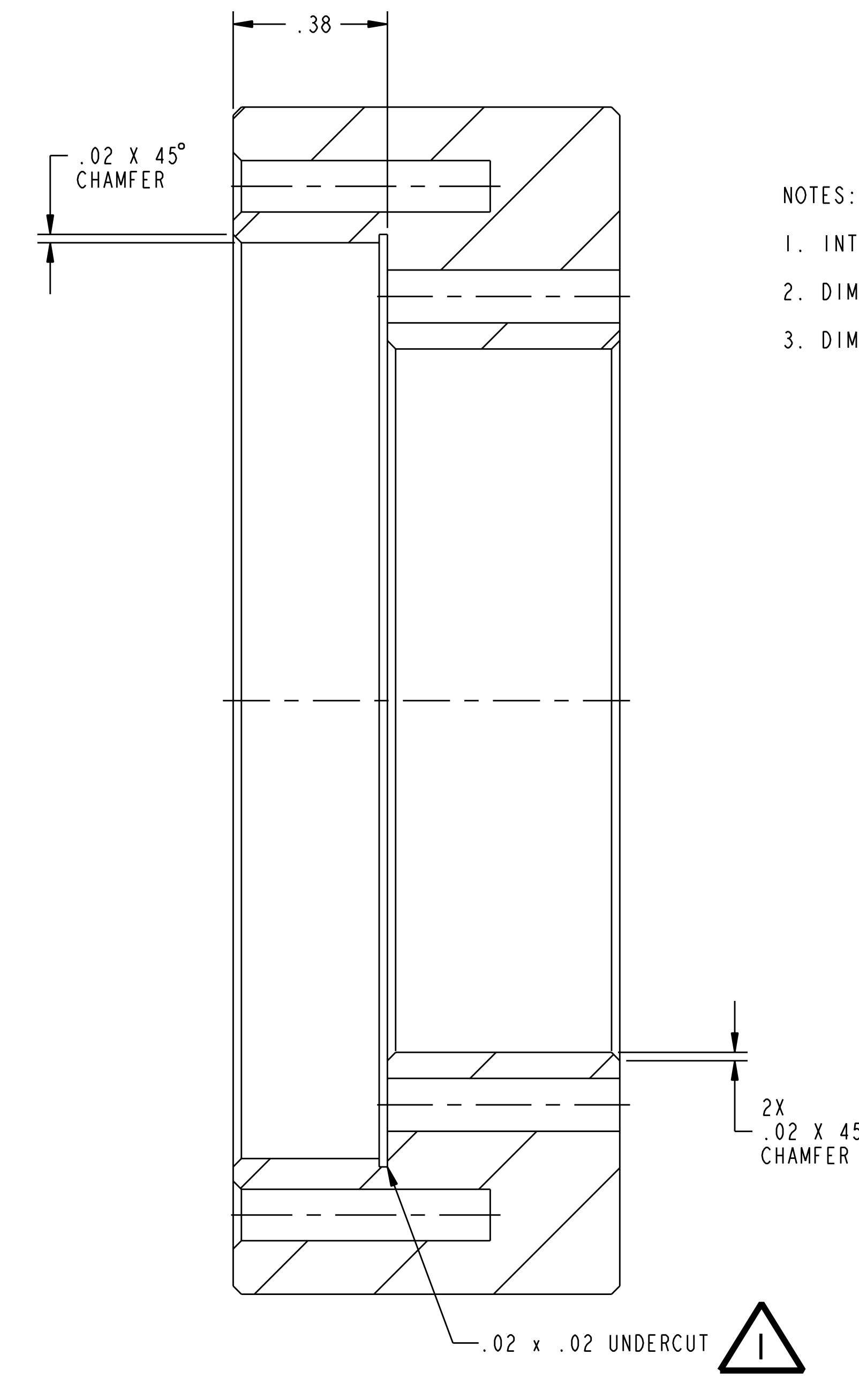

- NOTES:
1. INTERPRET DIMENSIONS AND TOLERANCES PER ANSI Y14.5M
 2. DIMENSIONS ARE IN INCHES
 3. DIMENSIONS APPLY AT ROOM TEMPERATURE.

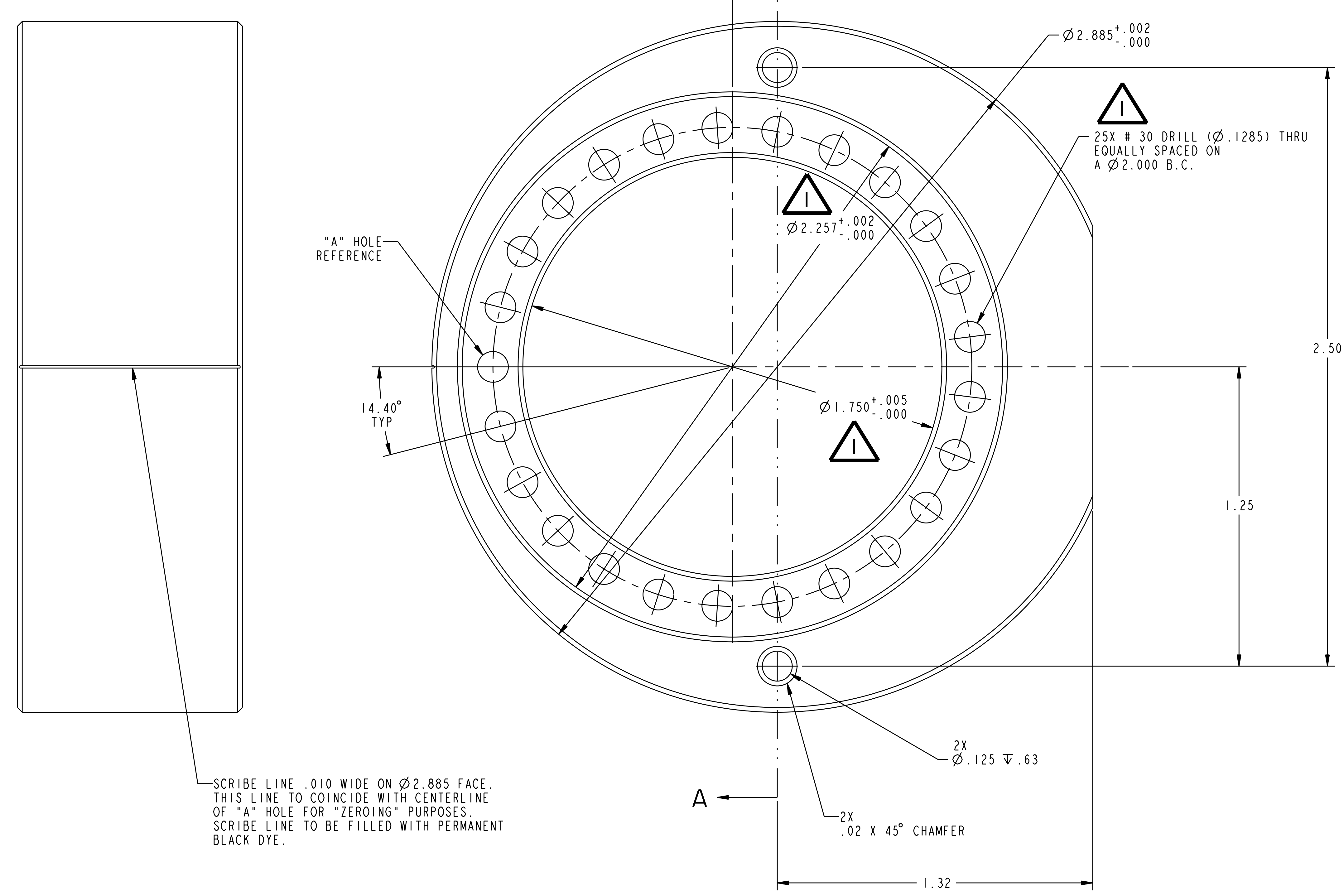
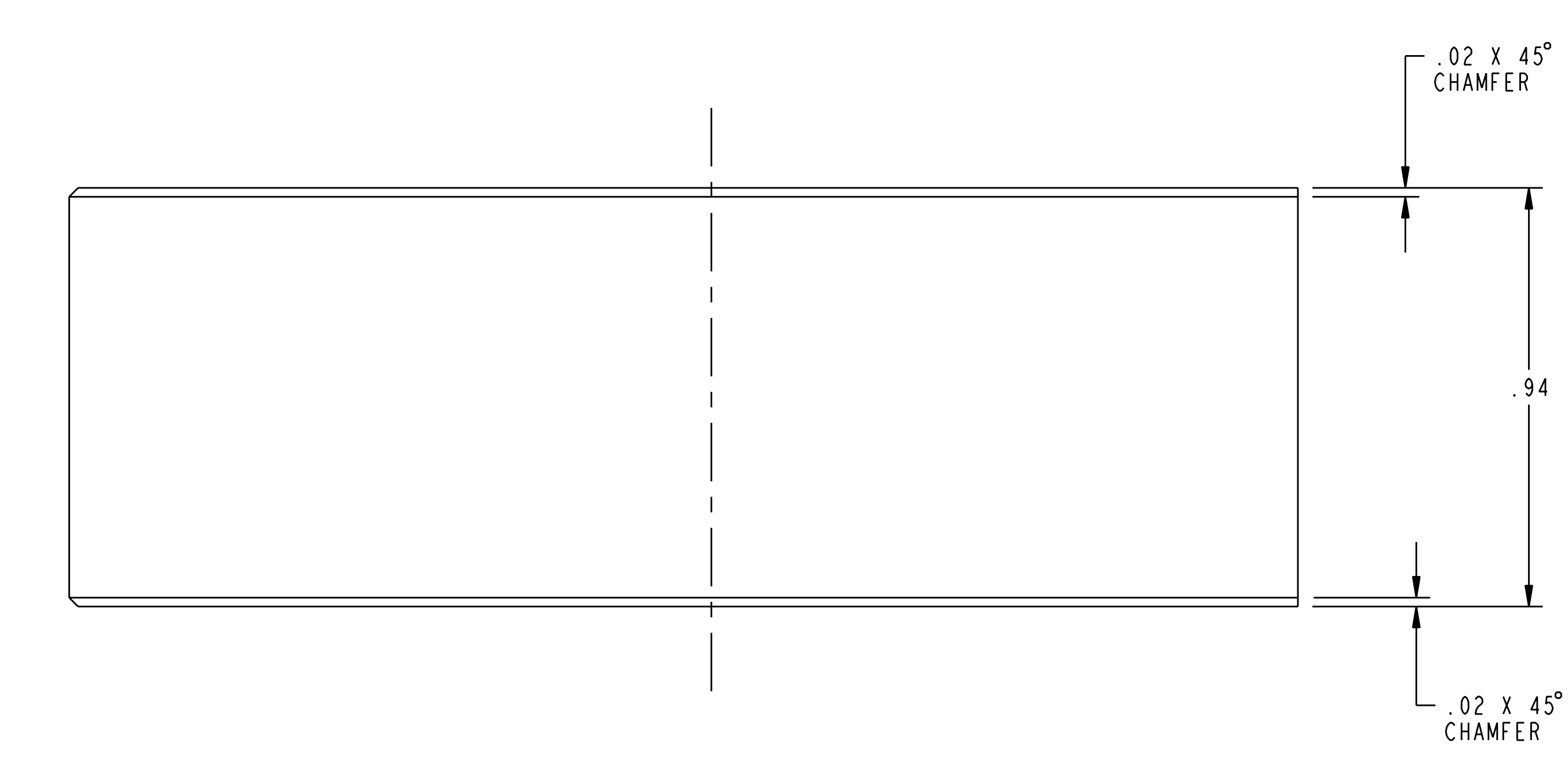

SCALE 4 : 1

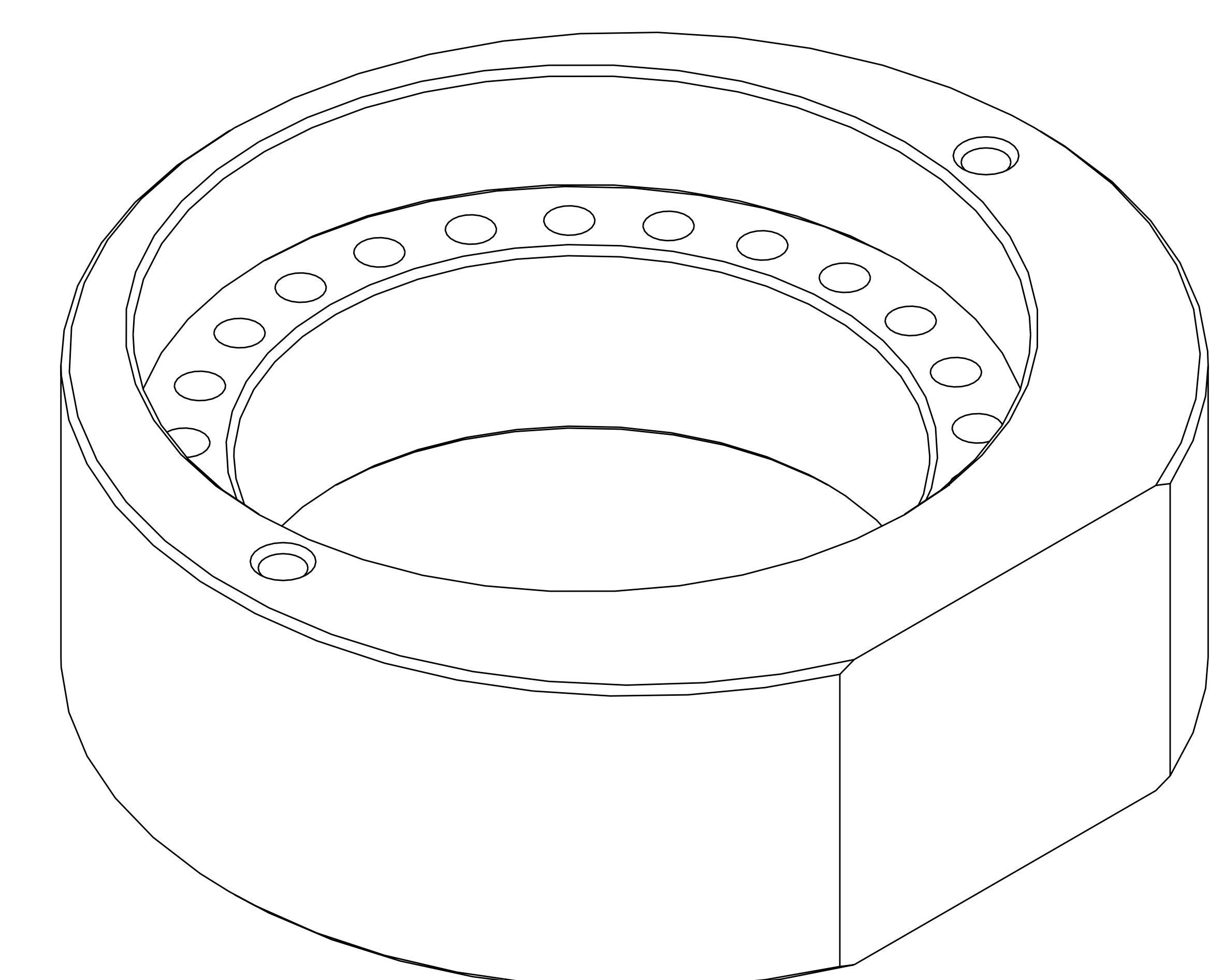

RELEASED FOR FABRICATION / INSTALLATION
PPPL Drafting:

RELEASE LEVEL: Fabrication
DWG VERSION NO: 0

WEIGHT	0.8 lbs
MODEL NAME	SE1851-173
WELDING ENGINEER	

PART NO.	DRAWING NO	NOMENCLATURE OR DESCRIPTION	MATERIAL	QTY REOD
1	SE1851-173	OUTER ALIGNMENT WASHER	316 S/S	3
PARTS LIST				
COMPUTER GENERATED DRAWING MANUAL CHANGES NOT PERMITTED		CENTRAL FILES: UNLESS OTHERWISE SPECIFIED	PRINCETON PLASMA PHYSICS LABORATORY PRINCETON UNIVERSITY	
DO NOT VERIFY INFORMATION BY SCALING DRAWING		DIMENSIONS ARE IN INCHES MACHINE SURFACES UNLESS OTHERWISE SPECIFIED	NATIONAL COMPACT STELLARATOR EXPERIMENT	
NEXT ASSEMBLY		TOLERANCES NON-CUMULATIVE	MODULAR COILS BALL ALIGNMENT ASSEMBLY OUTER ALIGNMENT WASHER	
		DECIMAL-INCH FRACTIONS	DSN: L. MORRIS	DRAWING NO:
		.XX ±.000	CHK: M. COLE	7-6-05
		.XXX ±.005	ENGR: T. BROWN	7-6-05
		ANGULAR ±.015°	SUPV: J. SIEGEL	7-6-05
				SHEET 1 OF 1
				REV 1

NCSX-SE1851-173