

NO.	REVISION	BY	CH	SUP	APPROVED	DATE
1	REVISED PER ECN-5008	LM	TB	JS	T. BROWN	7-19-05

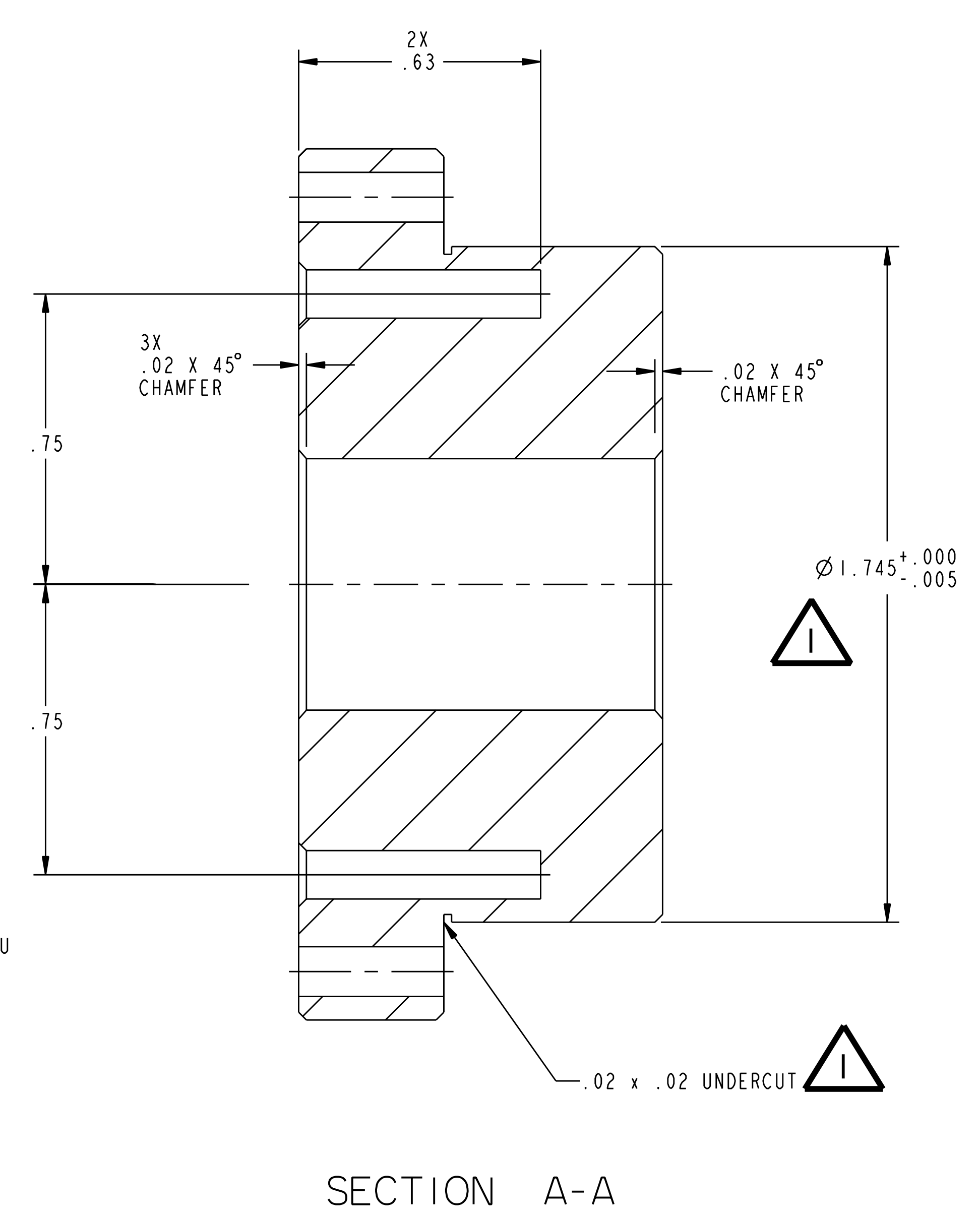

- NOTES:
1. INTERPRET DIMENSIONS AND TOLERANCES PER ANSI Y14.5M
  2. DIMENSIONS ARE IN INCHES
  3. DIMENSIONS APPLY AT ROOM TEMPERATURE.

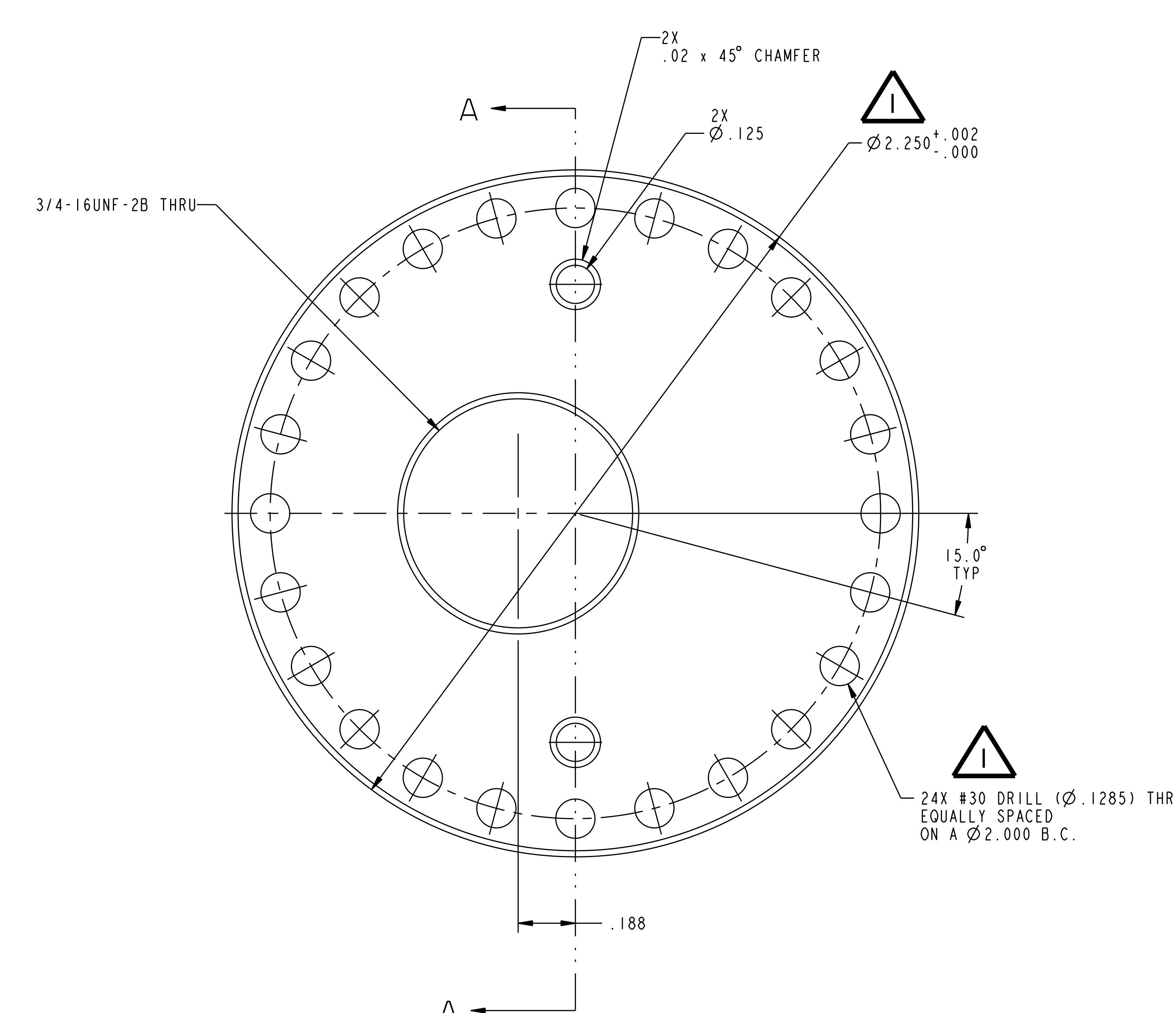
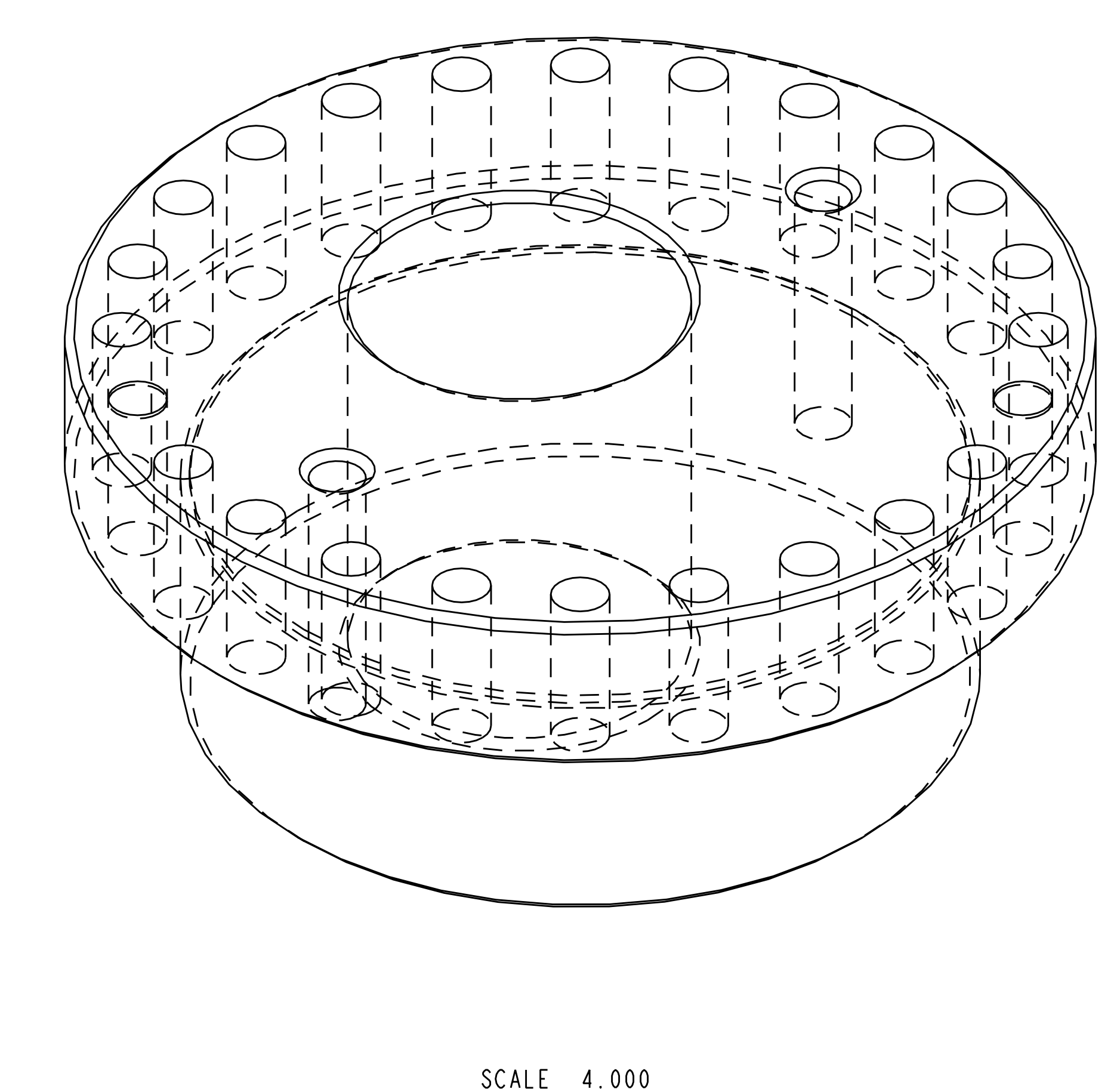
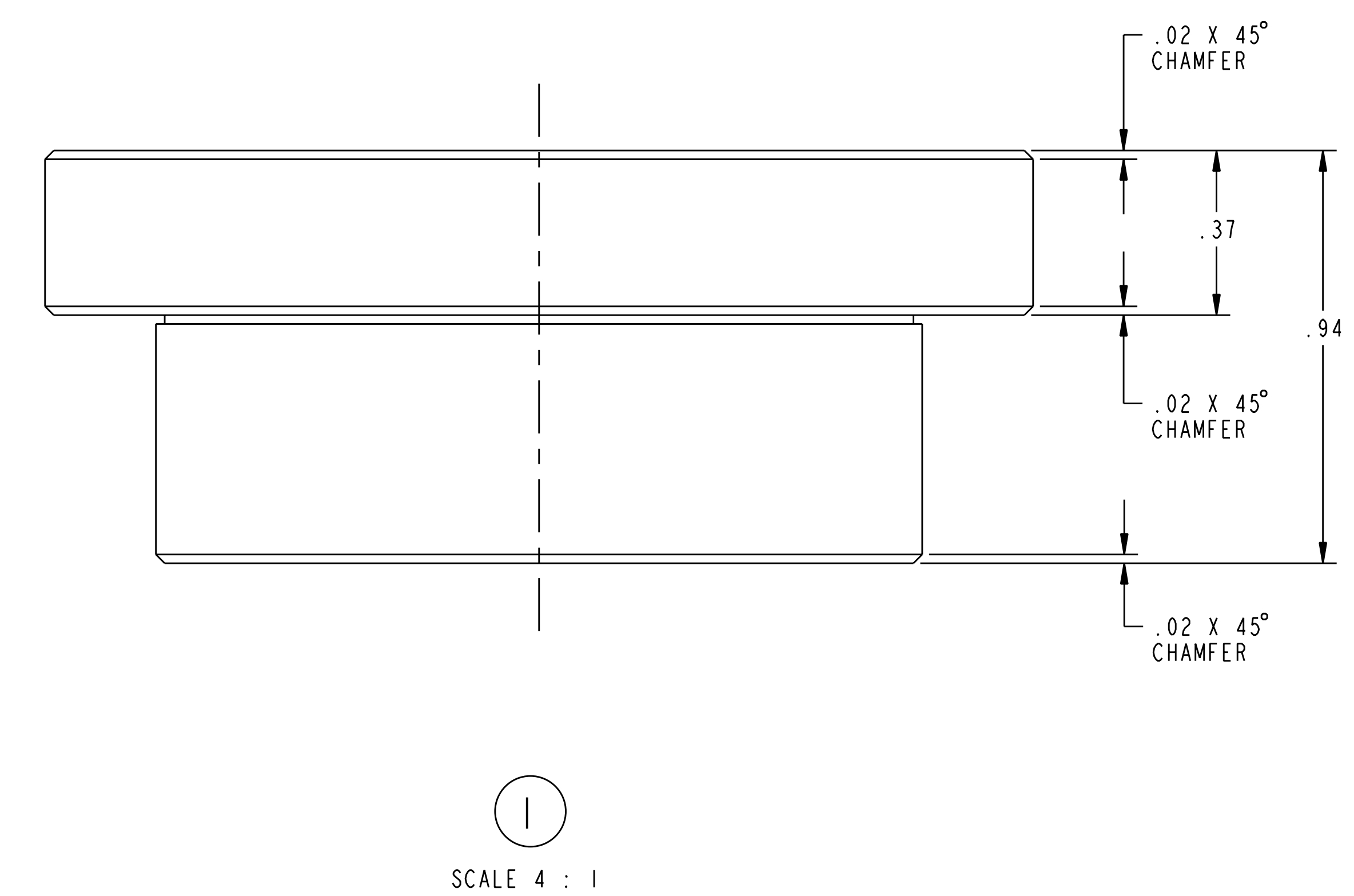

**RELEASED FOR FABRICATION / INSTALLATION**  
PPPL Drafting:

RELEASE LEVEL: Fabrication  
DWG VERSION NO: 0

WEIGHT	0.6 lbs
MODEL NAME	SE1851-174
WELDING ENGINEER	

PART NO.	DRAWING NO	NOMENCLATURE OR DESCRIPTION	MATERIAL	QTY REOD
1	SE1851-174	INNER ALIGNMENT WASHER	316 S/S	3

PARTS LIST

COMPUTER GENERATED DRAWING MANUAL CHANGES NOT PERMITTED	CENTRAL FILES: UNLESS OTHERWISE SPECIFIED	PRINCETON PLASMA PHYSICS LABORATORY PRINCETON UNIVERSITY <b>NATIONAL COMPACT STELLARATOR EXPERIMENT</b>		
DO NOT VERIFY INFORMATION BY SCALING DRAWING	DIMENSIONS ARE IN INCHES MACHINE SURFACES BREAK SHARP EDGES .005/.020	MODULAR COILS BALL ALIGNMENT ASSEMBLY INNER ALIGNMENT WASHER		
Pro E	TOLERANCES NON-CUMULATIVE	DSN: L. MORRIS	7-6-05	DRAWING NO:
NEXT ASSEMBLY	DECIMAL-INCH FRACTIONS	CHK: M. COLE	7-6-05	<b>SE1851-174</b>
	.X ±.100 0°-12° ±.125	ENGR: T. BROWN	7-6-05	
	.XX ±.030 12°-72° ±.110	SUPV: J. SIEGEL	7-6-05	SHEET 1 OF 1
	.XXX ±.005 72°-120° ±.114			REV 1
	ANGULAR ±.0°-15° OVER 120° ±.112			

NCSX-SE1851-174