

NOTES

1. WELDING SHALL BE PERFORMED IN ACCORDANCE WITH THE REQUIREMENTS OF AWS D1.1 OR PPPL PROCEDURE ENG-037. VISUAL WELD INSPECTION SHALL BE PERFORMED IN ACCORDANCE WITH THE ACCEPTANCE CRITERIA OF AWS D1.1 Section 6.
2. ALL HOLES TO BE MACHINED AFTER ALL WELDING IS COMPLETE.

01 ASSEMBLY - FLOOR MOUNTED ANTI-TIPPING PLATE WELDMENT - TYPE "A"

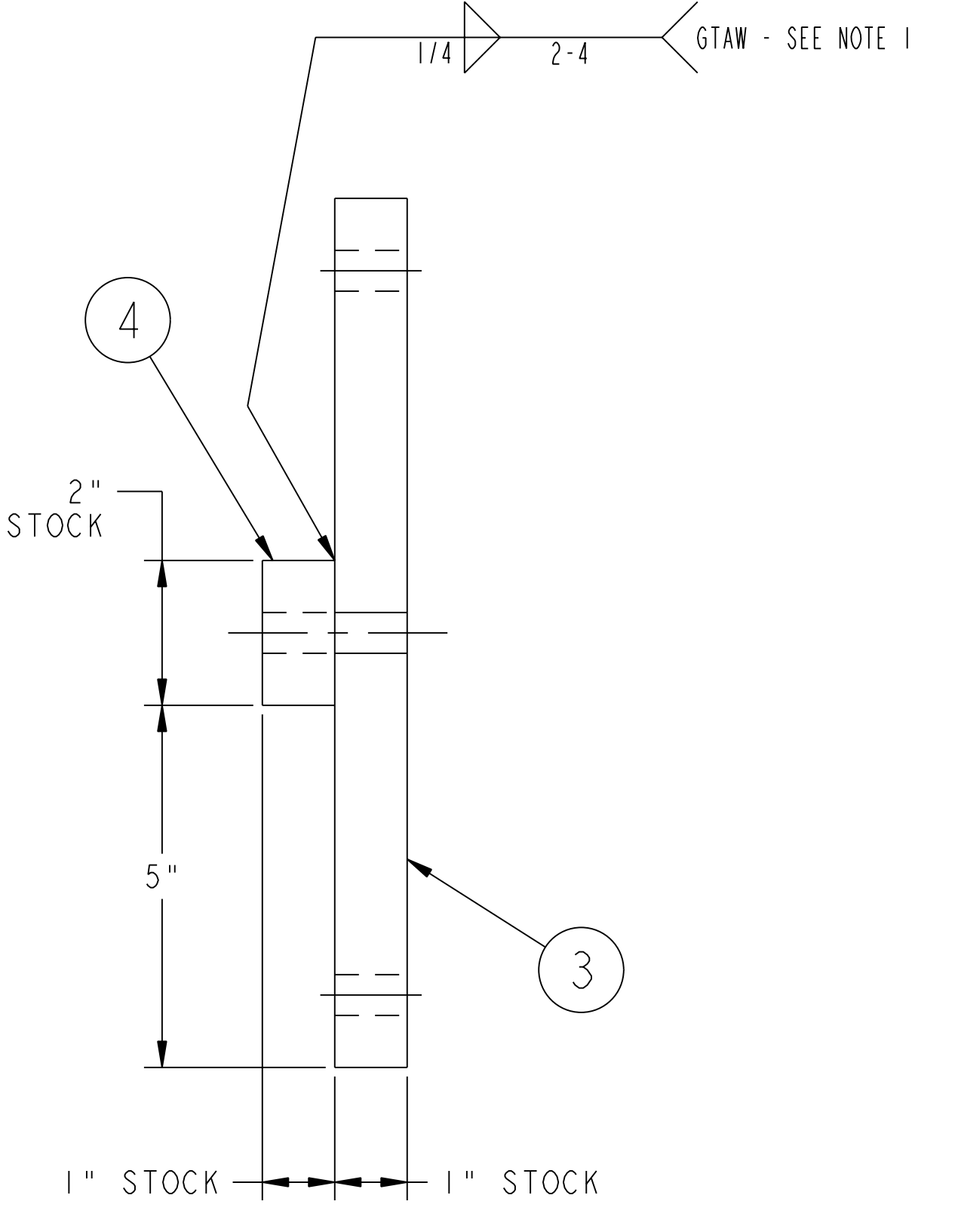
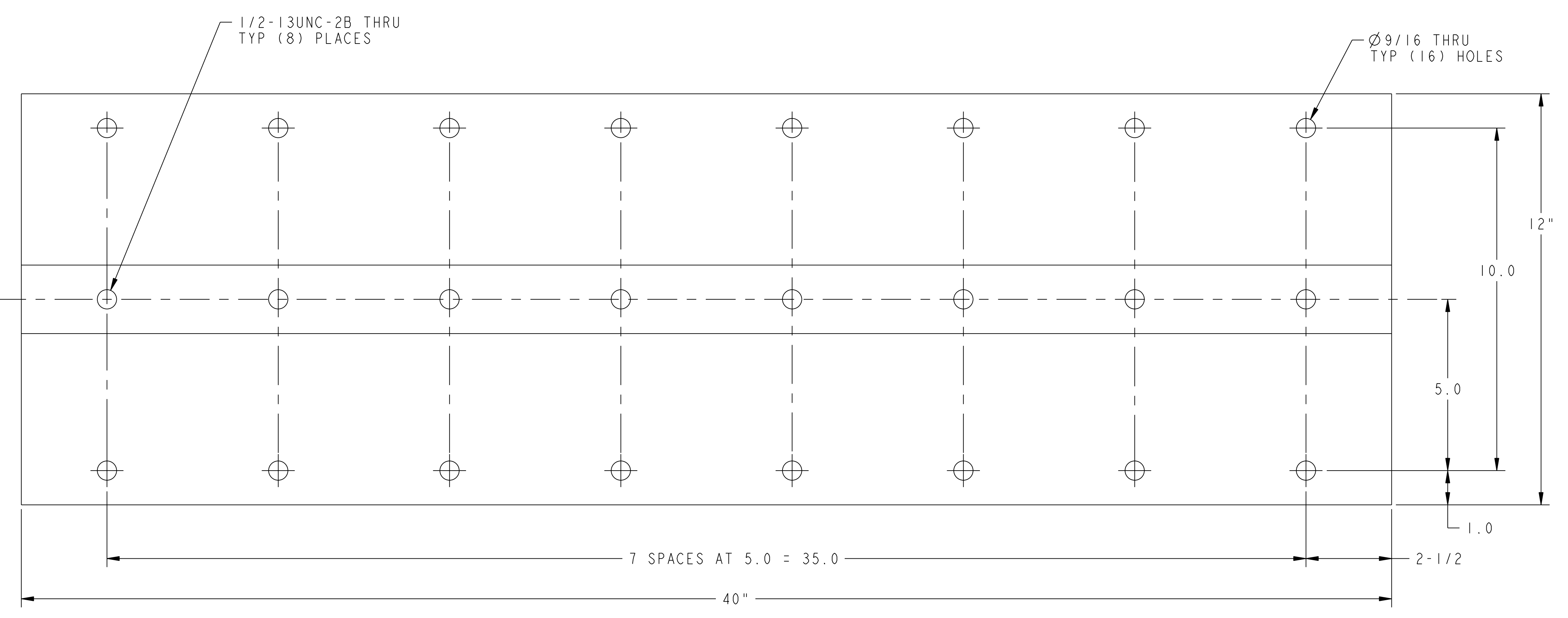

02 ASSEMBLY - FLOOR MOUNTED ANTI-TIPPING PLATE WELDMENT - TYPE "B"

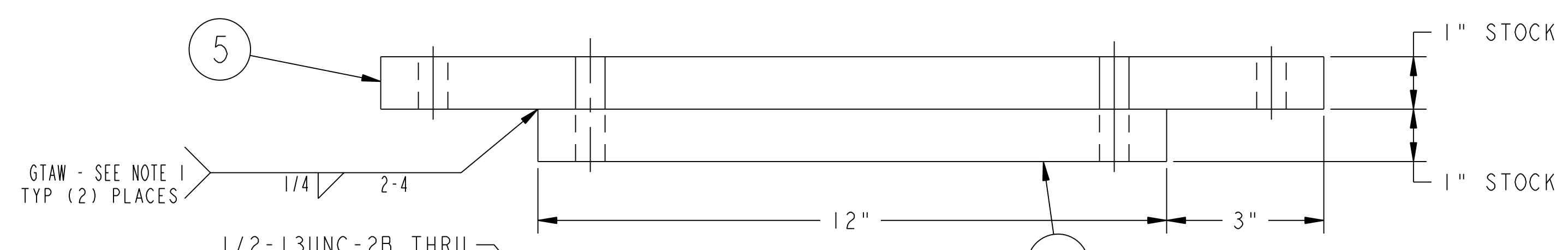
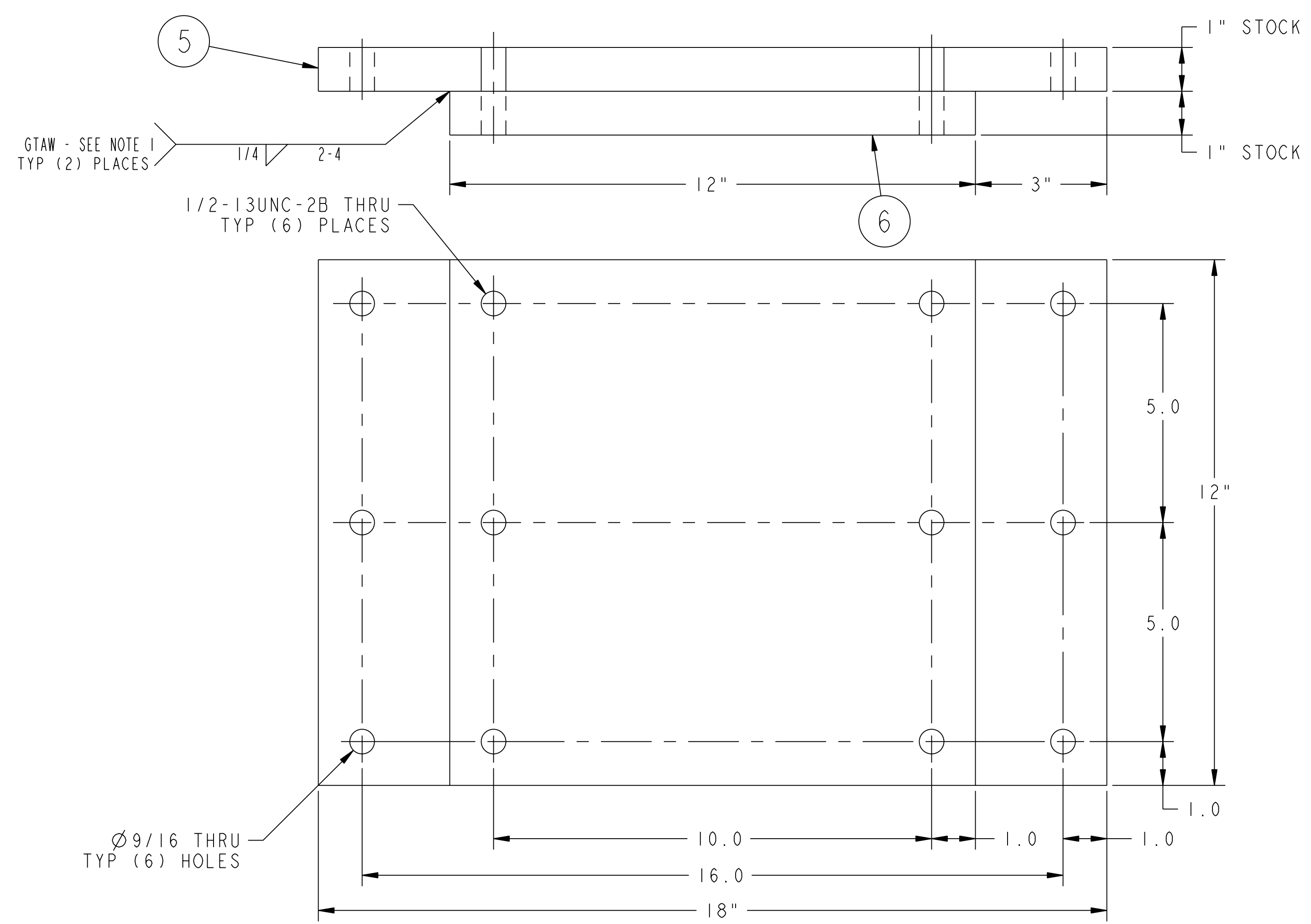

03 ASSEMBLY - FLOOR MOUNTED ANTI-TIPPING PLATE WELDMENT - TYPE "C"

RELEASED FOR
FABRICATION / INSTALLATION
PPPL Drafting

REV	NO.	DESCRIPTION	MATERIAL	QTY	RECD
	6	THIS DWG	ANTI-TIP MOUNTING PLATE - TYPE "D"	ASTM A36	
	5	THIS DWG	ANTI-TIP MOUNTING PLATE - TYPE "C"	ASTM A36	
	4	THIS DWG	ANTI-TIP MOUNTING BAR - TYPE "B"	ASTM A36	
	3	THIS DWG	ANTI-TIP MOUNTING PLATE - TYPE "B"	ASTM A36	
	2	THIS DWG	ANTI-TIP MOUNTING BAR - TYPE "A"	ASTM A36	
	1	THIS DWG	ANTI-TIP MOUNTING PLATE - TYPE "A"	ASTM A36	
		THIS DWG	FLOOR MOUNTED ANTI-TIPPING PLATE WELDMENT - TYPE "C"		2
		THIS DWG	FLOOR MOUNTED ANTI-TIPPING PLATE WELDMENT - TYPE "B"		1
		THIS DWG	FLOOR MOUNTED ANTI-TIPPING PLATE WELDMENT - TYPE "A"		1

03 ASSY	02 ASSY	01 ASSY	PART NO.	DRAWING NO.	NOMENCLATURE OR DESCRIPTION	MATERIAL	QTY	RECD

WEIGHT
128.6 lbs

MODEL NAME
SE186-327-01

WELDING ENGINEER
L. DUDEK 11-14-07

RELEASE LEVEL: Fabrication
DWG VERSION NO: 3

COMPUTER GENERATED DRAWING CHANGES NOT PERMITTED
UNLESS OTHERWISE SPECIFIED
DIMENSIONS ARE IN INCHES
MACHINE SURFACES UNLESS SHOWN OTHERWISE
BREAK SHARP EDGES .005/.020
TOLERANCES NON-CUMULATIVE
DECIMAL-INCH FRACTIONS
0"-.125" ±.010
.125"-.250" ±.012
.250"-.500" ±.015
.500"-.750" ±.020
.750"-.120" ±.025
OVER .120" ±.030

PRINCETON PLASMA PHYSICS LABORATORY
NATIONAL COMPACT STELLARATOR EXPERIMENT
FIELD PERIOD ASSEMBLY
FIELD PERIOD ASSEMBLY FIXTURE
FLOOR MOUNTED ANTI-TIPPING PLATE WELDMENTS

DSN: L. MORRIS
CHK: M. COLE
ENGR: T. BROWN
SUPV: J. SIEGEL

DRAWING NO:
SE186-327

SHEET 1 OF 1
REV 0

NCSX-SE186-327