

NO.	REVISION	BY	CH	SUP	APPROVED	DATE
1	REVISED PER ECD-5371	LM	TB	JS	T. BROWN	6-18-08

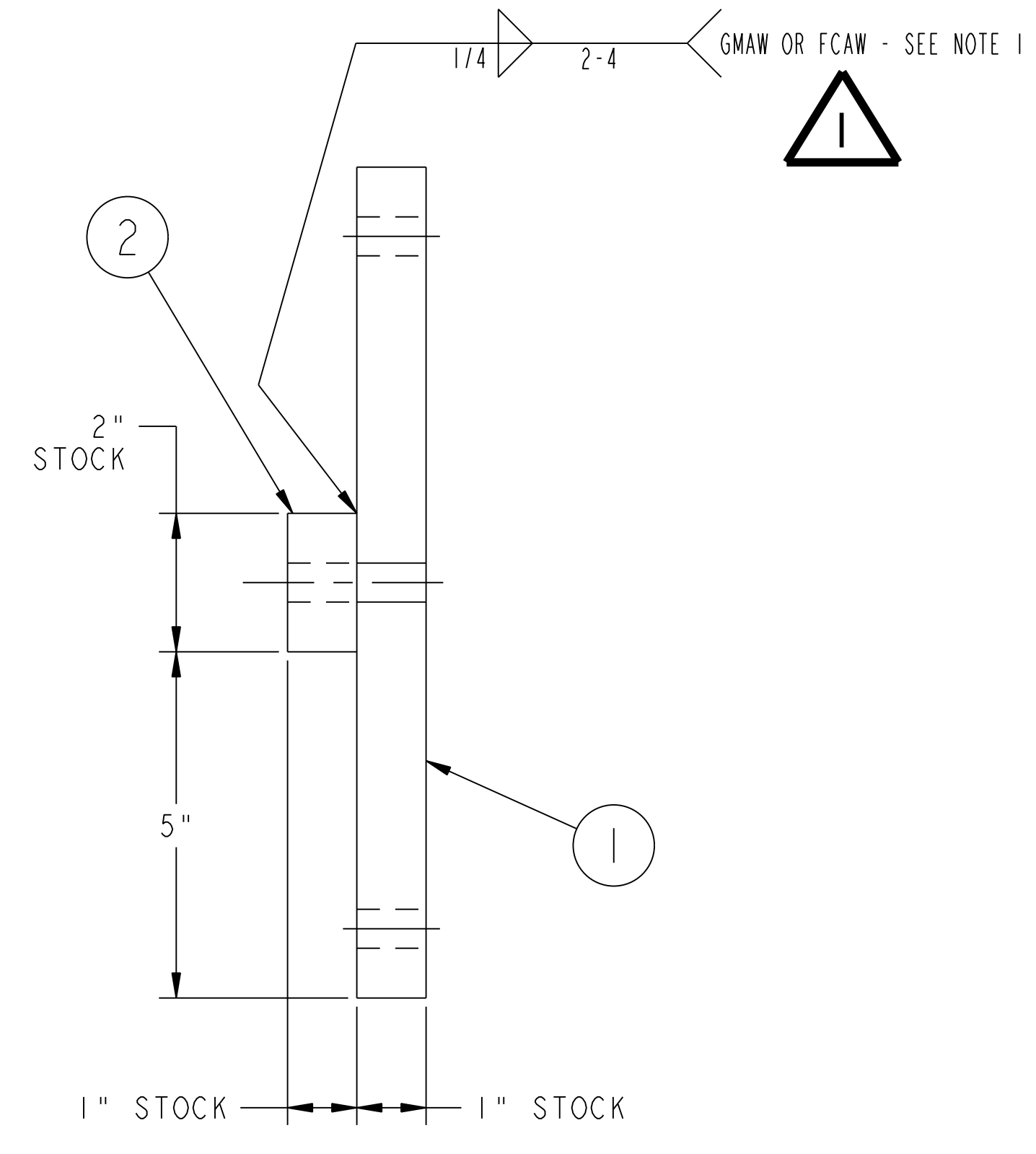
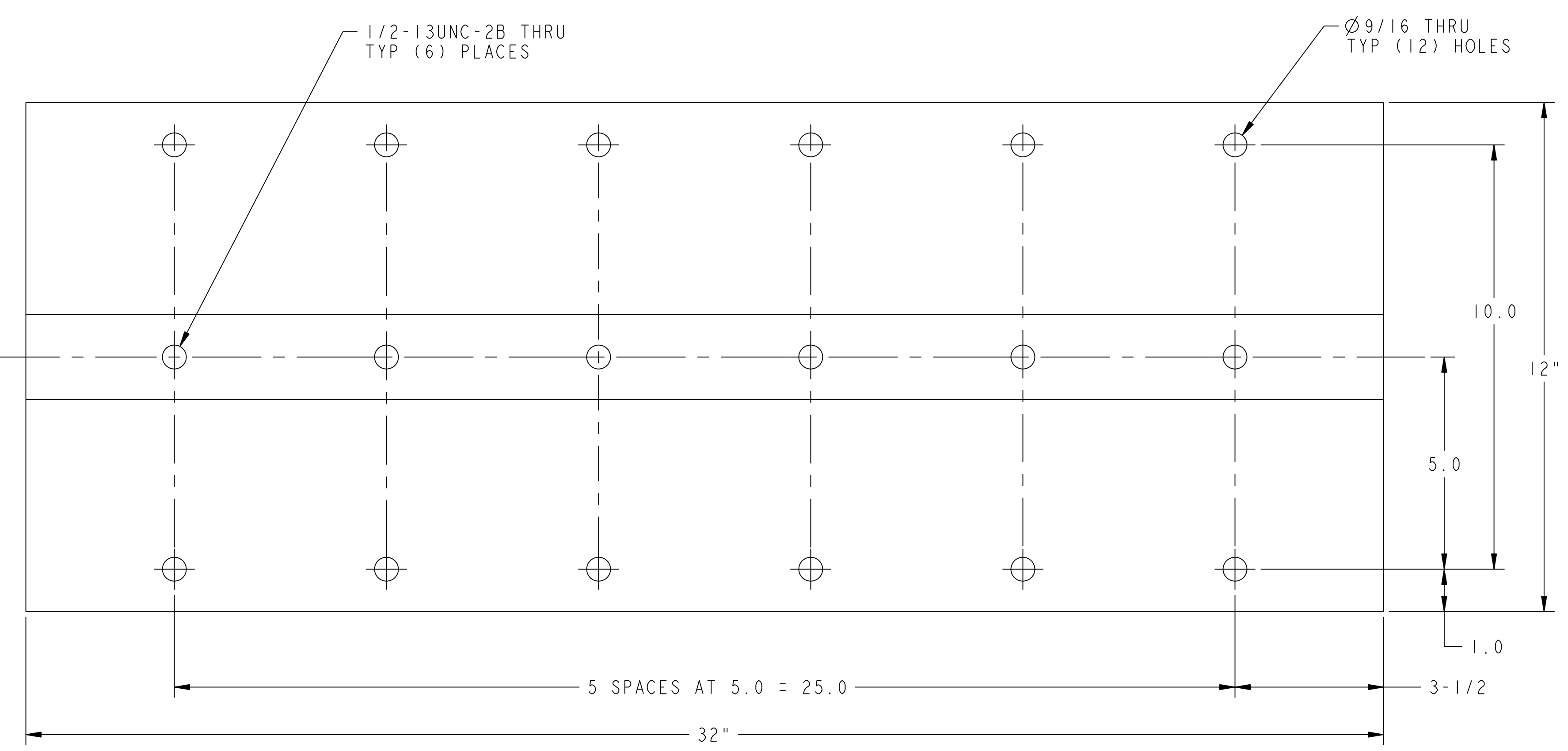

**NOTES**

1. WELDING SHALL BE PERFORMED IN ACCORDANCE WITH THE REQUIREMENTS OF AWS D1.1 OR PPPL PROCEDURE ENG-037. VISUAL WELD INSPECTION SHALL BE PERFORMED IN ACCORDANCE WITH THE ACCEPTANCE CRITERIA OF AWS D1.1 Section 6.
2. ALL HOLES TO BE MACHINED AFTER ALL WELDING IS COMPLETE.

01 ASSEMBLY - FLOOR MOUNTED ANTI-TIPPING PLATE WELDMENT - TYPE "A"

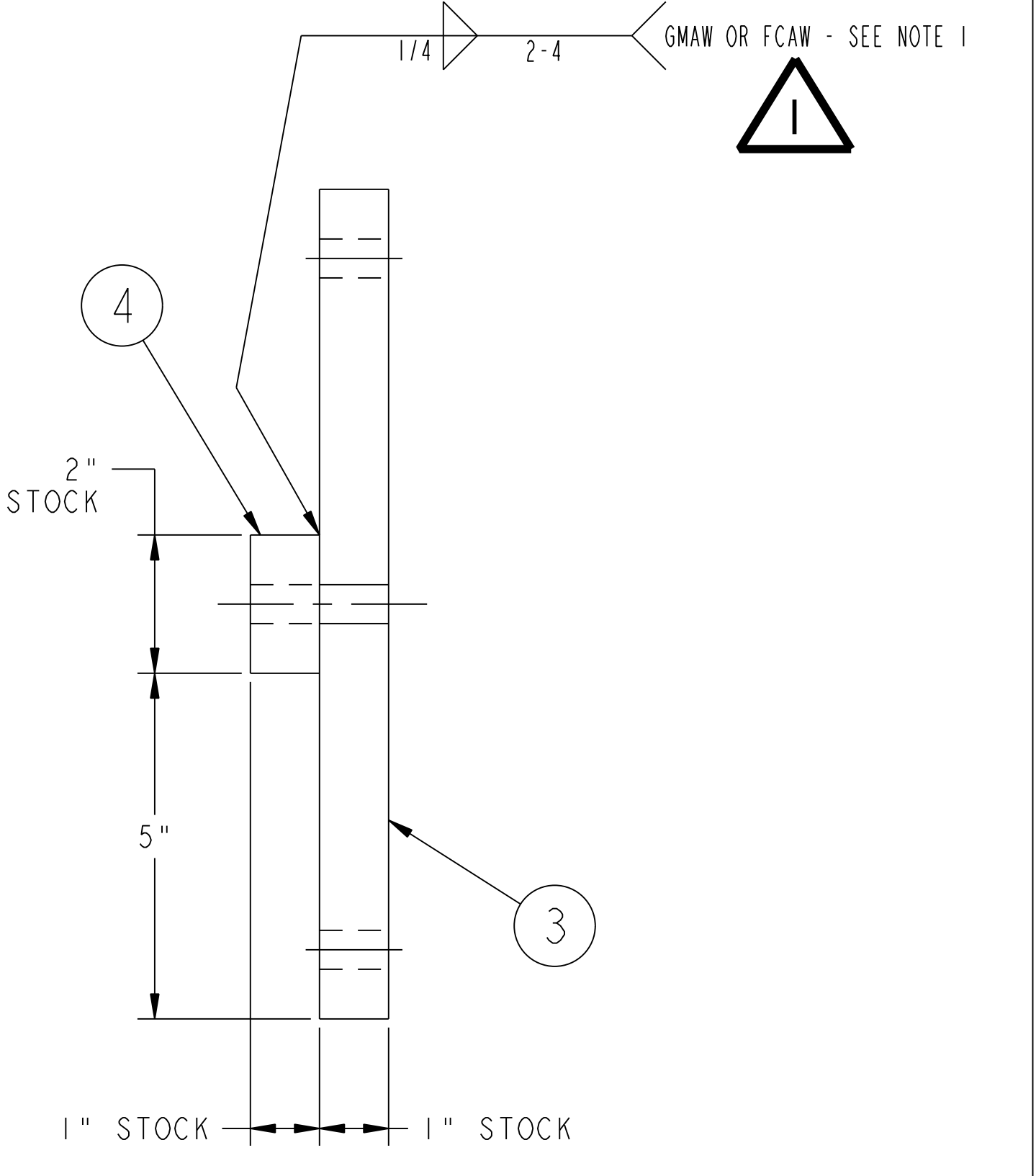
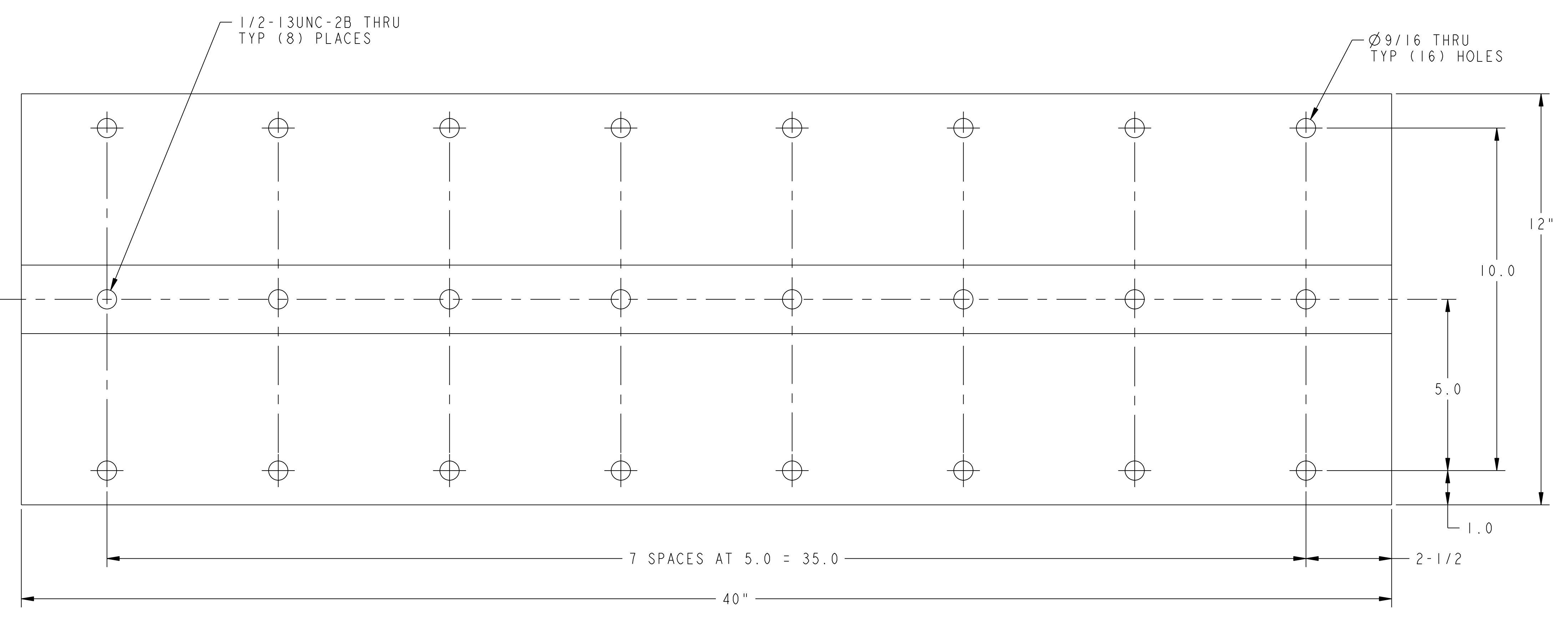

02 ASSEMBLY - FLOOR MOUNTED ANTI-TIPPING PLATE WELDMENT - TYPE "B"

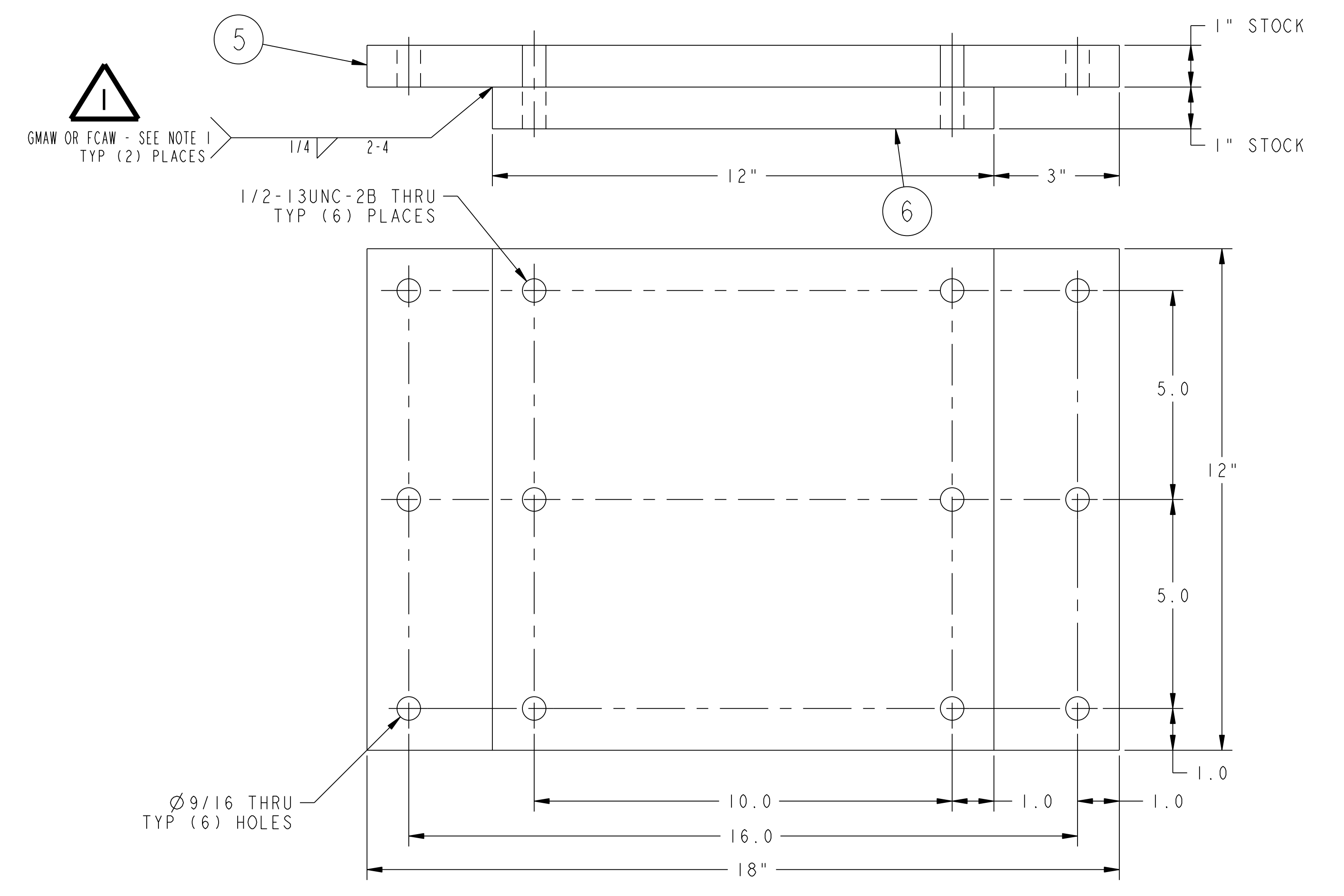

03 ASSEMBLY - FLOOR MOUNTED ANTI-TIPPING PLATE WELDMENT - TYPE "C"

RELEASED FOR  
FABRICATION / INSTALLATION  
PPPL Drafting:

REV	NO.	DATE	DESCRIPTION	MATERIAL	QTY	RECD
	6		THIS DWG	ANTI-TIP MOUNTING PLATE - TYPE "D"	ASTM A36	
	5		THIS DWG	ANTI-TIP MOUNTING PLATE - TYPE "C"	ASTM A36	
	4		THIS DWG	ANTI-TIP MOUNTING BAR - TYPE "B"	ASTM A36	
	3		THIS DWG	ANTI-TIP MOUNTING PLATE - TYPE "B"	ASTM A36	
	2		THIS DWG	ANTI-TIP MOUNTING BAR - TYPE "A"	ASTM A36	
	1		THIS DWG	ANTI-TIP MOUNTING PLATE - TYPE "A"	ASTM A36	
			THIS DWG	FLOOR MOUNTED ANTI-TIPPING PLATE WELDMENT - TYPE "C"		2
			THIS DWG	FLOOR MOUNTED ANTI-TIPPING PLATE WELDMENT - TYPE "B"		1
			THIS DWG	FLOOR MOUNTED ANTI-TIPPING PLATE WELDMENT - TYPE "A"		1

COMPUTER GENERATED DRAWING	CENTRAL FILES:	PRINCETON PLASMA PHYSICS LABORATORY
MANUAL CHANGES NOT PERMITTED	UNLESS OTHERWISE SPECIFIED	NATIONAL COMPACT STELLARATOR EXPERIMENT
Pro E	DIMENSIONS ARE IN INCHES	FIELD PERIOD ASSEMBLY
DO NOT VERIFY INFORMATION BY SCALING DRAWING	BREAK SHARP EDGES .005/.020	FLOOR MOUNTED ANTI-TIPPING PLATE WELDMENTS
	TOLERANCES NON-CUMULATIVE	DSN: L. MORRIS 12-11-07 DRAWING NO:
	DECIMAL-INCH FRACTIONS	CHK: M. COLE 12-11-07
	ANGULAR ±0°15'	ENGR: T. BROWN 12-11-07
		SUPV: J. SIEGEL 12-11-07

RELEASE LEVEL: Fabrication  
DWG VERSION NO: 3

WEIGHT	128.6 lbs
MODEL NAME	SE186-327-01
WELDING ENGINEER	L. DUDEK 11-14-07

NCSX-SE186-327