

- NOTES:
1. INTERPRET DIMENSIONS AND TOLERANCES PER ANSI Y14.5M.
 2. DIMENSION ARE IN INCHES.
 3. REQUIREMENTS FOR FABRICATING THE VACUUM VESSEL SPACER ARE DEFINED IN THE DRAWINGS, MODELS, AND SPECIFICATION.
 4. GEOMETRY OF VACUUM VESSEL SPACER IS DEFINED IN CAD MODELS/FILES SEI21-015.PRT.
 5. MEASURE AND MACHINE TO FIT AT ASSEMBLY, SEI20-015.
 6. ADDITIONAL TOLERANCE LIMITS ARE DEFINED IN DOCUMENT NCSX-12-122002-PH.

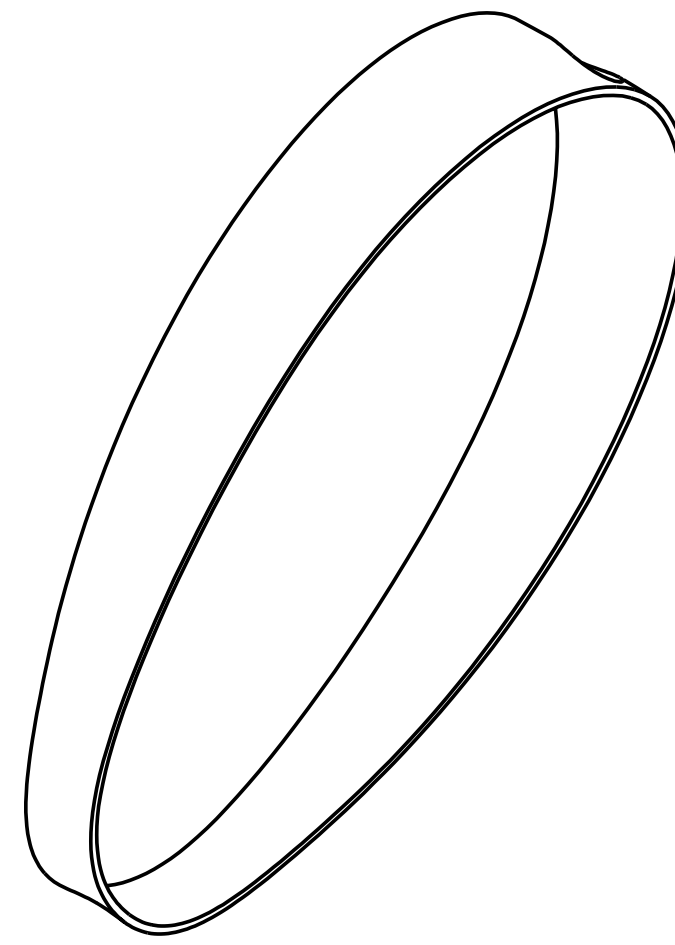

ISOMETRIC VIEW
SCALE 0.13

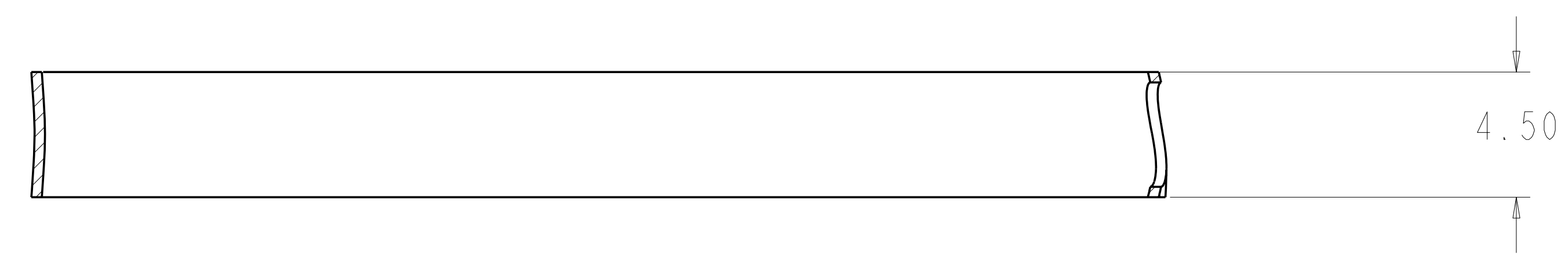

SECTION A-A

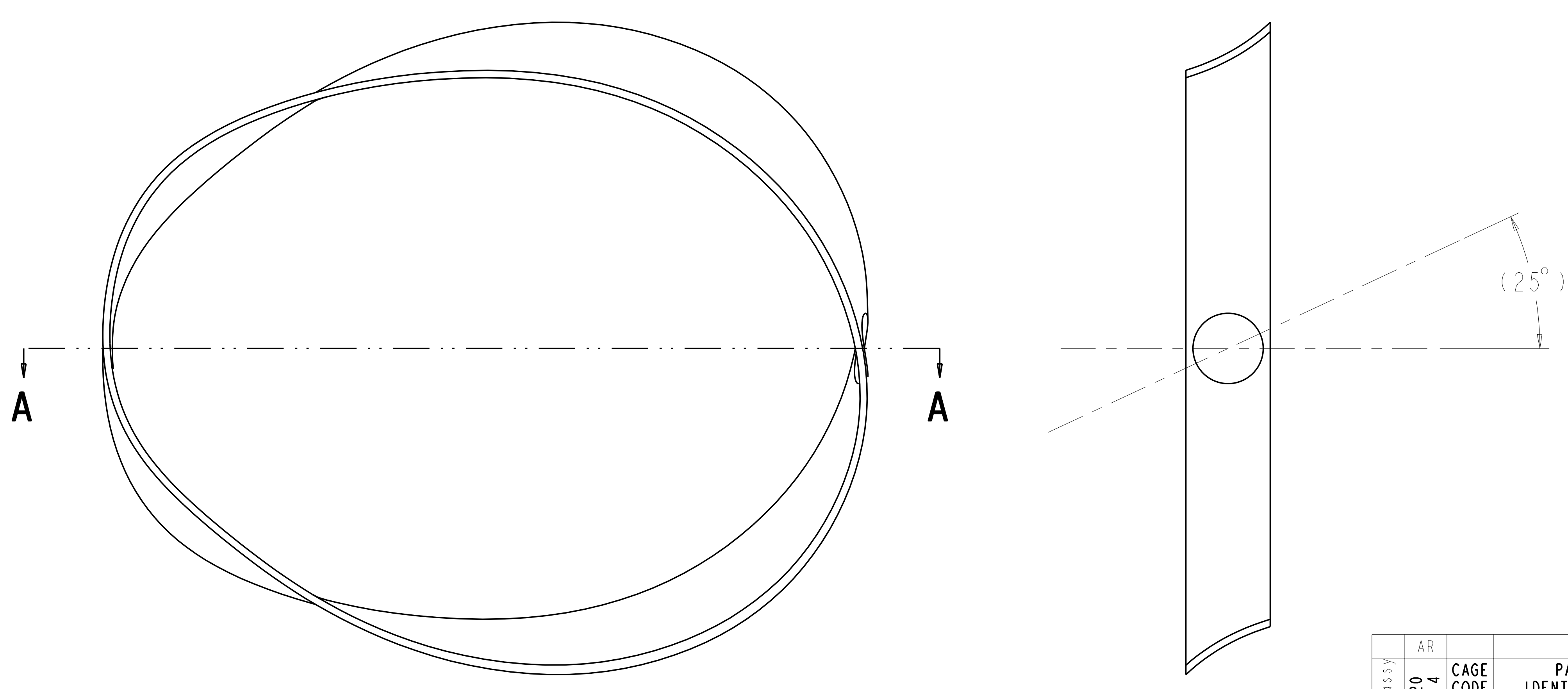

SCALE: .25

next assy	AR	-1	SPACER	UNS N06625	I
SEI20-014	CAGE CODE	PART OR IDENTIFYING NO	NOMENCLATURE OR DESCRIPTION	MATERIAL	FIND NO
		NEXT ASSEMBLY	PARTS LIST		

QUALITY VERIFICATION		
MECHANICAL AND STRUCTURAL		
REFERENCE ORNL QA-GDS		
QV CLAUSE	DOCUMENTS REQUIRED	APPLICABLE TO PART NO *
30.3	MATERIAL MILL TEST REPORT	
32.5	MATERIAL SELLER CERT	X
32.6	SPECIAL MATERIAL INSPECTION REPORT	
20.5	MANUFACTURING, INSPECTION AND TEST PLAN	X
31.2	FIELD INSPECTION AND TEST PLAN	X
32.1	WELD AND BRAZE INSPECTION REPORT	X
32.2	HEAT TREAT REPORT (INCOMPL)	X
31.0	CLEAR TEST REPORT	X
31.5	CLEANING CERT	X
31.8	DEVIATION REQUEST	X
31.9	NONCONFORMANCE REPORT	X
32.3	DIMENSIONAL REPORT	X
33.0	FUNCTIONAL TEST REPORT	
100	DOCUMENTATION	X

DES P. L. GORANSON 8/03
 DRW G. H. JONES 8/03

UT-BATTELLE
 Oak Ridge National Laboratory
 managed for the DEPARTMENT OF ENERGY under
 U.S. GOVERNMENT contract DE-AC05-00OR22725
 UT-BATTELLE, LLC. Oak Ridge, Tennessee

NATIONAL COMPACT STELLERATOR EXPERIMENT

VACUUM VESSEL
 SPACER BODY
 DETAIL

PPPL DRFT	VERSION NO.	PLANT	BLDG	FL	SHT OF	TYPE	CLASS
	000	XX	XX	XX	1	XX	U
	RELEASE LEVEL						REV
	000						A

SEI21-015

REV	DESCRIPTION	DATE	BY	CHKD	APPD
A	GEN REVISION	GHJ	5/03		

NO REPRESENTATION OR WARRANTY, EXPRESSED OR IMPLIED, IS MADE AS TO THE ACCURACY, COMPLETENESS OR USEFULNESS OF THE INFORMATION OR STATEMENTS CONTAINED IN THESE DRAWINGS, OR THAT THE USE OR DISCLOSURE OF ANY INFORMATION, APPARATUS, METHOD OR PROCESS DISCLOSED IN THESE DRAWINGS MAY NOT INFRINGE PRIVATE RIGHTS OF OTHERS. NO LIABILITY IS ASSUMED WITH RESPECT TO THE USE OF, OR FOR DAMAGES RESULTING FROM THE USE OF, ANY INFORMATION, APPARATUS, METHOD OR PROCESS DISCLOSED IN THESE DRAWINGS. DRAWINGS MADE AVAILABLE FOR INFORMATION TO BIDDER ARE NOT TO BE USED FOR OTHER PURPOSES, AND ARE TO BE RETURNED UPON REQUEST OF THE FORWARDING CONTRACTOR.

P THIS DRAWING PRODUCED ON PRO-ENGINEER

SEI21-015