

- NOTES:
- DRAWING PREPARED IN ACCORDANCE WITH ASME Y14.100-2000.
  - INTERPRET DIMENSIONS AND TOLERANCES PER ANSI Y14.5M
  - DIMENSIONS ARE IN INCHES
  - DIMENSIONS APPLY AT ROOM TEMPERATURE. OPERATING TEMP 80 K.
  - LEADS AREA SHALL BE COVERED OR SPRAYED WITH AN INSULATING MATERIAL TO PREVENT DEBRIS FROM CAUSING AN ELECTRICAL SHORT DURING OPERATION.
  - OPTIONAL BLANKET INSULATION ASSEMBLY, F/N 18, NOT SHOWN. SEE DRAWING SE122-009 FOR INSTALLATION.
  - SEE LATEST REVISION OF PROCEDURE D-NCSX-MCF-001 FOR ADDITIONAL REQUIREMENTS.
  - WELDING SHALL BE PERFORMED IN ACCORDANCE WITH THE REQUIREMENTS OF PPPL PROCEDURE NO. ENG-037. VISUAL WELD INSPECTION SHALL BE PERFORMED IN ACCORDANCE WITH THE ACCEPTANCE CRITERIA OF AWS D1.6.
  - VENDOR INFORMATION: TRULY TUBULAR FITTING CORP  
 PO BOX 1160  
 MT VERNON, NY 10550  
 914-664-8686 OR WWW.TRULYTUBULAR.COM
  - VENDOR INFORMATION: FISO FIBER OPTICS  
 500 ST. JEAN BAPTISTE AVE SUITE 195  
 QUEBEC QC, G2E 5R CANADA  
 418-688-8065 OR WWW.FISO.COM
  - VENDOR INFORMATION: OMEGA ENGINEERING CORP  
 ONE OMEGA DRIVE  
 STAMFORD, CT 06907  
 800-848-4286 OR WWW.OMEGA.COM
  - SOME PARTS IN THIS ASSEMBLY ARE GRAPHIC REPRESENTATIONS OF ACTUAL PARTS/ASSEMBLIES. PART IDENTIFICATION NUMBERS REFER TO ACTUAL PARTS. FOR FULL MODELED ASSEMBLY SEE SE140-102.
  - TYPE "C" COIL: REMOVE ALL STUDS AFTER CLAMP AND INSULATION BLANKETS ARE ASSEMBLED (POST VPI).

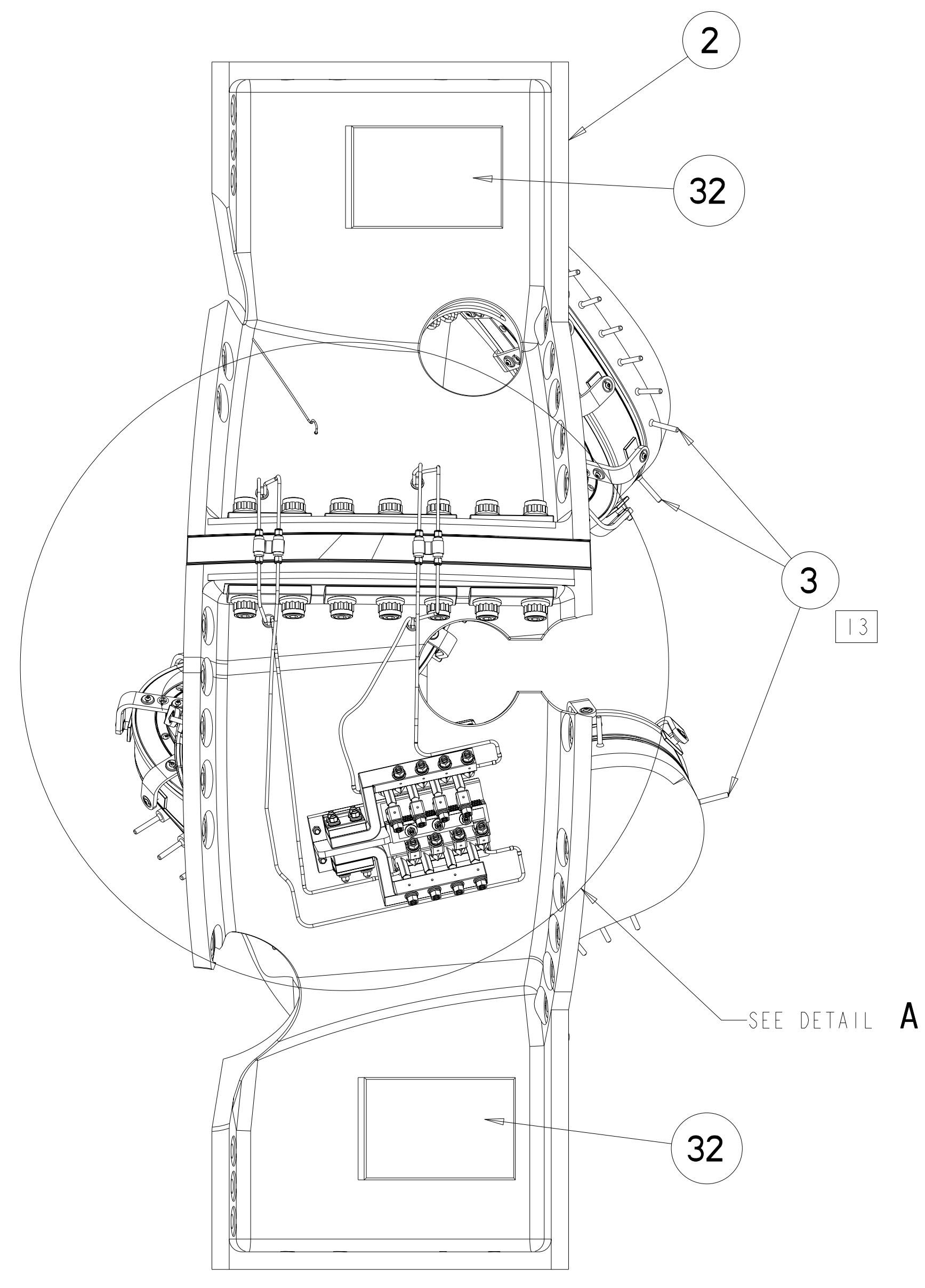

1 TYPE-C MODULAR COIL ASSEMBLY

SCALE: 0.125

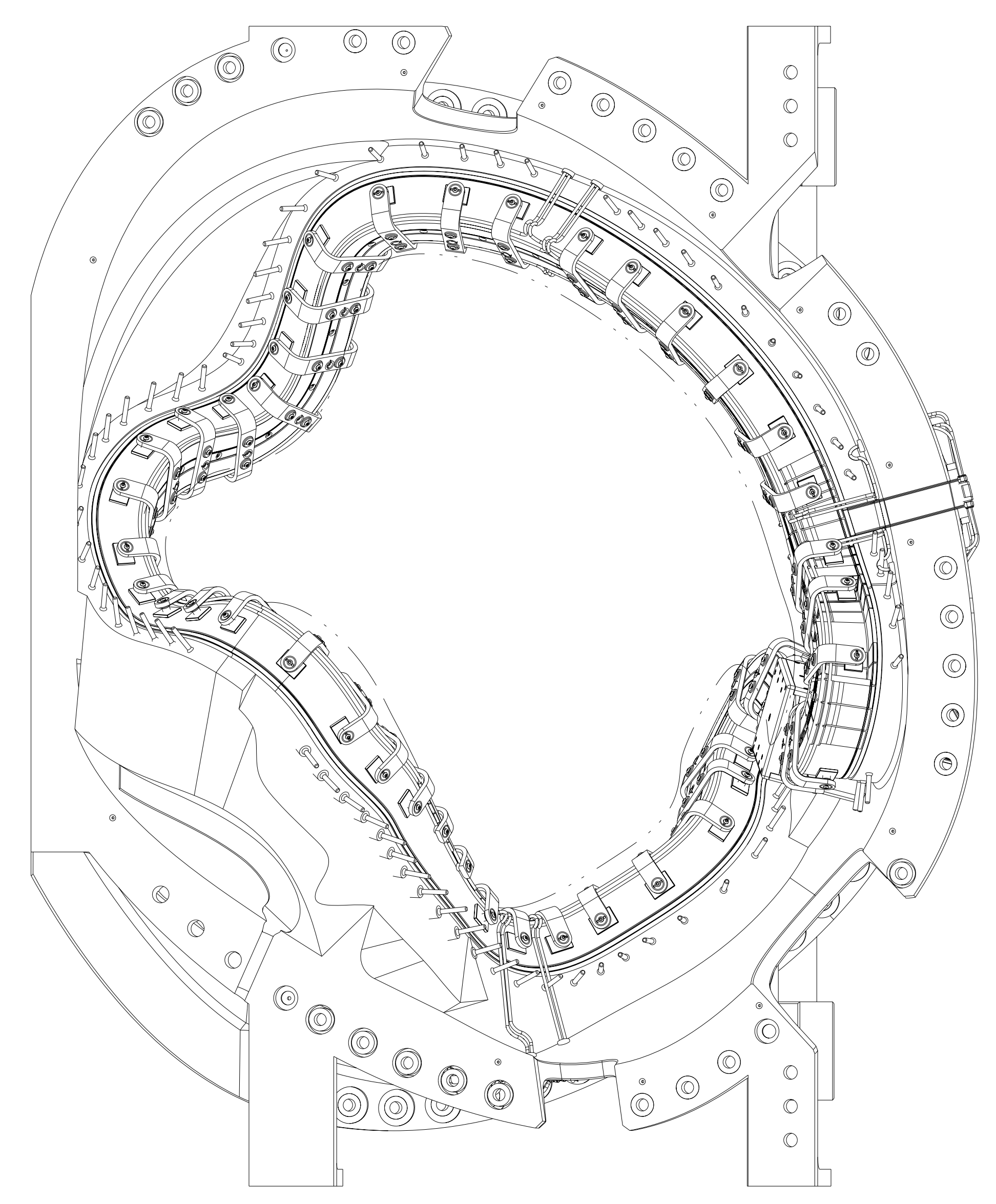
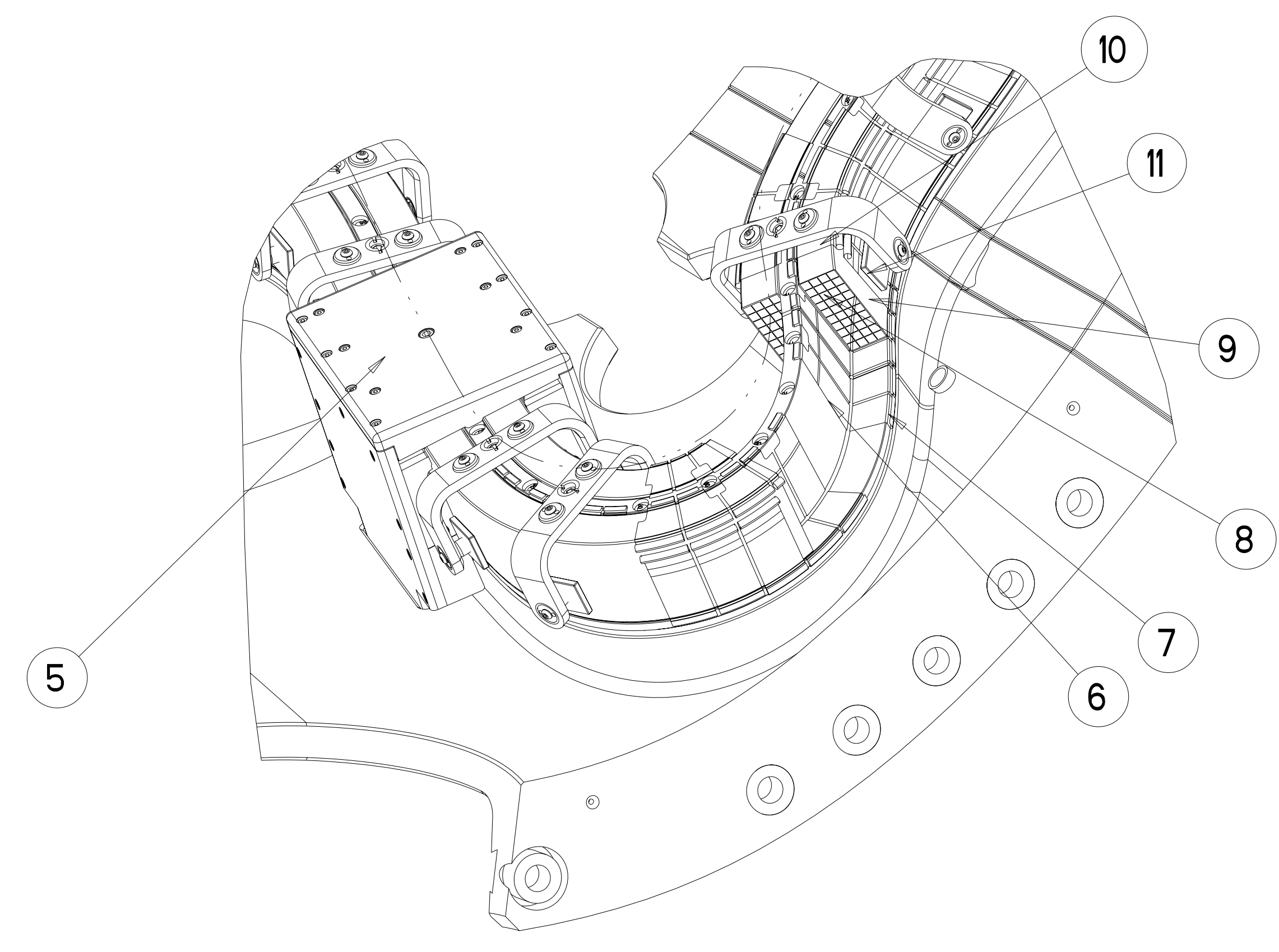

CUT-AWAY VIEW SHOWING WINDING INSTALLATION SEQUENCE (SIDE "A")

SCALE 0.25

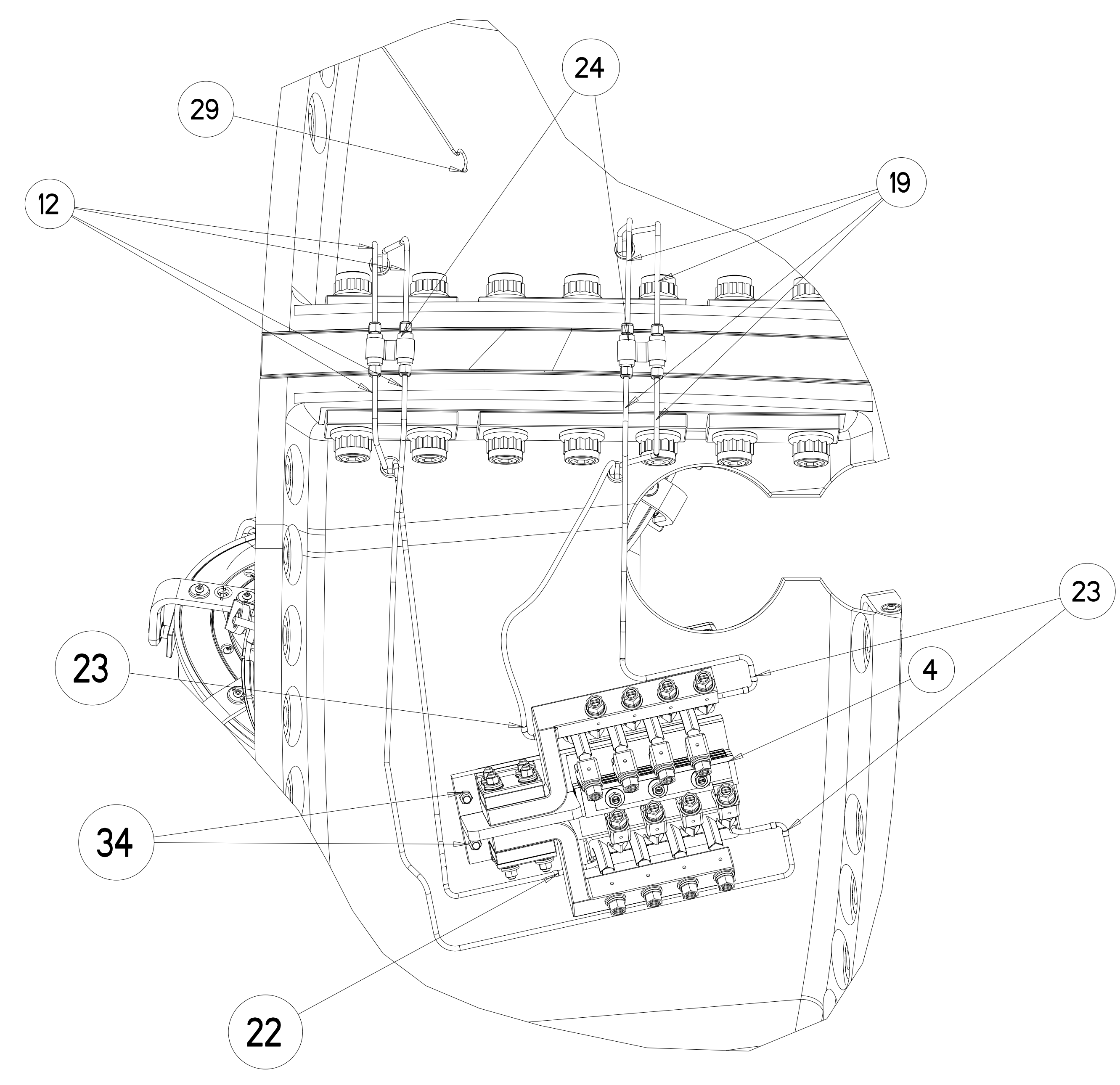

DETAIL A

SCALE 0.250

REV	DESCRIPTION	BY	DATE	CHK	DEPT	DATE	PE	REQ	DATE	ORNL	DOE	DATE
4	-34											
12	SE142C-014											
2	SE142C-015											
10	AR SE142C-013											
2	SS-810-1-8											
11	2 SE142C-016											
6	SE1851-170											
13	SE141-204											
16	5FF-5-4											
AR	SE142C-011											
2	SE142C-020											
9	3 90FF-4											
9	2 10FF-4											
6	AR SE122-009											
AR	SE142C-010											
12	AR SE142C-248											
1	SE142C-488											
1	SE142C-486											
AR	SE142C-243											
1	SE142C-241											
1	SE142C-484											
1	SE142C-482											
AR	SE142C-258											
1	SE142C-388											
1	SE142C-386											
AR	SE142C-253											
1	SE142C-251											
1	SE142C-384											
12	1 SE142C-382											
1	SE142C-080_2											
1	SE142C-050											
13	TEMP_060831A											
1	SE141-103											
1	-1											

SEI40-003	CAGE CODE	PART OR IDENTIFYING NO	NOMENCLATURE OR DESCRIPTION	MATERIAL	SPECIFICATION	FIND NO
SEI40-101						

NO REPRESENTATION OR WARRANTY, EXPRESSED OR IMPLIED, IS MADE AS TO THE ACCURACY, COMPLETENESS OR USEFULNESS OF THE INFORMATION OR STATEMENTS CONTAINED IN THESE DRAWINGS, OR THAT THE USE OR DISCLOSURE OF ANY INFORMATION, APPARATUS, METHOD OR PROCESS DISCLOSED IN THESE DRAWINGS MAY NOT INFRINGE PRIVATE RIGHTS OF OTHERS. NO LIABILITY IS ASSUMED WITH RESPECT TO THE USE OF, OR FOR DAMAGES RESULTING FROM THE USE OF, ANY INFORMATION, APPARATUS, METHOD OR PROCESS DISCLOSED IN THESE DRAWINGS. DRAWINGS MADE AVAILABLE FOR INFORMATION TO BIDDER ARE NOT TO BE USED FOR OTHER PURPOSES, AND ARE TO BE RETURNED UPON REQUEST OF THE FORWARDING CONTRACTOR.

**P** THIS DRAWING PRODUCED ON PRO-ENGINEER

SCALE NOTED  
 TOLERANCES UNLESS OTHERWISE SPECIFIED  
 FRACTIONS :  
 XX DECIMALS ±.01  
 XXX DECIMALS ±.005  
 ANGLES ±0'15"  
 BREAK SHARP EDGES 06 MAX  
 FINISH : .125 UNLESS OTHERWISE SPECIFIED

DES: D WILLIAMSON 10-06  
 DRW: G LOVETT 10-06  
 CHK: MIKE COLE 11-06  
 SECT :  
 DEPT :  
 PE :  
 CR :  
 PJ :  
 RD :  
 PPPL DRFT J SIEGLE 11-06  
 :  
 :  
 DRAWING APPROVALS DATE

Oak Ridge National Laboratory managed for the DEPARTMENT OF ENERGY under U.S. GOVERNMENT contract DE-AC05-00OR22725 UT-BATTELLE, LLC. Oak Ridge, Tennessee  
**UT-BATTELLE**  
 NATIONAL COMPACT STELLARATOR EXPERIMENT  
 TYPE "C" MCWF  
 FINAL COIL ASSEMBLY

VERSION NO. 24  
 PLANT X-10  
 BLDG 5700  
 FL 3  
 SHT 1  
 OF 2  
 TYPE S  
 CLASS U  
 RELEASE LEVEL WIP  
 SEI40-103  
 REV 0

