

NCSX Engineering Status Meeting

May 7, 2003

Vacuum Vessel Status

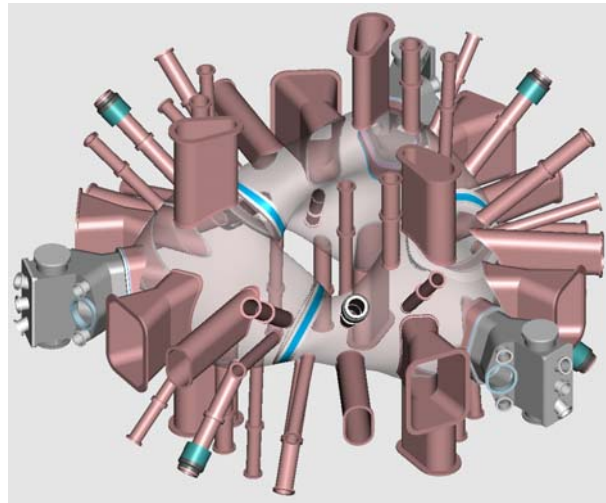

Vacuum Vessel

Vacuum Vessel

- Shell surface has been updated to reflect max/min reqts from Art Brooks
- Port 4 has been modified to reflect new geometry from Russ Feder
- Currently working on spacer and vv supports
- Model has been passed to Art Brooks and Fred Dahlgren for stress analysis

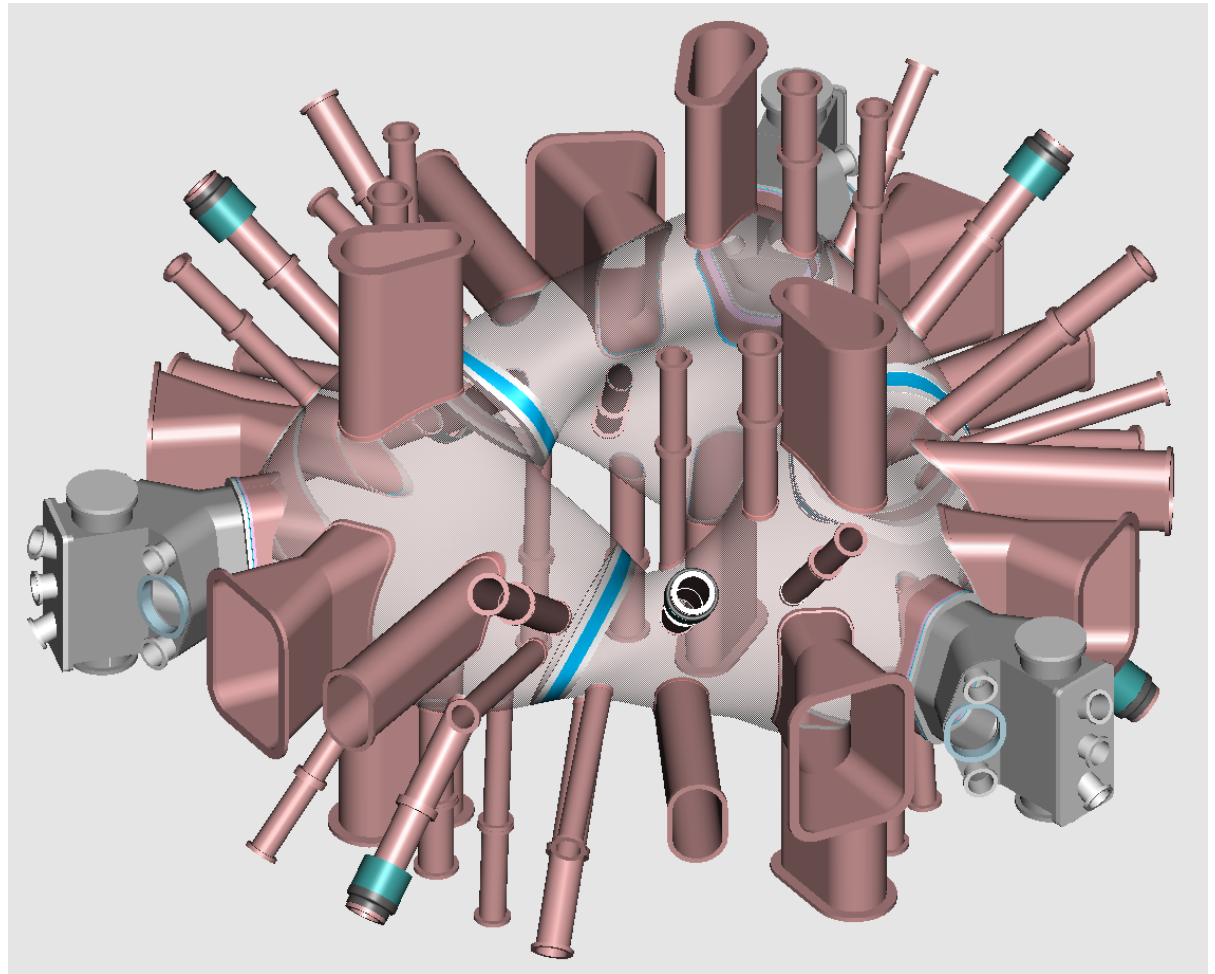

Vacuum Vessel

Vacuum Vessel Ports

- 9 ports half period
- 11 Ports on NB
- Total Ports per Period 29
- 87 Ports on VV

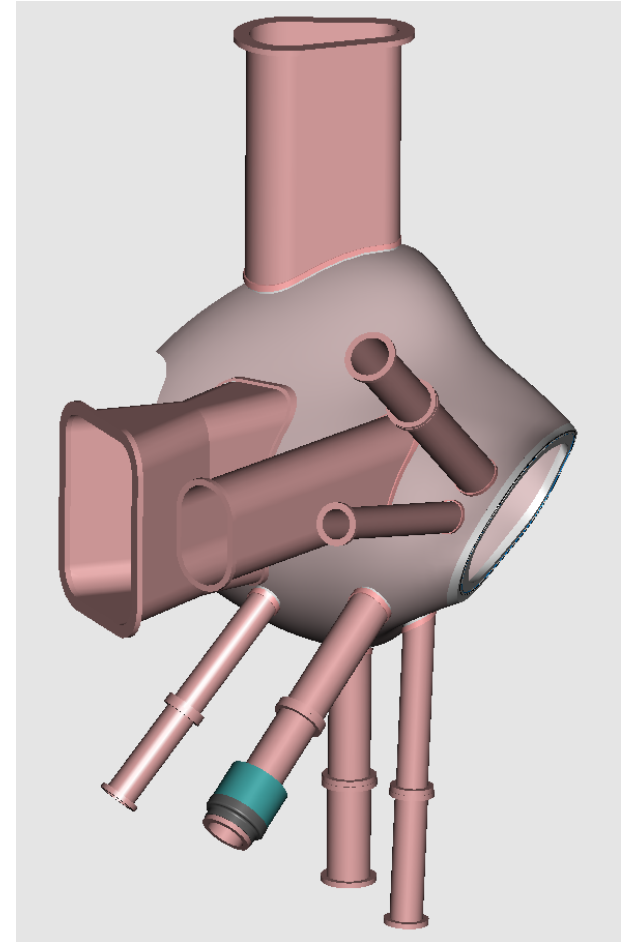
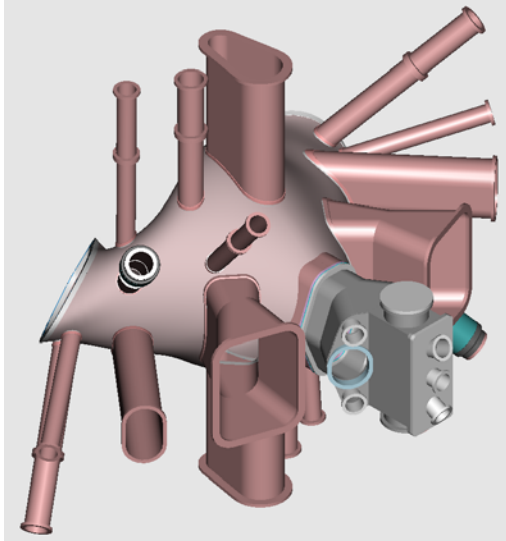
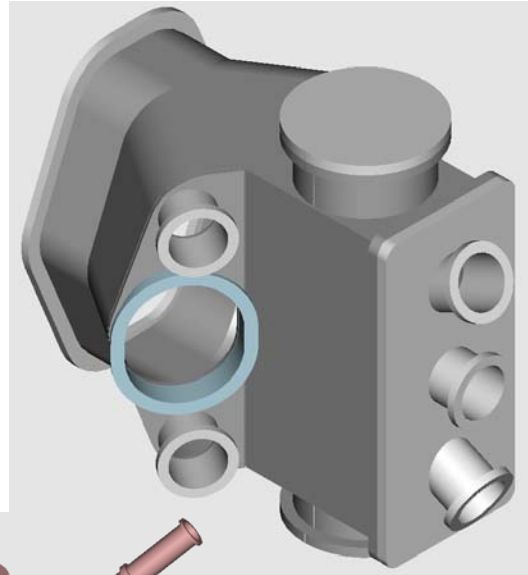

Vacuum Vessel

Plasma configurations

- Brad Nelson developed the Plasma shapes from Neil Pomphrey
- These shapes were used to generate a surface 4cm from the composite plasma shapes

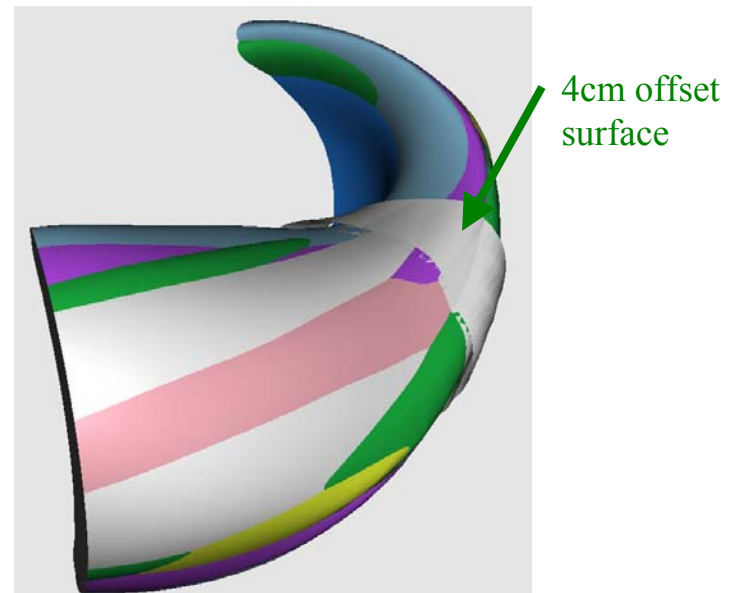
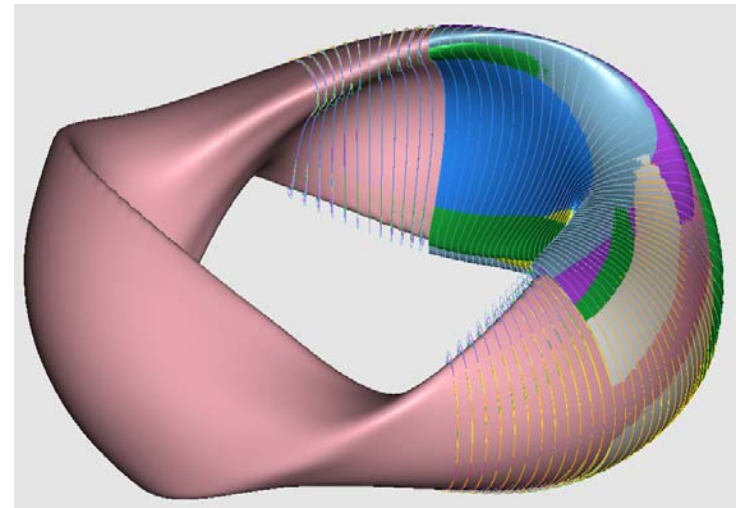

Vacuum Vessel

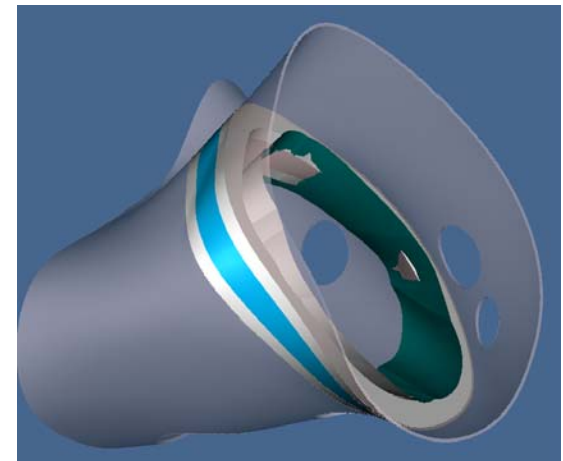
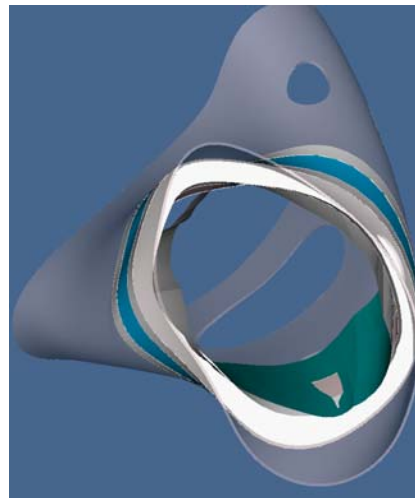
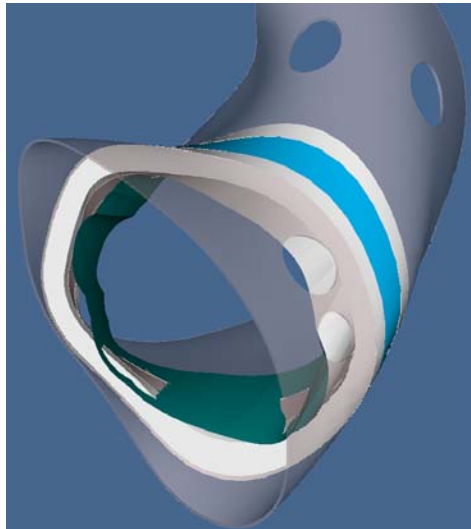
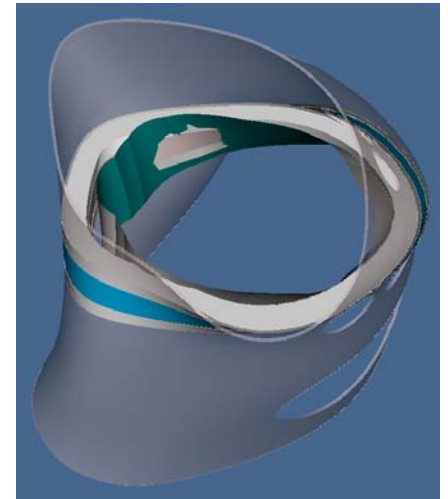
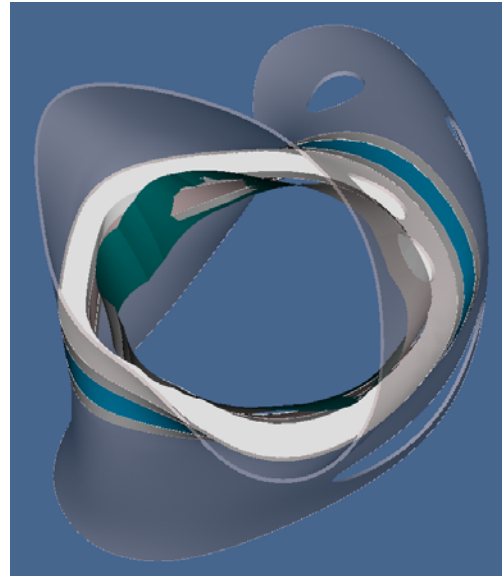
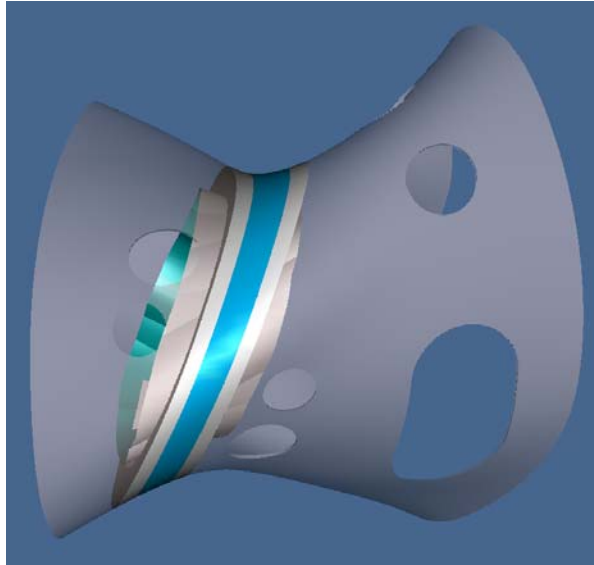

Vacuum Vessel

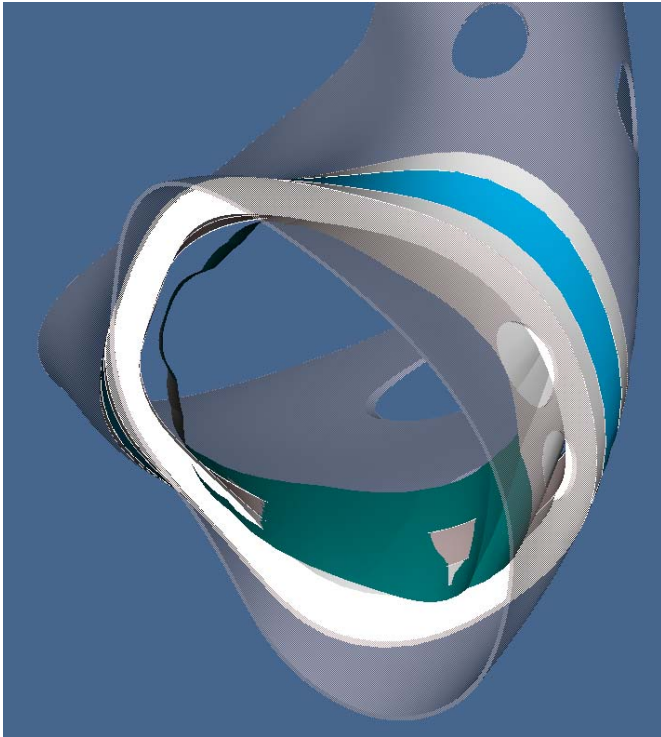

The spacer shape will be modified in this region.

The shape will be modified by moving the vessel surface in this region.