

NO.	REVISION	BY	CH	SUP	APPROVED	DATE

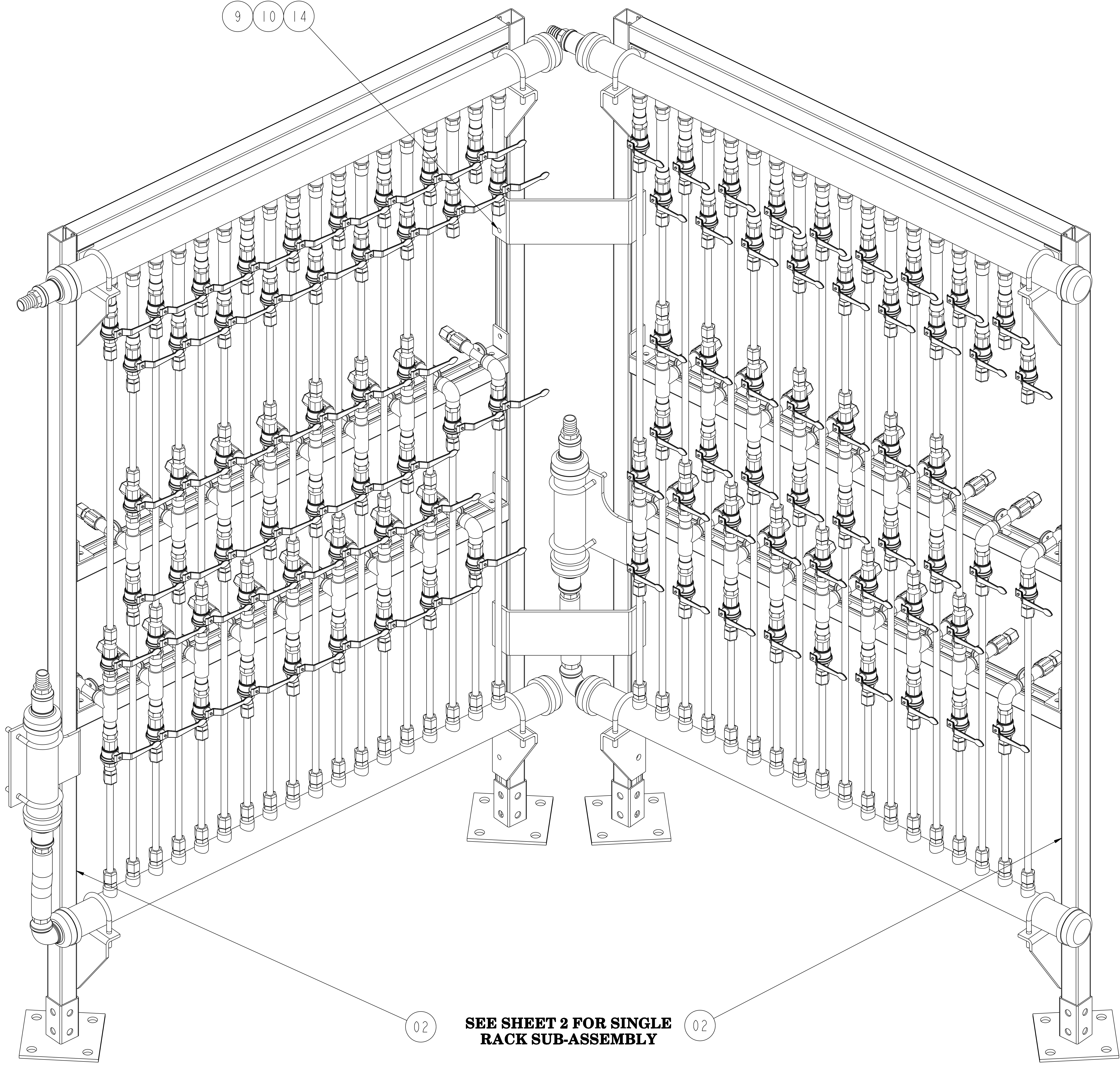

SEE SHEET 2 FOR SINGLE RACK SUB-ASSEMBLY

ISOMETRIC VIEW TWO RACK ASSEMBLY

RELEASED FOR FABRICATION / INSTALLATION
PPPL Drafting:

COMPUTER GENERATED DRAWING MANUAL CHANGES NOT PERMITTED Pro E	CENTRAL FILES:	PRINCETON PLASMA PHYSICS LABORATORY PRINCETON UNIVERSITY			
	UNLESS OTHERWISE SPECIFIED	NATIONAL COMPACT STELLARATOR EXPERIMENT			
DO NOT VERIFY INFORMATION BY SCALING DRAWING	DIMENSIONS ARE IN INCHES MACHINE SURFACES BREAK SHARP EDGES .005/.020	MODULAR COILS EPOXY FILL DELIVERY SYSTEM TWO RACK ASSEMBLY			
WEIGHT [.] lbs	TOLERANCES NON-CUMULATIVE	DSN:	B. PAUL	2/23/05	DRAWING NO:
MODEL NAME SEI144-205-02	DECIMAL-INCH FRACTIONS	CHK:	T. MEIGHAN	2/23/05	SEI144-205
RELEASE LEVEL: Fabrication DWG VERSION NO: 2	NEXT ASSEMBLY	ENGR:	J. CHRZANOWSKI	2/23/05	SHEET 1 OF 2
WELDING ENGINEER	ANGULAR	SUPV:	J. SEIGEL	2/23/05	REV 0

NCSX-SEI144-205

NO.	REVISION	BY	CH	SUP	APPROVED	DATE

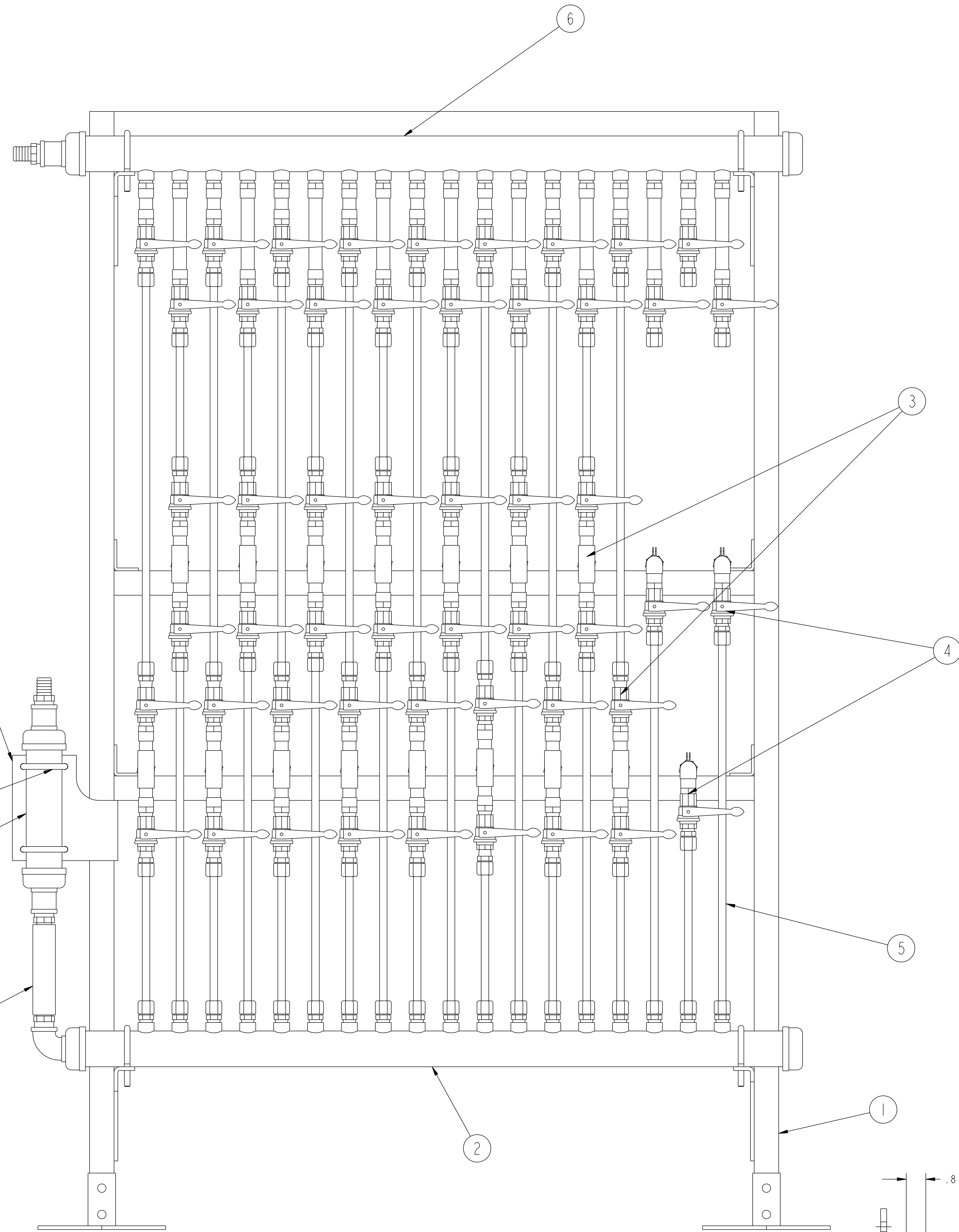

TYPICAL SINGLE RACK PIPING ASSEMBLY
NO. REQ'D = 2

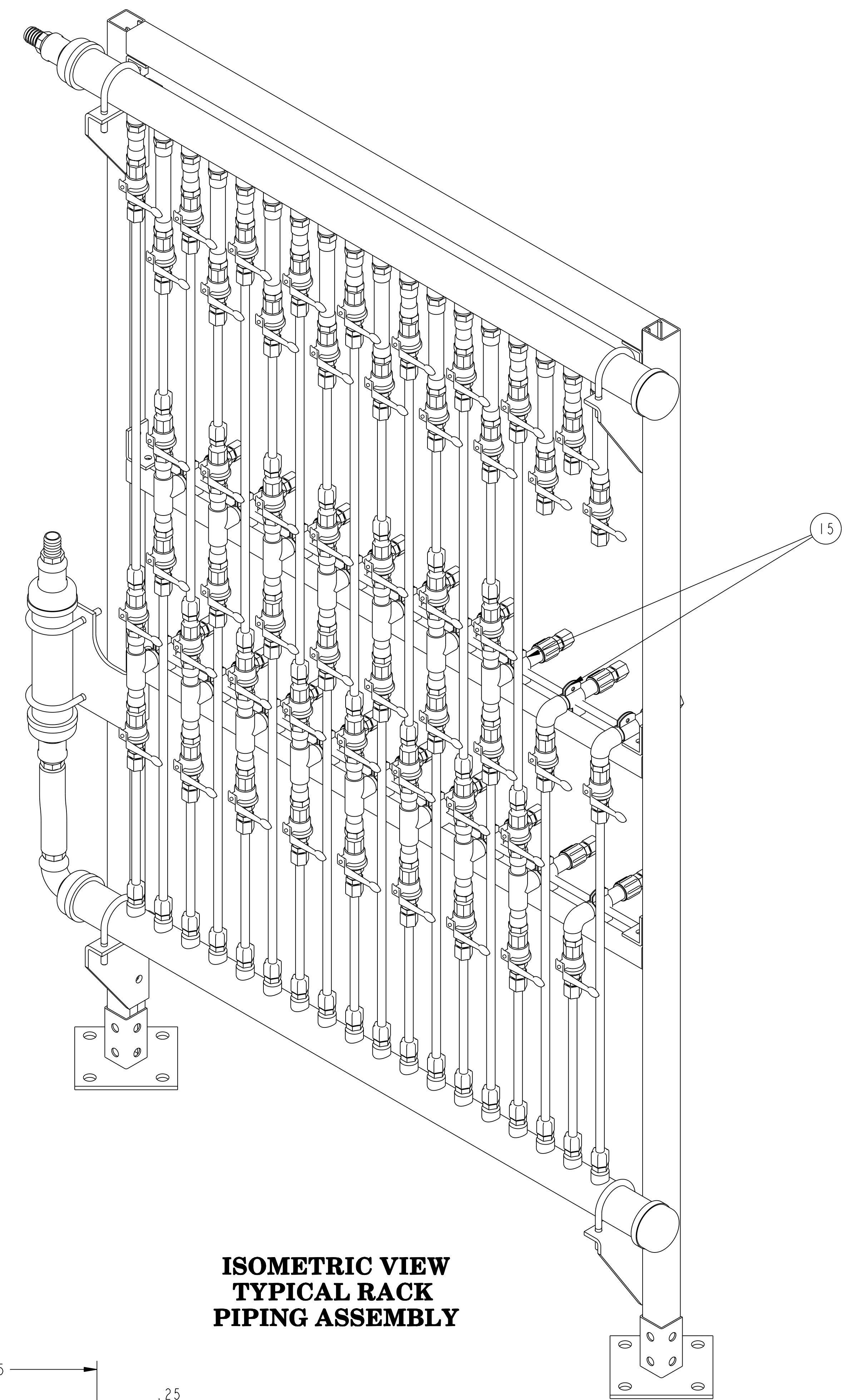

ISOMETRIC VIEW TYPICAL RACK PIPING ASSEMBLY

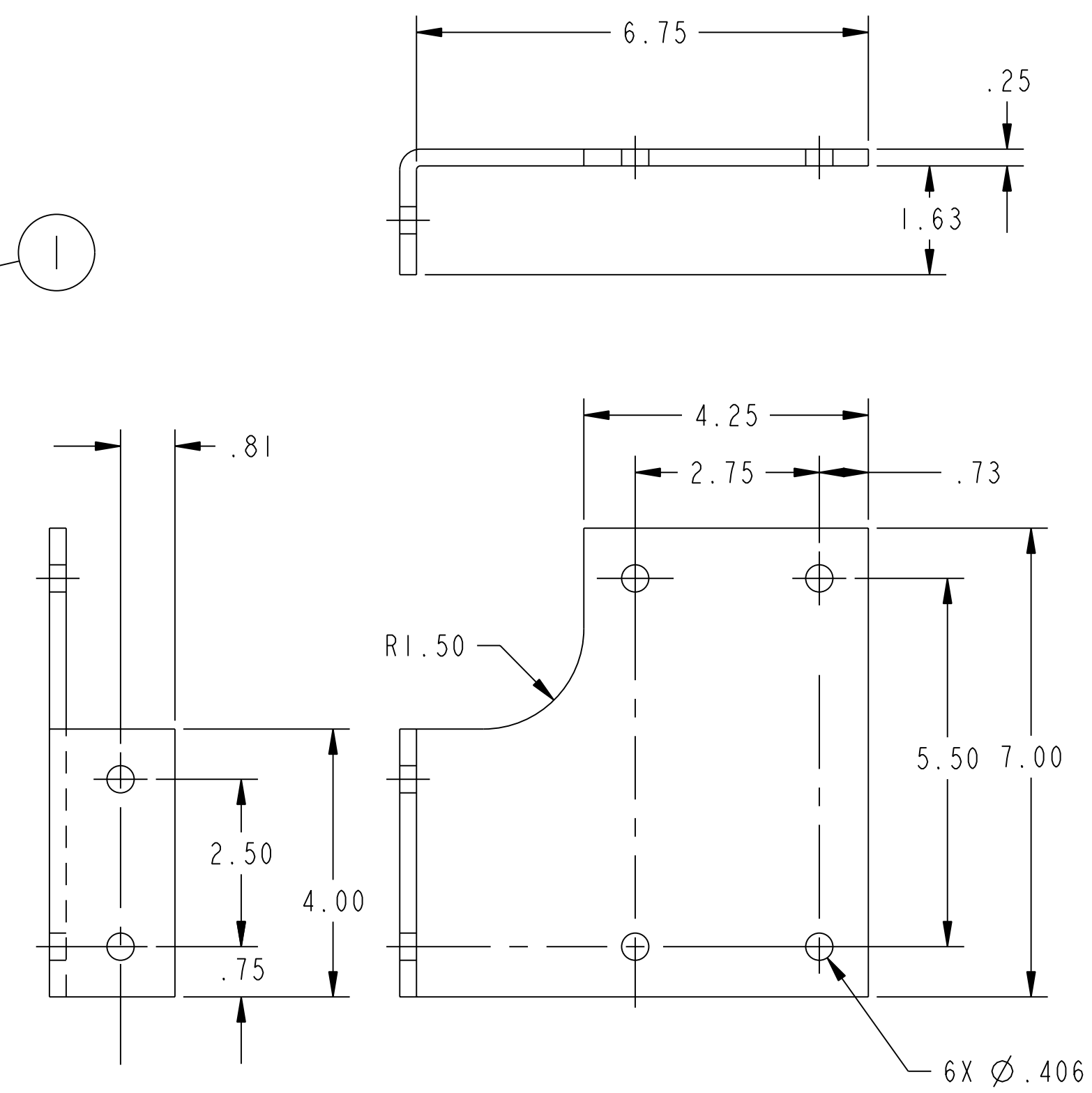

PART 8

15	COMM	O.D. TUBING CLAMP B2027 (B-LINE SYSTEMS)	-----	36
14	SE144-206-6	TWO RACK JOINING PLATE	SEE DWG.	2
13	THIS DWG	1 "I.D. X 1/4" WALL TUBING LG. AR.	TYGON	AR
12	THIS DWG	HEX NUT 3/8-16UNC	SS	24
11	SE144-206-7	Ø 3/8" PIPE U-BOLT	SEE DWG.	12
10	COMM	NUT 3/8"-16UNC N228WO (B-LINE SYSTEMS)	-----	12
9	THIS DWG	3/8" HEX BOLT X 1 1/4" LG	SS	12
8	THIS DWG	FILTER MOUNTING PLATE	ALUMN	2
7	SE144-207-03	EPOXY FILTER ASSEMBLY	SEE DWG.	2
6	SE144-207-01	VACUUM MANIFOLD ASSEMBLY	SEE DWG.	2
5	THIS DWG	1/2" O.D. TUBING LENGTH AS REQ'D	CLEAR PVC	AR
4	SE144-207-05	SINGLE VALVE SUB-ASSEMBLY	SEE DWG.	12
3	SE144-207-04	TWO VALVE SUB-ASSEMBLY	SEE DWG.	30
2	SE144-207-02	EPOXY FILL MANIFOLD ASSEMBLY	SEE DWG.	2
1	SE144-206	TYPICAL FRAME ASSY & DETAILS	SEE DWG.	2
PART NO.	DRAWING NO.	NOMENCLATURE OR DESCRIPTION	MATERIAL	QTY REQ'D

PARTS LIST

COMPUTER GENERATED DRAWING MANUAL CHANGES NOT PERMITTED	CENTRAL FILES: UNLESS OTHERWISE SPECIFIED	PRINCETON PLASMA PHYSICS LABORATORY PRINCETON UNIVERSITY NATIONAL COMPACT STELLARATOR EXPERIMENT			
Pro E	DIMENSIONS ARE IN INCHES MACHINE SURFACES	MODULAR COILS EPOXY FILL DELIVERY SYSTEM TYPICAL RACK PIPING ASSEMBLY			
DO NOT VERIFY INFORMATION BY SCALING DRAWING	BREAK SHARP EDGES .005/.020	TOLERANCES NON-CUMULATIVE	DSN: B. PAUL	2/23/05	DRAWING NO:
NEXT ASSEMBLY	DECIMAL-INCH FRACTIONS	CHK: T. MEIGHAN	2/23/05	SE144-205	
	.XX .01-.100 0"-12" 1/16"	ENGR: J. CHRZANOWSKI	2/23/05	SHEET 2 OF 2	
	.XXX .05-120" 1/16"	SUPV: J. SEIGEL	2/23/05	REV 0	

RELEASED FOR FABRICATION / INSTALLATION
PPPL Drafting:

RELEASE LEVEL: Fabrication
DWG VERSION NO: 2

WEIGHT [.] lbs	SE144-205-02
MODEL NAME	
WELDING ENGINEER	