

Early cartoon done in July of '04 showing a longer shoulder that would not interfere with the washer(s) (simple schematic)

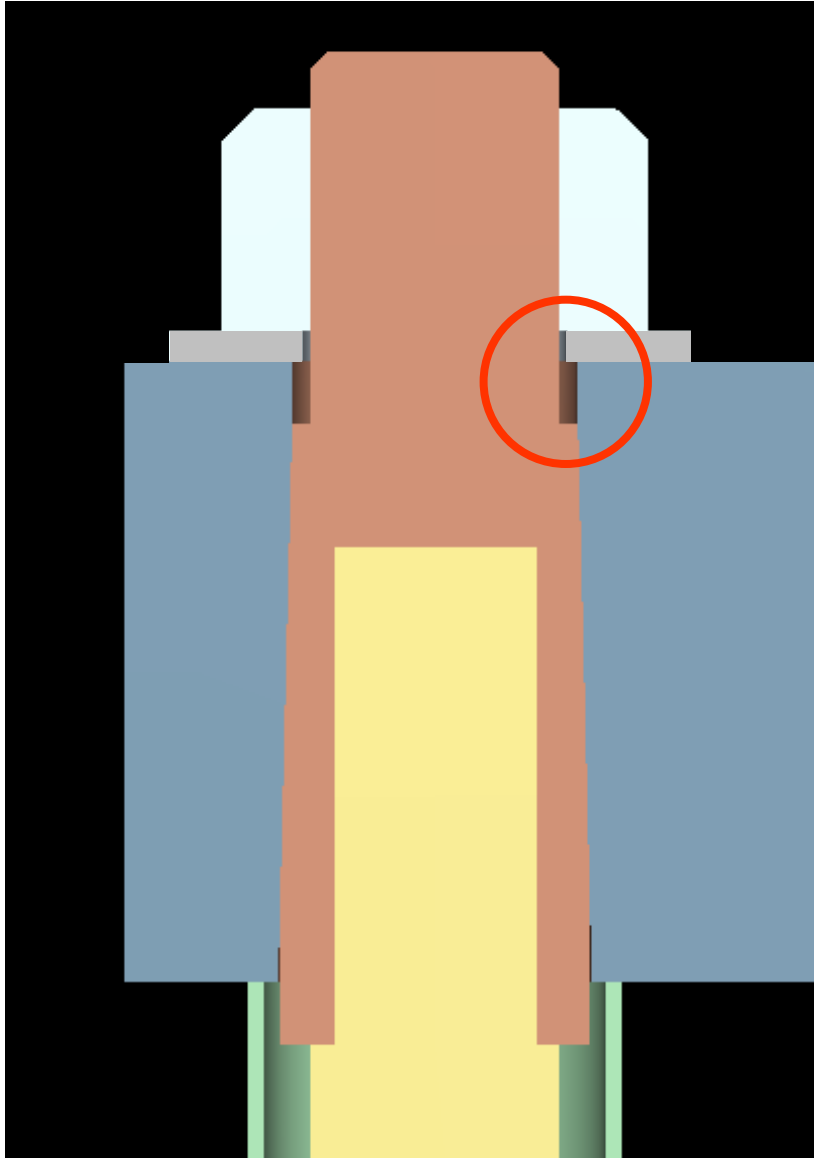

It's no mystery as to why the connector may not get fully seated in the jumper or lug sockets. The nut tightens the bellville washers against the connector shoulder, but not necessarily the socket, giving a false sense of "tightening".

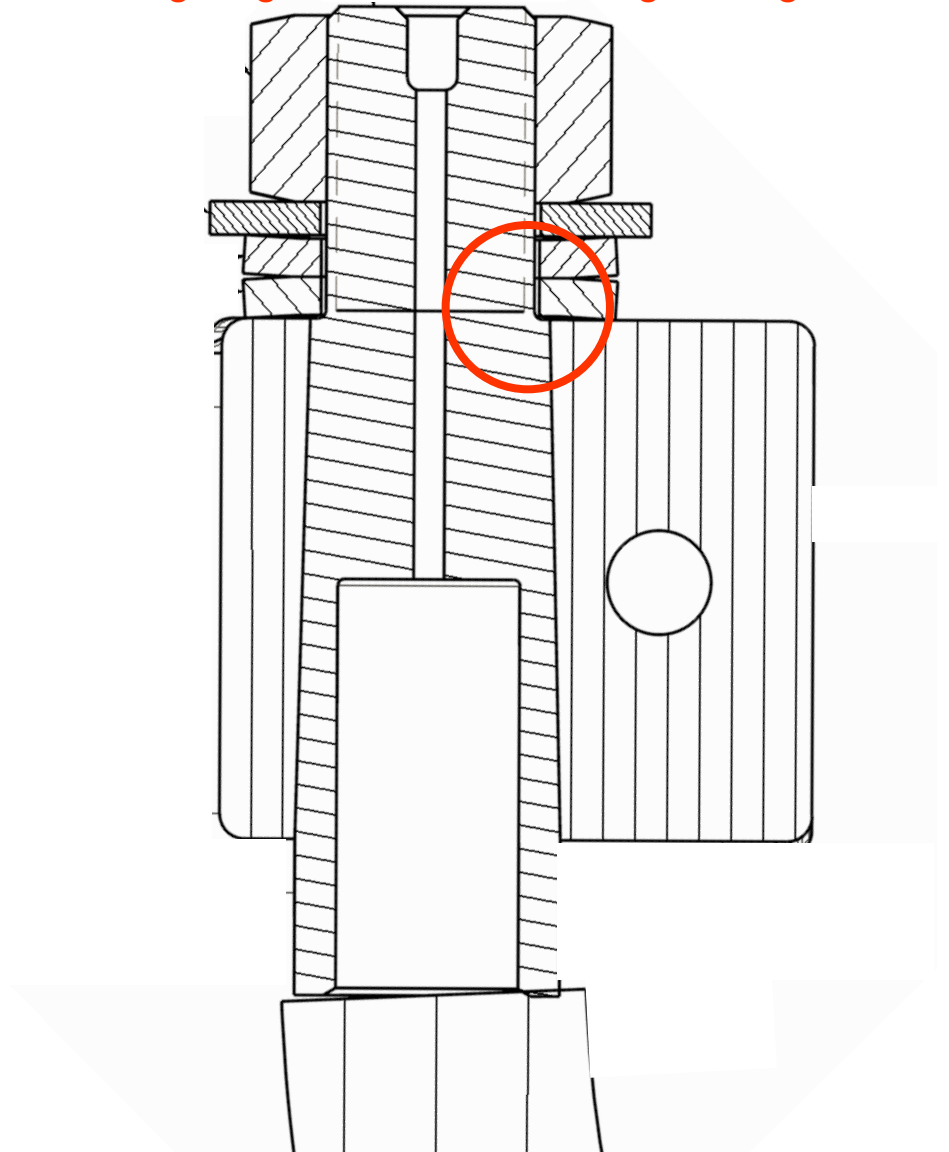

Either bore out the I.D. of the existing flat washers, or go with a larger flat washer

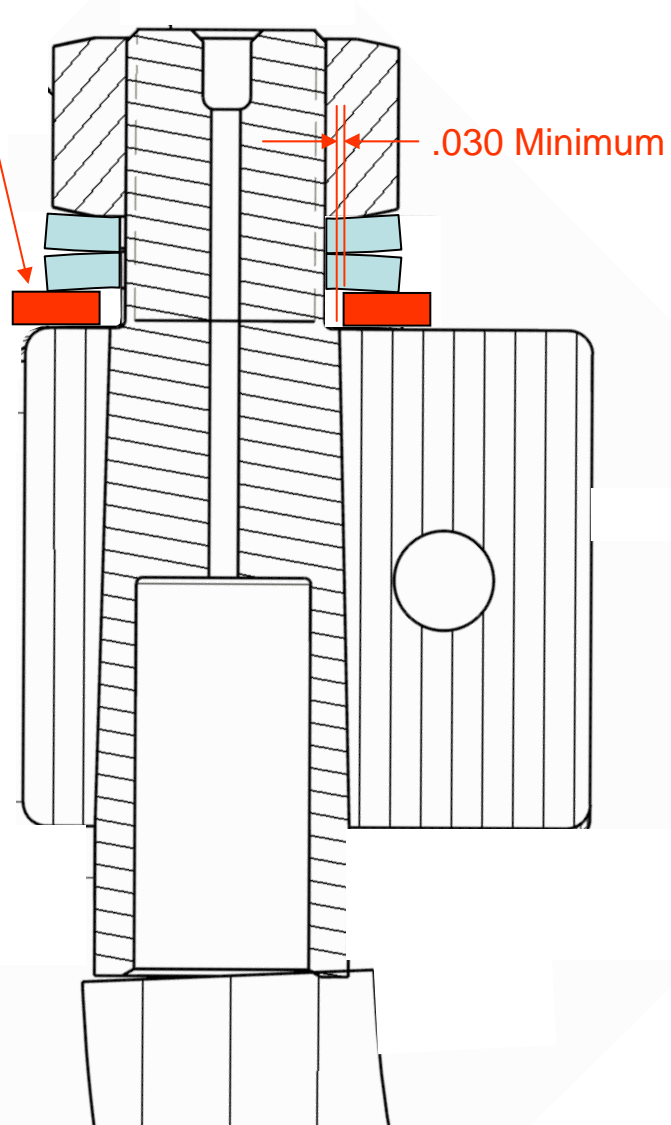

Lug Assembly

Recommended Remedy

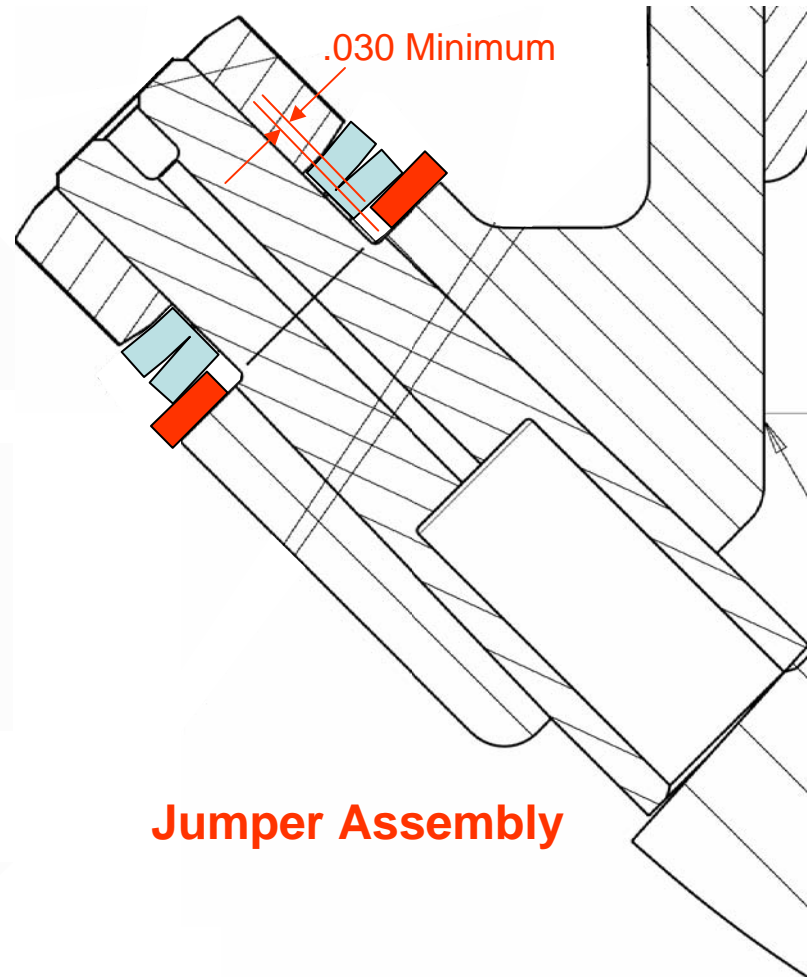

Jumper Assembly