

NO.	REVISION	BY	CH	SUP	APPROVED	DATE

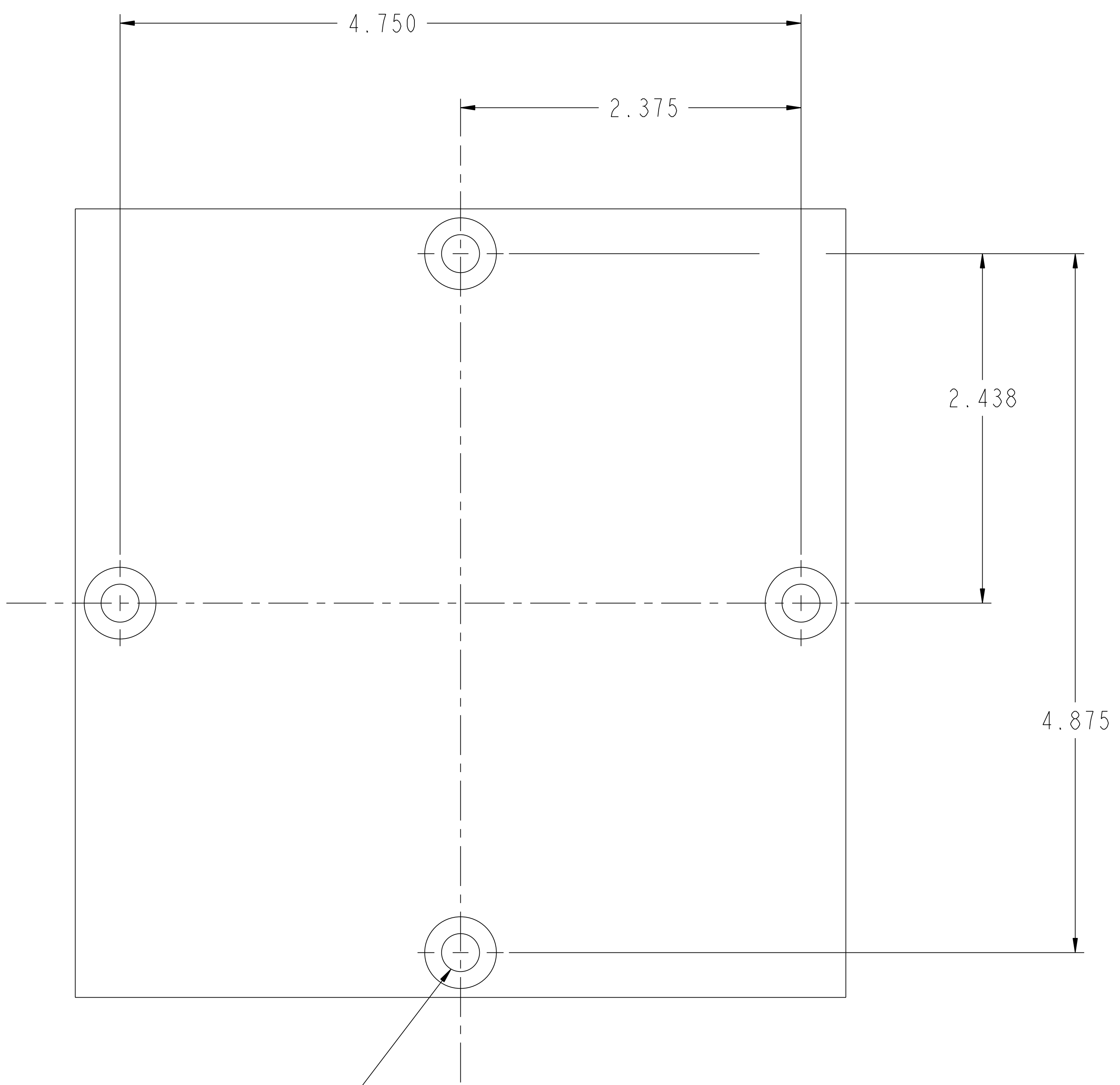

$\varnothing .265$ THRU
 $\varnothing .500$ $\nabla .156$
 TYP 4 HOLES

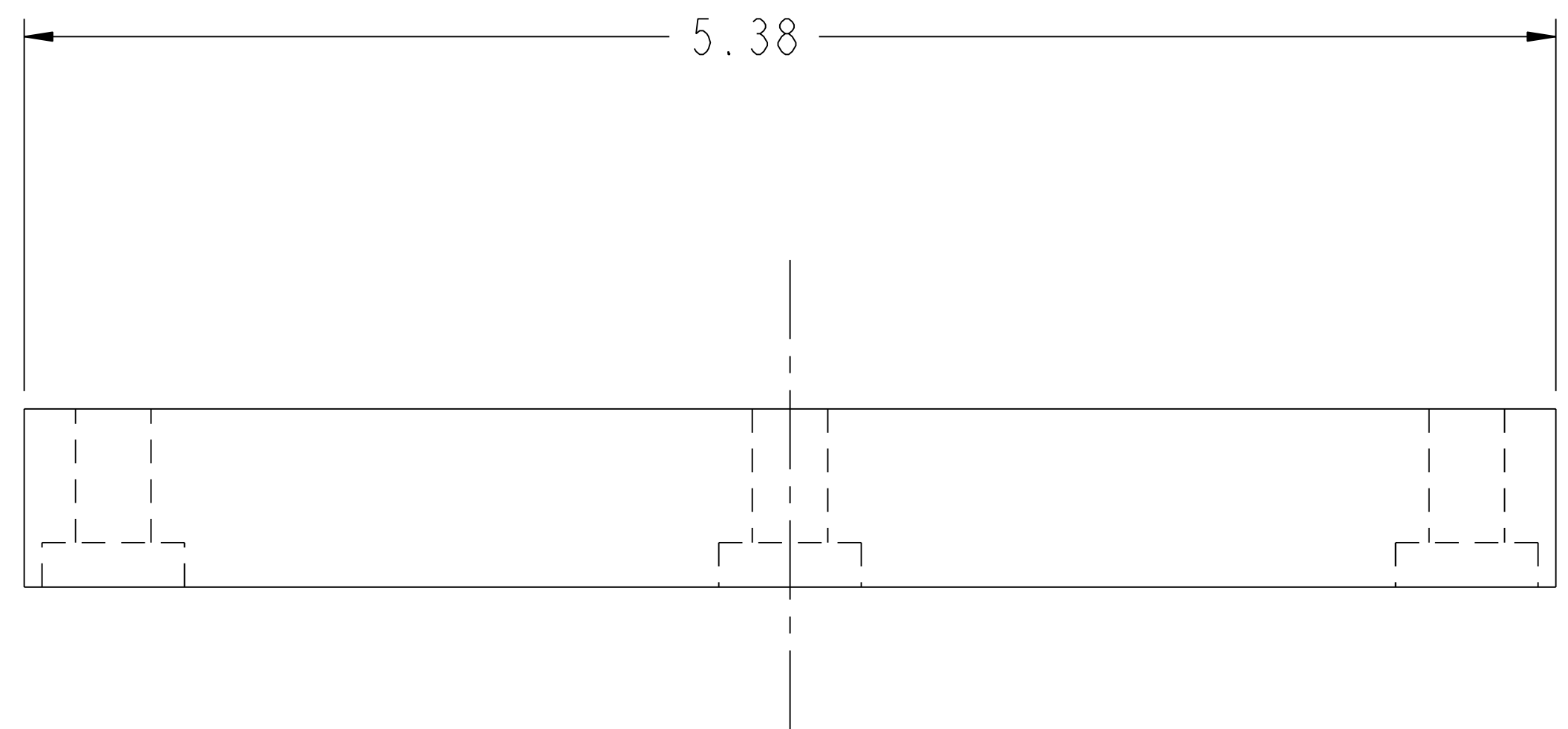
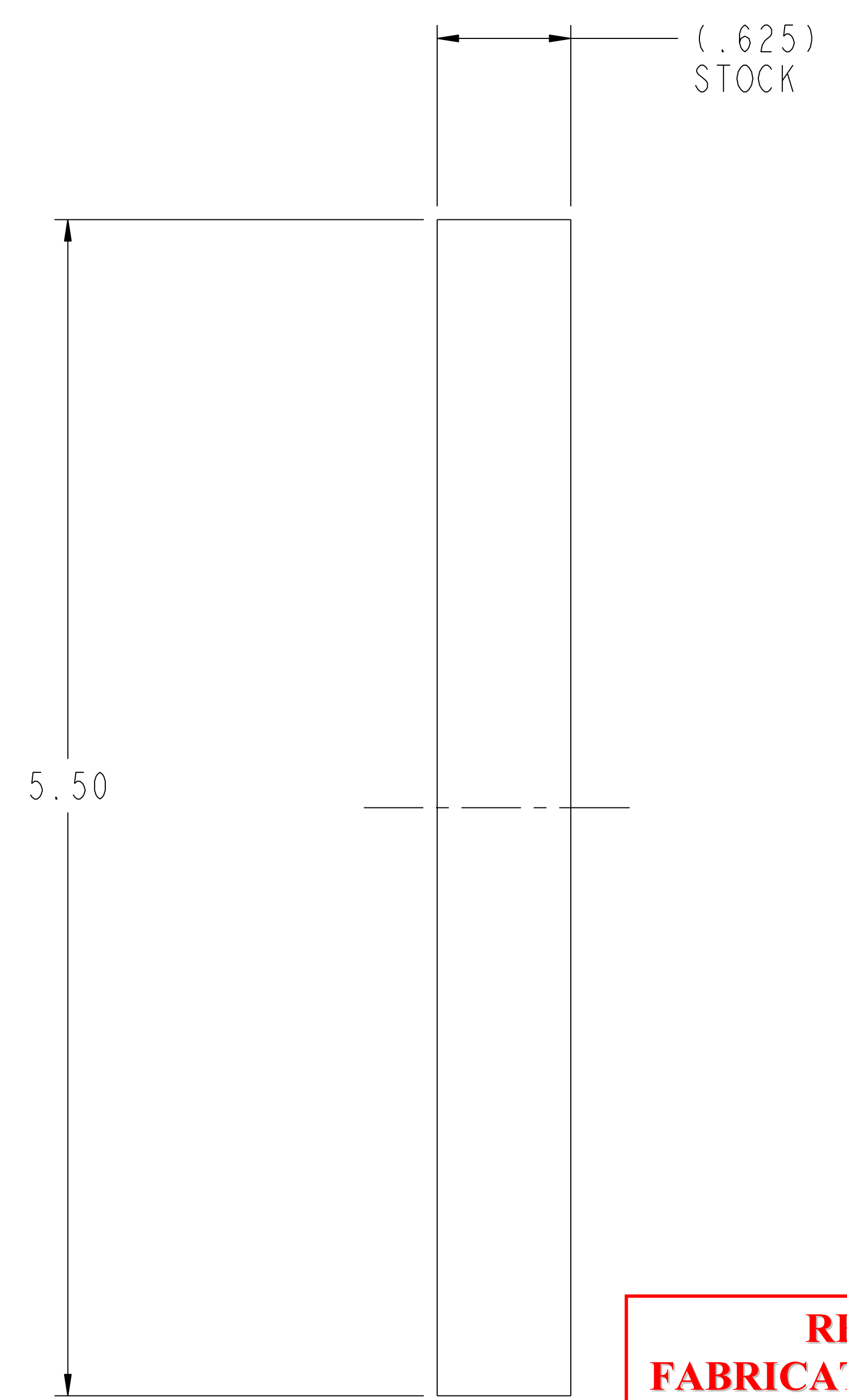

**RELEASED FOR
 FABRICATION / INSTALLATION**
 PPPL Drafting:

RELEASE LEVEL: Fabrication
DWG VERSION NO: 4+

WEIGHT
 5.3 lbs
 MODEL NAME
 SE1311-108
 WELDING
 ENGINEER

PART NO.	SE1311-108	END CAP DETAIL	GRADE A2 TOOL STEEL	2
DRAWING NO.		NOMENCLATURE OR DESCRIPTION	MATERIAL	QTY REOD
PARTS LIST				
COMPUTER GENERATED DRAWING MANUAL CHANGES NOT PERMITTED	CENTRAL FILES: UNLESS OTHERWISE SPECIFIED	PRINCETON PLASMA PHYSICS LABORATORY PRINCETON UNIVERSITY NATIONAL COMPACT STELLARATOR EXPERIMENT		
Pro E	DIMENSIONS ARE IN INCHES MACHINE SURFACES	STELLARATOR CORE CONVENTIONAL COILS IF COIL TEST SAMPLE VPI MOLD ASSEMBLY END CAP DETAIL		
DO NOT VERIFY INFORMATION BY SCALING DRAWING	BREAK SHARP EDGES .005/.020	TOLERANCES NON-CUMULATIVE	DSN: J. RUSHINSKI	01/12/05
SCALE 2.000	DECIMAL-INCH FRACTIONS	CHK: S. RAFTOPOULOS	01/12/05	DRAWING NO: SE1311-108
NEXT ASSEMBLY	.XX +/- .000 .XXX +/- .005 ANGULAR +/- .015	ENGR: M. KALISH	01/12/05	
	OVER 120 +/- .112	SUPV: J. SIEGEL	01/12/05	SHEET 1 OF 1 REV 0

NCSX-SE1311-108