

8

7

6

5

4

3

2

1

NEXT ASS'Y: FINAL ASS'Y:

- NOTES
1. INTERPRET DIMENSIONS AND TOLERANCES PER ANSI Y14.5M.
  2. DIMENSIONS ARE IN INCHES

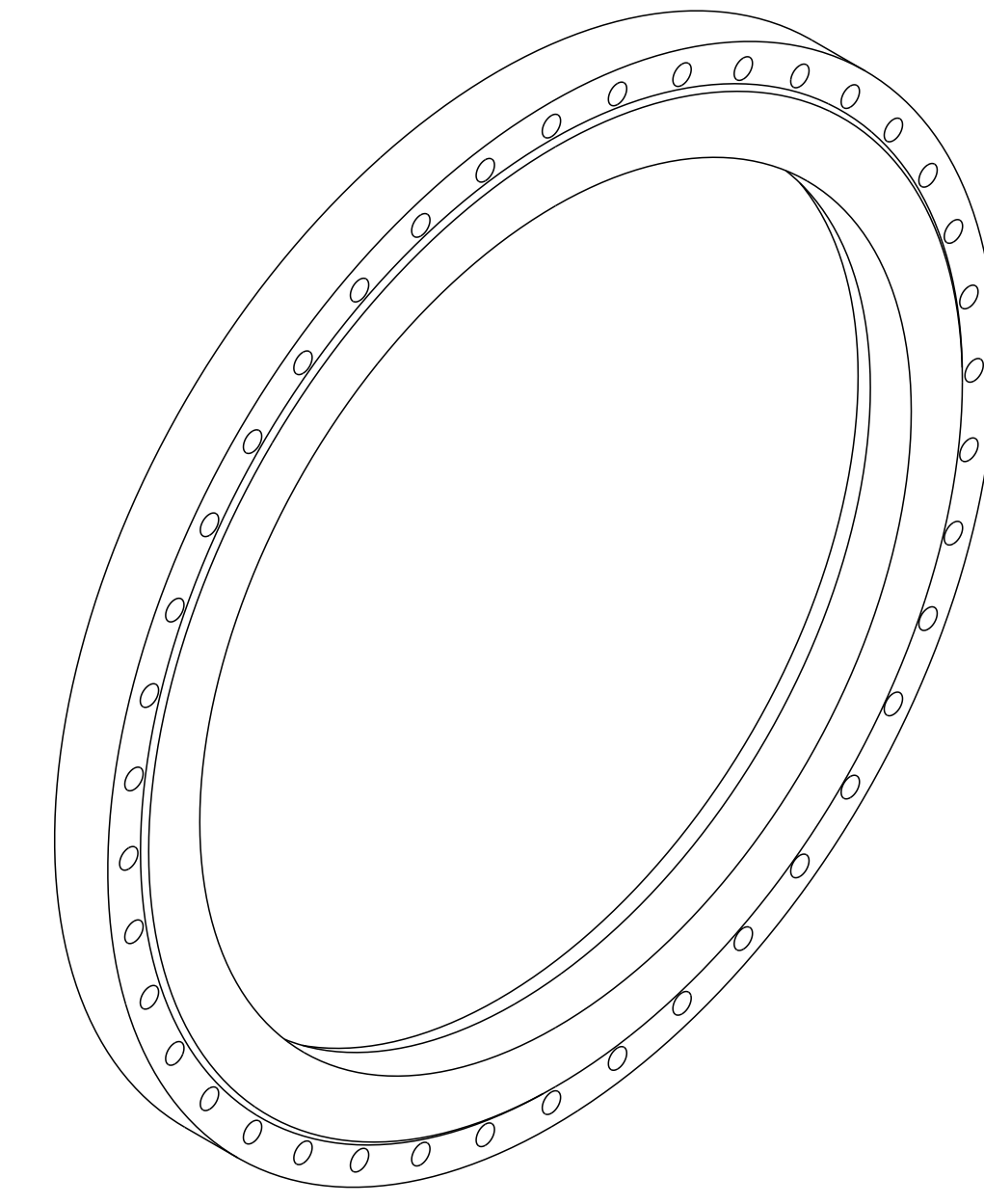

ISOMETRIC VIEW  
SCALE 0.250

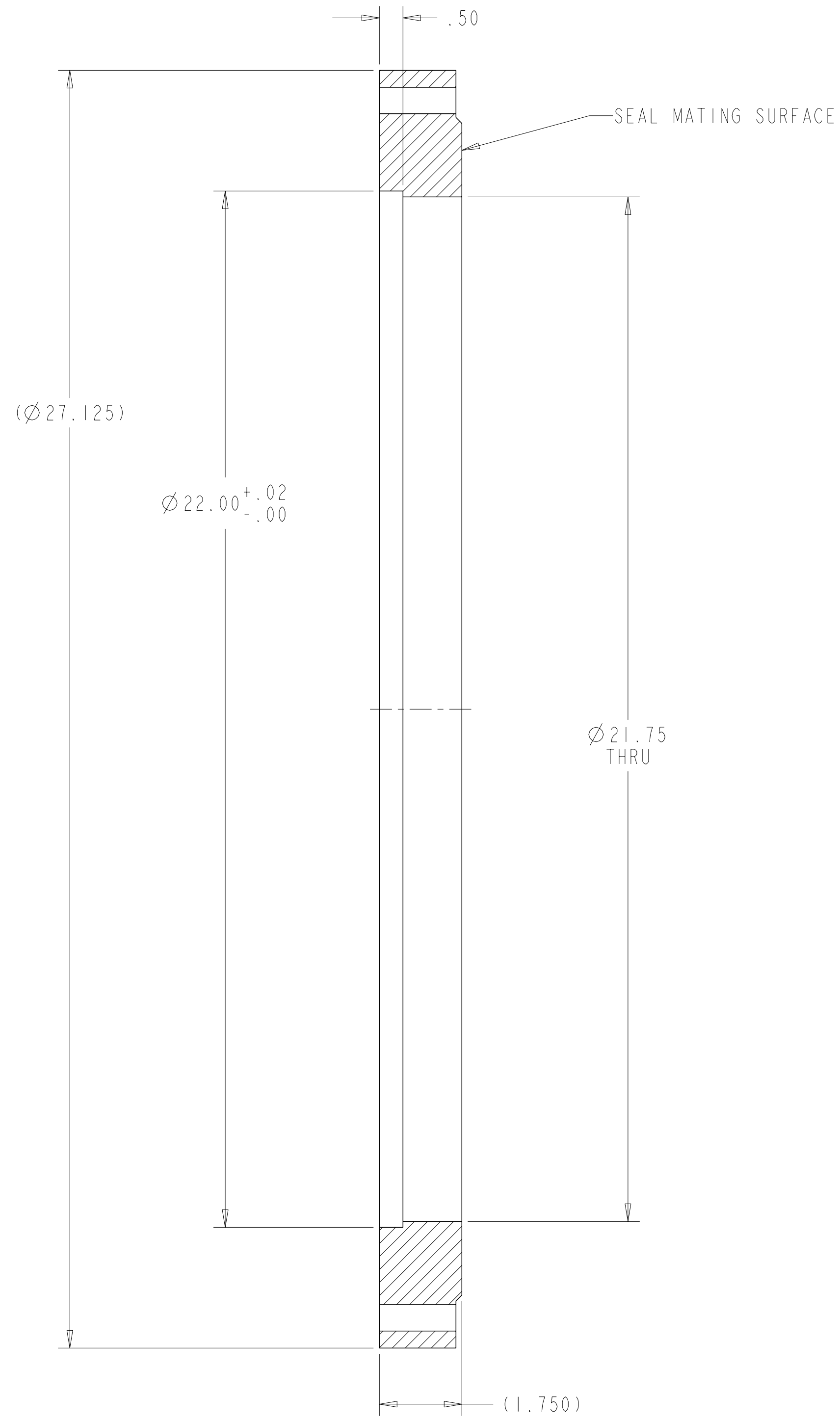

SECTION A-A

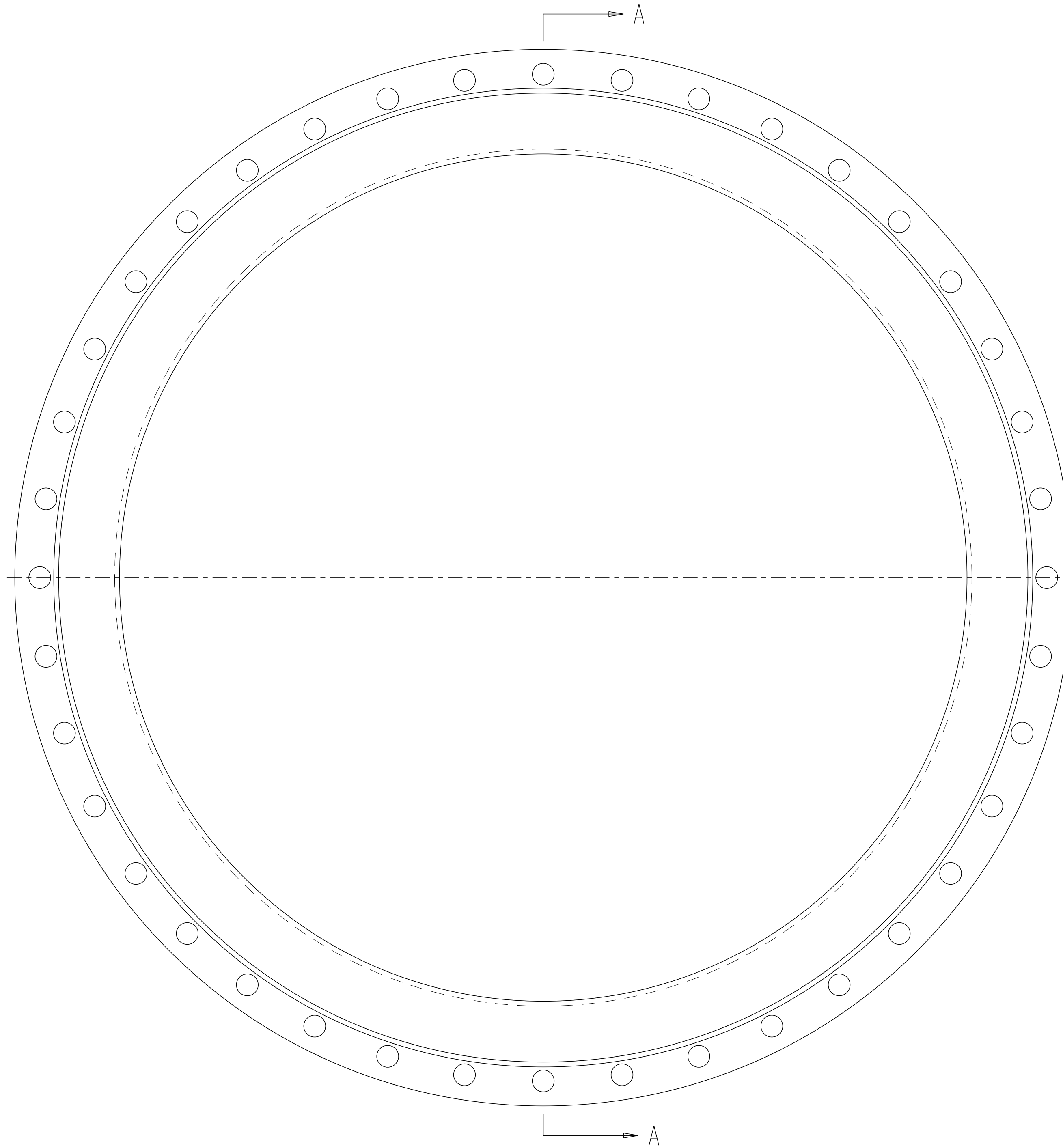

SCALE 0.500

AR	-1	MDC FLANGE MODIFICATION	WIRE SEAL FLANGE 180034 REF# WSF27-00MB	MDC VACUUM PRODUCTS CORP. 23842 CABOT BOULEVARD HAYWARD, CA 94545-1661	I
CAGE CODE	PART OR IDENTIFYING NO	NOMENCLATURE OR DESCRIPTION	MATERIAL	SPECIFICATION	FIND NO
SE121-133	← NEXT ASSEMBLY	PARTS LIST			

SCALE NOTED										DES P GORANSON	06/05	Oak Ridge National Laboratory managed for the DEPARTMENT OF ENERGY under U.S. GOVERNMENT CONTRACT DE-AC05-00OR22725 UT-BATTELLE, LLC, Oak Ridge, Tennessee									
TOLERANCES UNLESS OTHERWISE SPECIFIED										DRW MT BROWN	06/05	UT-BATTELLE									
FRACTIONS										CHK D.B. RAINEY	08/05	NATIONAL COMPACT STELLARATOR EXPERIMENT									
XX DECIMALS ±.03										SECT :		MCD FLANGE MODIFICATION									
XXX DECIMALS ±.005										DEPT :		VERSION NO. PLANT BLDG FL SHT OF TYPE CLASS									
ANGLES ±0°15'										PE :		pro1. version ORNL 5700 3 1 1 S U									
BREAK SHARP EDGES .06 MAX										CR :		RELEASE LEVEL SE121-133									
FINISH .125 UNLESS OTHERWISE SPECIFIED										PJ :		REV 0									
										PPPL DRFT :		DRAWING APPROVALS DATE									
										REV :											
										DESCRIPTION	BY	DATE	CHK	DEPT	DATE	PE	REQ	DATE	ORNL	DOE	DATE
										ORIGINAL ISSUE											
										REVISION OR ISSUE PURPOSE											

NO REPRESENTATION OR WARRANTY, EXPRESSED OR IMPLIED, IS MADE AS TO THE ACCURACY, COMPLETENESS OR USEFULNESS OF THE INFORMATION OR STATEMENTS CONTAINED IN THESE DRAWINGS, OR THAT THE USE OR DISCLOSURE OF ANY INFORMATION, APPARATUS, METHOD OR PROCESS DISCLOSED IN THESE DRAWINGS MAY NOT INFRINGE PRIVATE RIGHTS OF OTHERS. NO LIABILITY IS ASSUMED WITH RESPECT TO THE USE OF, OR FOR DAMAGES RESULTING FROM THE USE OF, ANY INFORMATION, APPARATUS, METHOD OR PROCESS DISCLOSED IN THESE DRAWINGS. DRAWINGS MADE AVAILABLE FOR INFORMATION TO BIDDERS ARE NOT TO BE USED FOR OTHER PURPOSES, AND ARE TO BE RETURNED UPON REQUEST OF THE FORWARDING CONTRACTOR.

**P** THIS DRAWING PRODUCED ON PRO-ENGINEER

8

7

6

5

4

3

2

1