

NO.	REVISION	BY	CH	SUP	APPROVED	DATE

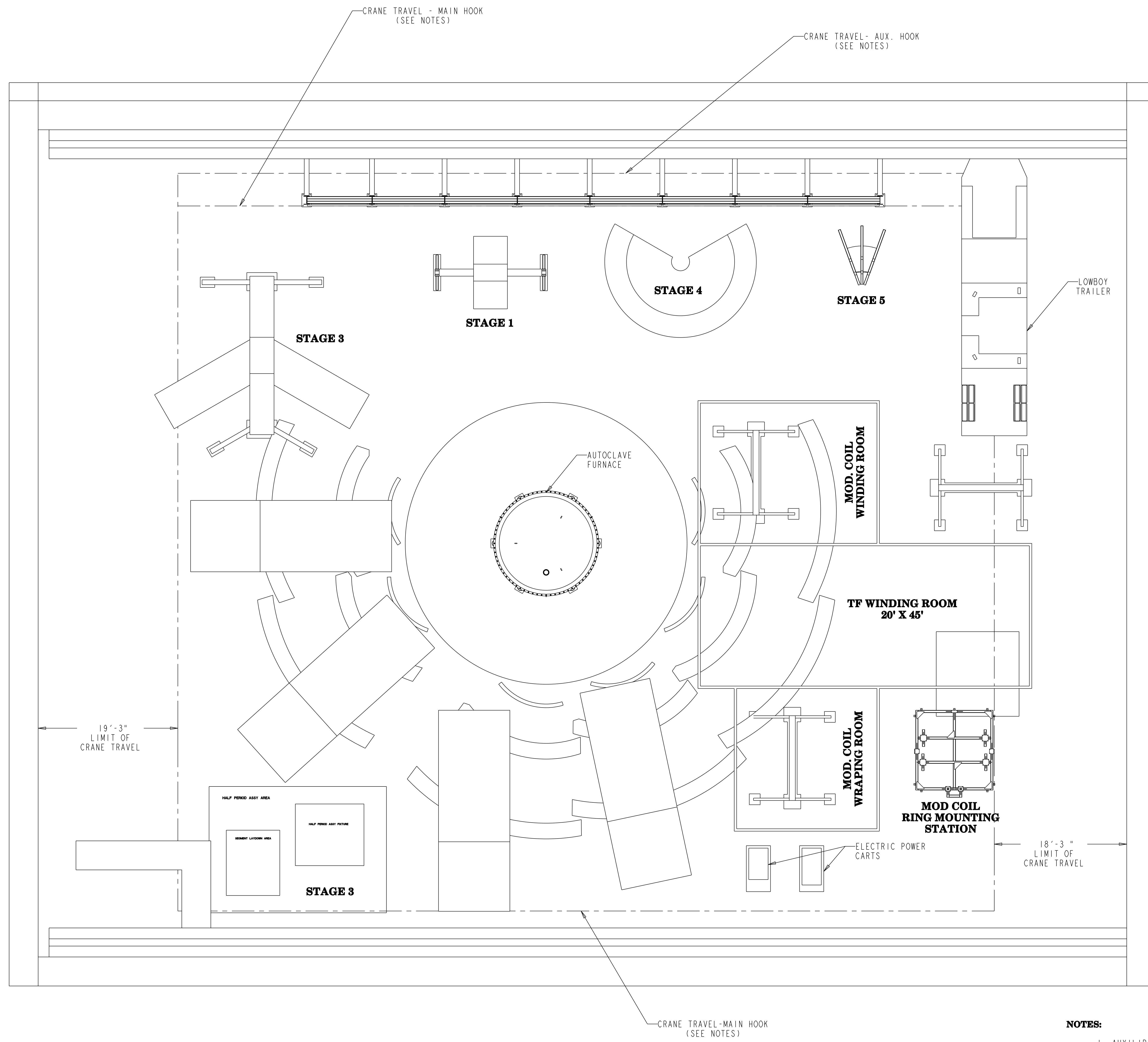

**PLAN VIEW - MODULAR COIL WINDING FACILITY
AND FIELD PERIOD ASSEMBLY STAGES**

- NOTES:**
- AUXILIARY HOOK CAPACITY IS RATED AT 25 TONS. MAX. HOOK ELEV. ABOVE FLOOR (EL. 100'-0") IS EL. 146'-9".
 - MAIN HOOK CAPACITY IS RATED AT 110 TONS. MAX. HOOK ELEV. ABOVE FLOOR (EL. 100'-0") IS EL. 143'-0".

RELEASE LEVEL: WIP
DWG VERSION NO: 0

WELDING
ENGINEER

COMPUTER GENERATED DRAWING MANUAL CHANGES NOT PERMITTED Pro E	CENTRAL FILES: UNLESS OTHERWISE SPECIFIED DIMENSIONS ARE IN INCHES MACHINE SURFACES BREAK SHARP EDGES .005/.020	PRINCETON PLASMA PHYSICS LABORATORY NATIONAL COMPACT STELLARATOR EXPERIMENT MODULAR COIL /TF COIL WINDING ROOMS AND FIELD PERIOD ASSEMBLY STAGES PREVIOUS TFTR TEST CELL	
DO NOT VERIFY INFORMATION BY SCALING DRAWING	TOLERANCES NON-CUMULATIVE DECIMAL-INCH FRACTIONS .X +/- .100 0'-12" +/- .125 .XX +/- .030 12'-12" +/- .178 .XXX +/- .005 12'-120" +/- .178 ANGULAR +/- .0'-15' OVER 120' +/- .172	DSN: B. PAUL CHK: ENGR: M. VIOLA SUPV:	DRAWING NO: SE144-150 SHEET 1 OF 1 REV 0

NCSX-SE144-150