

Date: 11-17-04
The C.A. Lawton Co.
Pattern Division
Weekly Report – Coil C1
Contract Number: SUB# S-04341-F REV 5

Administration:

Laser Scanning – Reviewing the schedule so scanning services can be arranged.

Open Item: Finalize action plan to accomplish scanning task; November 23, 2005.

Open Item: Finalize Logistics – Due week 1 December

Technical:

Polodial Break Shim Pattern – Technical data regarding finish stock requirements has been received from Metaltec and from Major Tool. Joe Edwards suggests that we build the shim with 5/8” finish stock because we can trim the thickness later rather than being short. Tim is reviewing the drawings and stock requirements provided by Kevin Bowling.

Chill Pattern - The chill pattern is complete. The pattern was shipped to Metaltec on Tuesday, November 16, 2004.

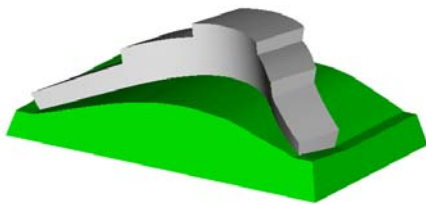

**Chill Pattern Model with
Follow Board**



Chill Pattern

Flask Size – We need the flask size from Metaltec.

Modeling - Don reports that he sees light at the end of the tunnel with modeling tasks. Don anticipates that most models will be completed prior to Thanksgiving holiday.

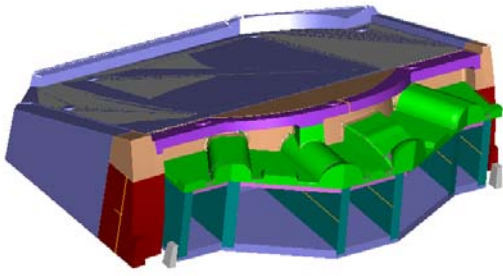

Drag Pattern Assembly – Back view



Side Core Box

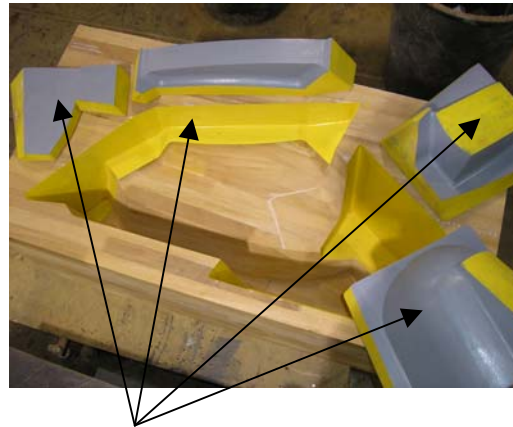

Loose Pieces



Cope Core Box



Cope Pattern



The Cope Core Box loose top is flipped over and mounted on to the cope core box

Cope Core Box Loose Top

Quality Assurance: The revision to the MIT plan was sent to Peter at EIO for further review.