

- NOTES:
1. INTERPRET DIMENSIONS AND TOLERANCES PER ANSI Y14.5M.
 2. DIMENSION ARE IN INCHES.
 3. FABRICATION, INSPECTION, AND TESTING SHALL BE PERFORMED IN ACCORDANCE WITH SPECIFICATION NCSX-CSPEC-121-02 AND STATEMENT OF WORK NCSX-SOW-121-03.
 4. LEAK CHECK ITEM -2 (HALF NIPPLE) OPTIONAL.

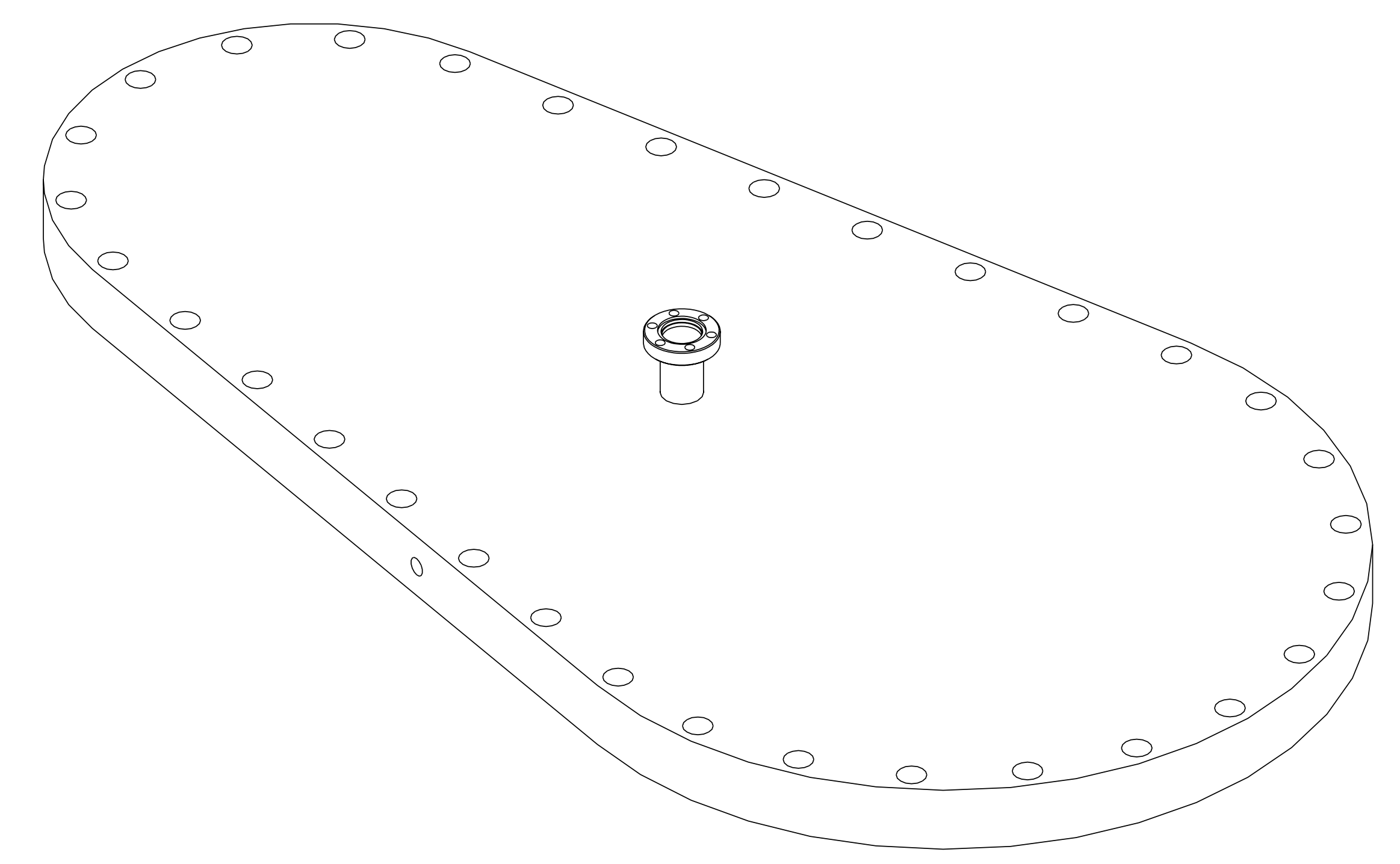

ISOMETRIC VIEW

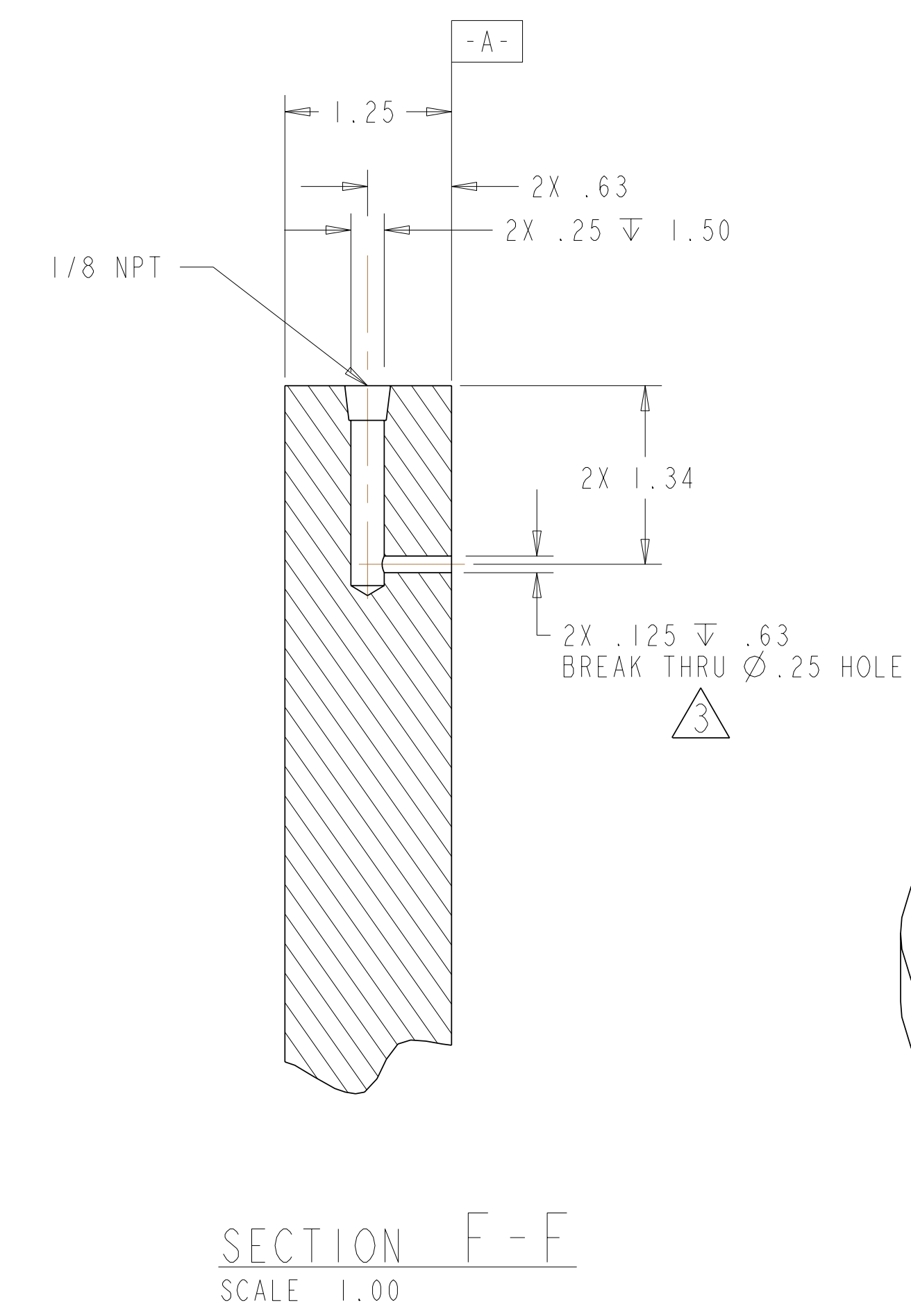
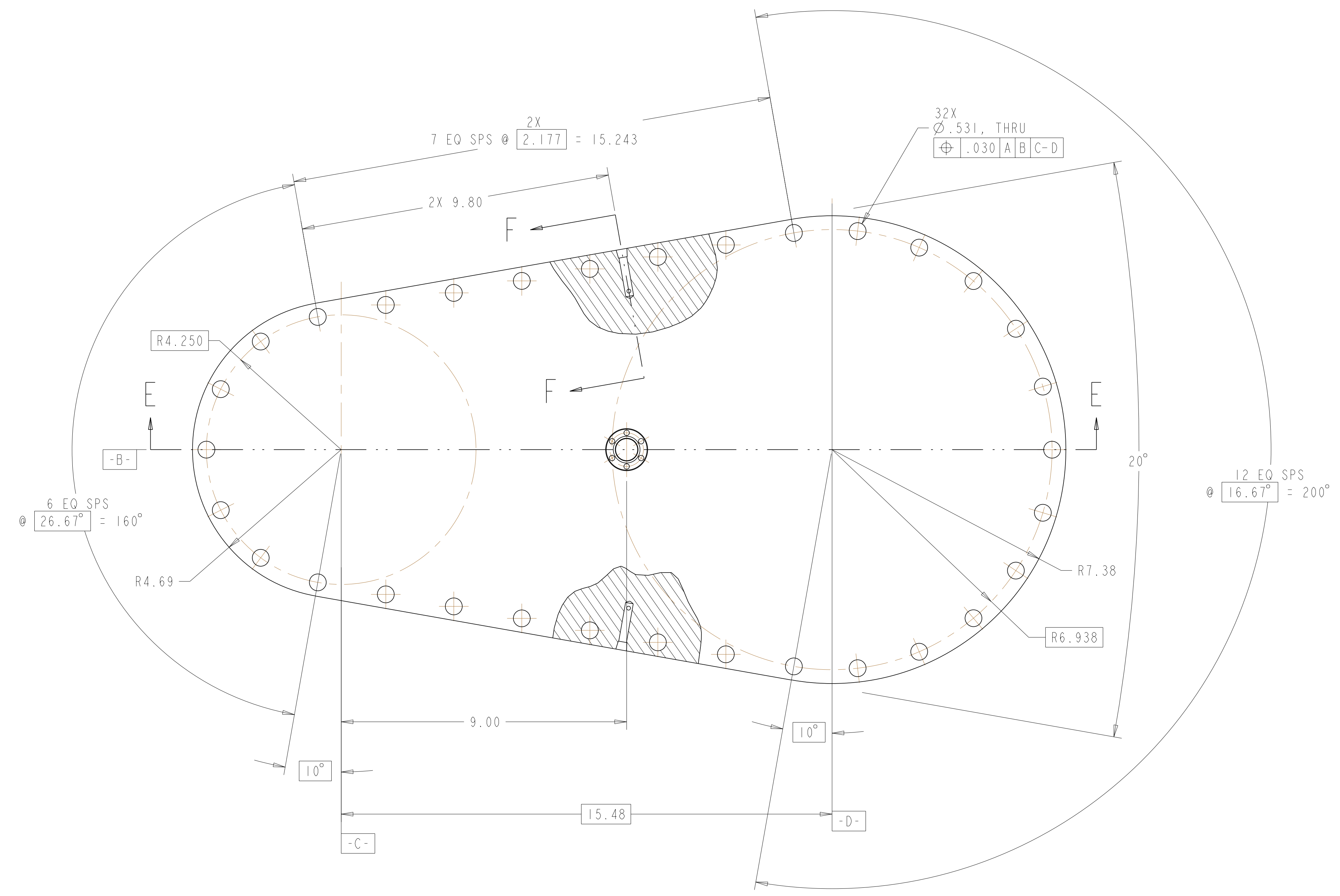
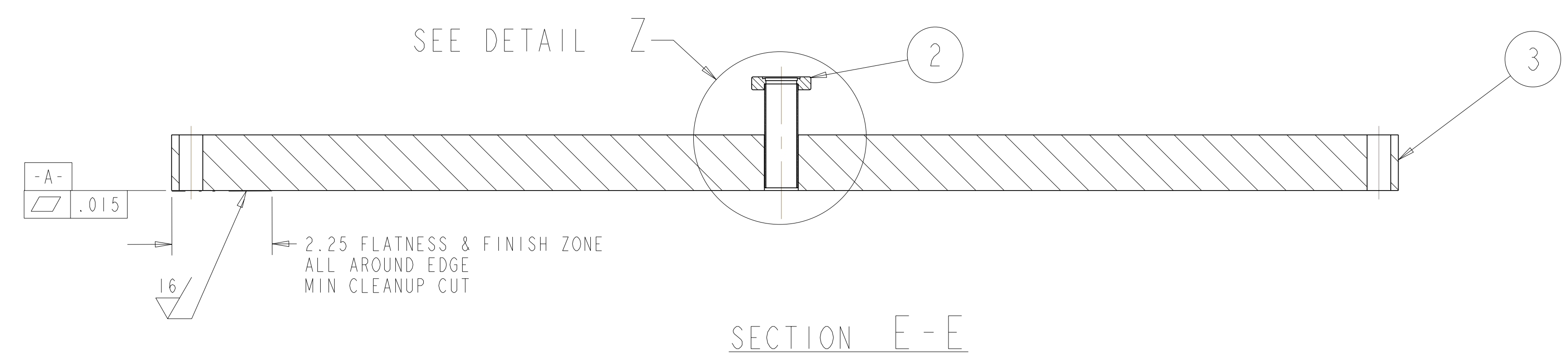

SECTION E-E

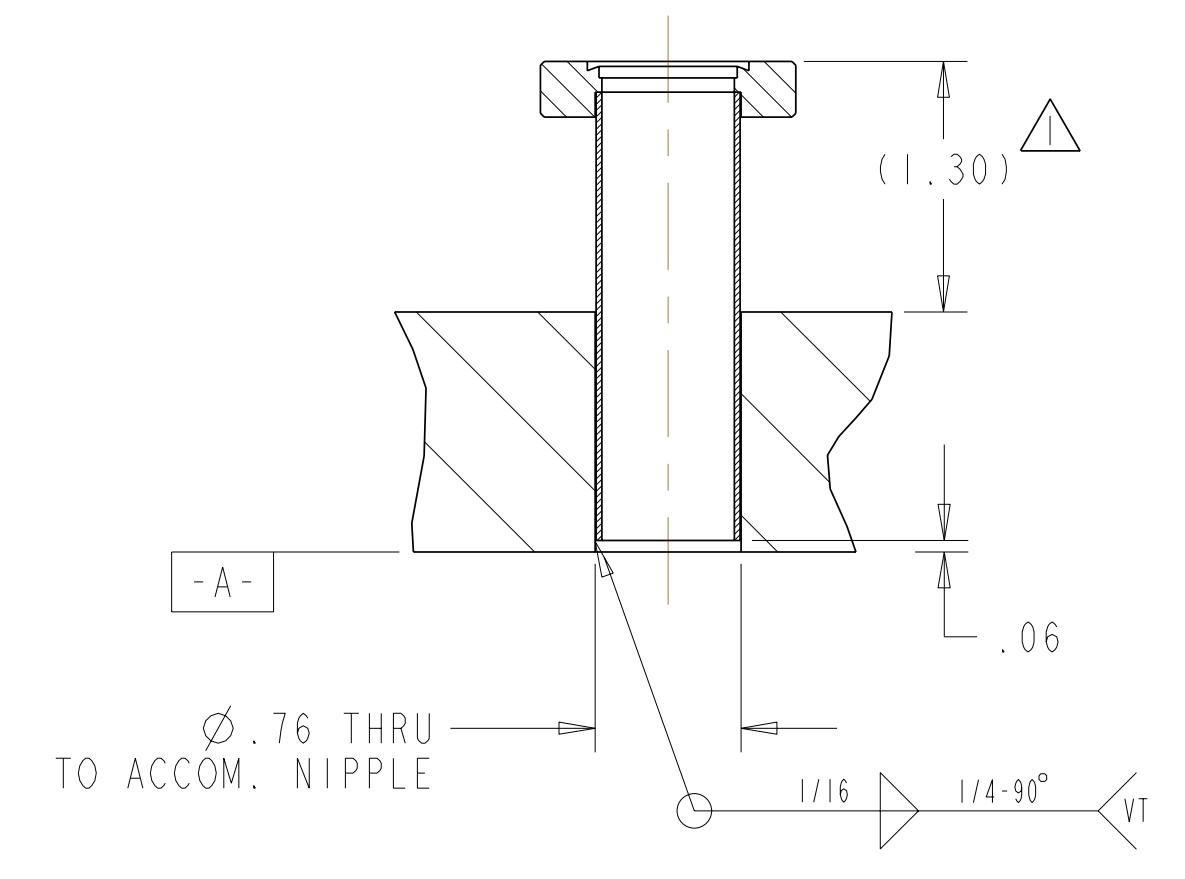

DETAIL Z
 SCALE 1.00

SCALE: .50

AR	CAGE CODE	PART OR IDENTIFYING NO	NOMENCLATURE OR DESCRIPTION	MATERIAL	SPECIFICATION	FIND NO
AR	-4	-	WELD, FILLER METAL			4
I	-3	-	PORT 12 FLANGE	316L SST		3
I	-2	-	HALF NIPPLE 1 1/3 DEL-SEAL CF CUSTOM LENGTH 2.50"	MDC VACUUM PRODUCTS CORP. 23842 CABBOT BOULEVARD HAYWARD, CA. 94545-1651		2
AR	-1	-	PORT 12 COVER TEST FLANGE WELDMENT			1
SE120-004	-1					

← NEXT ASSEMBLY

PARTS LIST

WELDING ENGINEER
 APPROVED R. PARSELLS DATE: 6/04

RELEASED FOR FABRICATION / INSTALLATION
 PPL Drafting:

NO REPRESENTATION OR WARRANTY, EXPRESSED OR IMPLIED, IS MADE AS TO THE ACCURACY, COMPLETENESS OR USEFULNESS OF THE INFORMATION OR STATEMENTS CONTAINED IN THESE DRAWINGS, OR THAT THE USE OR DISCLOSURE OF ANY INFORMATION, APPARATUS, METHOD OR PROCESS DISCLOSED IN THESE DRAWINGS MAY NOT INFRINGE PRIVATE RIGHTS OF OTHERS. NO LIABILITY IS ASSUMED WITH RESPECT TO THE USE OF, OR FOR DAMAGES RESULTING FROM THE USE OF, ANY INFORMATION, APPARATUS, METHOD OR PROCESS DISCLOSED IN THESE DRAWINGS. DRAWINGS MADE AVAILABLE FOR INFORMATION TO BIDDER ARE NOT TO BE USED FOR OTHER PURPOSES, AND ARE TO BE RETURNED UPON REQUEST OF THE FORWARDING CONTRACTOR.

P THIS DRAWING PRODUCED ON PRO-ENGINEER

REV	DESCRIPTION	BY	DATE	CHK	DEPT	DATE	PE	REQ	DATE	ORNL	DOE	DATE
2	REVISD PER ECN-4945	GHJ	2/28/05	MJC								
2	ADDED NOTE 4 MODIFIED DEPTH											
1	REVISD PER ECN-4933	MJC	11/02/04	PLG								
1	ADDED REF DIMENSION											

SCALE	NOTED	DES	DATE
	TOLERANCES UNLESS OTHERWISE SPECIFIED	P. L. GORANSON	8/03
	FRACTIONS	DRW G. H. JONES	8/03
	XX DECIMALS ±.01	CHK M. J. COLE	6/04
	XXX DECIMALS ±.005	SECT :	
	ANGLES ±0°15'	DEPT :	
	BREAK SHARP EDGES .06 MAX	PE :	
	FINISH .125 UNLESS OTHERWISE SPECIFIED	PJ :	
		RED :	
		PPPL DRFT J. SIEGEL	6/04

VERSION NO.	PLANT	BLDG	FL	SHT OF	TYPE	CLASS
1	X-10	5700	03	1	I	S U
						REV 2

UT-BATTELLE
 NATIONAL COMPACT STELLARATOR EXPERIMENT
 VACUUM VESSEL
 PORT 12 COVER TEST FLANGES
 WELDMENT

SE122-104

H
G
F
E
D
C
B
A

SE122-104