

| | | | | | | |
|-----|----------|----|----|-----|----------|------|
| NO. | REVISION | BY | CH | SUP | APPROVED | DATE |
| | | | | | | |

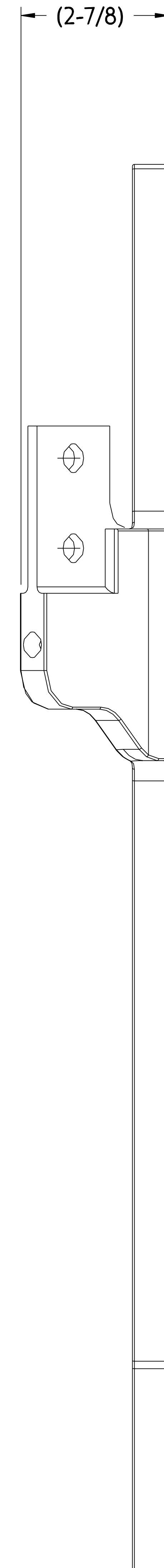
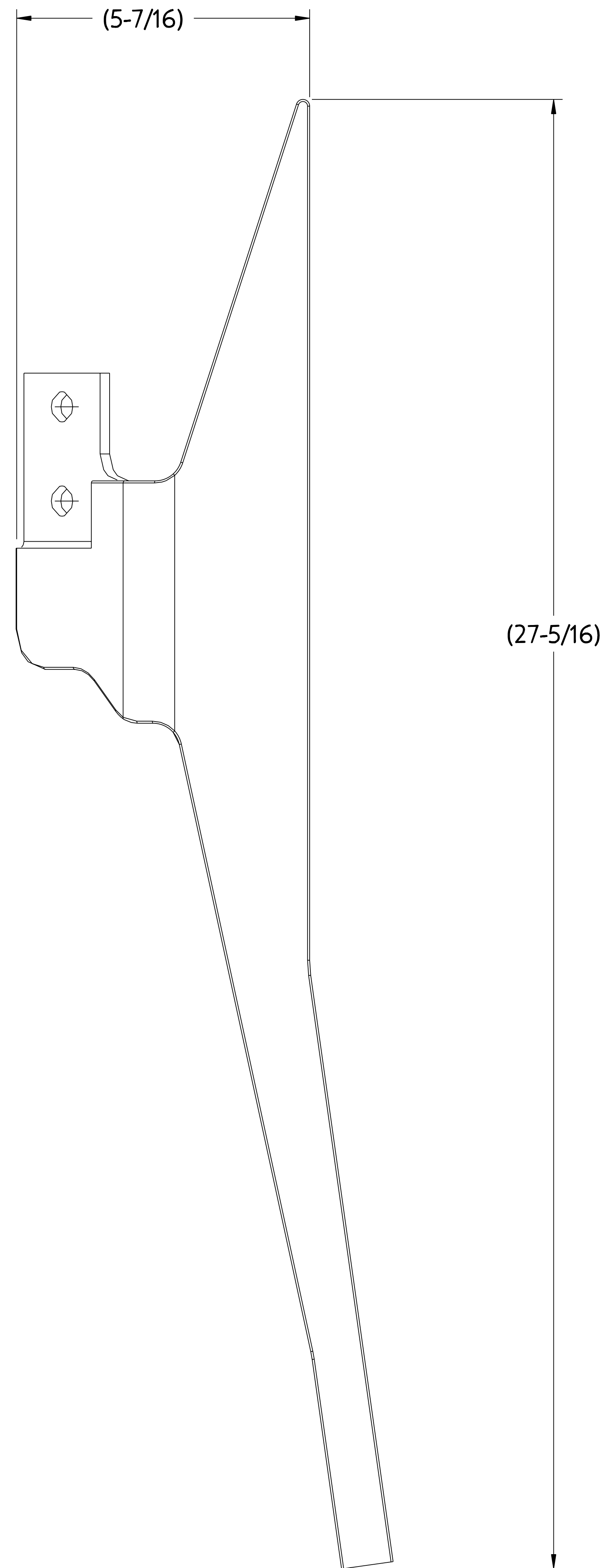
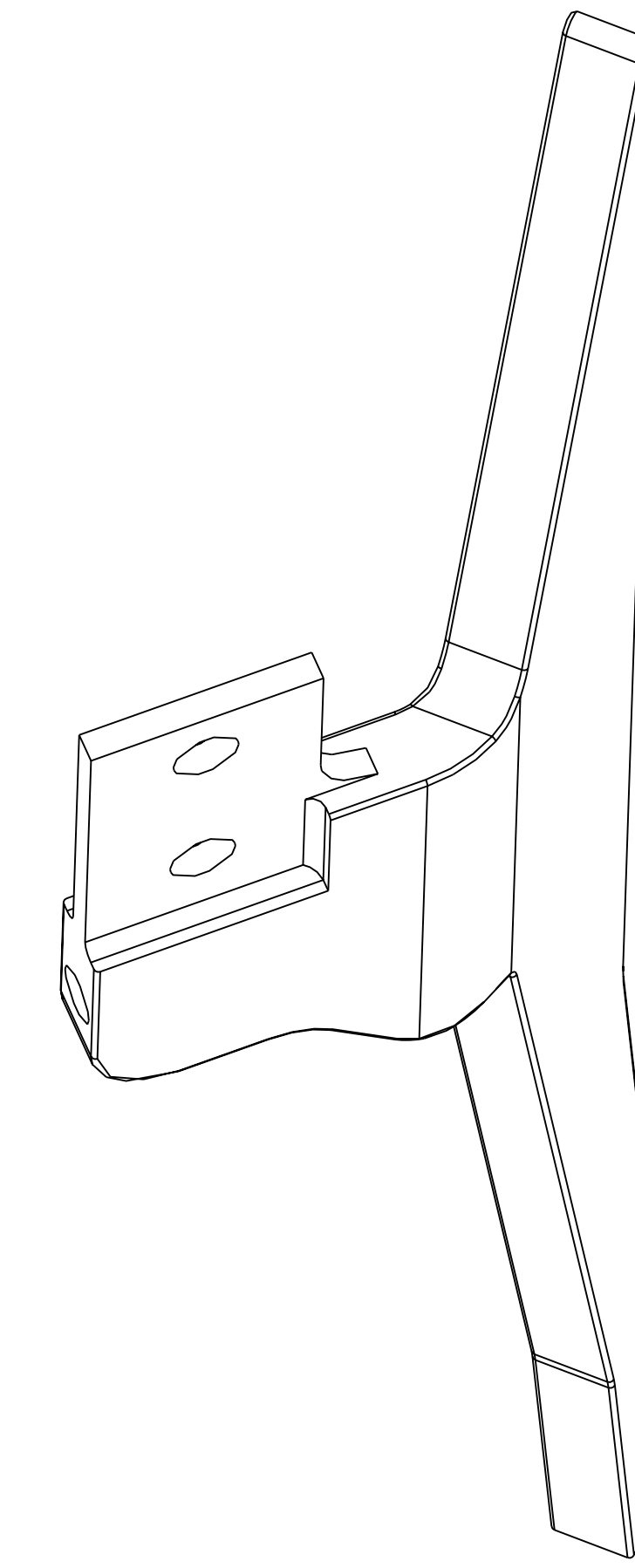
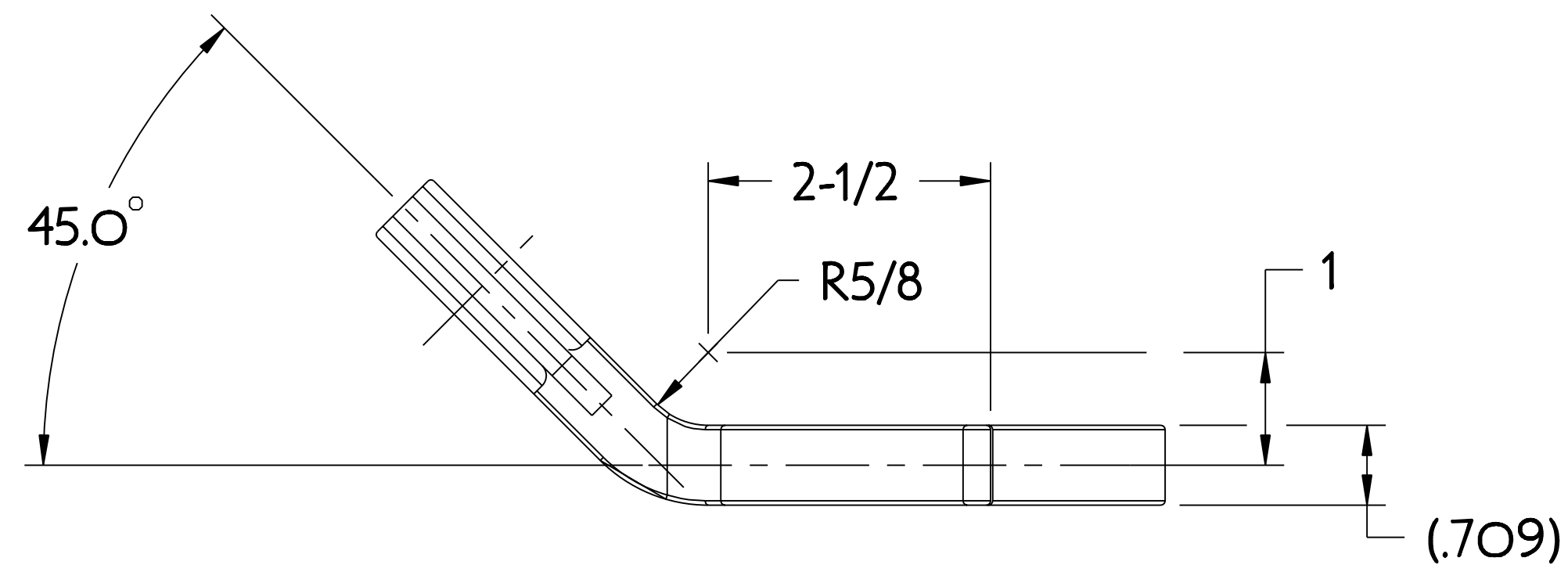

**RELEASED FOR
FABRICATION / INSTALLATION**
PPPL Drafting:

NOTE

BEND PART #SE131-082 AS SHOWN

RELEASE LEVEL: Fabrication
DWG VERSION NO:

WEIGHT
12.2 lbs
MODEL NAME
SE131-054
WELDING
ENGINEER

| | | | | |
|---|--|--|-------------------|--------------------|
| I | SE131-054 | TF COIL LEAD SHORT BENT RIGHT | SEE SPECIFICATION | 9 |
| PART NO. | DRAWING NO | NOMENCLATURE OR DESCRIPTION | MATERIAL | QTY REOD |
| PARTS LIST | | | | |
| COMPUTER GENERATED DRAWING MANUAL CHANGES NOT PERMITTED Pro E | CENTRAL FILES: UNLESS OTHERWISE SPECIFIED | PRINCETON PLASMA PHYSICS LABORATORY PRINCETON UNIVERSITY NATIONAL COMPACT STELLARATOR EXPERIMENT | | |
| DO NOT VERIFY INFORMATION BY SCALING DRAWING | DIMENSIONS ARE IN INCHES MACHINE SURFACES BREAK SHARP EDGES .005/.020 | STELLARATOR CORE CONVENTIONAL COILS TF COIL LEAD SHORT BENT - RIGHT | | |
| SCALE 0.750 | TOLERANCES NON-CUMULATIVE | DSN: J. RUSHINSKI | 2/01/06 | DRAWING NO: |
| NEXT ASSEMBLY | DECIMAL-INCH FRACTIONS | CHK: M. KALISH | 2/01/06 | SE131-054 |
| | .X +/- .000 0°-120° +/- .004 .XX +/- .000 12°-12° +/- .004 .XXX +/- .005 72°-120° +/- .004 ANGULAR +/- .0°-15° OVER 120° +/- .122 | ENGR: M. KALISH | 2/01/06 | |
| | | SUPV: J. SIEGEL | 2/01/06 | SHEET 1 OF 1 REV 0 |

NCSX-SE131-054