

NO.	REVISION	BY	CH	SUP	APPROVED	DATE

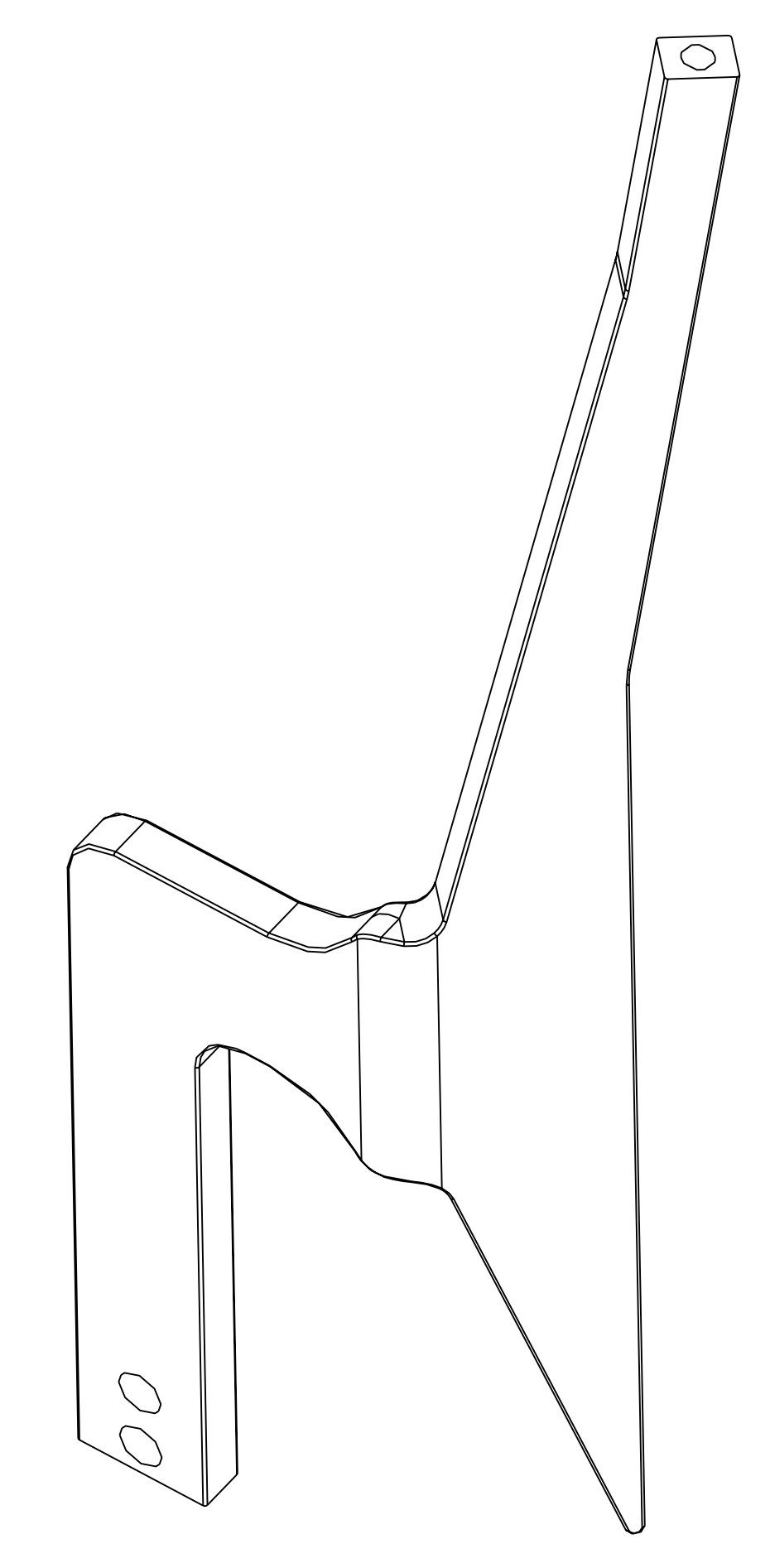
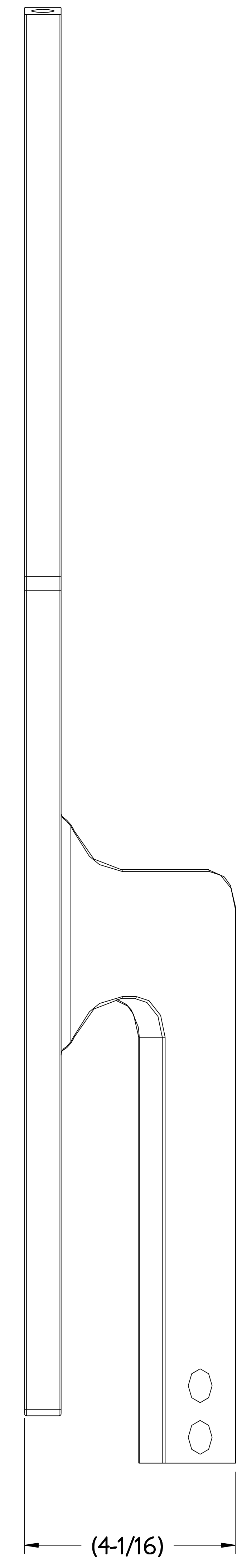
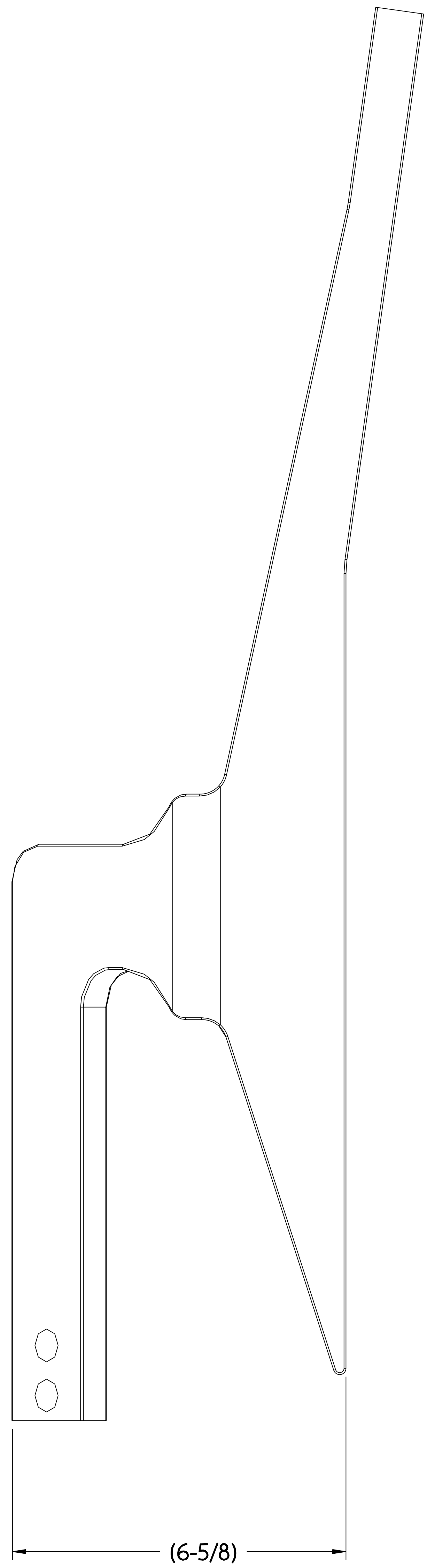
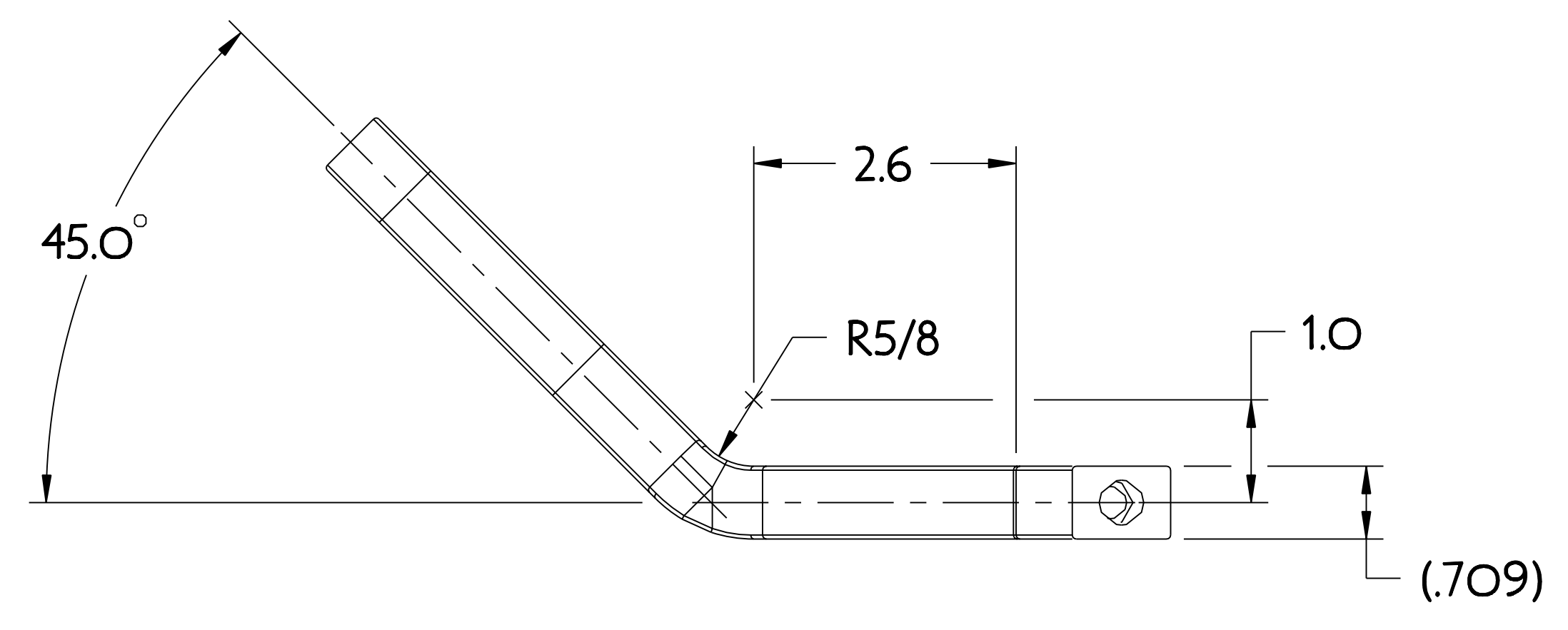

NOTE

1. BEND PART #SE131-088 AS SHOWN.

**RELEASED FOR
FABRICATION / INSTALLATION**
PPPL Drafting:

RELEASE LEVEL: Fabrication
DWG VERSION NO: proj_version

WEIGHT	16.6 lbs
MODEL NAME	SE131-057
WELDING ENGINEER	

PART NO.	SE131-057	TF COIL LEAD LONG BENT LEFT	COPPER C-107	9
DRAWING NO.		NOMENCLATURE OR DESCRIPTION	MATERIAL	QTY REOD
PARTS LIST				
COMPUTER GENERATED DRAWING MANUAL CHANGES NOT PERMITTED Pro E	CENTRAL FILES: UNLESS OTHERWISE SPECIFIED	PRINCETON PLASMA PHYSICS LABORATORY PRINCETON UNIVERSITY		
DO NOT VERIFY INFORMATION BY SCALING DRAWING	DIMENSIONS ARE IN INCHES MACHINE SURFACES BREAK SHARP EDGES .005/.020	NATIONAL COMPACT STELLARATOR EXPERIMENT		
SCALE 0.750	TOLERANCES NON-CUMULATIVE	DSN: J. RUSHINSKI	2/01/06	DRAWING NO:
NEXT ASSEMBLY	DECIMAL-INCH FRACTIONS	CHK: M. KALISH	2/01/06	SE131-057
	.XX +/- .030 12°-12° +/- 1/8°	ENGR: M. KALISH	2/01/06	
	.XXX +/- .005 72°-120° +/- 1/4°	SUPV: J. SIEGEL	2/01/06	SHEET 1 OF 1 REV 0
	ANGULAR +/- 0°-15° OVER 120° +/- 1/2°			

NCSX-SE131-057