

1 TYPE-A SIDE-A ASM  
 SCALE 0.25

- NOTES:
1. DRAWING PREPARED IN ACCORDANCE WITH ASME Y14.100-2000.
  2. INTERPRET DIMENSIONS AND TOLERANCES PER ASME Y14.5M-1994.
  3. DIMENSIONS ARE IN INCHES.
  4. DRAWING DEPICTS FLAT PATTERN OF FORMED PARTS DEFINED BY PRO/E MODELS SE142A-255.PRT AND SE142A-257.PRT.
  5. PROFILE TOLERANCE OF FLAT PATTERN IS +/- .010 IN.
  6. THICKNESS IS 0.040 +/- .006 IN. PER ASTM B248.
  7. REMOVE ALL BURRS AND SHARP EDGES.
  8. IDENTIFY PARTS WITH LABEL SHOWN BY ETCHING OR PERMANENT MARKER.

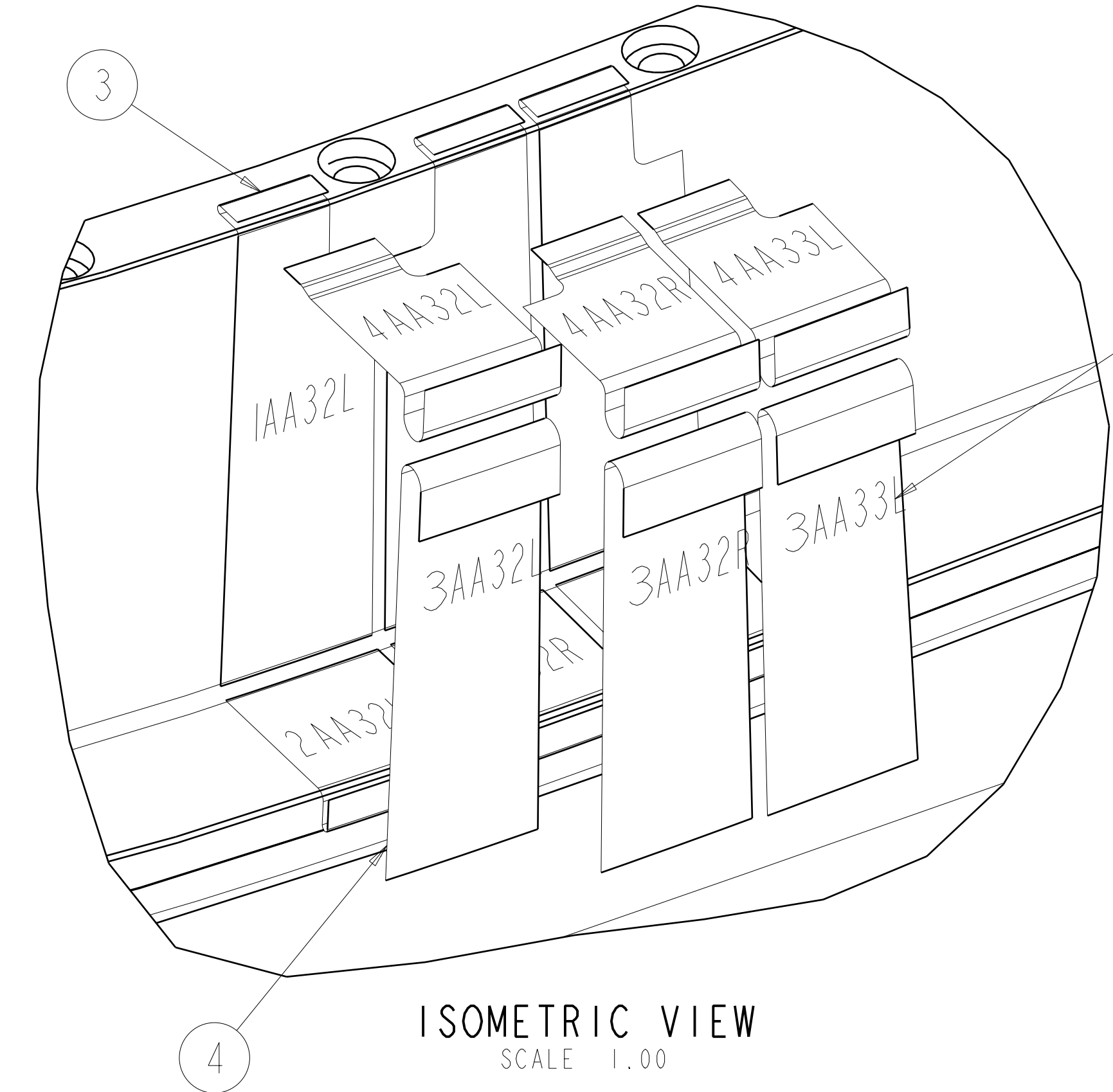

ISOMETRIC VIEW  
 SCALE 1.00

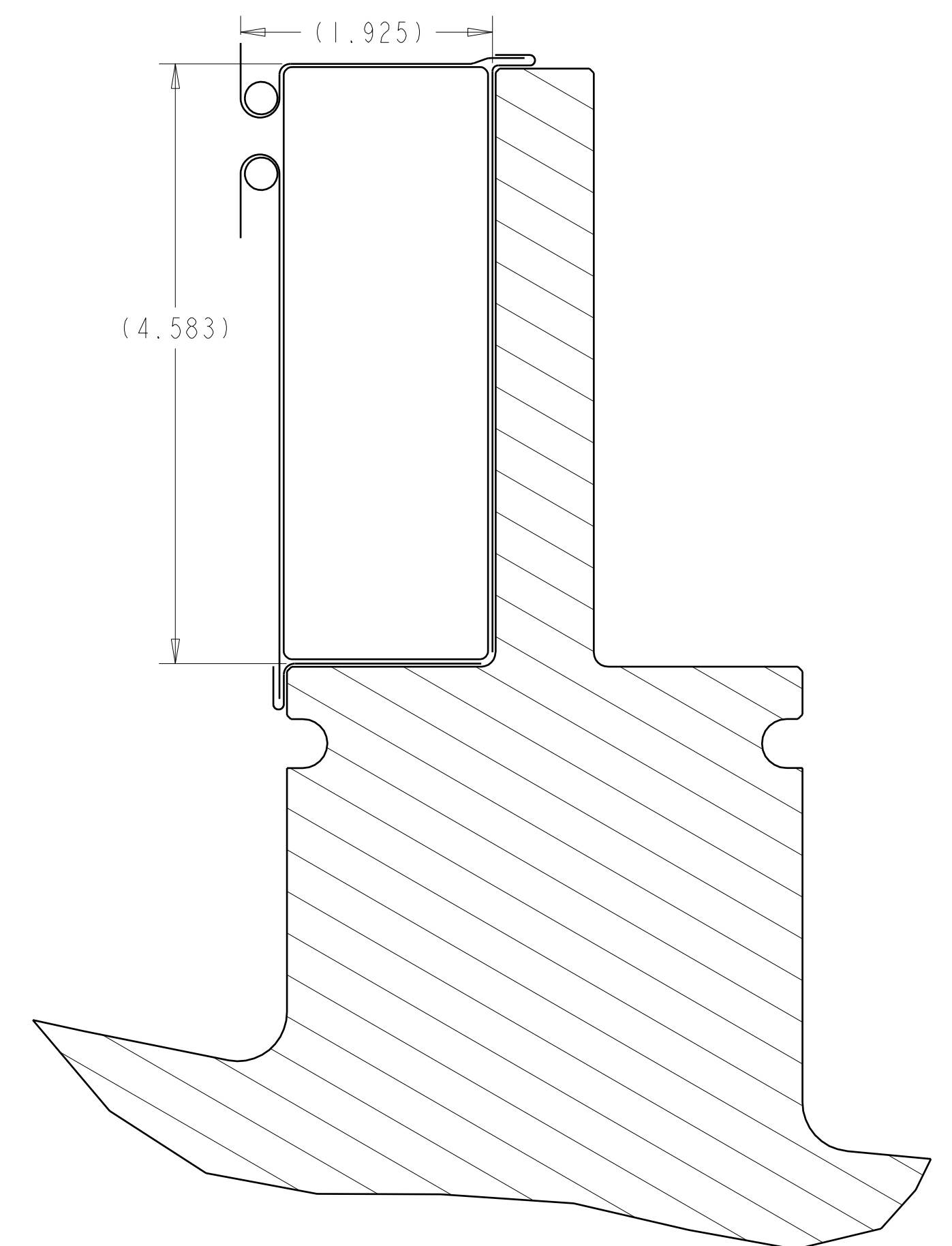
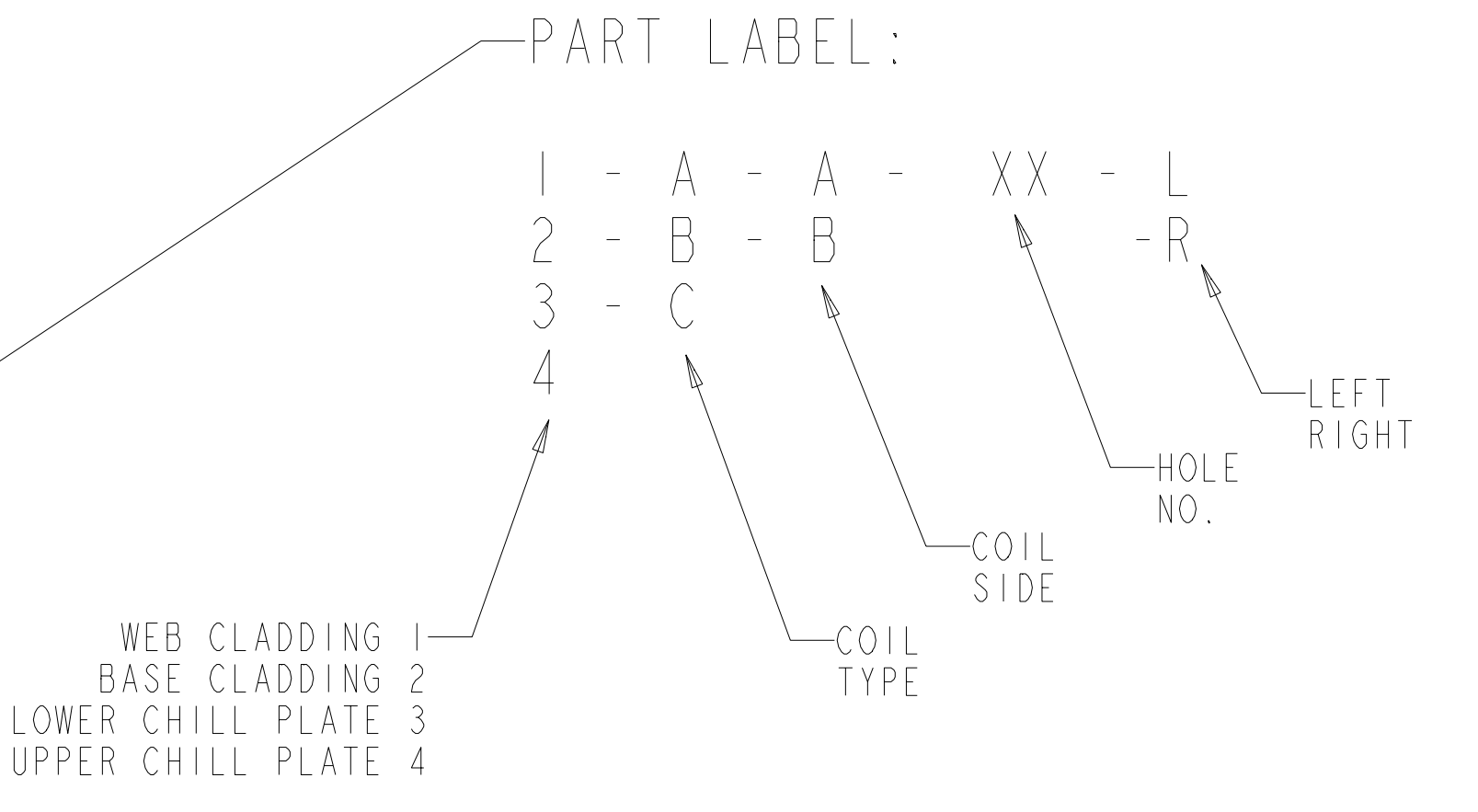

TYPICAL SECTION  
 SCALE 1.00

**RELEASED FOR  
 FABRICATION / INSTALLATION**  
 PPPL Drafting:

6	378	SE142A-257	CHILL PLATES	COPPER, ANNEALED UNS C10100, C10200	4
6	386	SE142A-255	CLADDING	COPPER, ANNEALED UNS C10100, C10200	3
I		SE141-114-SIM	TYPE-A MODULAR COIL WINDING FORM		2
AR	X	-1	TYPE-A SIDE-A CLADDING AND CHILL PLATES		1
SE140-101					
	CAGE CODE	PART OR IDENTIFYING NO	NOMENCLATURE OR DESCRIPTION	MATERIAL / SPECIFICATION	FIND NO
			NEXT ASSEMBLY	PARTS LIST	

NO REPRESENTATION OR WARRANTY, EXPRESSED OR IMPLIED, IS MADE AS TO THE ACCURACY, COMPLETENESS OR USEFULNESS OF THE INFORMATION OR STATEMENTS CONTAINED IN THESE DRAWINGS, OR THAT THE USE OR DISCLOSURE OF ANY INFORMATION, APPARATUS, METHOD OR PROCESS DISCLOSED IN THESE DRAWINGS MAY NOT INFRINGE PRIVATE RIGHTS OF OTHERS. NO LIABILITY IS ASSUMED WITH RESPECT TO THE USE OF, OR FOR DAMAGES RESULTING FROM THE USE OF, ANY INFORMATION, APPARATUS, METHOD OR PROCESS DISCLOSED IN THESE DRAWINGS. DRAWINGS MADE AVAILABLE FOR INFORMATION TO BIDDER ARE NOT TO BE USED FOR OTHER PURPOSES, AND ARE TO BE RETURNED UPON REQUEST OF THE FORWARDING CONTRACTOR.

**P** THIS DRAWING PRODUCED ON PRO-ENGINEER

REV	DESCRIPTION	BY	DATE	CHK	DEPT	DATE	PE	REQ	DATE	ORNL	DOE	DATE

SCALE NOTED	DES. T. HARGROVE 02-06	<b>UT-BATTELLE</b> Oak Ridge National Laboratory managed for the DEPARTMENT OF ENERGY under U.S. GOVERNMENT contract DE-AC05-00OR22725 UT-BATTELLE, LLC. Oak Ridge, Tennessee PRODUCT NAME
TOLERANCES UNLESS OTHERWISE SPECIFIED	DRW. D. WILLIAMSON 02-06	
FRACTIONS	CHK. M. COLE 02-06	<b>NATIONAL COMPACT STELLARATOR EXPERIMENT</b> MODULAR COIL TYPE-A SIDE-A CLADDING AND CHILL PLATES FLAT PATTERN LAYOUT
XX DECIMALS ±.01	PE. D. WILLIAMSON 02-06	
XXX DECIMALS ±.005	CR. : :	PPPL DRFT. J. SIEGEL 02-06
ANGLES ±0°15'	PJ. : :	VERSION NO. 13
BREAK SHARP EDGES .06 MAX	RED. : :	PLANT X-10
FINISH .125 UNLESS OTHERWISE SPECIFIED	PPPL DRFT. J. SIEGEL 02-06	BLDG 5700
		FL 3
		SHT 1
		TYPE 12
		CLASS S
		RELEASE LEVEL Fabrication
		REV 0

H  
G  
F  
E  
D  
C  
B  
A



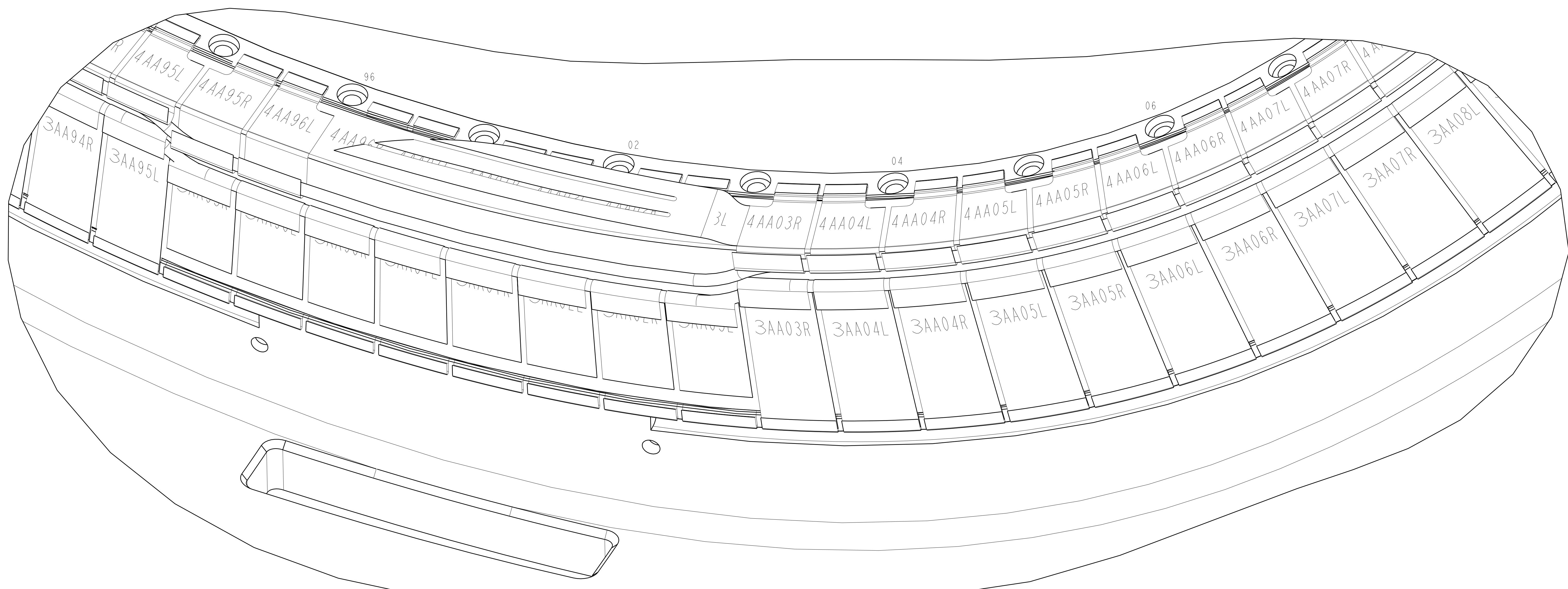
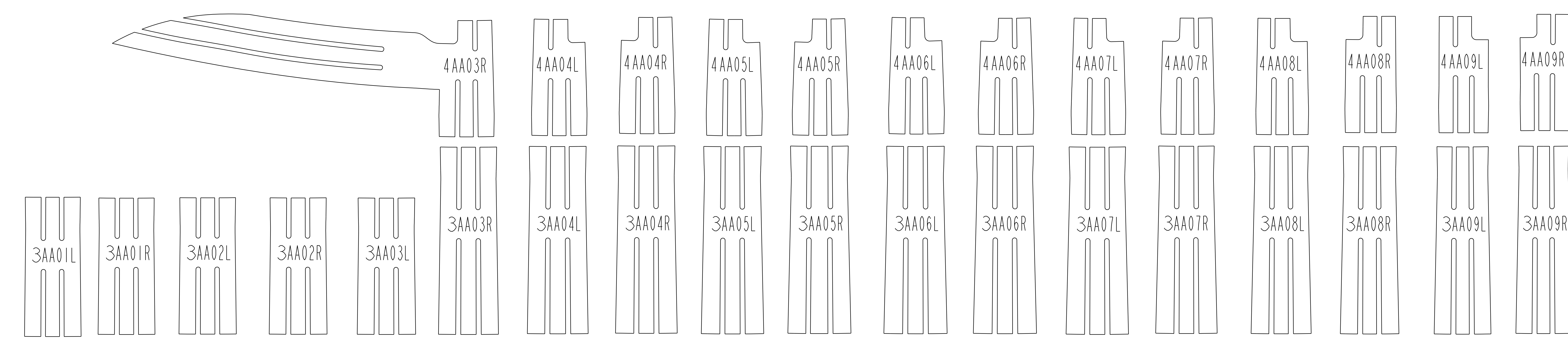
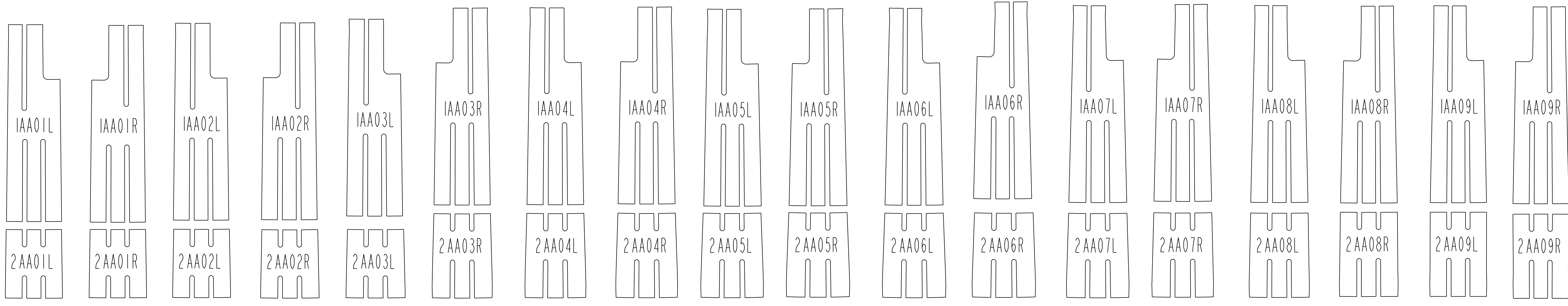

ISOMETRIC VIEW  
 SCALE 1:00

**RELEASED FOR  
 FABRICATION / INSTALLATION**  
 PPPL Drafting:

Oak Ridge National Laboratory managed for the DEPARTMENT OF ENERGY under U.S. GOVERNMENT contract DE-AC05-00OR22725 UT-BATTELLE, LLC, Oak Ridge, Tennessee						
<b>UT-BATTELLE</b>						
NATIONAL COMPACT STELLARATOR EXPERIMENT						
MODULAR COIL TYPE-A SIDE-A CLADDING AND CHILL PLATES FLAT PATTERN LAYOUT						
VERSION NO.	PLANT	BLDG	FL	SHT OF	TYPE	CLASS
13	X-10	5700	3	2	12	S U
RELEASE LEVEL		SE142A-252		REV		
Fabrication				0		

SE142A-252



8

7

6

5

4

3

2

1

NEXT ASS'Y: 1 FINAL ASS'Y:

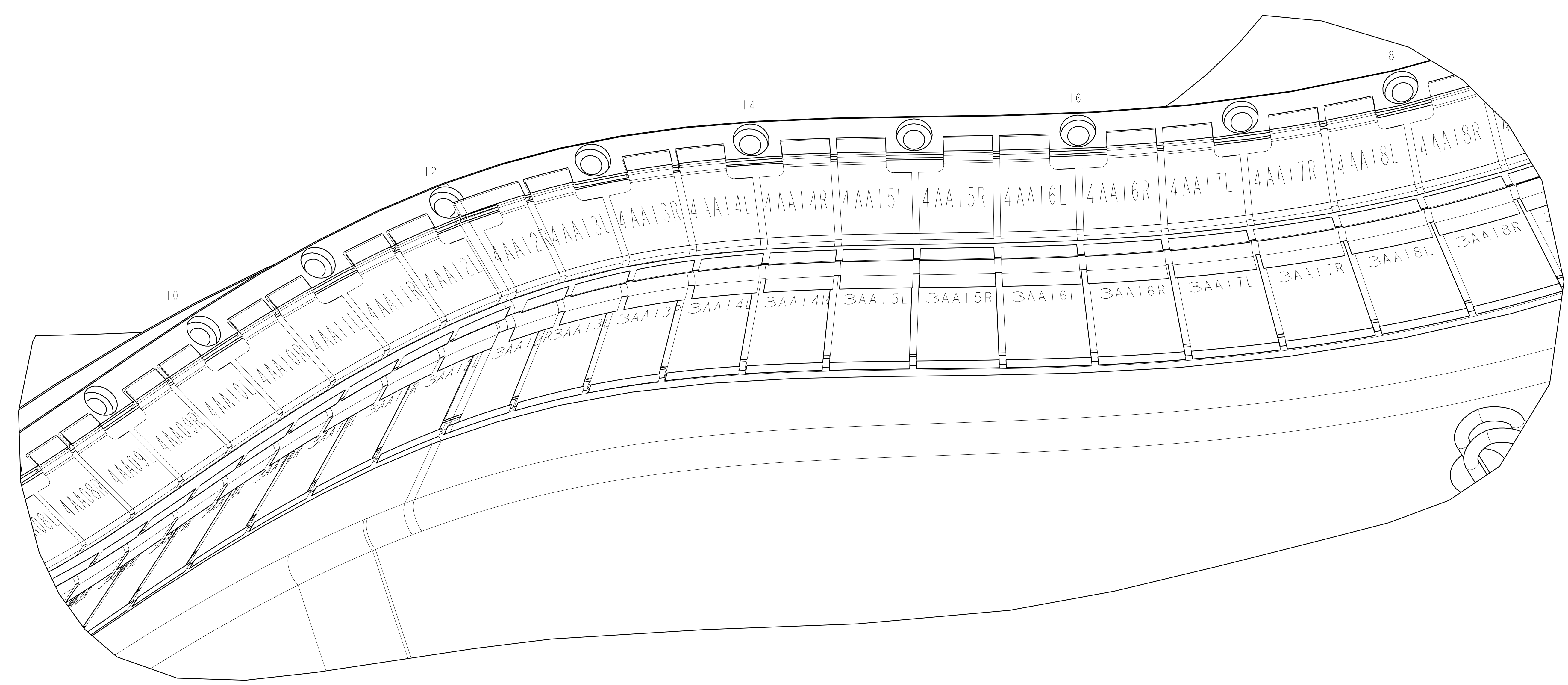
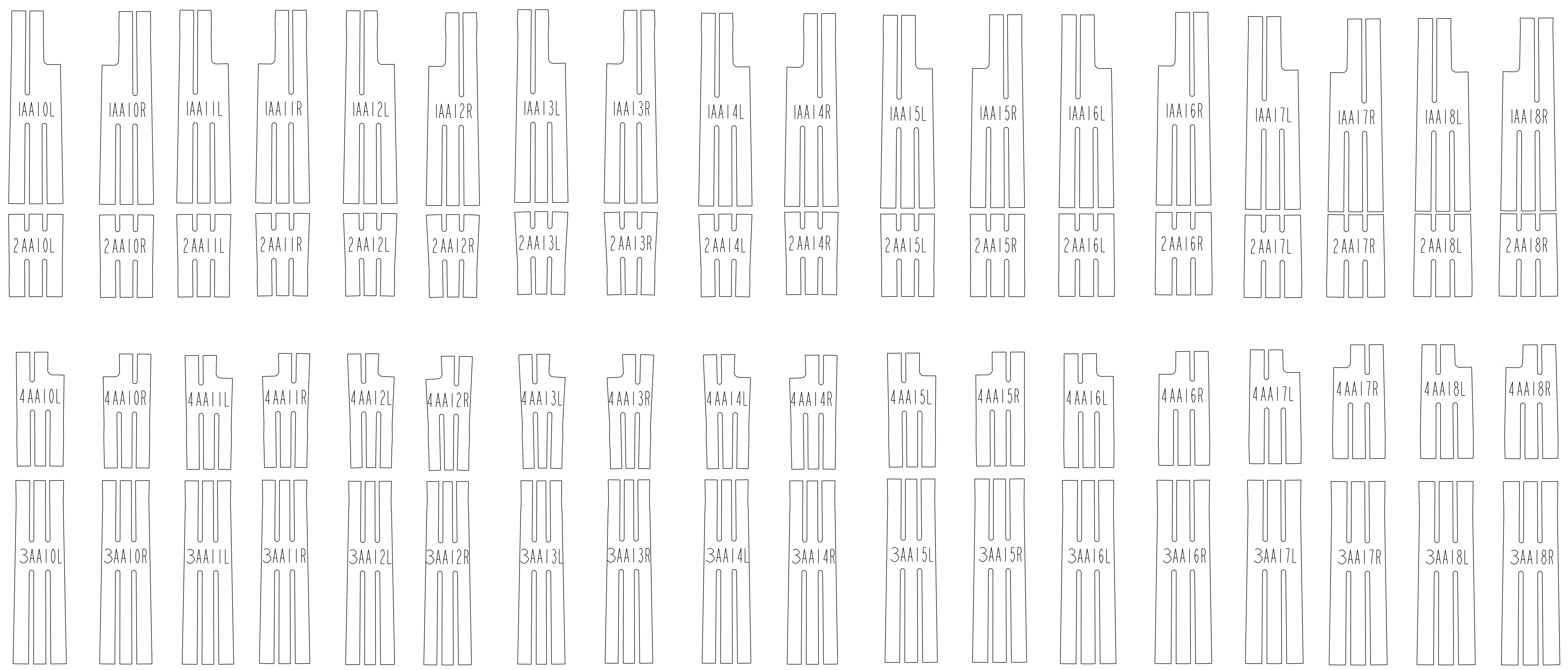

ISOMETRIC VIEW  
SCALE 1.00

**RELEASED FOR  
FABRICATION / INSTALLATION**  
PPPL Drafting:

Oak Ridge National Laboratory managed for the DEPARTMENT OF ENERGY under U.S. GOVERNMENT contract DE-AC05-00OR22725 UT-BATTELLE, LLC, Oak Ridge, Tennessee PROJECT NAME:						
<b>NATIONAL COMPACT STELLARATOR EXPERIMENT</b> MODULAR COIL TYPE-A SIDE-A CLADDING AND CHILL PLATES FLAT PATTERN LAYOUT						
VERSION NO.	PLANT	BLDG	FL	SHT OF	TYPE	CLASS
13	X-10	5700	3	3	12	S U
RELEASE LEVEL		REV				
Fabrication		SE142A-252				
						0

H  
G  
F  
E  
D  
C  
B  
A

SE142A-252



8

7

6

5

4

3

2

1

NEXT ASS'Y: 1 FINAL ASS'Y:

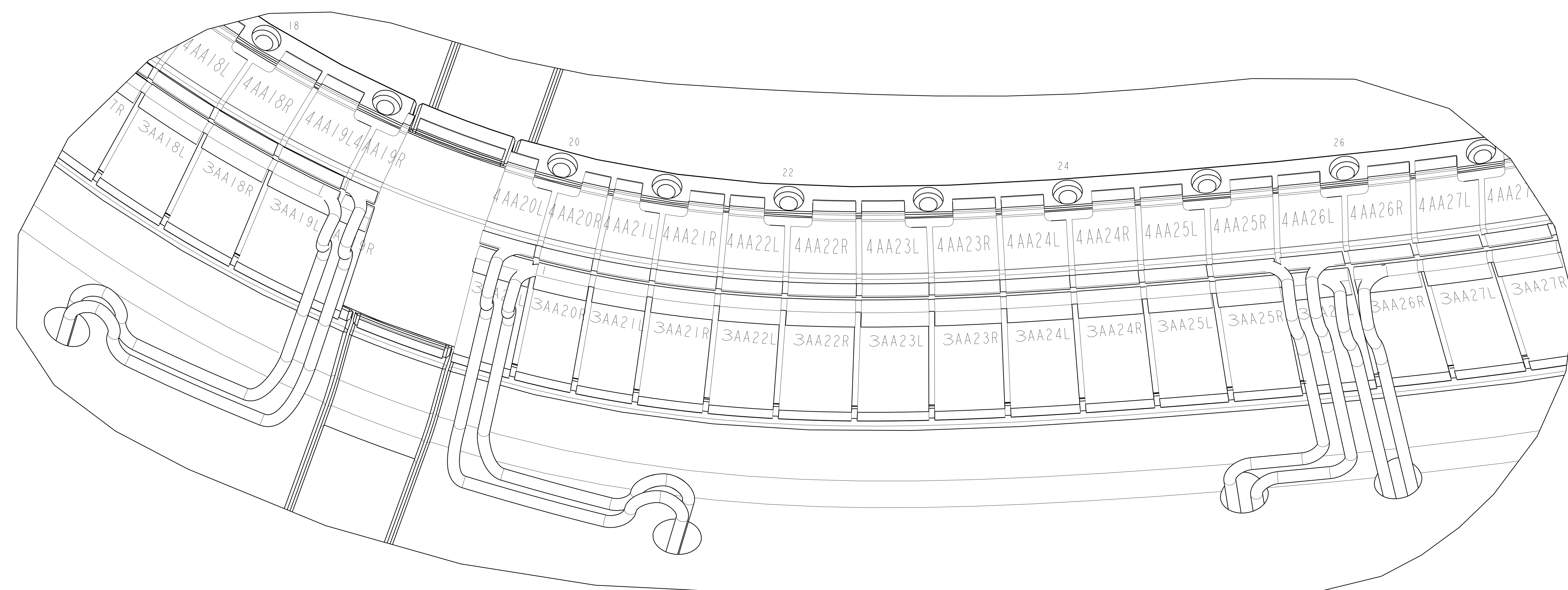
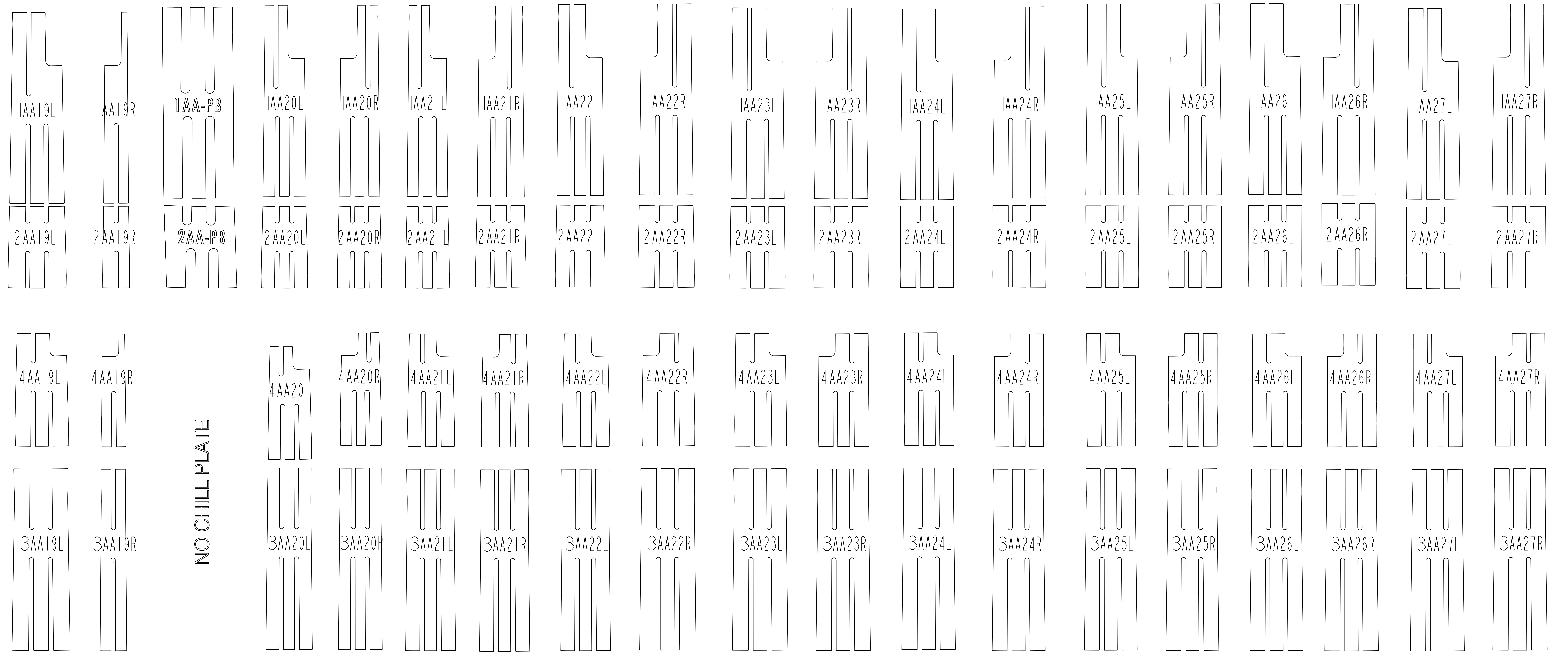

ISOMETRIC VIEW  
SCALE 1.00

**RELEASED FOR  
FABRICATION / INSTALLATION**  
 PPPL Drafting

Oak Ridge National Laboratory managed for the DEPARTMENT OF ENERGY under U.S. GOVERNMENT contract DE-AC05-00OR22725 UT-BATTELLE, LLC. Oak Ridge, Tennessee							
<b>NATIONAL COMPACT STELLARATOR EXPERIMENT</b> MODULAR COIL TYPE-A SIDE-A CLADDING AND CHILL PLATES FLAT PATTERN LAYOUT							
VERSION NO.	PLANT	BLDG	FL	SHT OF	TYPE	CLASS	
13	X-10	5700	3	4	12	S	U
RELEASE LEVEL		SE142A-252		REV		0	
Fabrication							

SE142A-252

A



8

7

6

5

4

3

2

1

NEXT ASS'Y: 1 FINAL ASS'Y:

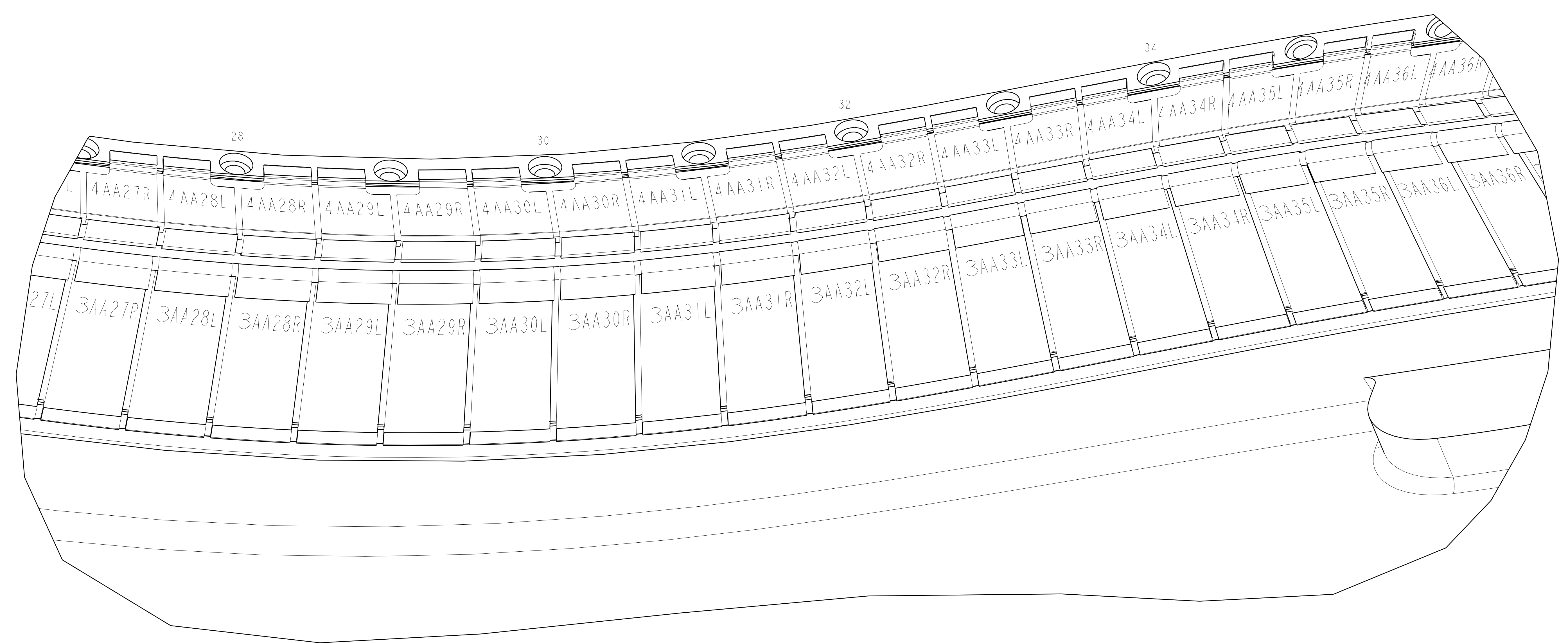
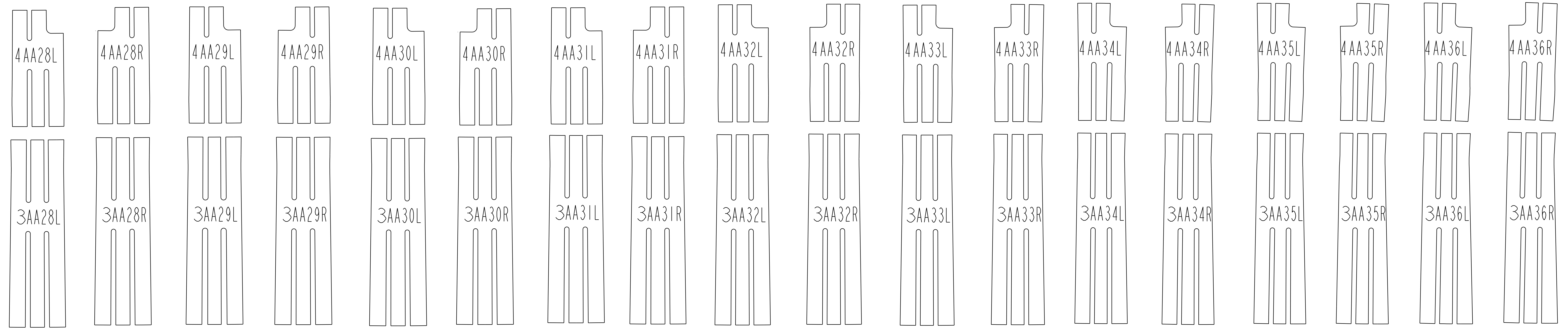
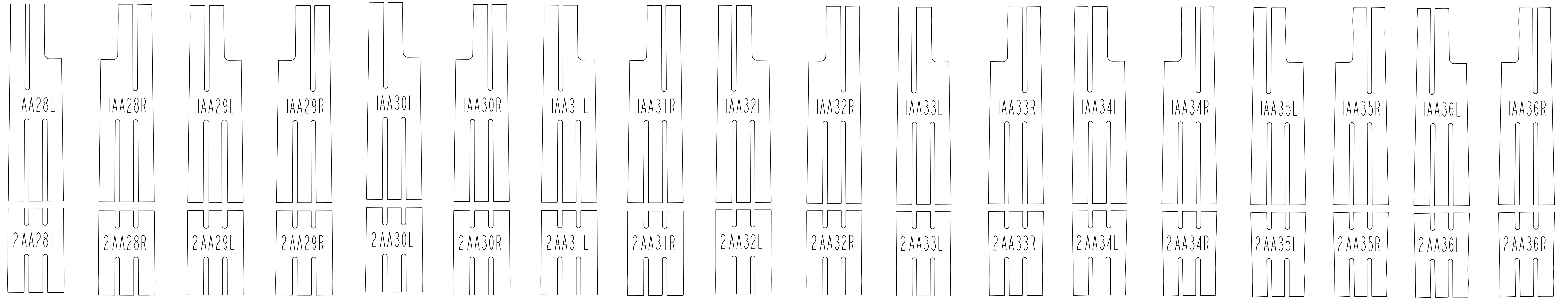

**RELEASED FOR  
FABRICATION / INSTALLATION**

PPPL Drafting:

ISOMETRIC VIEW  
SCALE 1:00

Oak Ridge National Laboratory managed for the DEPARTMENT OF ENERGY under U.S. GOVERNMENT contract DE-AC05-00OR22725 UT-BATTELLE, LLC, Oak Ridge, Tennessee							
<b>UT-BATTELLE</b> NATIONAL COMPACT STELLARATOR EXPERIMENT MODULAR COIL TYPE-A SIDE-A CLADDING AND CHILL PLATES FLAT PATTERN LAYOUT							
VERSION NO.	PLANT	BLDG	FL	SHT	OF	TYPE	CLASS
13	X-10	5700	3	5	12	S	U
RELEASE LEVEL		Fabrication					
SE142A-252							REV 0

SE142A-252

A



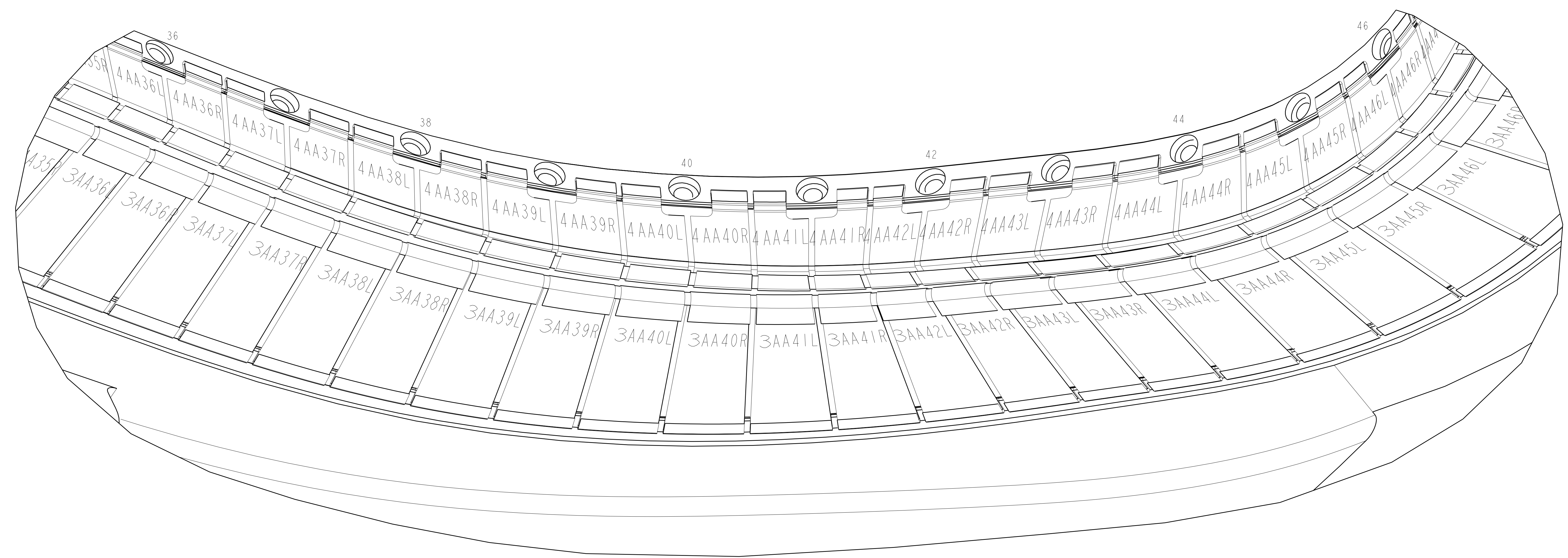
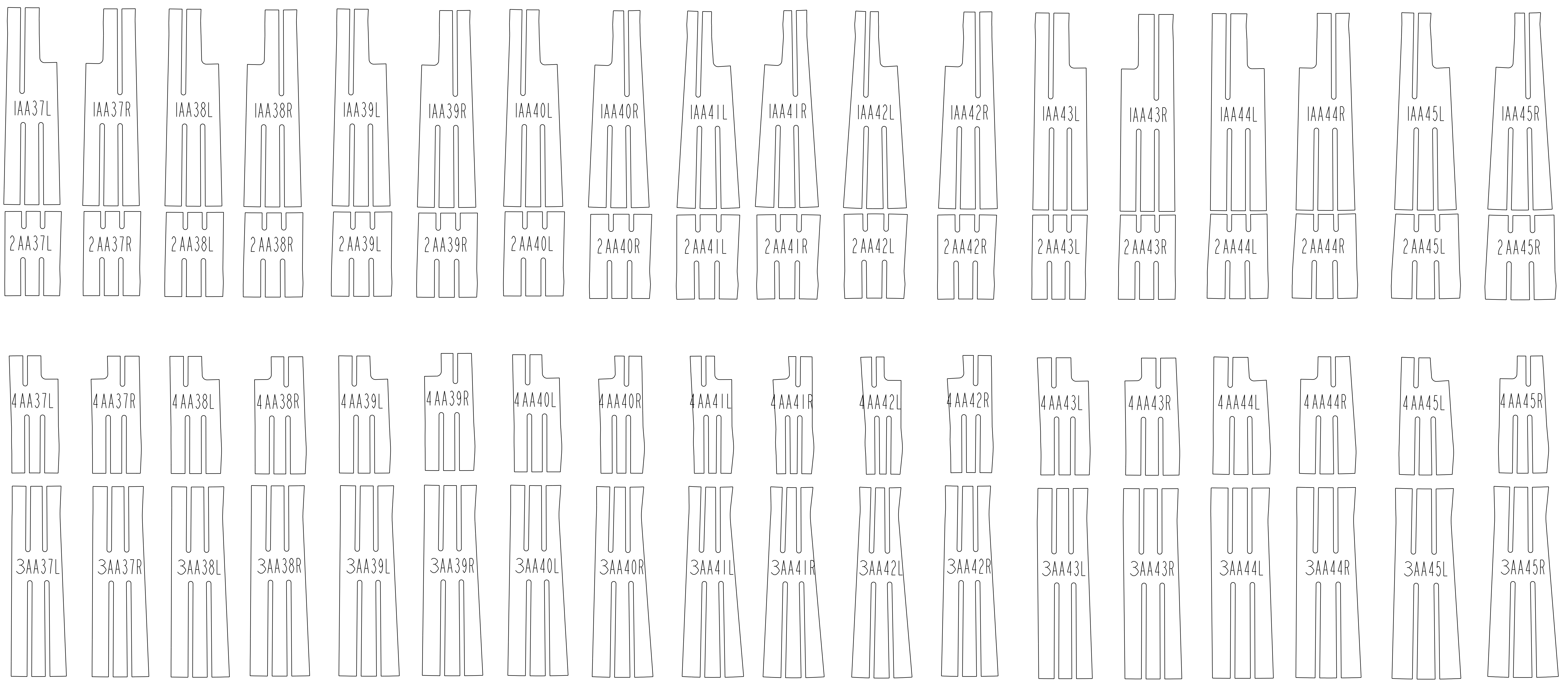

ISOMETRIC VIEW  
SCALE 1.00

**RELEASED FOR  
FABRICATION / INSTALLATION**  
PPPL Drafting:

<b>UT-BATTELLE</b>		Oak Ridge National Laboratory managed for the DEPARTMENT OF ENERGY under U.S. GOVERNMENT contract DE-AC05-00OR22725 UT-BATTELLE, LLC, Oak Ridge, Tennessee					
<b>NATIONAL COMPACT STELLARATOR EXPERIMENT</b>							
MODULAR COIL TYPE-A SIDE-A CLADDING AND CHILL PLATES FLAT PATTERN LAYOUT							
VERSION NO. 13	PLANT X-10	BLDG 5700	FL 3	SHT OF 6	TYPE 12	CLASS S	
RELEASE LEVEL Fabrication		SE142A-252			REV 0		

SE142A-252

A



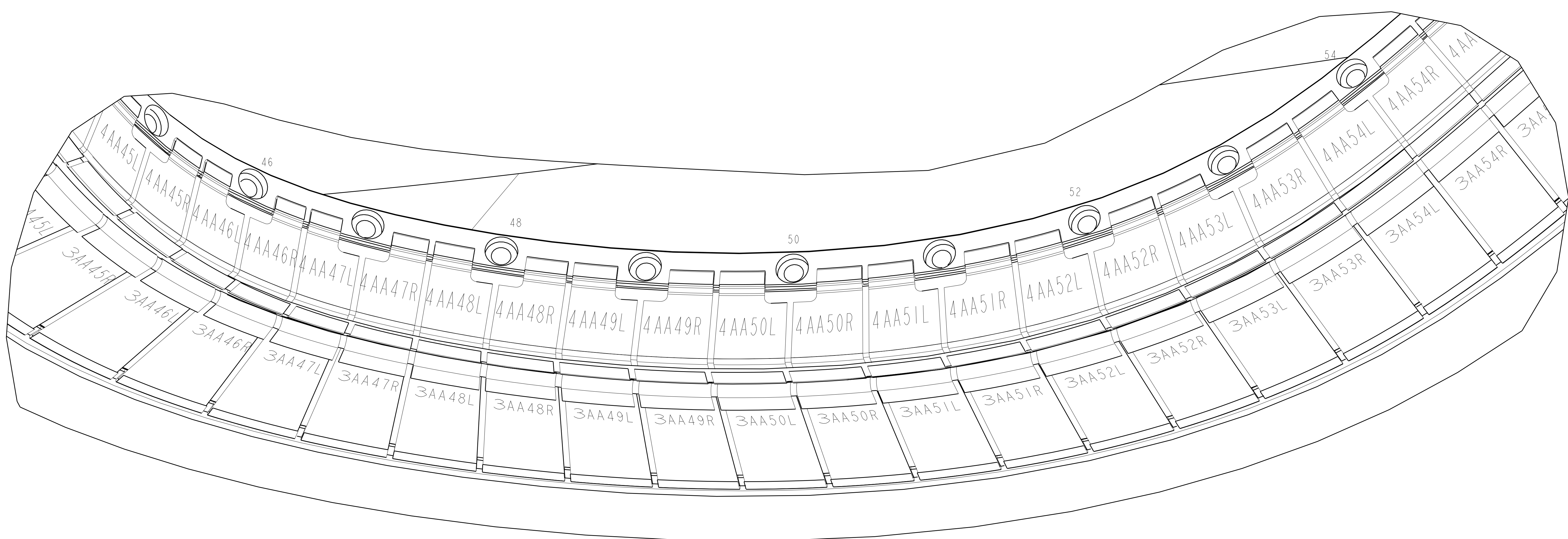
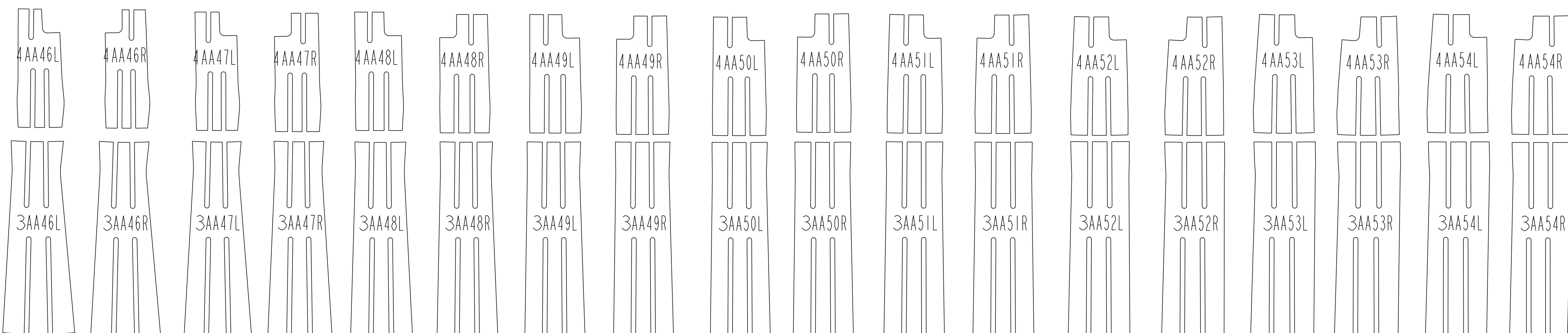
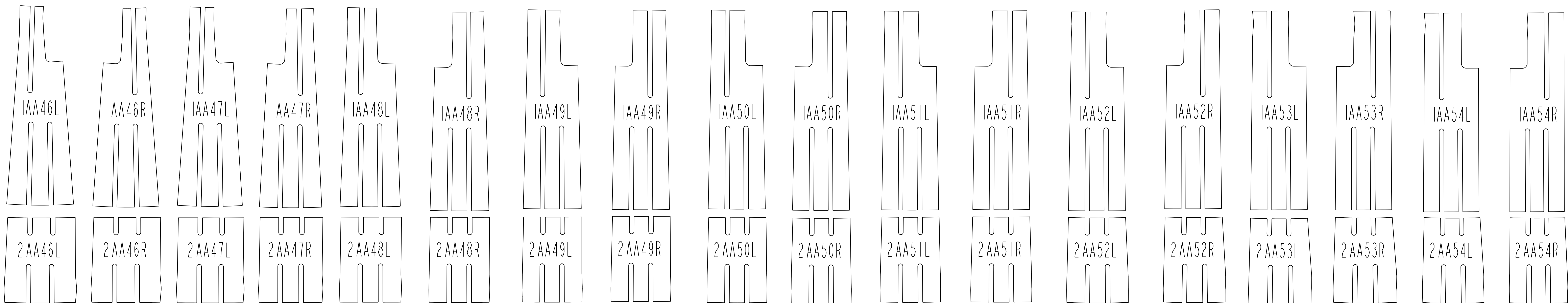

ISOMETRIC VIEW  
 SCALE 1.00

**RELEASED FOR  
 FABRICATION / INSTALLATION**  
 PPPL Drafting:

<b>UT-BATTELLE</b>		Oak Ridge National Laboratory managed for the DEPARTMENT OF ENERGY under U.S. GOVERNMENT contract DE-AC05-00OR22725 UT-BATTELLE, LLC, Oak Ridge, Tennessee					
PROJECT NAME							
<b>NATIONAL COMPACT STELLARATOR EXPERIMENT</b>							
MODULAR COIL TYPE-A							
SIDE-A CLADDING AND CHILL PLATES							
FLAT PATTERN LAYOUT							
VERSION NO.	PLANT	BLDG	FL	SHT OF	TYPE	CLASS	
13	X-10	5700	3	7	12	S	
RELEASE LEVEL		SE142A-252				REV	
Fabrication						0	

SE142A-252



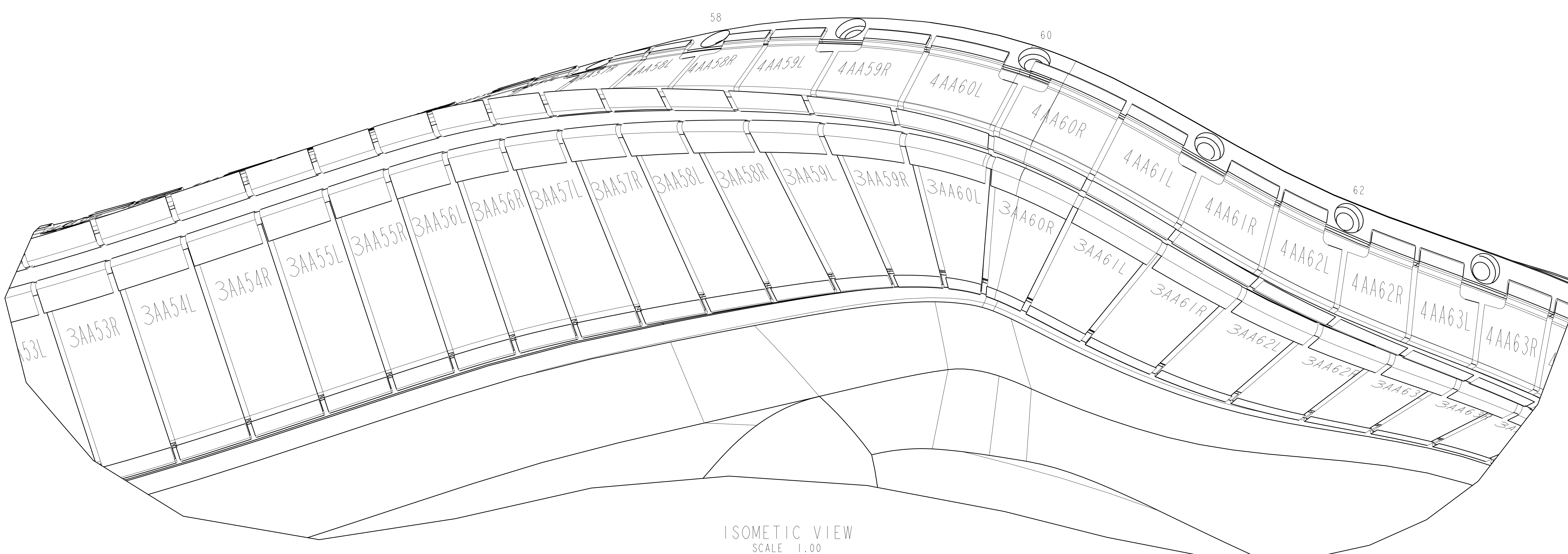
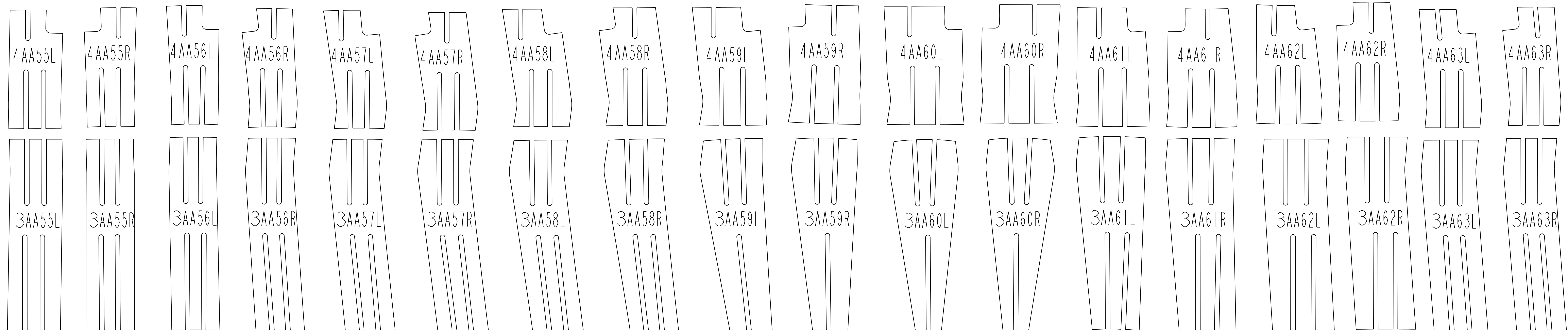
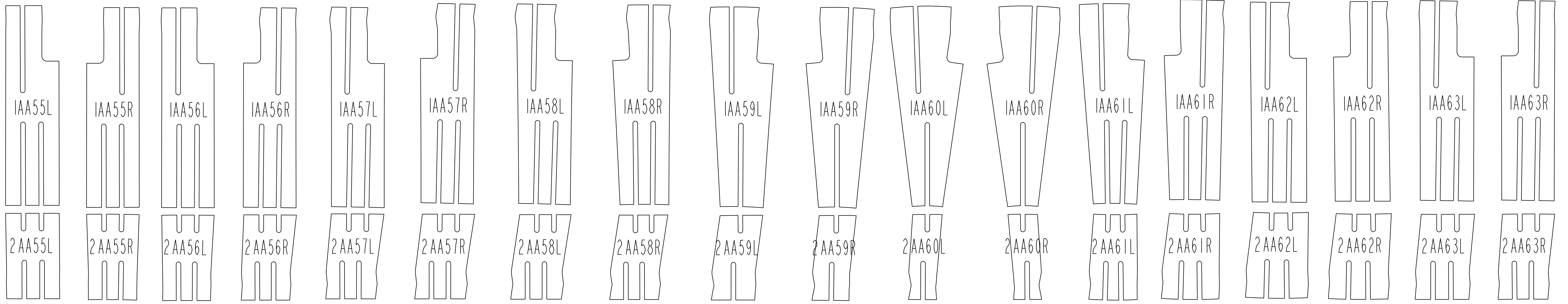

**RELEASED FOR  
 FABRICATION / INSTALLATION**  
 PPPL Drafting:

Oak Ridge National Laboratory managed for the DEPARTMENT OF ENERGY under U.S. GOVERNMENT contract DE-AC05-00OR22725 UT-BATTELLE, LLC, Oak Ridge, Tennessee						
<b>UT-BATTELLE</b>						
NATIONAL COMPACT STELLARATOR EXPERIMENT MODULAR COIL TYPE-A SIDE-A CLADDING AND CHILL PLATES FLAT PATTERN LAYOUT						
VERSION NO.	PLANT	BLDG	FL	SHT OF	TYPE	CLASS
13	X-10	5700	3	8	12	S
RELEASE LEVEL		SEI42A-252		REV		U
Fabrication						0

H  
G  
F  
E  
D  
C  
B  
A



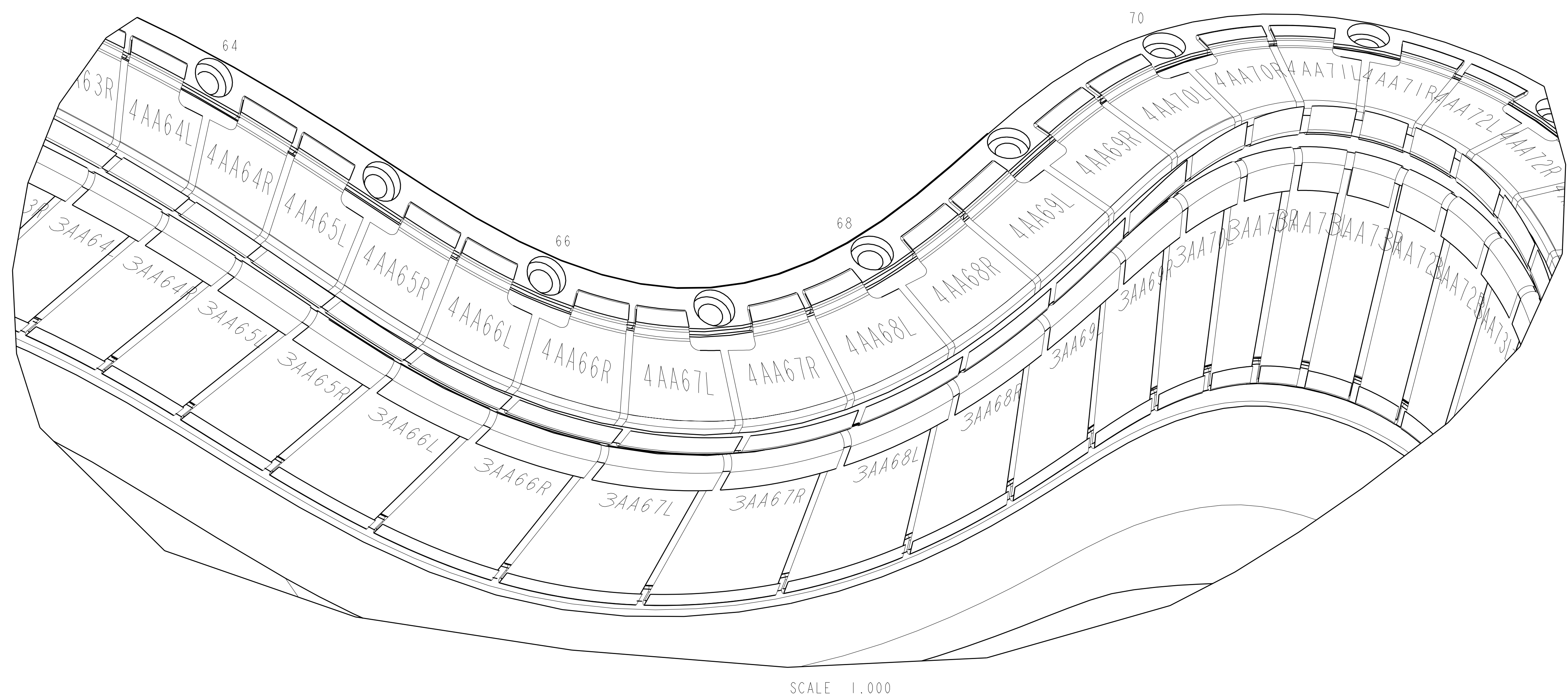
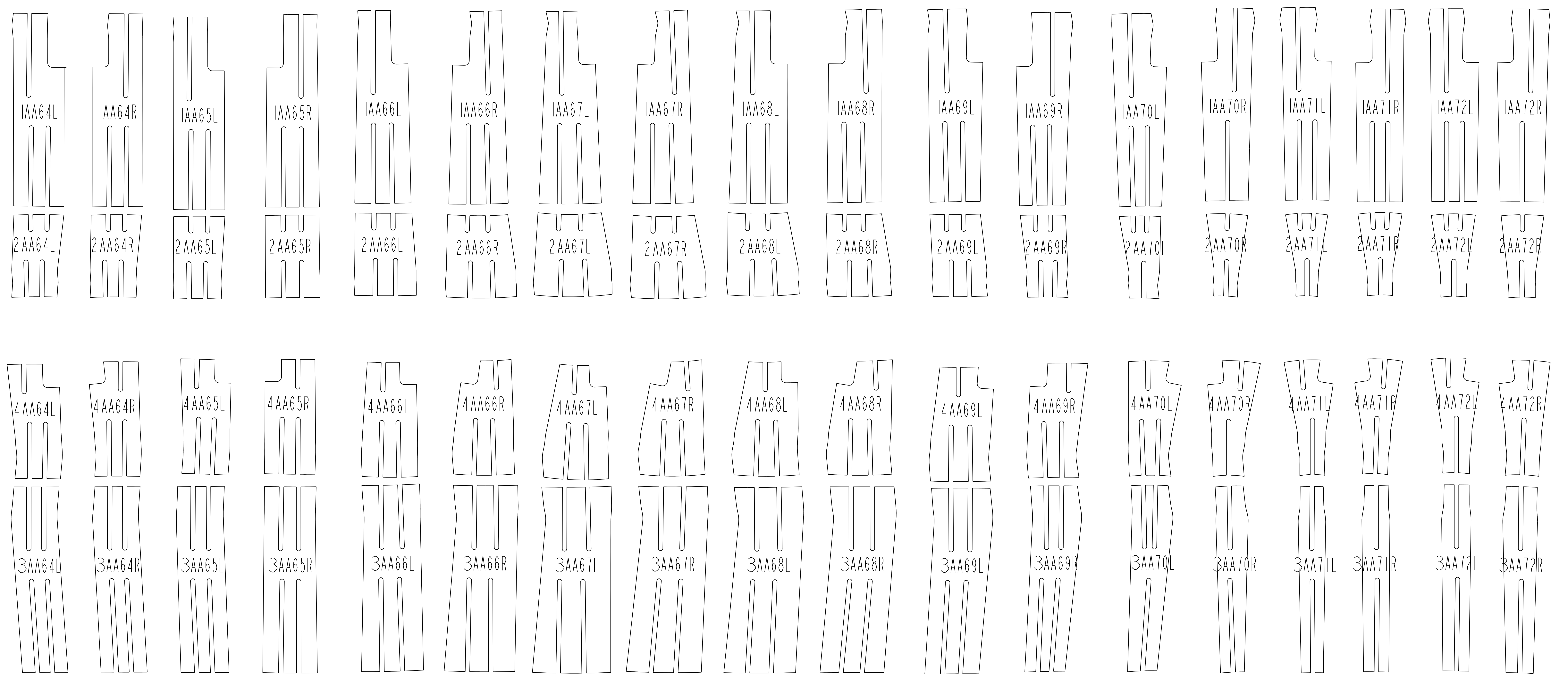

**RELEASED FOR  
 FABRICATION / INSTALLATION**  
 PPPL Drafting:

Oak Ridge National Laboratory managed for the DEPARTMENT OF ENERGY under U.S. GOVERNMENT contract DE-AC05-00OR22725 UT-BATTELLE, LLC., Oak Ridge, Tennessee						
<b>UT-BATTELLE</b>						
NATIONAL COMPACT STELLARATOR EXPERIMENT MODULAR COIL TYPE-A SIDE-A CLADDING AND CHILL PLATES FLAT PATTERN LAYOUT						
VERSION NO.	PLANT	BLDG	FL	SHT OF	TYPE	CLASS
13	X-10	5700	3	9	12	S
RELEASE LEVEL		Fabrication		SE142A-252		REV 0

SE142A-252

A



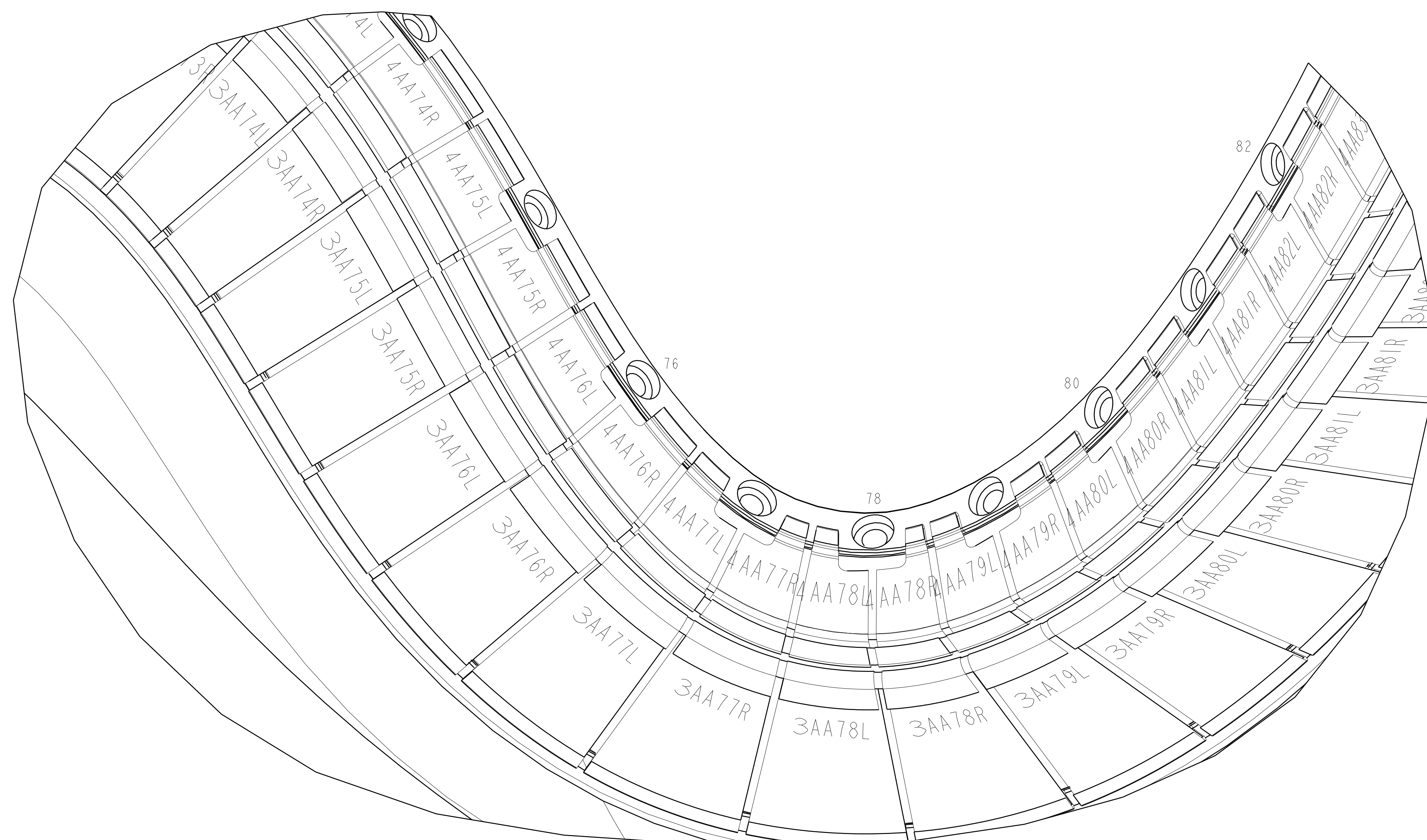
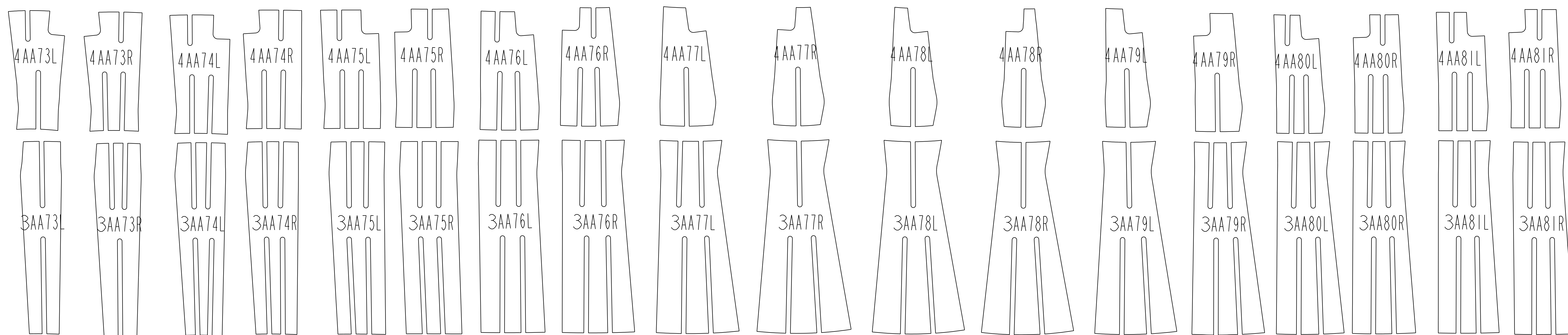
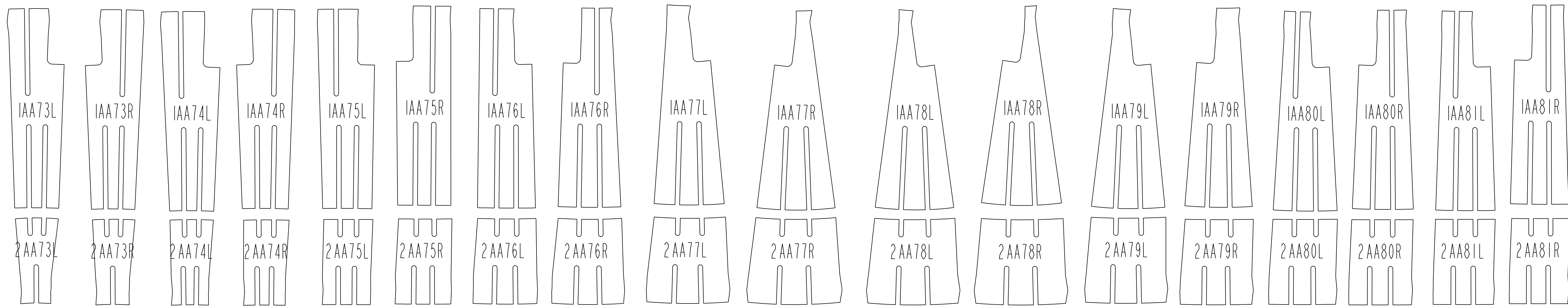

**RELEASED FOR  
 FABRICATION / INSTALLATION**  
 PPPL Drafting:

<b>UT-BATTELLE</b>		Oak Ridge National Laboratory managed for the DEPARTMENT OF ENERGY under U.S. GOVERNMENT contract DE-AC05-00OR22725 UT-BATTELLE, LLC, Oak Ridge, Tennessee					
PROJECT NAME							
<b>NATIONAL COMPACT STELLARATOR EXPERIMENT</b>							
MODULAR COIL TYPE-A							
SIDE-A CLADDING AND CHILL PLATES							
FLAT PATTERN LAYOUT							
VERSION NO.	PLANT	BLDG	FL	SHT OF	TYPE	CLASS	
13	X-10	5700	3	10	12 S	U	
RELEASE LEVEL						REV	
Fabrication		SE142A-252				0	

SE142A-252



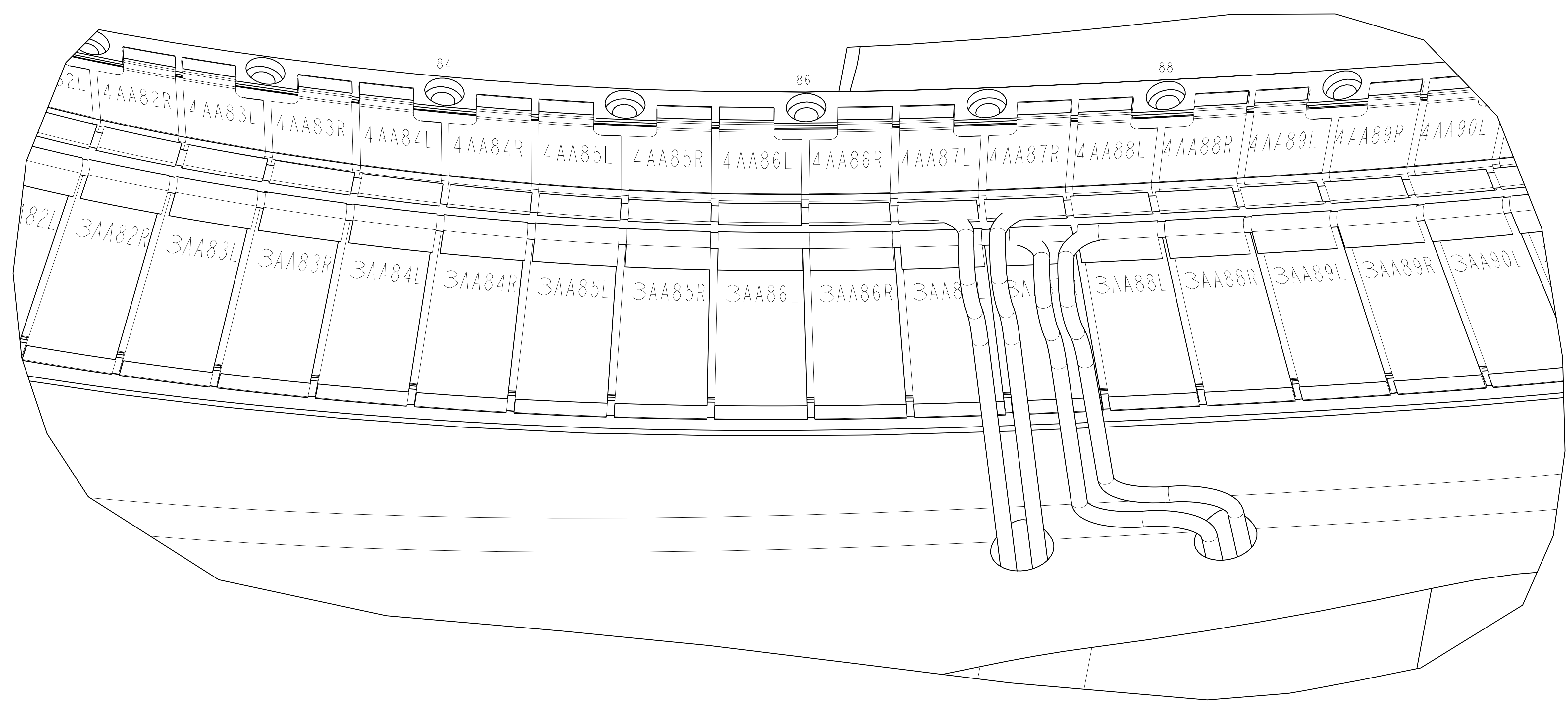
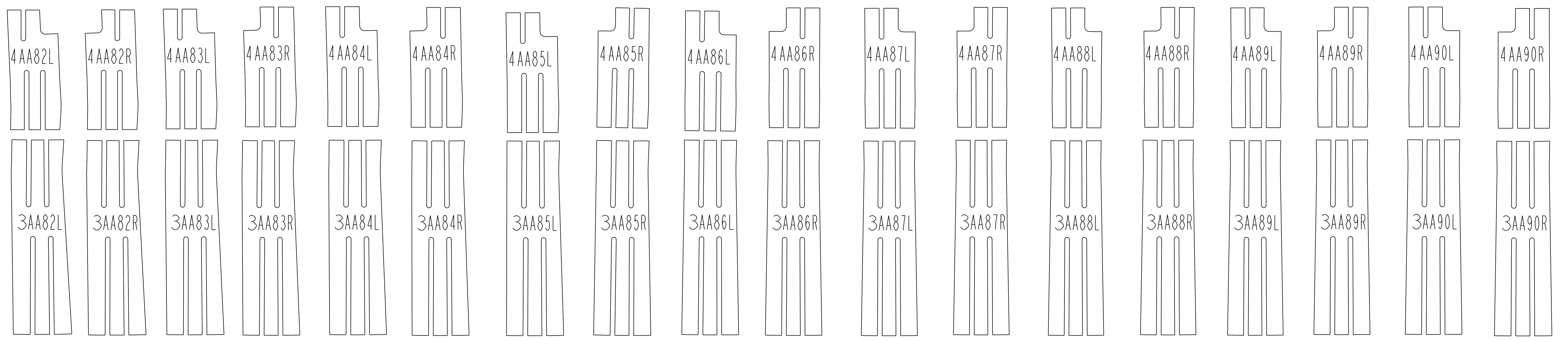
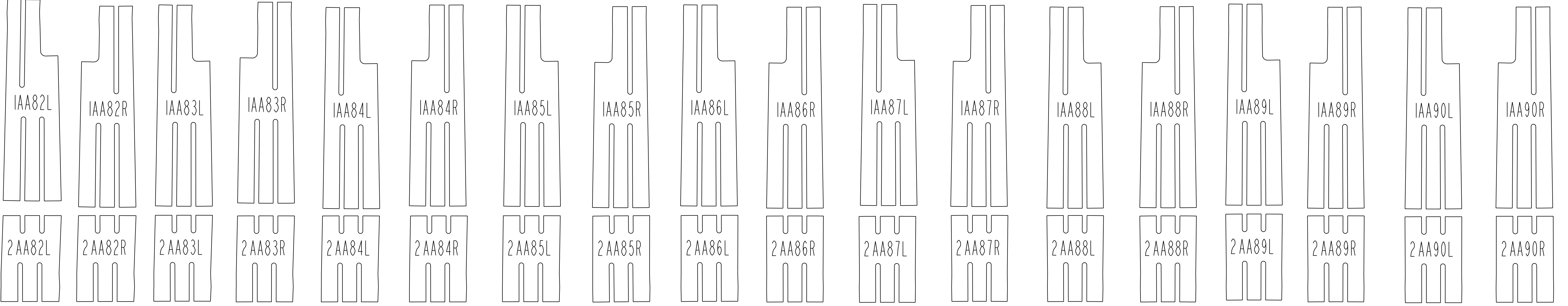

ISOMETRIC VIEW  
 SCALE 1.00

**RELEASED FOR  
 FABRICATION / INSTALLATION**  
 PPPL Drafting:

<b>UT-BATTELLE</b>		<small>Oak Ridge National Laboratory managed for the DEPARTMENT OF ENERGY under U.S. GOVERNMENT contract DE-AC05-00OR22725 UT-BATTELLE, LLC, Oak Ridge, Tennessee</small>					
<b>NATIONAL COMPACT STELLARATOR EXPERIMENT</b>							
<b>MODULAR COIL TYPE-A</b>							
<b>SIDE-A CLADDING AND CHILL PLATES</b>							
<b>FLAT PATTERN LAYOUT</b>							
VERSION NO.	PLANT	BLDG	FL	SHT OF	TYPE	CLASS	
13	X-10	5700	3	11	12 S	U	
RELEASE LEVEL		SE142A-252				REV	
Fabrication						0	

H  
G  
F  
E  
D  
C  
B  
A

SE142A-252



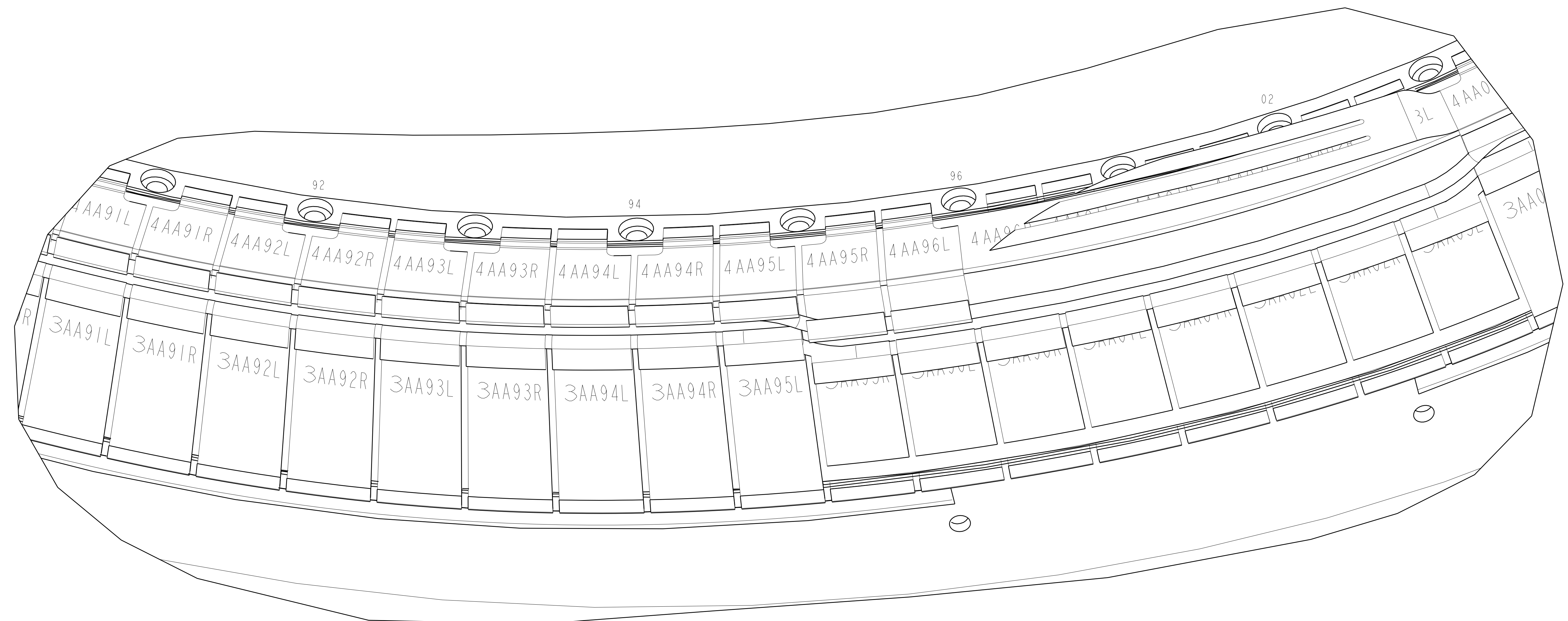
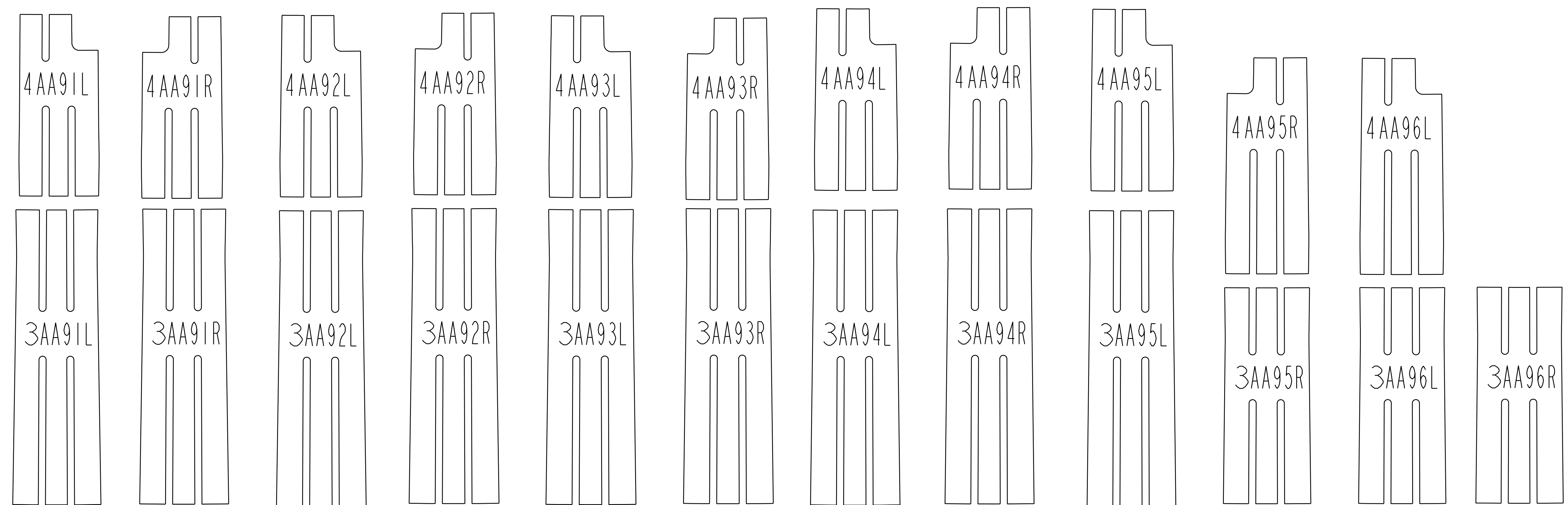
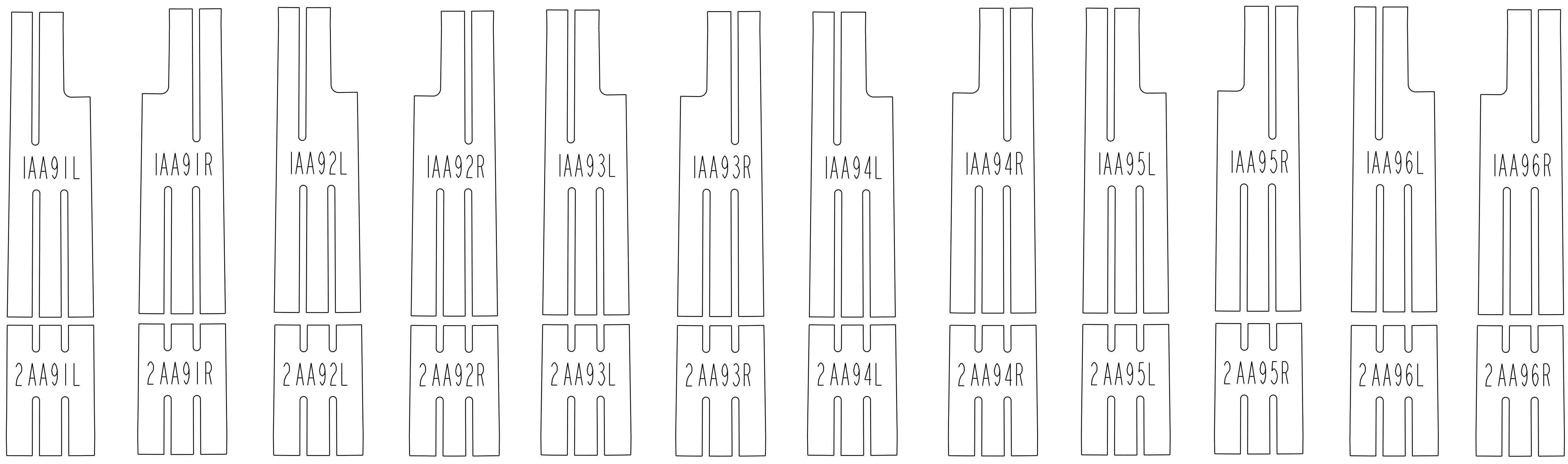

ISOMETRIC VIEW  
 SCALE 1.00

**RELEASED FOR  
 FABRICATION / INSTALLATION**  
 PPPL Drafting:

<b>UT-BATTELLE</b>		<small>Oak Ridge National Laboratory managed for the DEPARTMENT OF ENERGY under U.S. GOVERNMENT contract DE-AC05-00OR22725 UT-BATTELLE, LLC. Oak Ridge, Tennessee</small>					
<b>NATIONAL COMPACT STELLARATOR EXPERIMENT</b>							
MODULAR COIL TYPE-A							
SIDE-A CLADDING AND CHILL PLATES							
FLAT PATTERN LAYOUT							
VERSION NO.	PLANT	BLDG	FL	SHT OF	TYPE	CLASS	
13	X-10	5700	3	12	12 S	U	
RELEASE LEVEL		SE142A-252				REV	
Fabrication						0	

SE142A-252