

NO.	REVISION	BY	CH	SUP	APPROVED	DATE

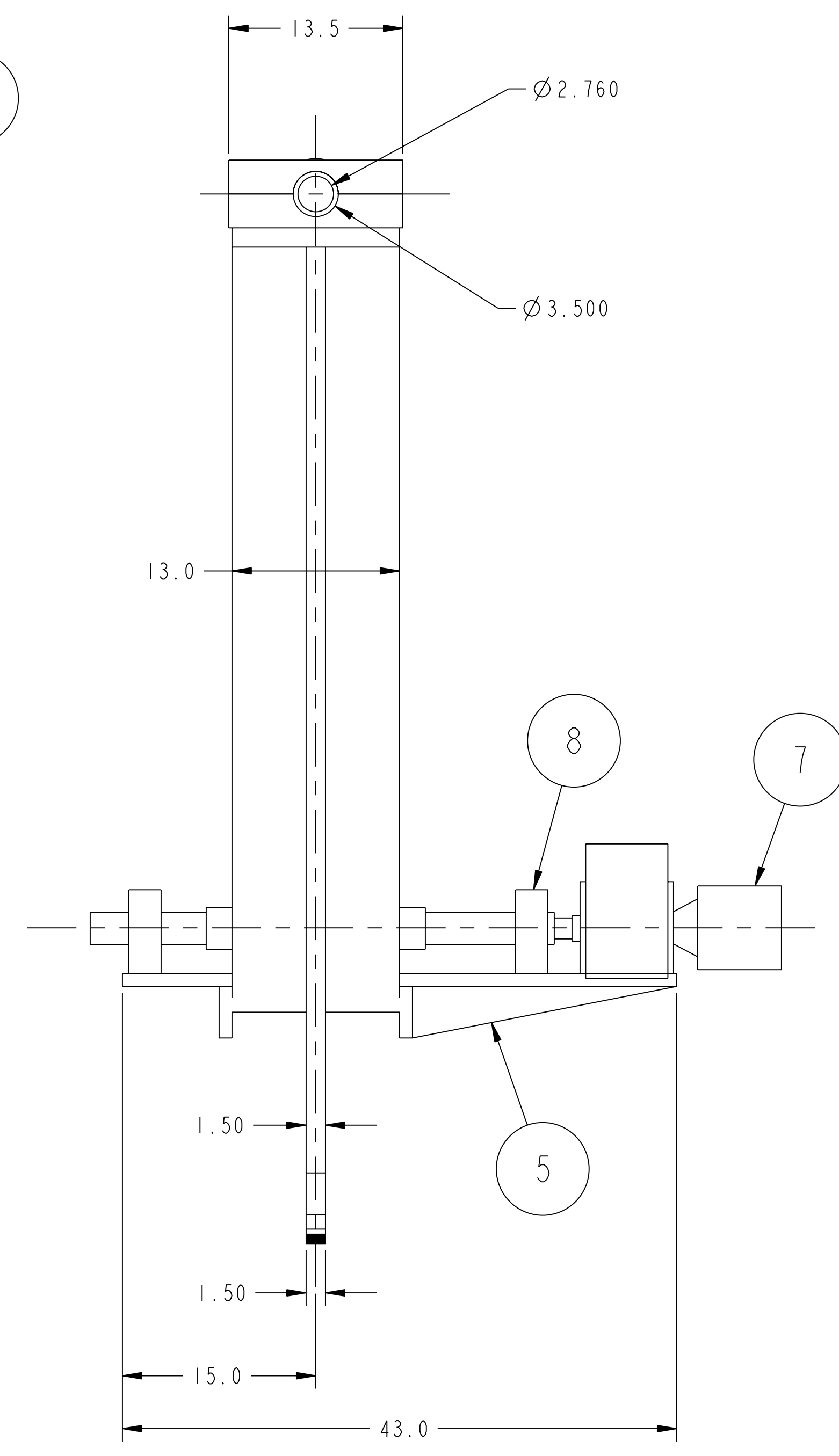
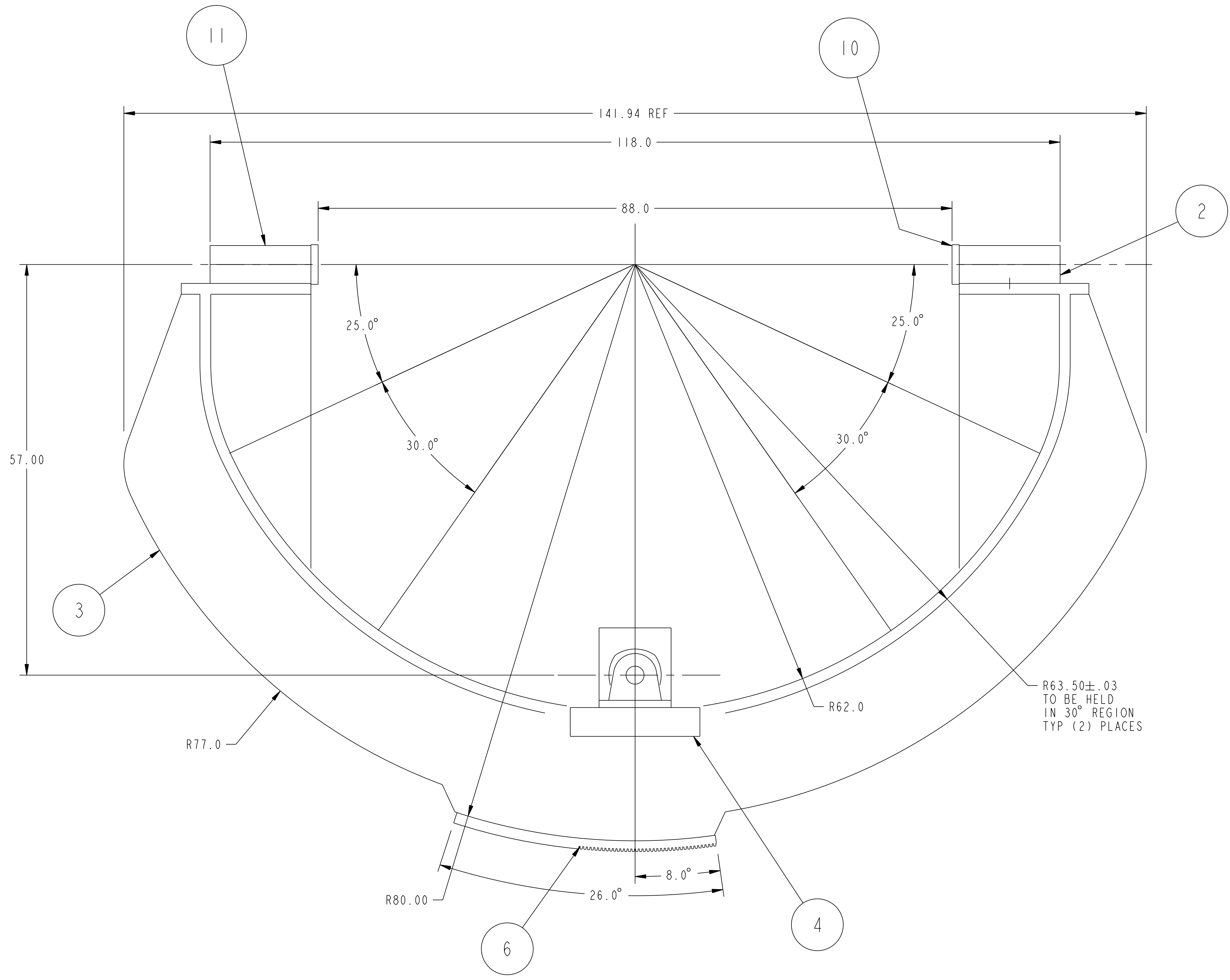
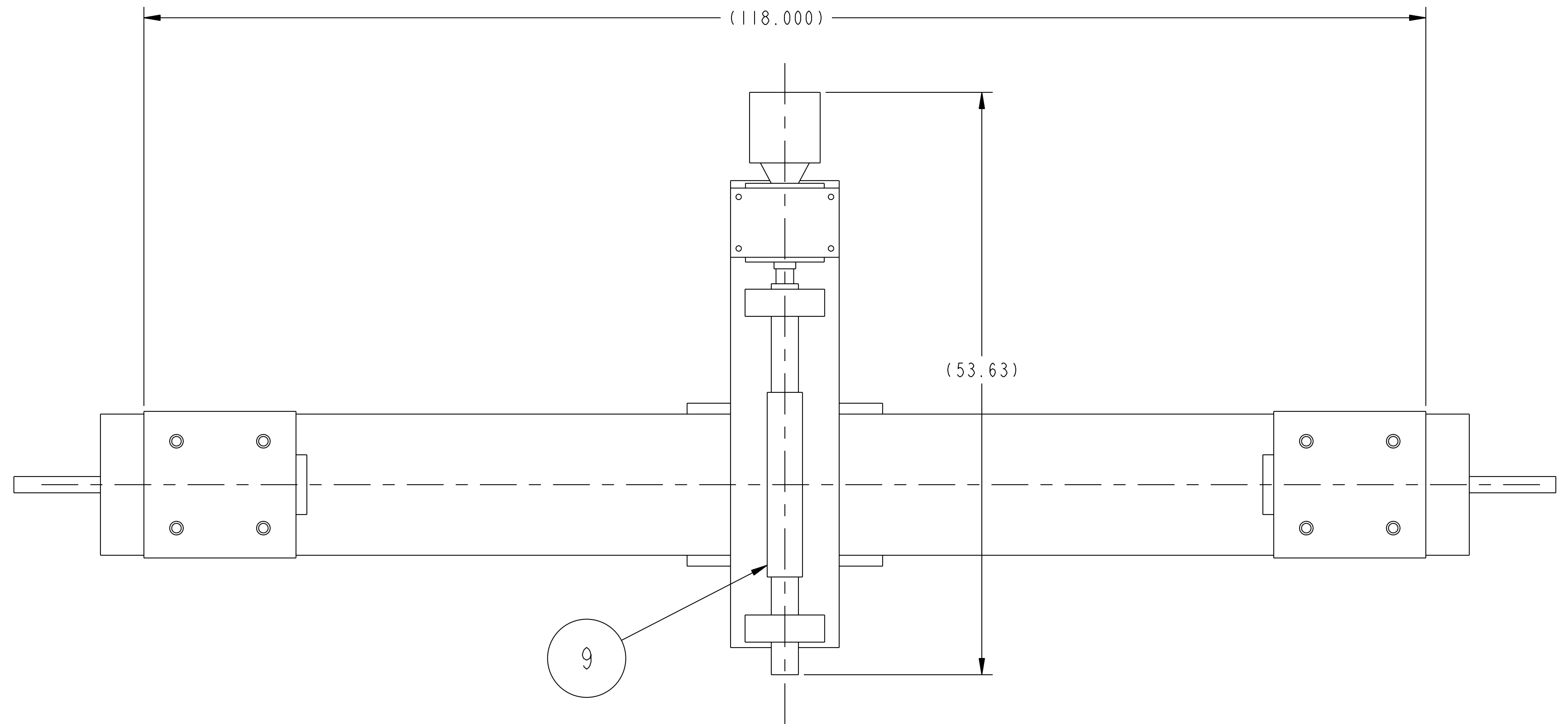

1
ASSEMBLY
 SCALE: 0.125
 1 REQ'D

PART NO.	DRAWING NO	NOMENCLATURE OR DESCRIPTION	MATERIAL	QTY	RECD
11	SE185-014B	BLOCK, PIVOT	STEEL	2	
10	SE185-065	--	--	2	
9	SE185-063	GEAR, WORM	--	1	
8	SE185-052	DRIVE AXLE SUPPORT	ASTM A36	2	
7	SE185-051	GEARMOTOR	--	1	
6	SE185-046-1	ROLLED RACK GEAR - 8 PITCH	STEEL	1	
5	SE185-032	PLATE, LOWER HORIZ	STEEL	1	
4	SE185-031	PLATE, LOWER VERT	ASTM A36	2	
3	SE185-028	PIVOT STRUCTURE	ASTM A36	1	
2	SE185-014	BLOCK, PIVOT	STEEL	2	
1	SE185-006	ASSEMBLY PIVOT AND ROTATION STRUCTURE	--	1	

COMPUTER GENERATED DRAWING		CENTRAL FILES:		PRINCETON PLASMA PHYSICS LABORATORY	
DRAWING CHANGES NOT PERMITTED		UNLESS OTHERWISE SPECIFIED		NATIONAL COMPACT STELLARATOR EXPERIMENT	
Pro E		DIMENSIONS ARE IN INCHES		FIELD PERIOD ASSEMBLY	
DO NOT VERIFY INFORMATION BY SCALING DRAWING		MACHINE SURFACES		PIVOT AND ROTATION STRUCTURE	
NEXT ASSEMBLY		TOLERANCES NON-CUMULATIVE		DSN: M. MESSINGO	
		DECIMAL-INCH FRACTIONS		CHK:	
		.XX ±.000 0°-120° ±.125		ENGR: T. BROWN	
		.XXX ±.005 120°-120° ±.125		SUPV:	
		ANGULAR ±.0°-15° OVER 120° ±.125		DRAWING NO:	
				SE185-006	
				SHEET 1 OF 1	
				REV 0	

WEIGHT
 3888.2 lbs

MODEL NAME
 SE185-006

WELDING ENGINEER

RELEASE LEVEL: WIP
 DWG VERSION NO: