

- NOTES
- DRAWING PREPARED IN ACCORDANCE WITH ASME Y14.100-2004.
  - INTERPRET DIMENSIONS AND TOLERANCES PER ASME Y14.5M-1994.
  - DIMENSIONS ARE IN INCHES
  - MAGNETIC PERMEABILITY NOT TO EXCEED 1.02 AS TESTED BY A SEVERN INDICATOR. AVAILABLE FROM:  
 SEVERN ENGINEERING  
 AUBURN, ALABAMA 36830  
 WWW.SEVERNEENGINEERING.COM
  - SHIMS TO BE ANNEALED AFTER COMPLETING ALL CUTTING AND GRINDING.

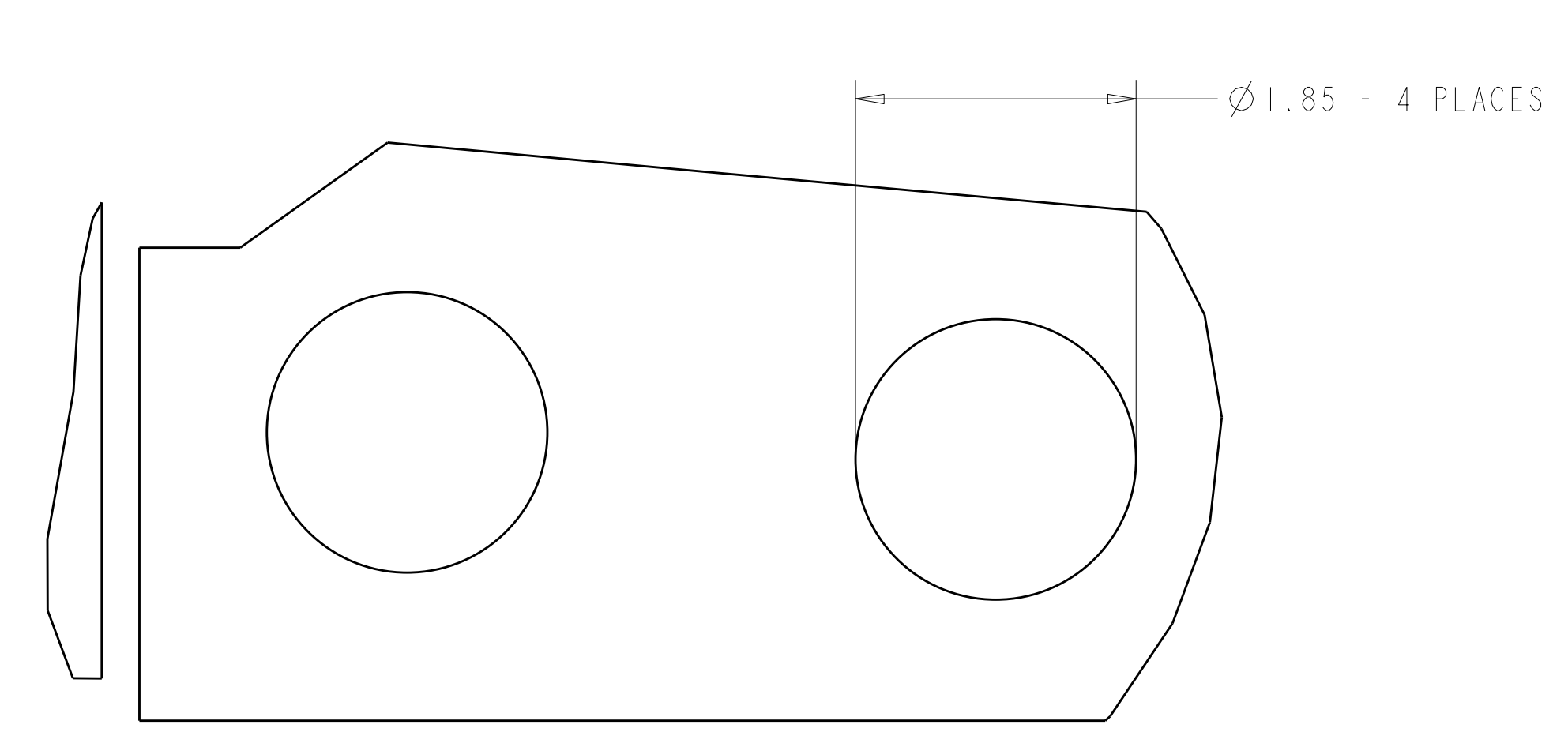

**DETAIL A**  
 SCALE 1.000

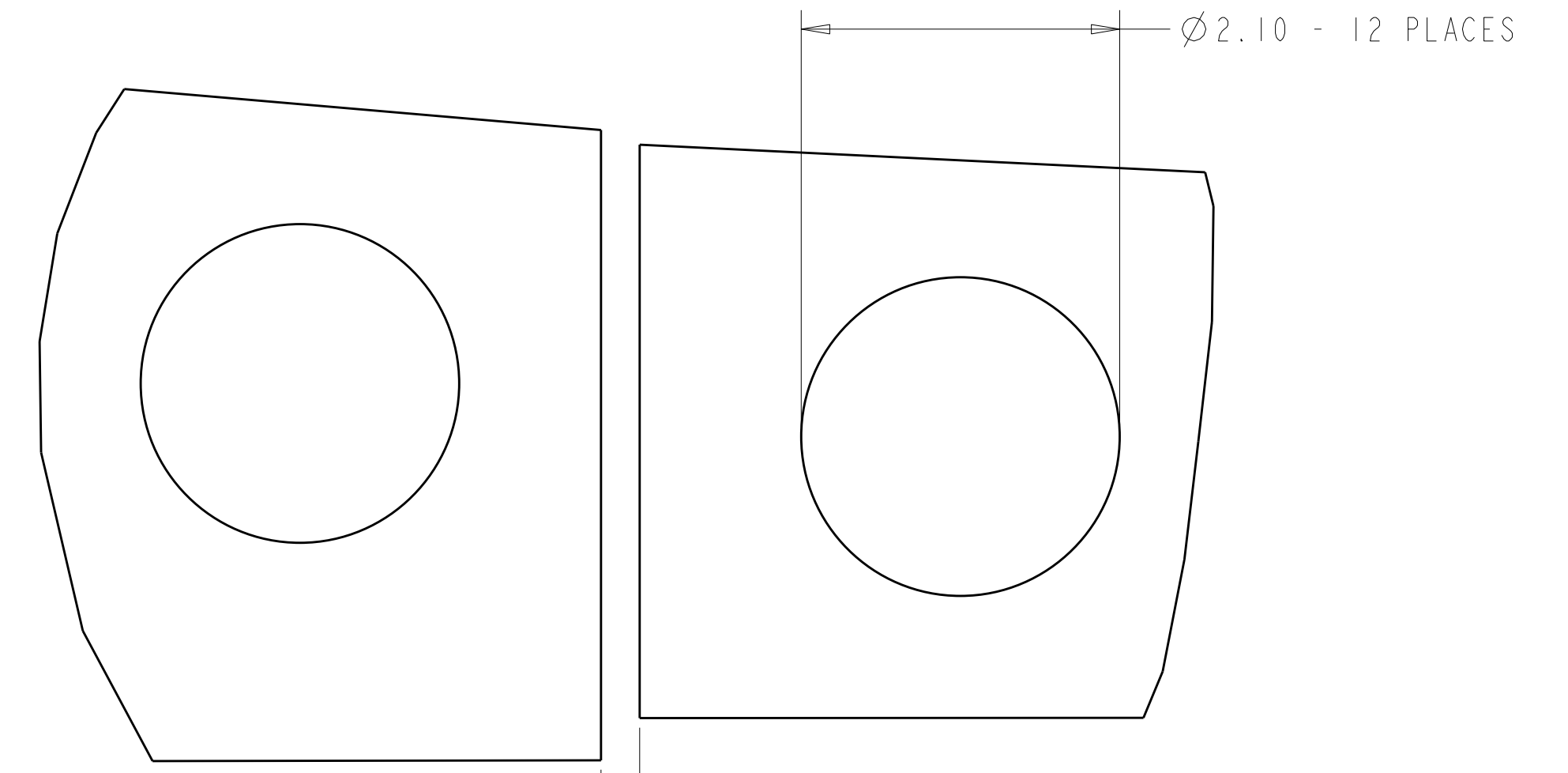

**DETAIL B**  
 SCALE 1.000

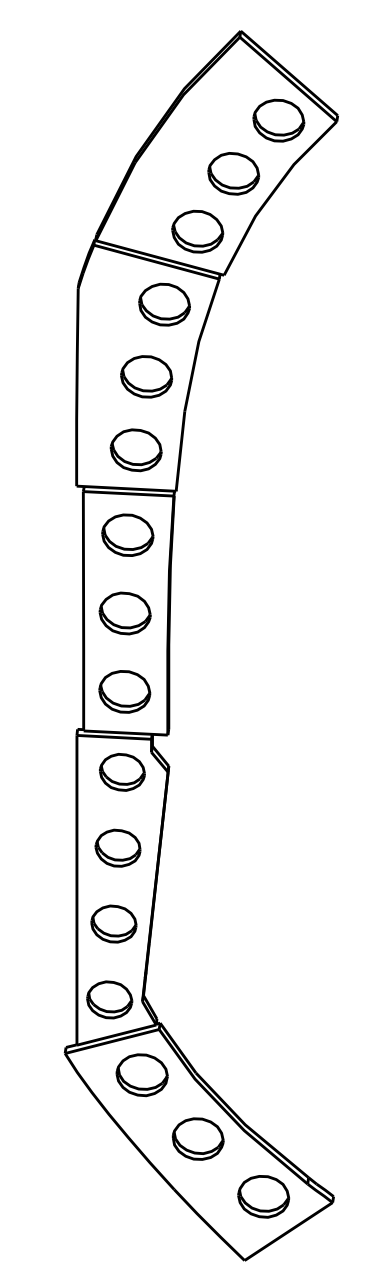

**ISOMETRIC VIEW**  
 SCALE 0.125

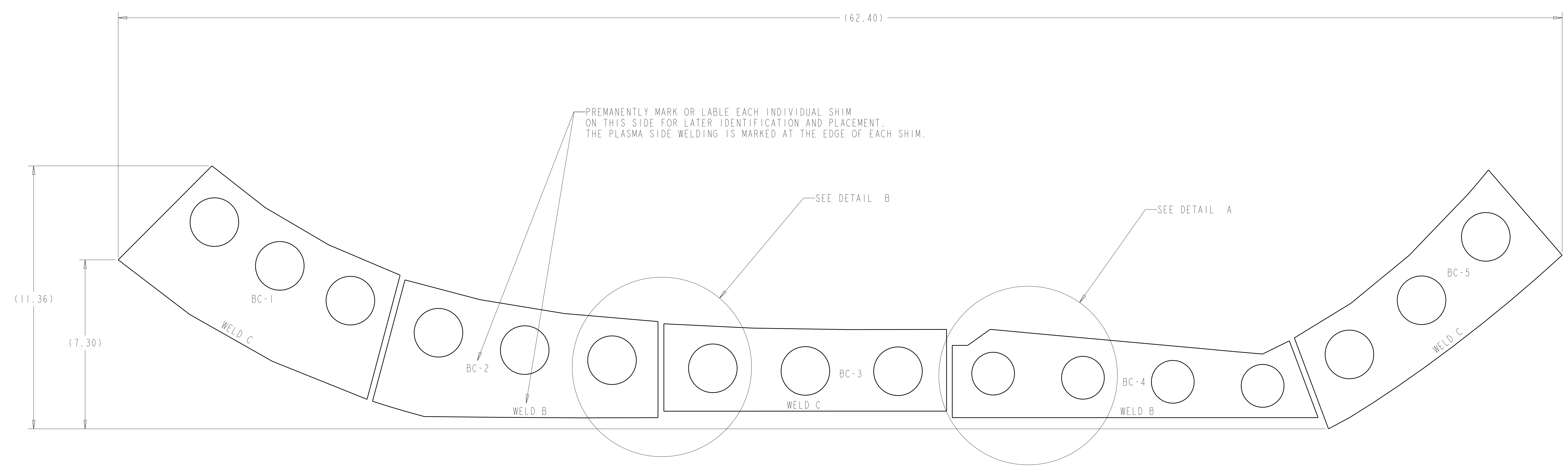

**-1 BC INBOARD SHIM**  
 SCALE 0.50

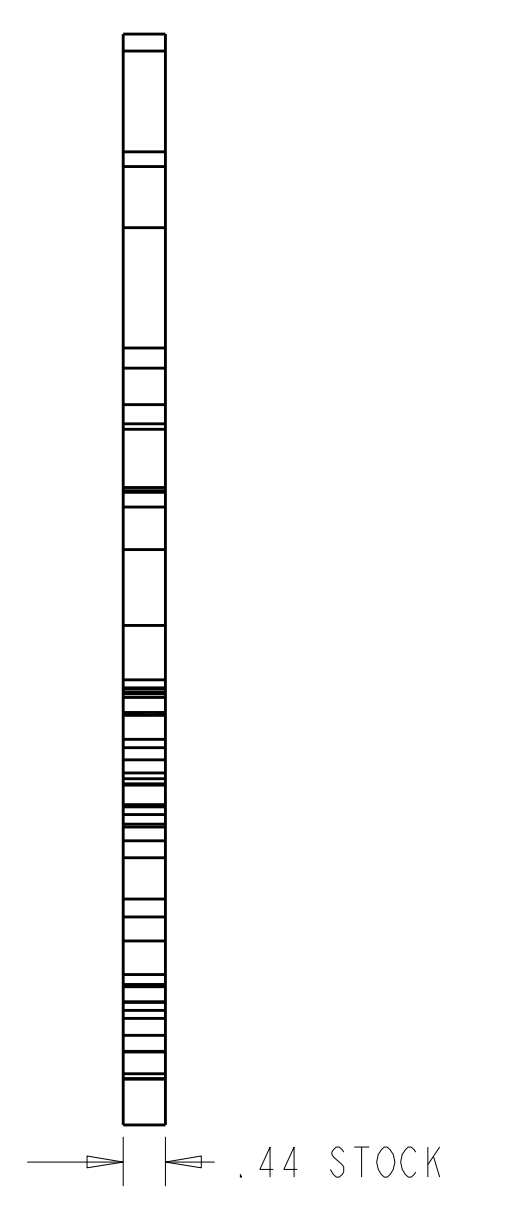

**PRELIMINARY**  
 10-25-2007

NOTE: PART TO BE CUT FROM FULL SIZE TEMPLATE, SEE SHEET 2.

AR	-1	BC INBOARD SHIM	316 SST 5	ASTM A240	I
CAGE CODE	PART OR IDENTIFYING NO	NOMENCLATURE OR DESCRIPTION	MATERIAL	SPECIFICATION	FIND NO
SEI140-003	←	NEXT ASSEMBLY	PARTS LIST		

NO REPRESENTATION OR WARRANTY, EXPRESSED OR IMPLIED, IS MADE AS TO THE ACCURACY, COMPLETENESS OR USEFULNESS OF THE INFORMATION OR STATEMENTS CONTAINED IN THESE DRAWINGS, OR THAT THE USE OR DISCLOSURE OF ANY INFORMATION, APPARATUS, METHOD OR PROCESS DISCLOSED IN THESE DRAWINGS MAY NOT INFRINGE PRIVATE RIGHTS OF OTHERS. NO LIABILITY IS ASSUMED WITH RESPECT TO THE USE OF, OR FOR DAMAGES RESULTING FROM THE USE OF, ANY INFORMATION, APPARATUS, METHOD OR PROCESS DISCLOSED IN THESE DRAWINGS. DRAWINGS MADE AVAILABLE FOR INFORMATION TO BIDDER ARE NOT TO BE USED FOR OTHER PURPOSES, AND ARE TO BE RETURNED UPON REQUEST OF THE FORWARDING CONTRACTOR.

**P** THIS DRAWING PRODUCED ON PRO-ENGINEER

REV	DESCRIPTION	SH	BY	DATE	CHK	DEPT	DATE	PE	REQ	DATE	DRNL	DOE	DATE
0	ORIGINAL ISSUE		SH	10/01	MC		01/01						
	REVISION OR ISSUE PURPOSE												

SCALE NOTED	DES: D WILLIAMSON 10/2007
TOLERANCES UNLESS OTHERWISE SPECIFIED	DRW: S HOMESCU 10/2007
FRACTIONS	CHK: M COLE 10/2007
XX DECIMALS ±.01	SECT: : :
XXX DECIMALS ±.005	DEPT: : :
ANGLES ±0°15'	PE: : :
BREAK SHARP EDGES .06 MAX	CR: : :
FINISH .125 UNLESS OTHERWISE SPECIFIED	PJ: : :
	RED: : :
	PPPL DRFT J SIEGEL 10/2007
	VERSION NO. 7+
	PLANT ORNL
	BLDG 5700
	FL 3
	SHT OF 1
	TYPE 2
	CLASS S
	REV U
	WIP
	SEI140-053
	REV 0

Oak Ridge National Laboratory managed for the DEPARTMENT OF ENERGY under U.S. GOVERNMENT contract DE-AC05-00OR22725 UT-BATTELLE, LLC. Oak Ridge, Tennessee  
**UT-BATTELLE**  
 NATIONAL COMPACT STELLARATOR EXPERIMENT  
**B-C INBOARD SHIM**

H  
G  
F  
E  
D  
C  
B  
A

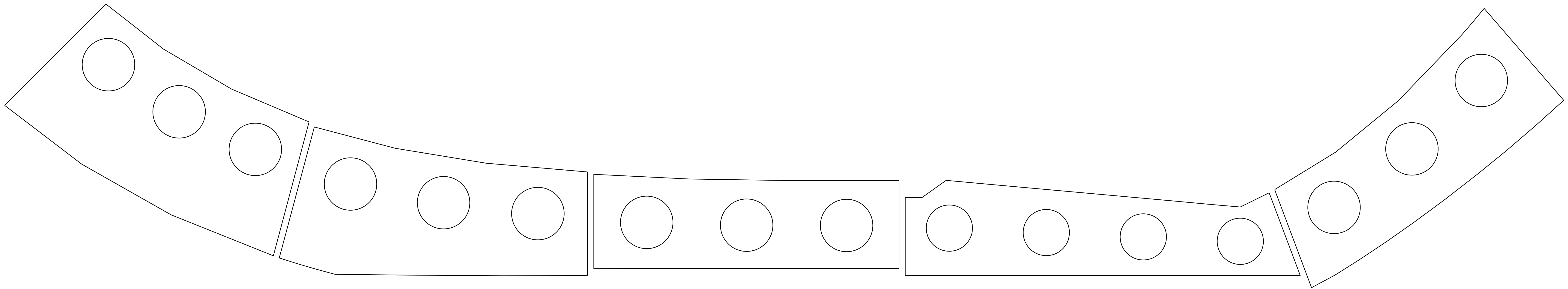

FULL SIZE TEMPLATE - SHOWN WITH INDIVIDUAL SHIM CUT LINES  
SCALE 1 : 1

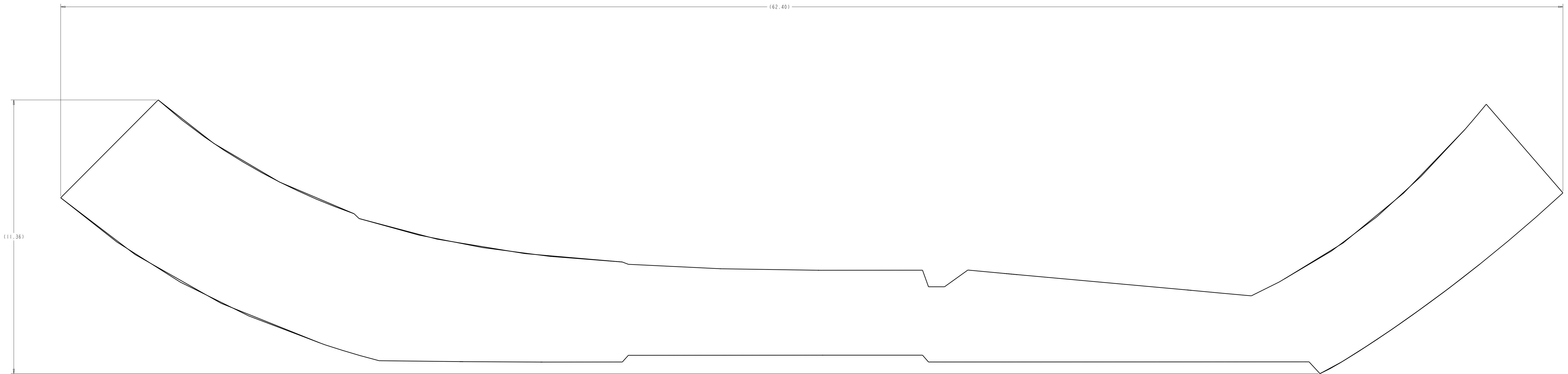

FULL SIZE TEMPLATE - CHECK REF DIMS SHOWN FOR PROPER SCALE  
SCALE 1 : 1