

NO.	REVISION	BY	CH	SUP	APPROVED	DATE

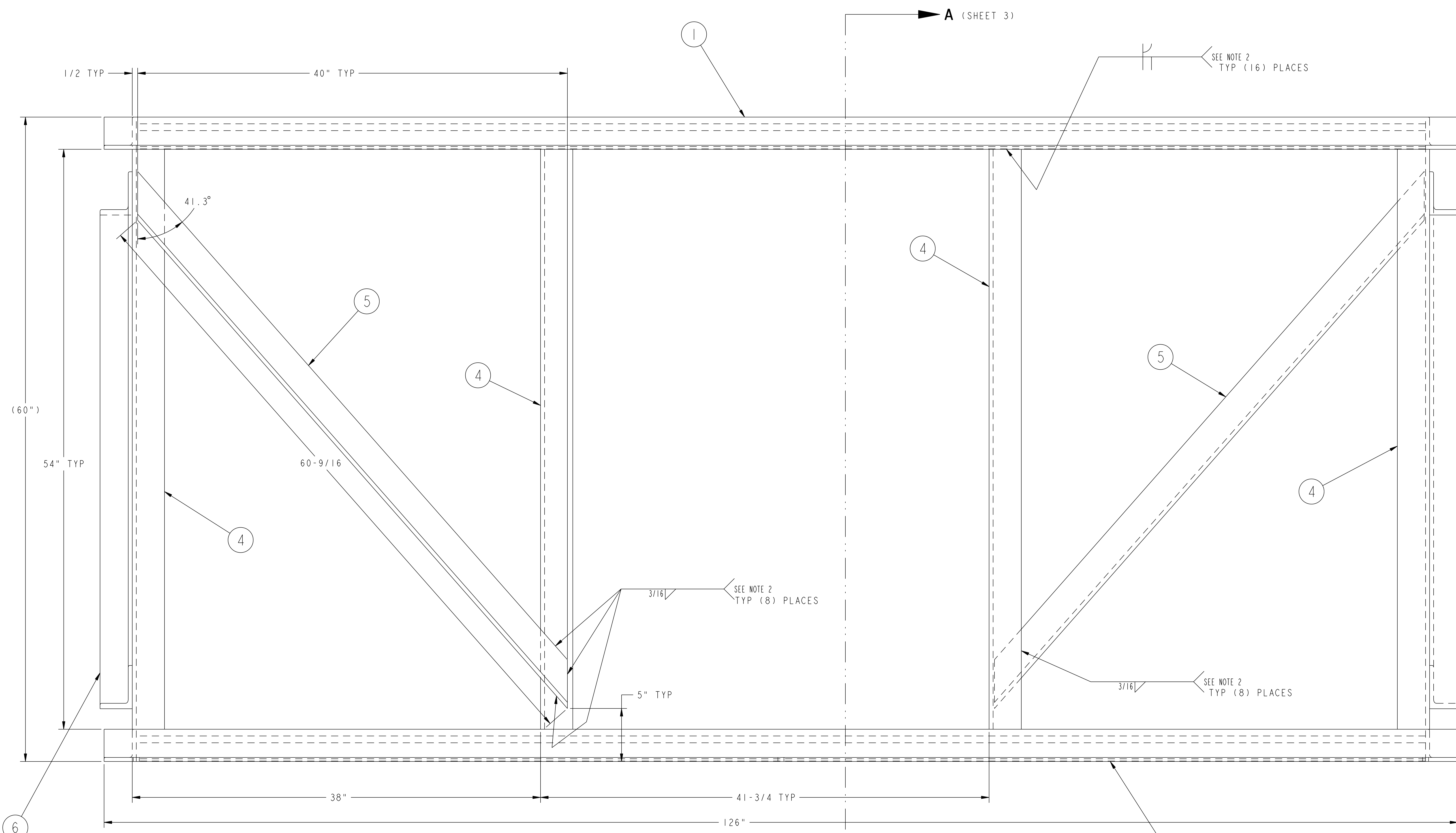

FRONT VIEW

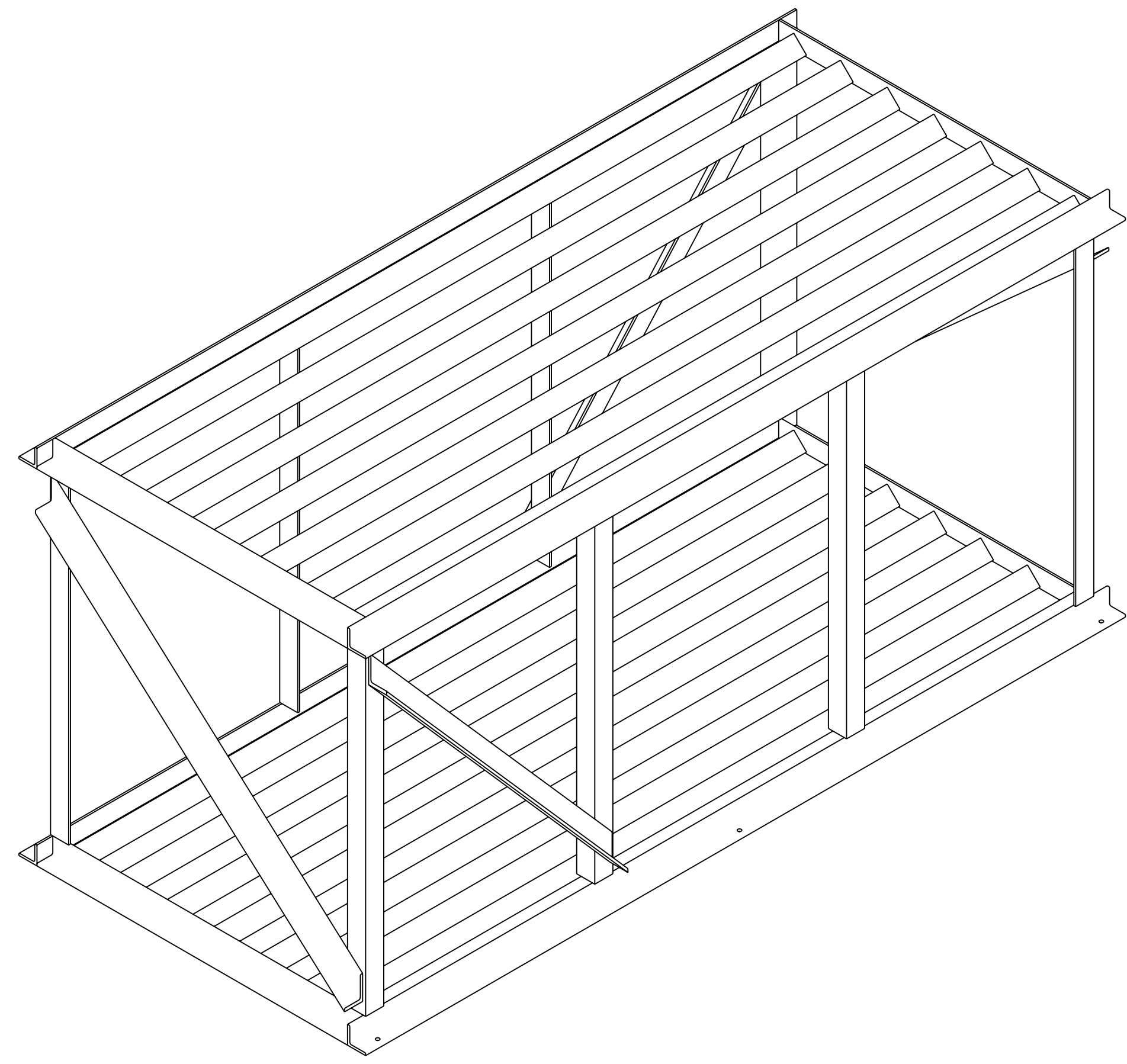

REFERENCE ISOMETRIC VIEW

NOTES

- ALL PARTS TO BE MADE FROM 3" x 3" x 3/8" STRUCTURAL ANGLE.
- WELDING SHALL BE PERFORMED IN ACCORDANCE WITH THE REQUIREMENTS OF PPPL PROCEDURE ENG-037. VISUAL WELD INSPECTION SHALL BE PERFORMED IN ACCORDANCE WITH THE ACCEPTANCE CRITERIA OF AWS D1.1.

RELEASED FOR FABRICATION / INSTALLATION
PPPL Drafting:

PART NO.	DRAWING NO.	NOMENCLATURE OR DESCRIPTION	MATERIAL	QTY REQD
2	6	THIS DWG	BRACE ANGLE - TYPE 2	ASTM A36
2	5	THIS DWG	BRACE ANGLE - TYPE 1	ASTM A36
8	4	THIS DWG	UPRIGHT ANGLE	ASTM A36
14	3	THIS DWG	STRINGER ANGLE	ASTM A36
4	2	THIS DWG	BASE ANGLE - SHORT	ASTM A36
4	1	THIS DWG	BASE ANGLE - LONG	ASTM A36
01	—	THIS DWG	SUPPORT FRAME WELDMENT	—

01	PART ASSY	PART NO.	DRAWING NO.	NOMENCLATURE OR DESCRIPTION	MATERIAL	QTY REQD
PARTS LIST						

COMPUTER GENERATED DRAWING CHANGES NOT PERMITTED	CENTRAL FILES: UNLESS OTHERWISE SPECIFIED	PRINCETON PLASMA PHYSICS LABORATORY			
DO NOT VERIFY INFORMATION BY SCALING DRAWING	BREAK SHARP EDGES .005/.020	NATIONAL COMPACT STELLARATOR EXPERIMENT			
WEIGHT	1890.4 lbs	MODULAR COIL ASSEMBLY			
MODEL NAME	SE144-410-01	SUPPORT FRAME WELDMENT			
WELDING ENGINEER	G. GETTELFINGER 4-20-07	TOLERANCES NON-CUMULATIVE	DSN: L. MORRIS 4-20-07	DRAWING NO:	SE144-410
		DECIMAL-INCH FRACTIONS	CHK: T. BROWN 4-20-07		
		.XX +/- .030	ENGR: M. VIOLA 4-20-07		
		.XXX +/- .005	SUPV: J. SIEGEL 4-20-07	SHEET 1 OF 3	REV 0.1
		ANGULAR +/- .15°			

RELEASE LEVEL: Fabrication
DWG VERSION NO: 0

NCSX-SE144-410

K

NO.	REVISION	BY	CH	SUP	APPROVED	DATE

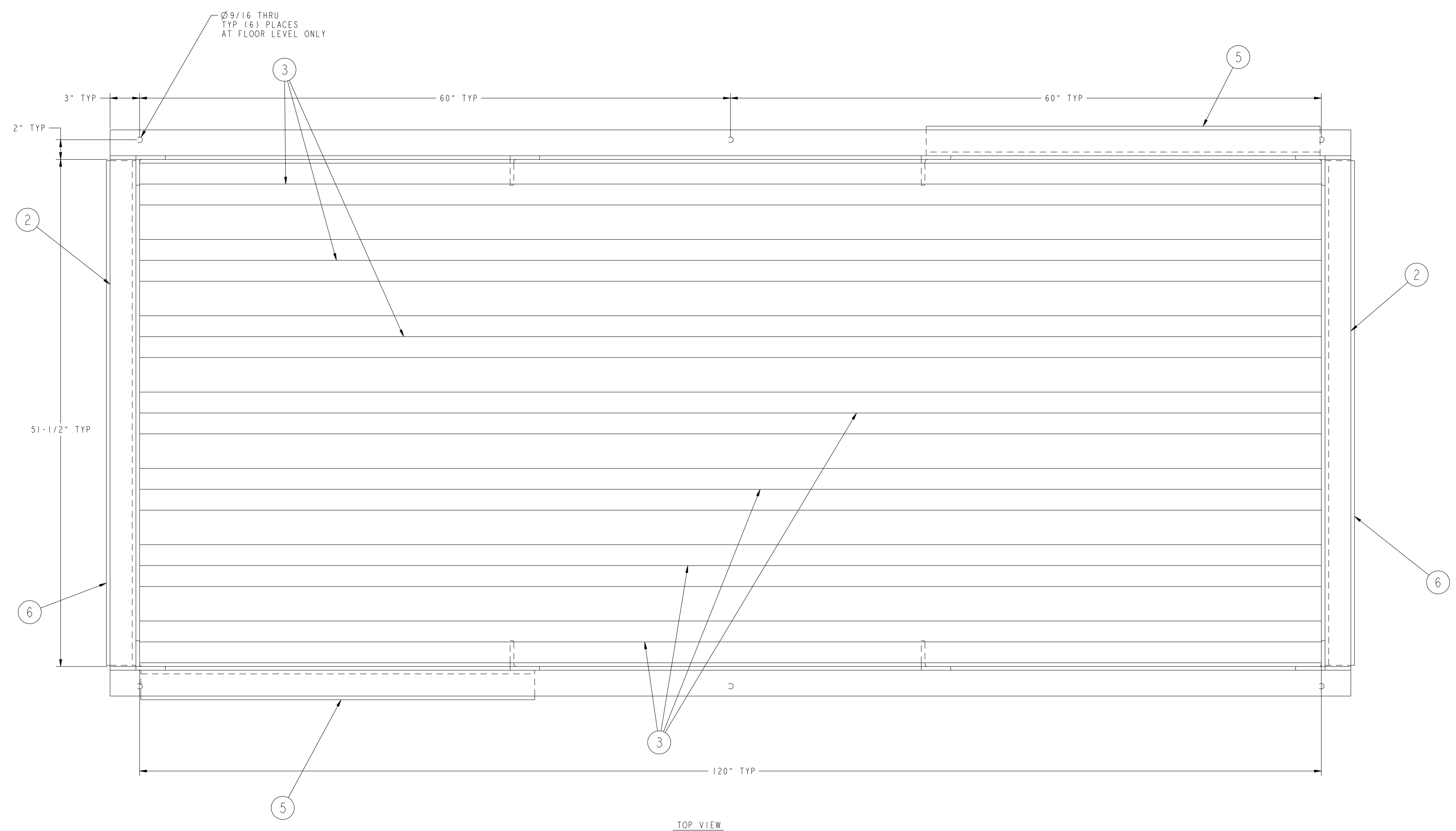

**RELEASED FOR
FABRICATION / INSTALLATION**
PPPL Drafting:

FOR NOTES AND BILL OF MATERIAL SEE SHEET 1

RELEASE LEVEL: Fabrication
DWG VERSION NO: 0

WEIGHT	1890.4 lbs
MODEL NAME	SE144-410-01
WELDING ENGINEER	

COMPUTER GENERATED DRAWING MANUAL CHANGES NOT PERMITTED Pro E	CENTRAL FILES: UNLESS OTHERWISE SPECIFIED DIMENSIONS ARE IN INCHES MACHINE SURFACES BREAK SHARP EDGES .005/.020	PRINCETON PLASMA PHYSICS LABORATORY PRINCETON UNIVERSITY NATIONAL COMPACT STELLARATOR EXPERIMENT MODULAR COIL ASSEMBLY SUPPORT FRAME WELDMENT	
DO NOT VERIFY INFORMATION BY SCALING DRAWING	TOLERANCES NON-CUMULATIVE DECIMAL-INCH FRACTIONS .XX ±.000 0°-120° ±.1/16 .XXX ±.005 120°-120° ±.1/16 ANGULAR ±.0°-15° OVER 120° ±.1/16	DSN: L. MORRIS 4-20-07	DRAWING NO: SE144-410
NEXT ASSEMBLY	ENGR: M. VIOLA 4-20-07	SUPV: J. SIEGEL 4-20-07	SHEET 2 OF 3 REV 0.1

NCSX-SE144-410

NO.	REVISION	BY	CH	SUP	APPROVED	DATE

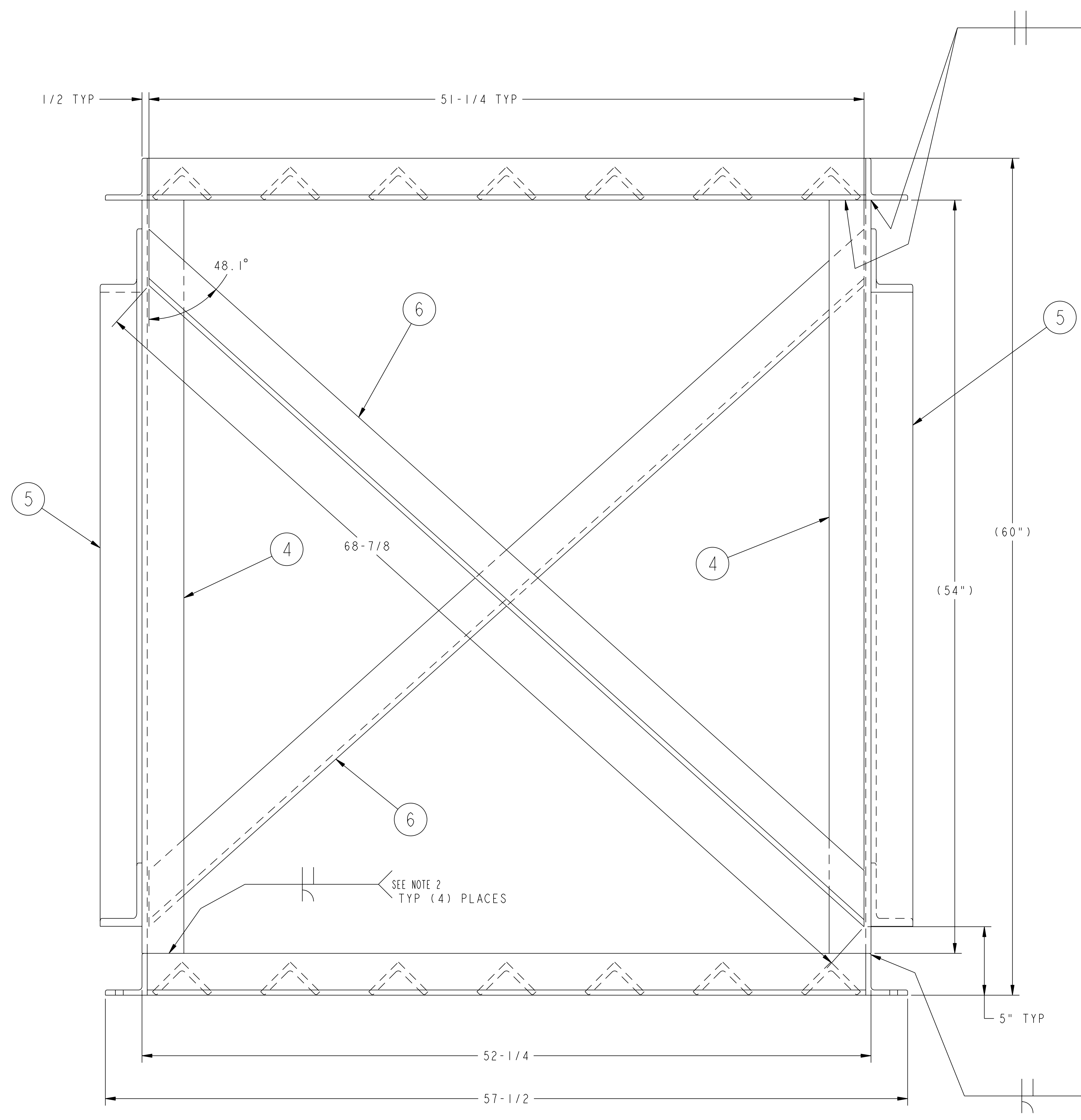

SIDE VIEW

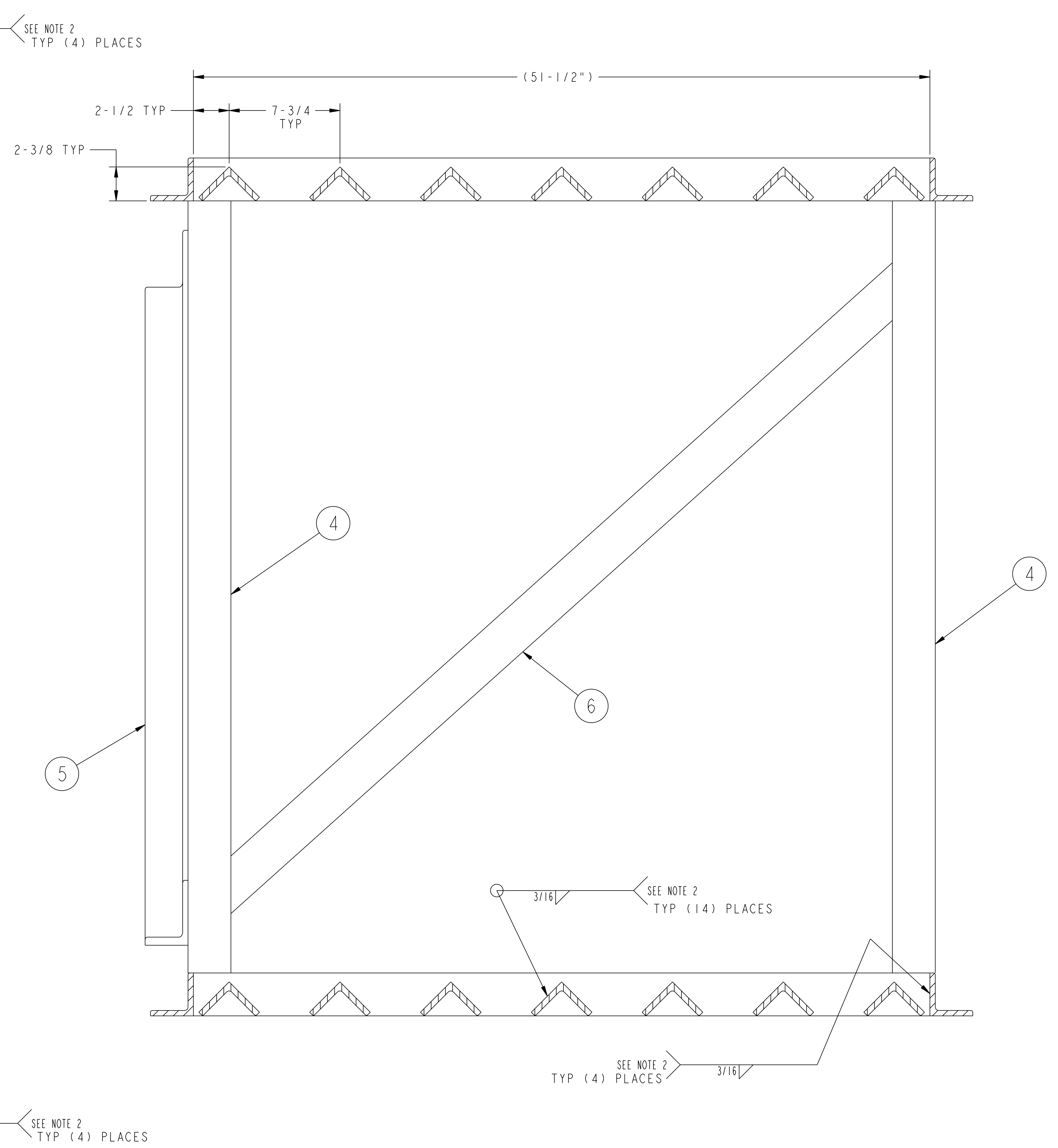

SECTION A-A

**RELEASED FOR
FABRICATION / INSTALLATION**
PPPL Drafting:

FOR NOTES AND BILL OF MATERIAL SEE SHEET 1

RELEASE LEVEL: Fabrication
DWG VERSION NO: 0

COMPUTER GENERATED DRAWING MANUAL CHANGES NOT PERMITTED Pro E	CENTRAL FILES:	PRINCETON PLASMA PHYSICS LABORATORY PRINCETON UNIVERSITY	
	UNLESS OTHERWISE SPECIFIED	NATIONAL COMPACT STELLARATOR EXPERIMENT	
DO NOT VERIFY INFORMATION BY SCALING DRAWING	DIMENSIONS ARE IN INCHES MACHINE SURFACES	MODULAR COIL ASSEMBLY	
NEXT ASSEMBLY	BREAK SHARP EDGES .005/.020	SUPPORT FRAME WELDMENT	
WEIGHT 1890.4 lbs	TOLERANCES NON-CUMULATIVE	DSN: L. MORRIS	4-20-07 DRAWING NO:
MODEL NAME SEI44-410-01	DECIMAL-INCH FRACTIONS	CHK: T. BROWN	4-20-07
WELDING ENGINEER	.XX +/- .000 0°-12° +/- .010 .XXX +/- .005 12°-120° +/- .100 ANGULAR +/- .0°-15° OVER 120° +/- .100	ENGR: M. VIOLA	4-20-07
		SUPV: J. SIEGEL	4-20-07

SEI44-410
SHEET 3 OF 3
REV 0.1

NCSX-SEI44-410