

FINAL ASS'

1. DRAWING PREPARED IN ACCORDANCE WITH ASME Y14.100-2004.
2. INTERPRET DIMENSIONS AND TOLERANCES PER ASME Y14.5M-1994.
3. DIMENSIONS ARE IN INCHES.

Technical drawing of a tapered shaft. The drawing shows a shaft with a tapered section. The taper is indicated by a dimension line with the value $1:50$ and the text "STK". The angle of the taper is labeled as 80.6° . The total length of the shaft is dimensioned as (7.70) .

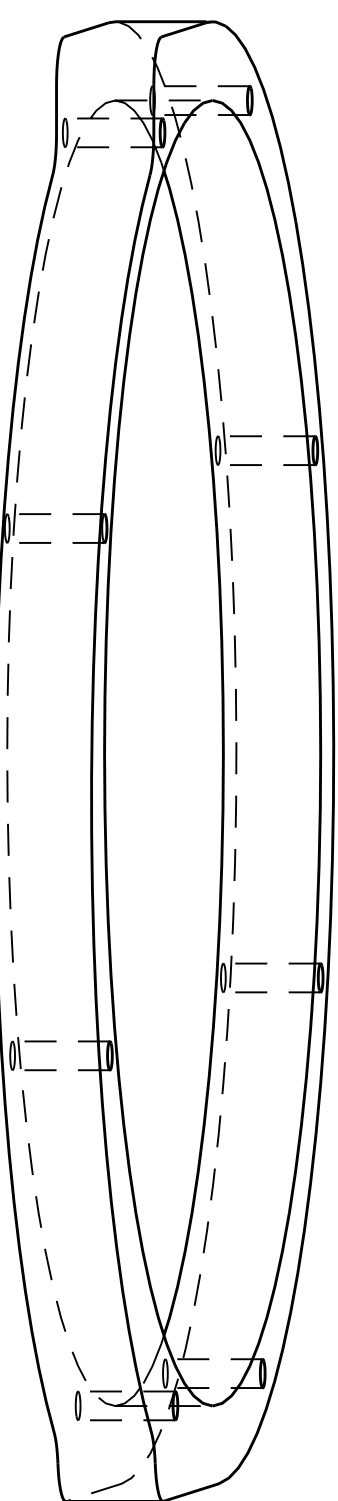
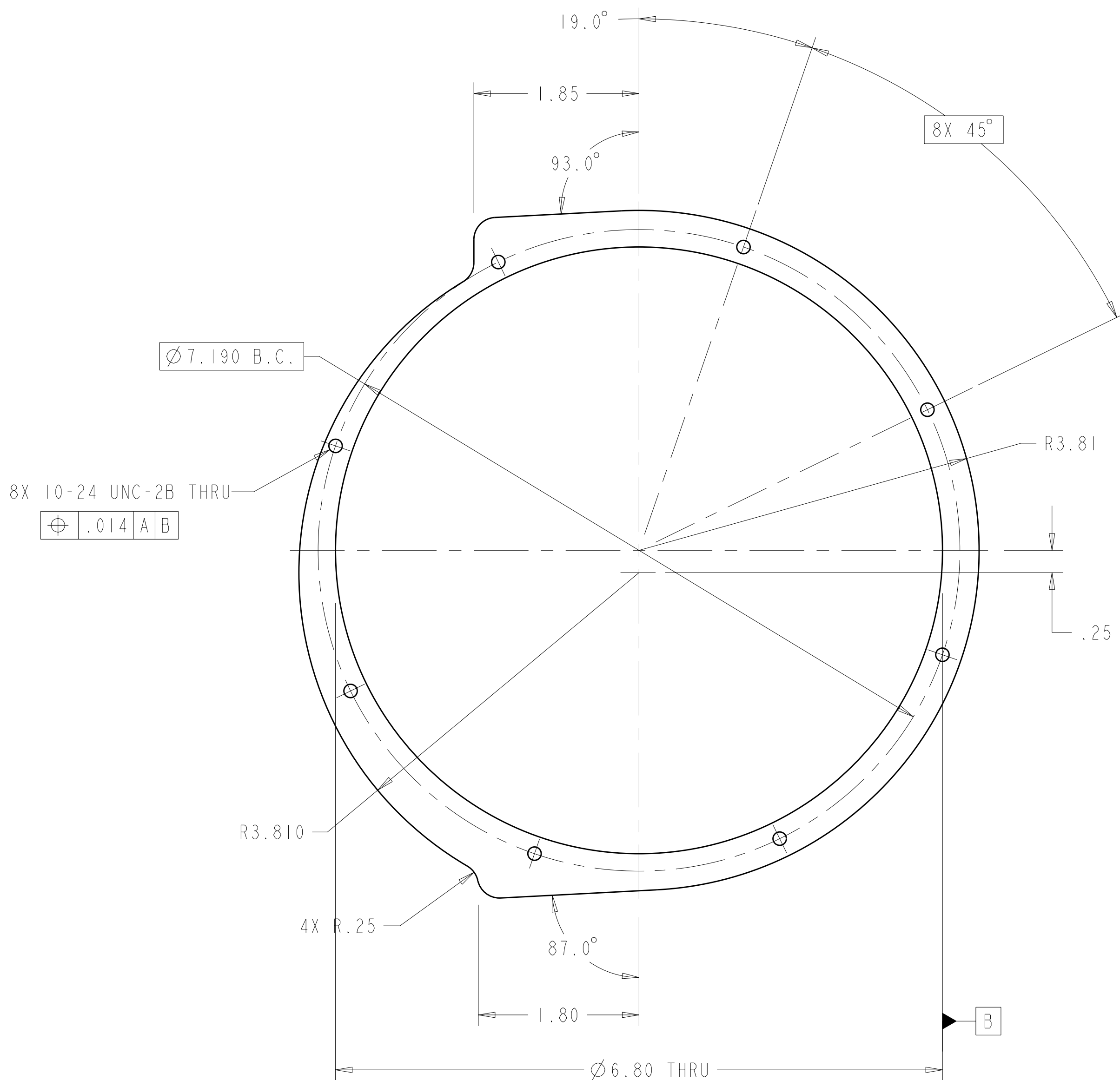
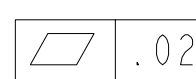
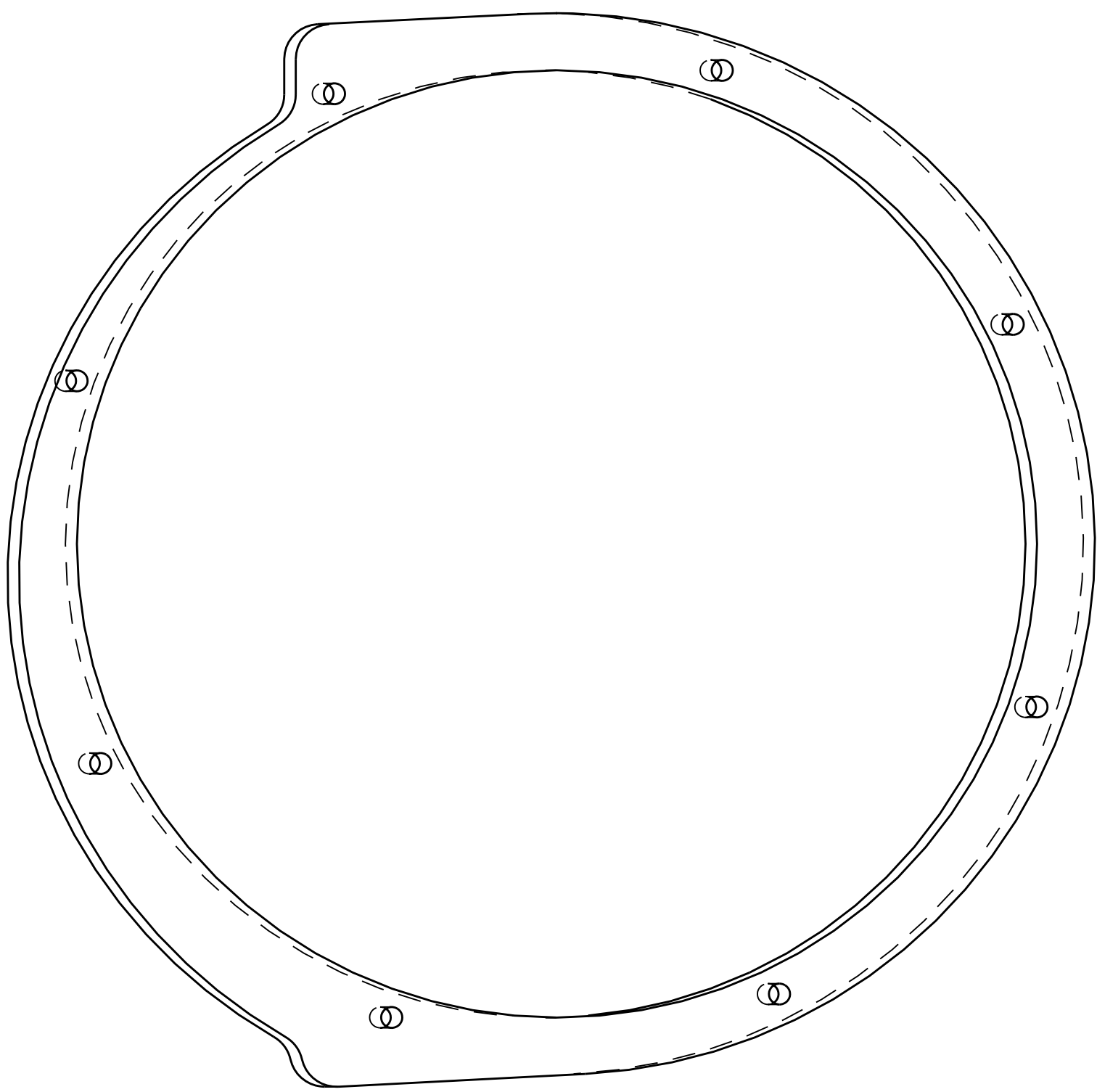
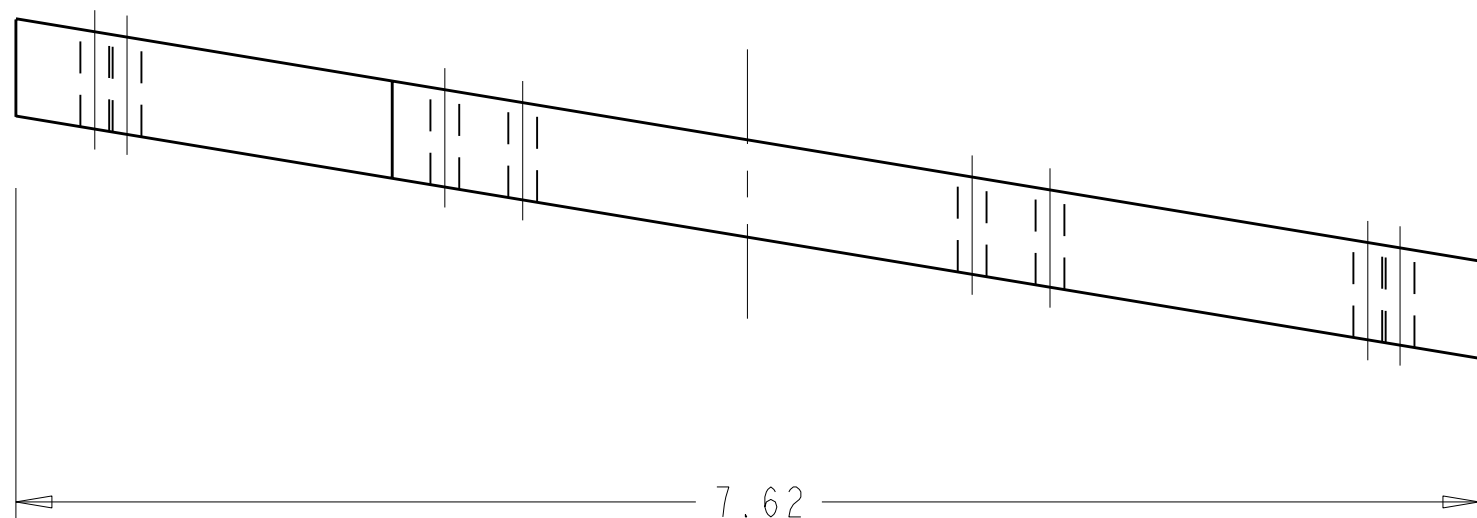

INSTALLED ORIENTATION

-1 PORT 2 WINDING FORM SEAL INNER PLATE 4

SCALE 1.000

4	AR	- I	PORT 2 WINDING FORM SEAL INNER PLATE	GAROLITE	G-11	I
SE122-340-1	CAGE CODE	PART OR IDENTIFYING NO	NOMENCLATURE OR DESCRIPTION	MATERIAL	SPECIFICATION	FIND NO
 NEXT ASSEMBLY			PARTS LIST			

[illegible]

NO REPRESENTATION OR WARRANTY, EXPRESSED OR IMPLIED, IS MADE AS TO THE ACCURACY, COMPLETENESS OR USEFULNESS OF THE INFORMATION OR STATEMENTS CONTAINED IN THESE DRAWINGS, OR THAT THE USE OR DISCLOSURE OF ANY INFORMATION, APPARATUS, METHOD OR PROCESS DISCLOSED IN THESE DRAWINGS WILL NOT INFRINGE PRIVATE RIGHTS OF OTHERS. NO LIABILITY IS ASSUMED WITH RESPECT TO THE USE OF, OR FOR DAMAGES RESULTING FROM THE USE OF, ANY INFORMATION, APPARATUS, METHOD OR PROCESS DISCLOSED IN THESE DRAWINGS. DRAWINGS MADE AVAILABLE FOR INFORMATION TO OTHERS ARE NOT TO BE USED FOR ANY OTHER PURPOSES, AND ARE TO BE RETURNED UPON REQUEST OF THE FORWARDING CONTRACTOR.

P THIS DRAWING PRODUCED
ON PRO-ENGINEER