

NO.	REVISION	BY	CH	SUP	APPROVED	DATE

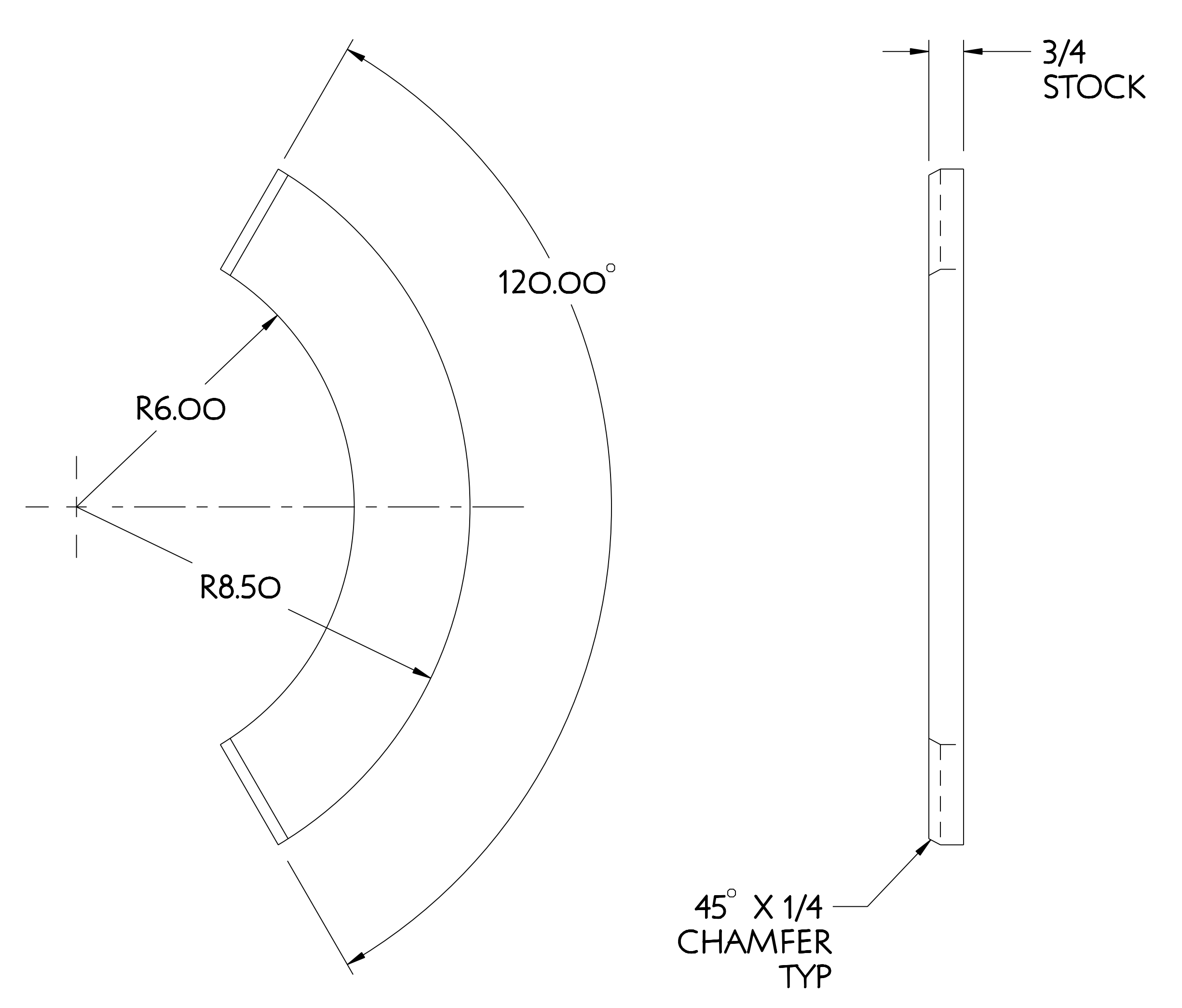

1 TOP SUPPORT PLATE
SCALE 0.500

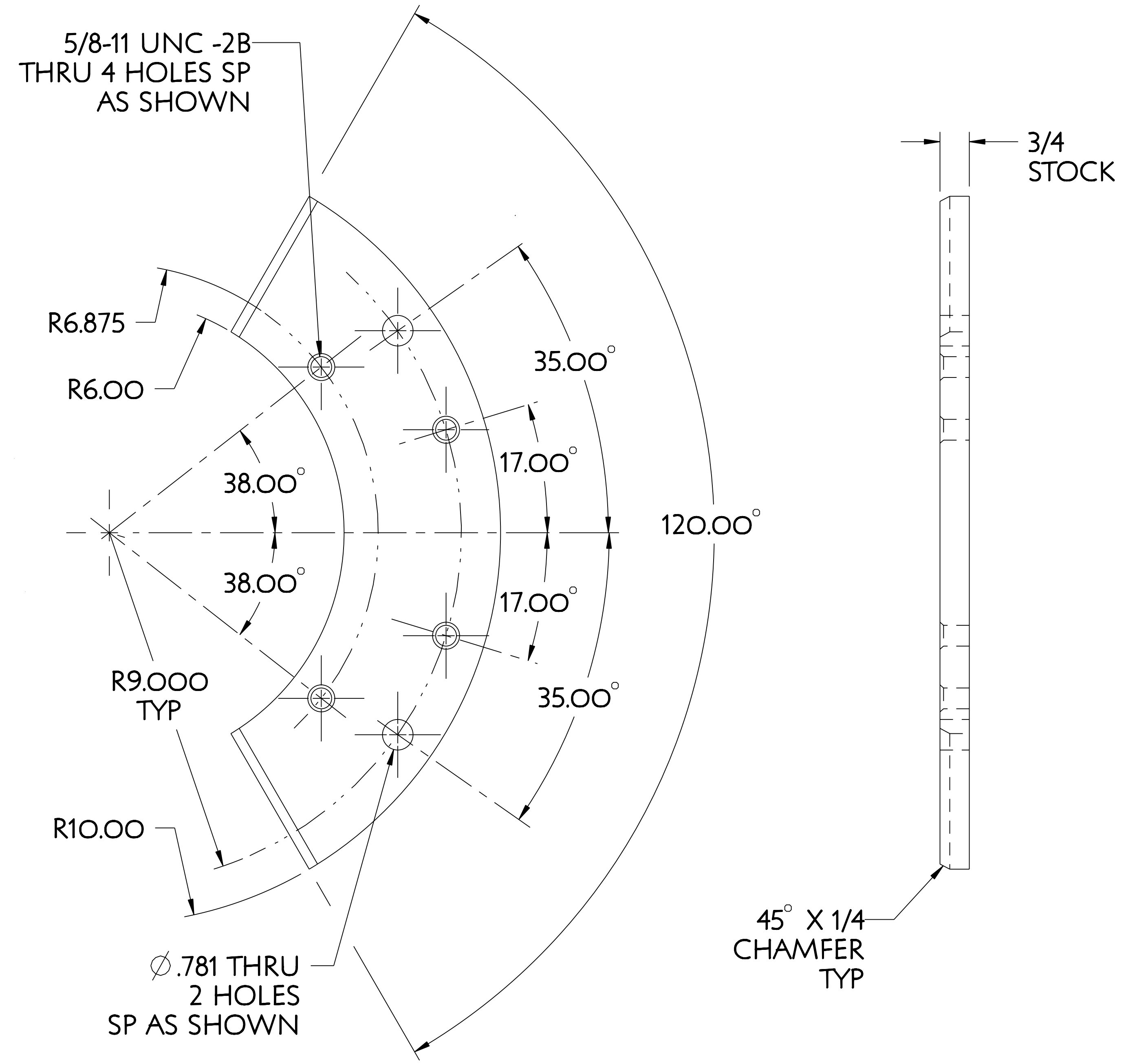

2 BOTTOM SUPPORT PLATE
SCALE 0.500

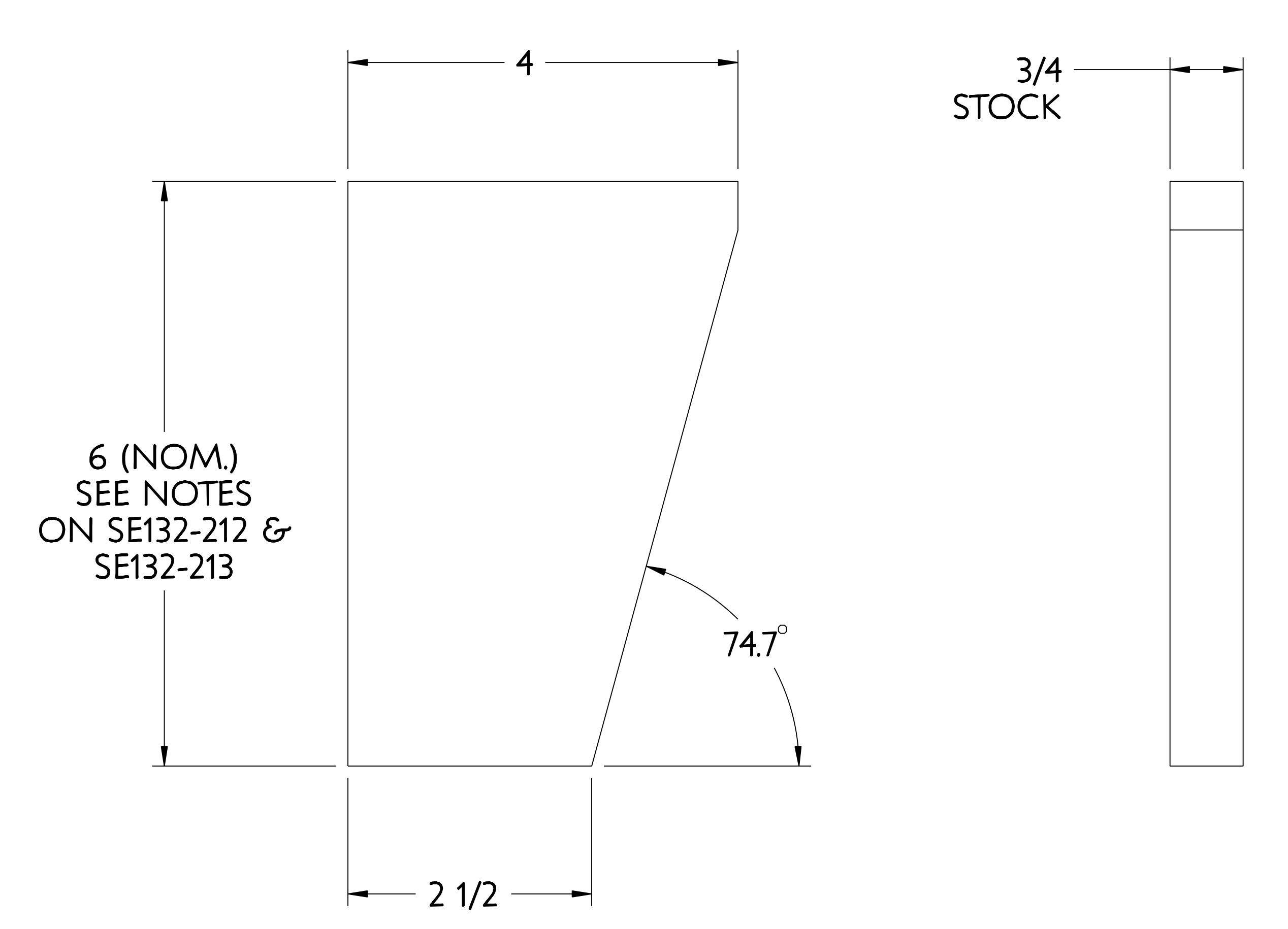

3 GUSSET PLATE

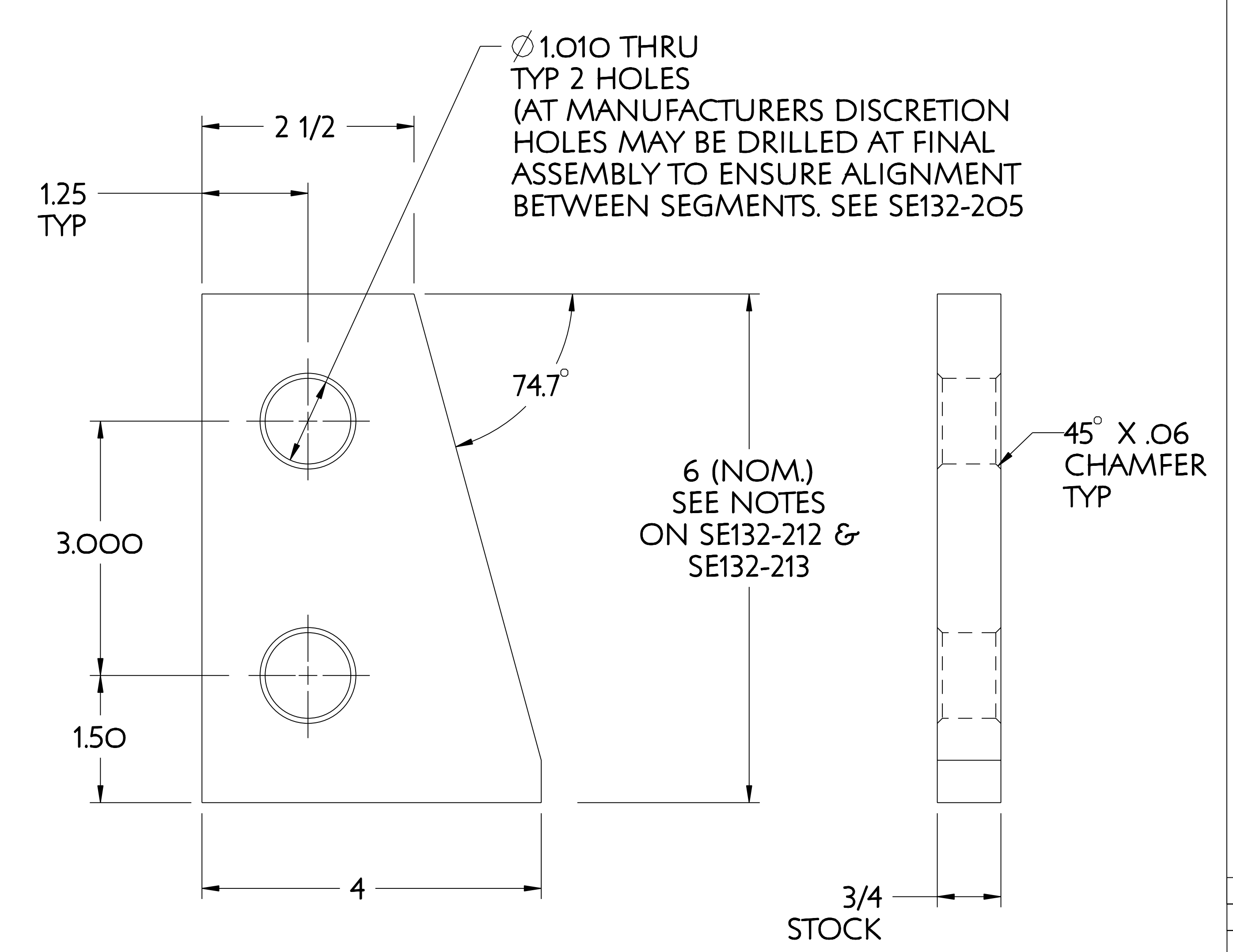

4 END SUPPORT GUSSET

6 (NOM.)
SEE NOTES
ON SE132-212 &
SE132-213

Ø1.010 THRU
TYP 2 HOLES
(AT MANUFACTURERS DISCRETION
HOLES MAY BE DRILLED AT FINAL
ASSEMBLY TO ENSURE ALIGNMENT
BETWEEN SEGMENTS. SEE SE132-205

6 (NOM.)
SEE NOTES
ON SE132-212 &
SE132-213

45° X .06
CHAMFER
TYP

PART NO.	DRAWING NO	NOMENCLATURE OR DESCRIPTION	MATERIAL	QTY	REOD
4	SE132-240-4	CENTER SOLENOID END SUPPORT GUSSET PLATE WITH HOLES	304 STN STL		
3	SE132-240-3	CENTER SOLENOID CENTER SUPPORT GUSSET PLATE	304 STN STL		
2	SE132-240-2	CENTER SOLENOID END SUPPORT PLATE 2	304 STN STL		
1	SE132-240-1	CENTER SOLENOID END SUPPORT PLATE 1	304 STN STL		

PARTS LIST

COMPUTER GENERATED DRAWING MANUAL CHANGES NOT PERMITTED	CENTRAL FILES: UNLESS OTHERWISE SPECIFIED	PRINCETON PLASMA PHYSICS LABORATORY PRINCETON UNIVERSITY NATIONAL COMPACT STELLARATOR EXPERIMENT	
Pro E	DIMENSIONS ARE IN INCHES MACHINE SURFACES	STELLARATOR CORE CONVENTIONAL COILS CENTER SOLENOID END SUPPORT DETAILS	
DO NOT VERIFY INFORMATION BY SCALING DRAWING	BREAK SHARP EDGES .005/.020	TOLERANCES NON-CUMULATIVE	DSN: J. RUSHINSKI
		DECIMAL-INCH FRACTIONS	CHK: ENGR: F. DAHLGREN
		.XX +/- .000	
		.XXX +/- .005	
		ANGULAR +/- 0°15'	
			DRAWING NO: SE132-240
			SHEET 1 OF 1 REV 0

RELEASE LEVEL: WIP
DWG VERSION NO: 6

WEIGHT
8.1 lbs
MODEL NAME
SE132-240-4
WELDING ENGINEER

NCSX-SE132-240