

Leads Assembly Sequence

Step - 1

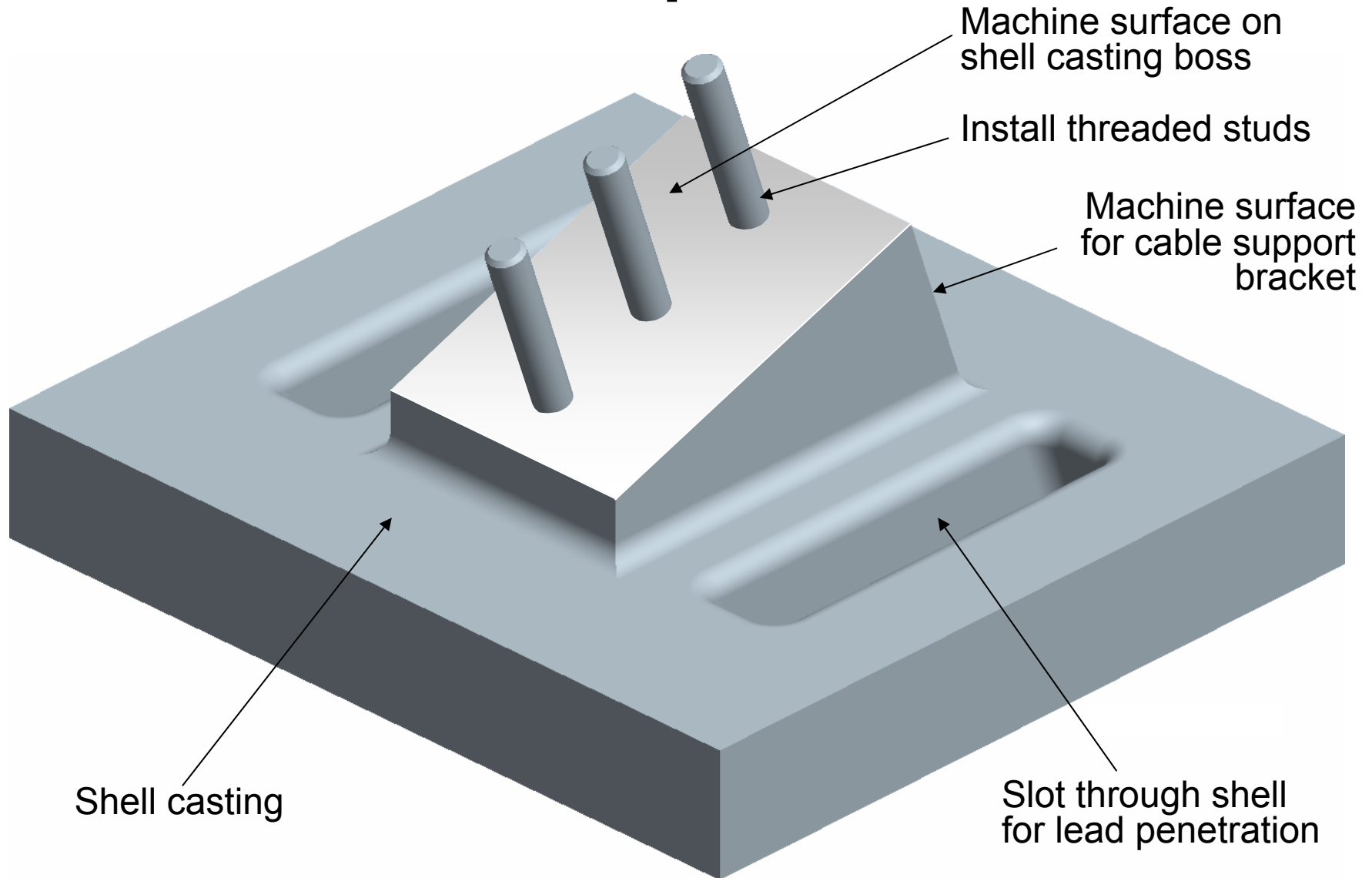

Step - 2

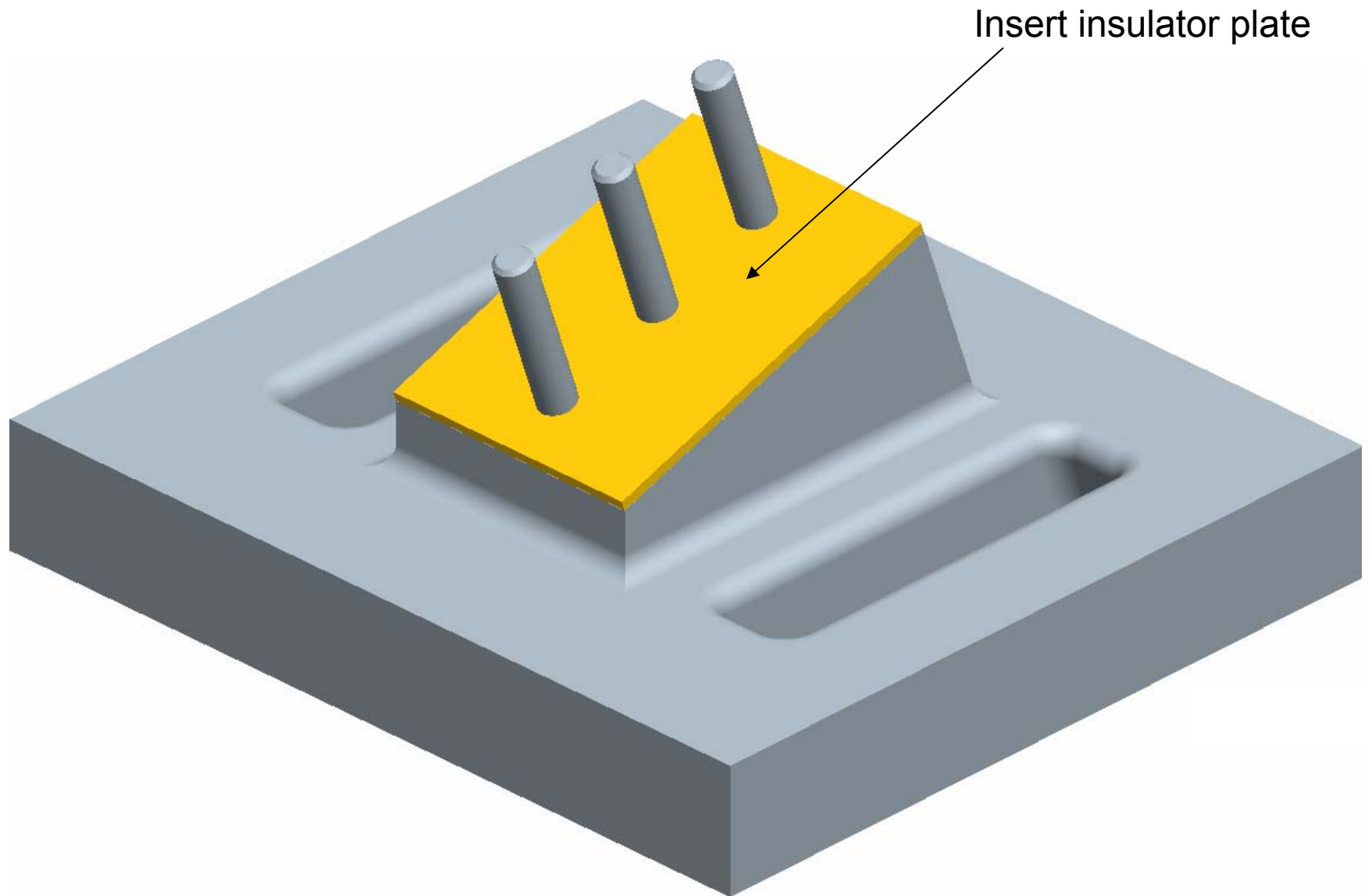

Step - 3

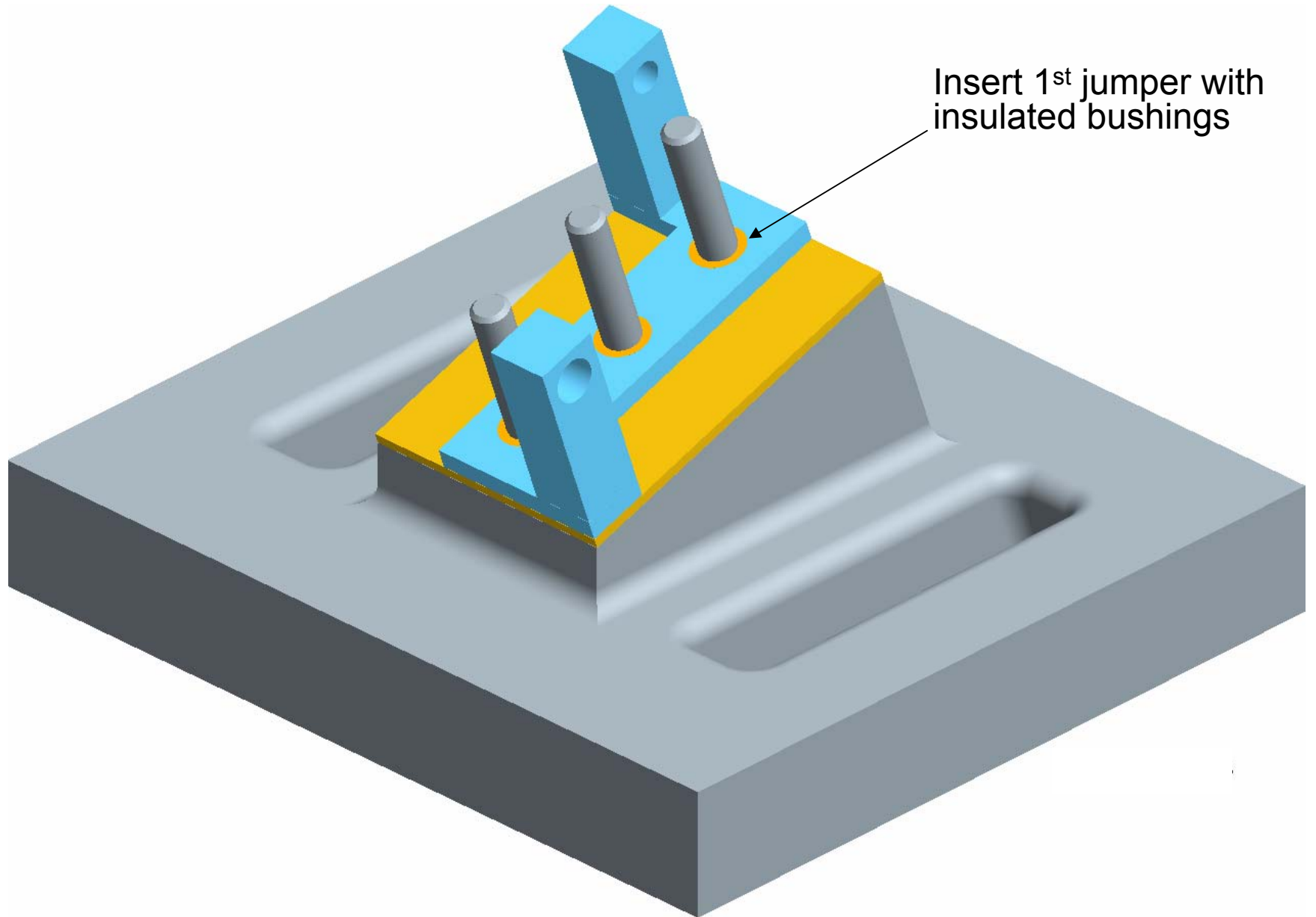

Step - 4

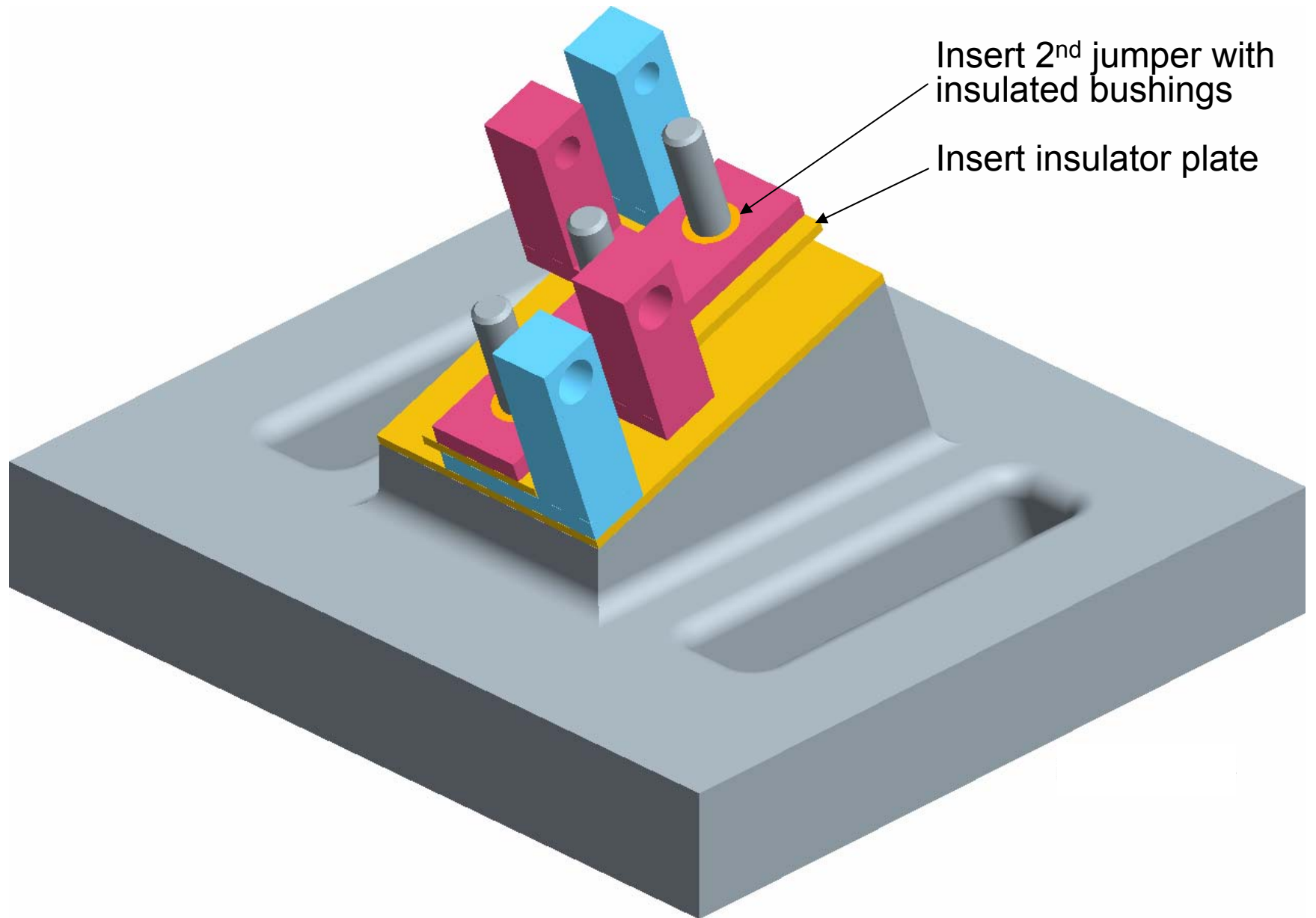

Step - 5

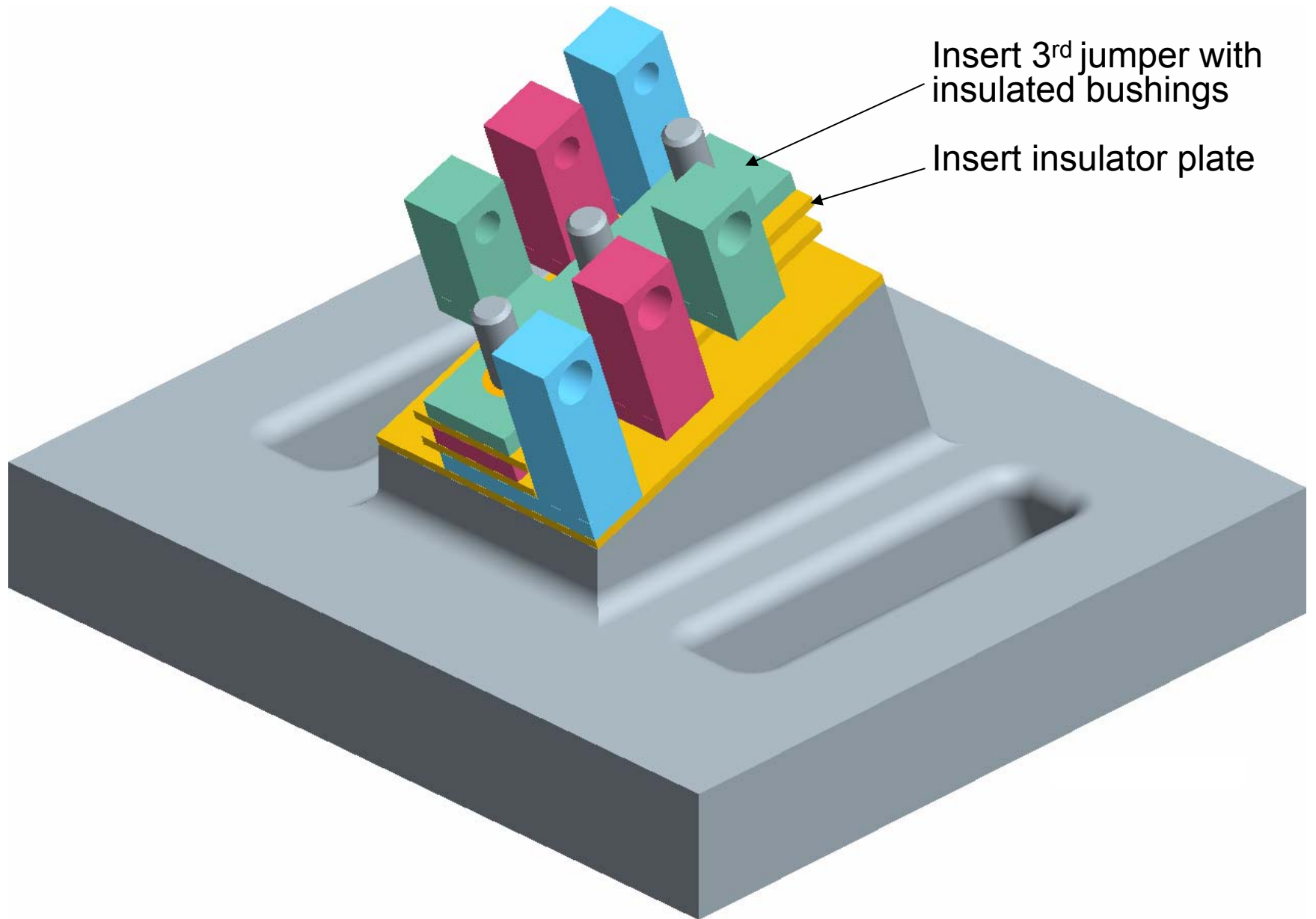

Step - 6

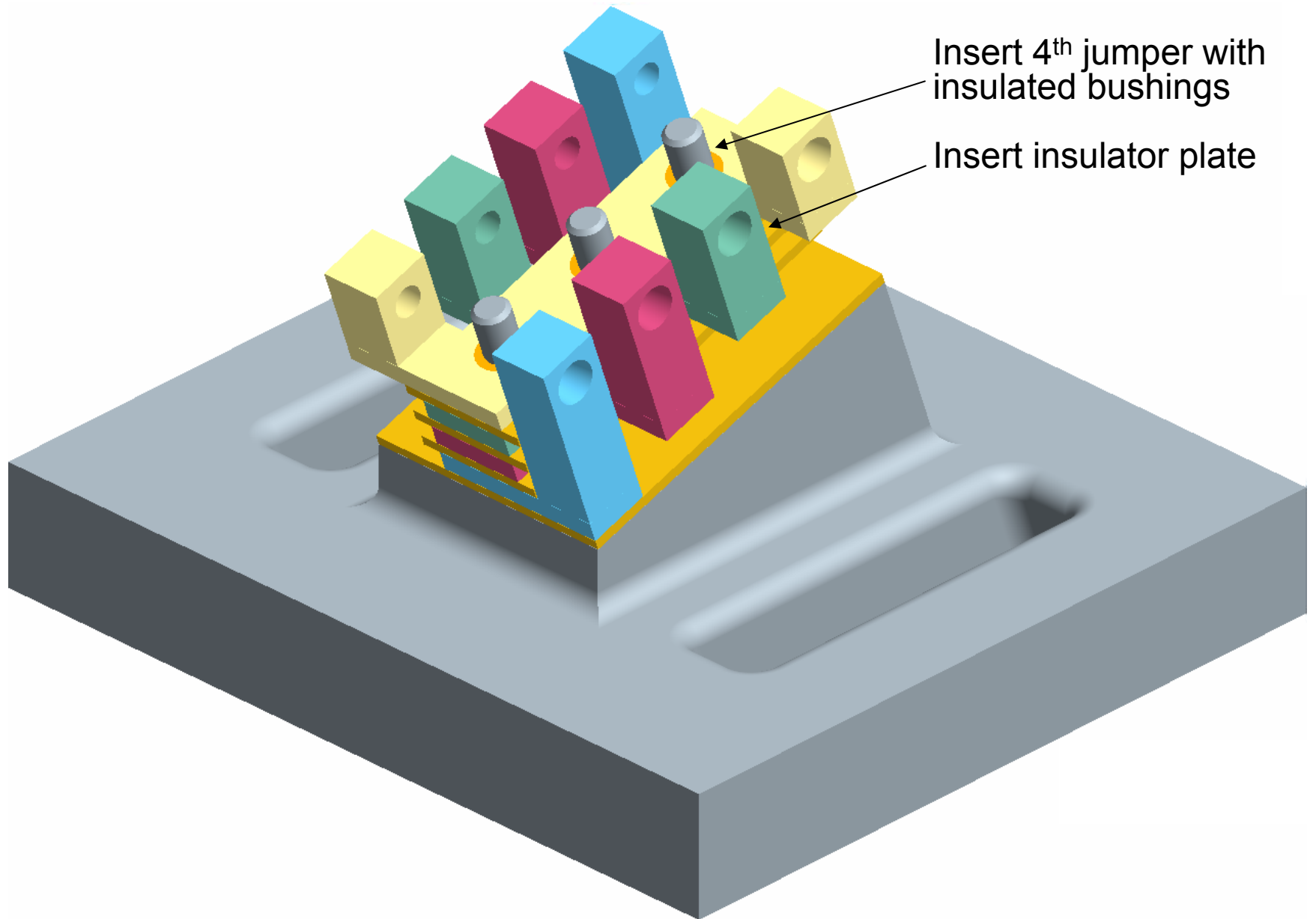

Step - 7

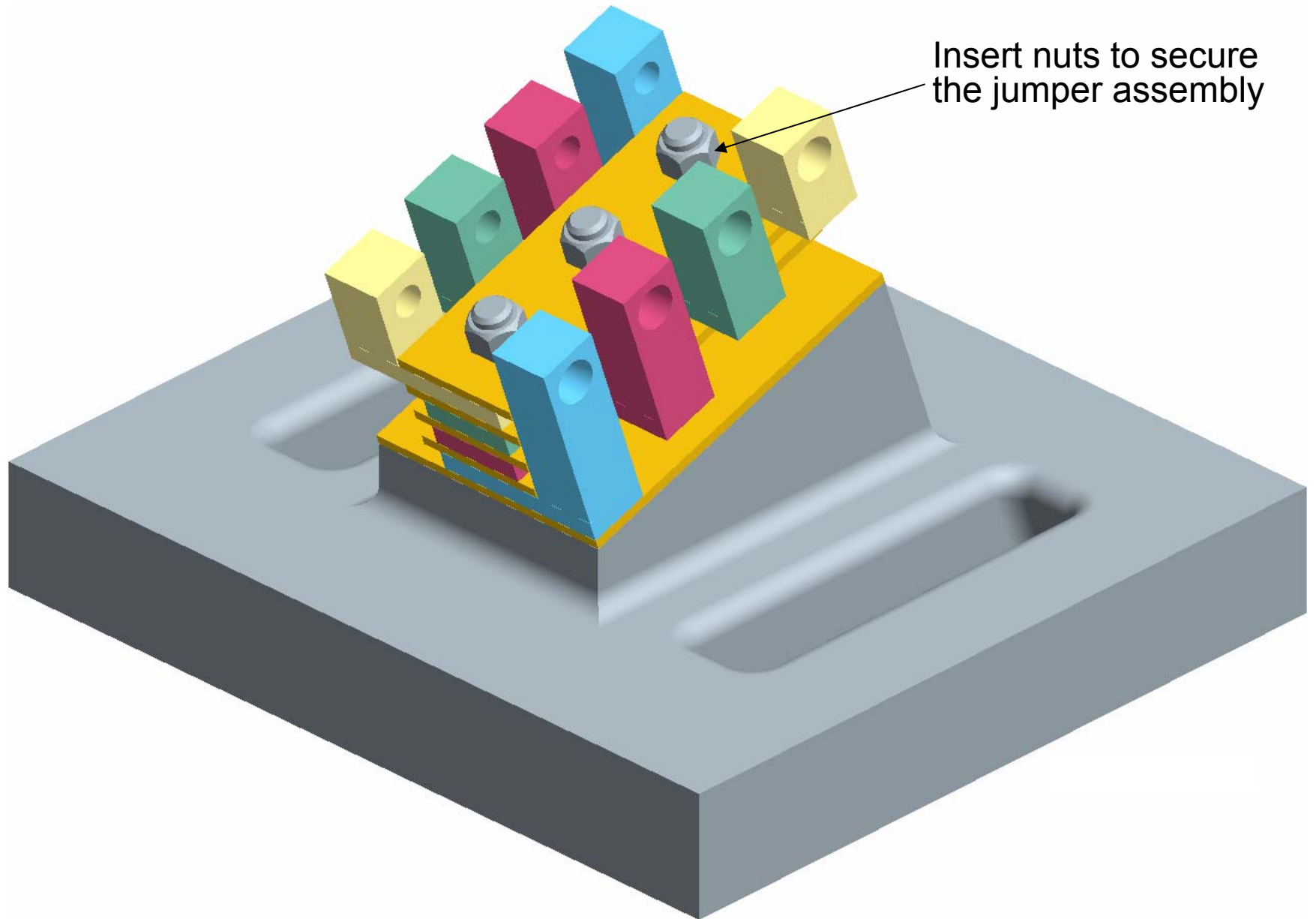

Step - 8

Insert insulator blocks
between jumper terminals

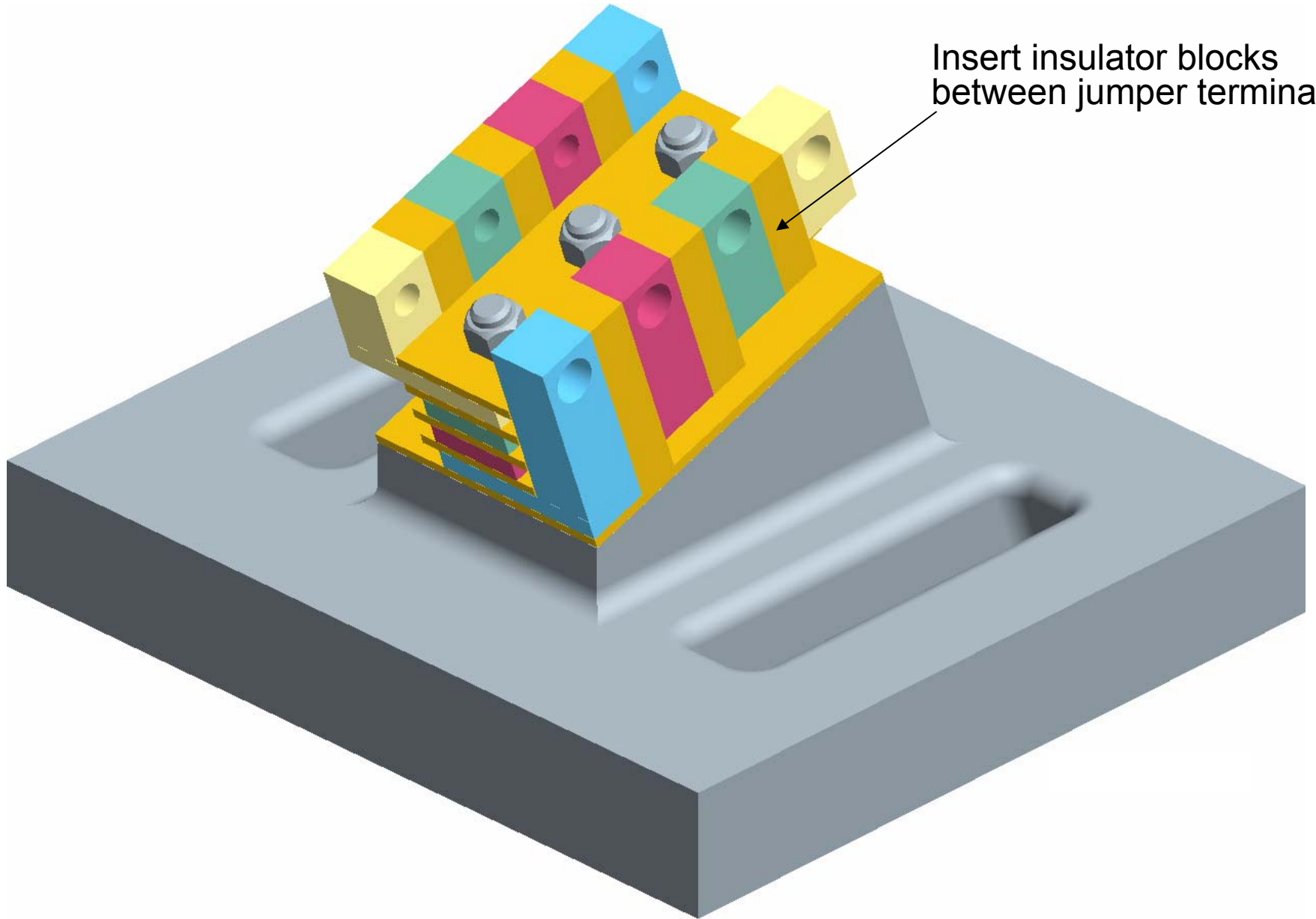

Step - 9

Insert individual leads into jumper terminals and tighten nuts / belleville washers

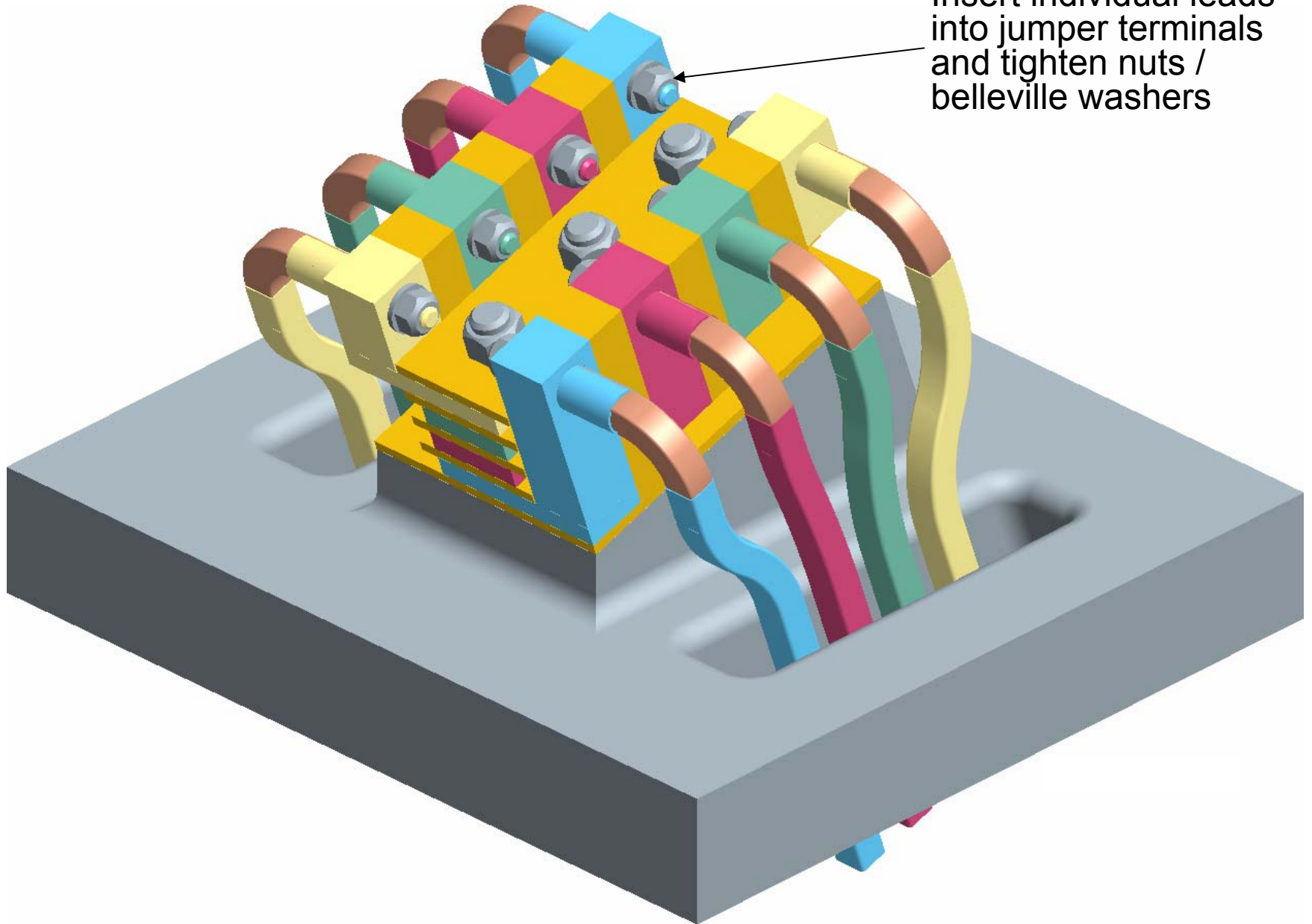

Lead Connector Detail

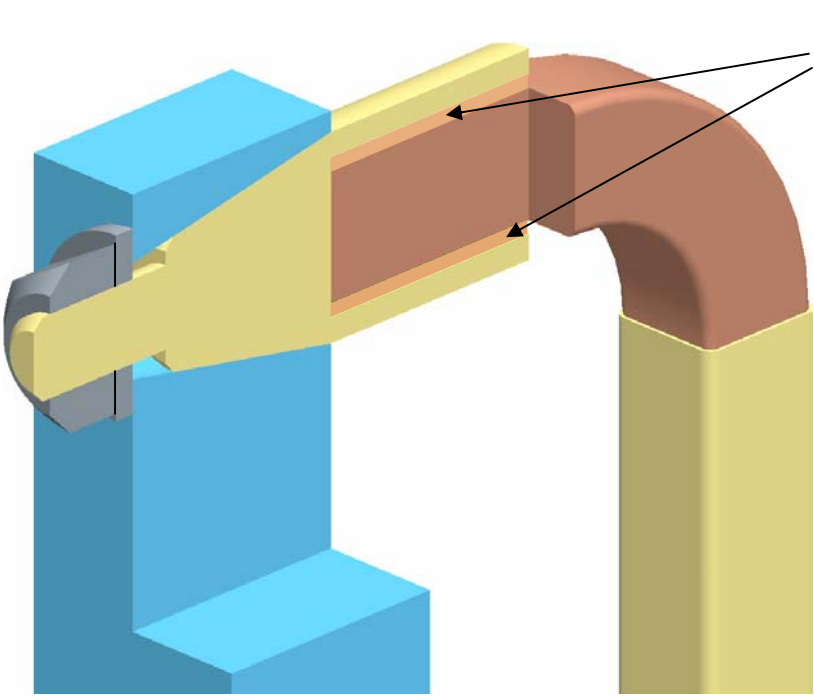

Front View

All voids are filled with solder

Jumper Terminal

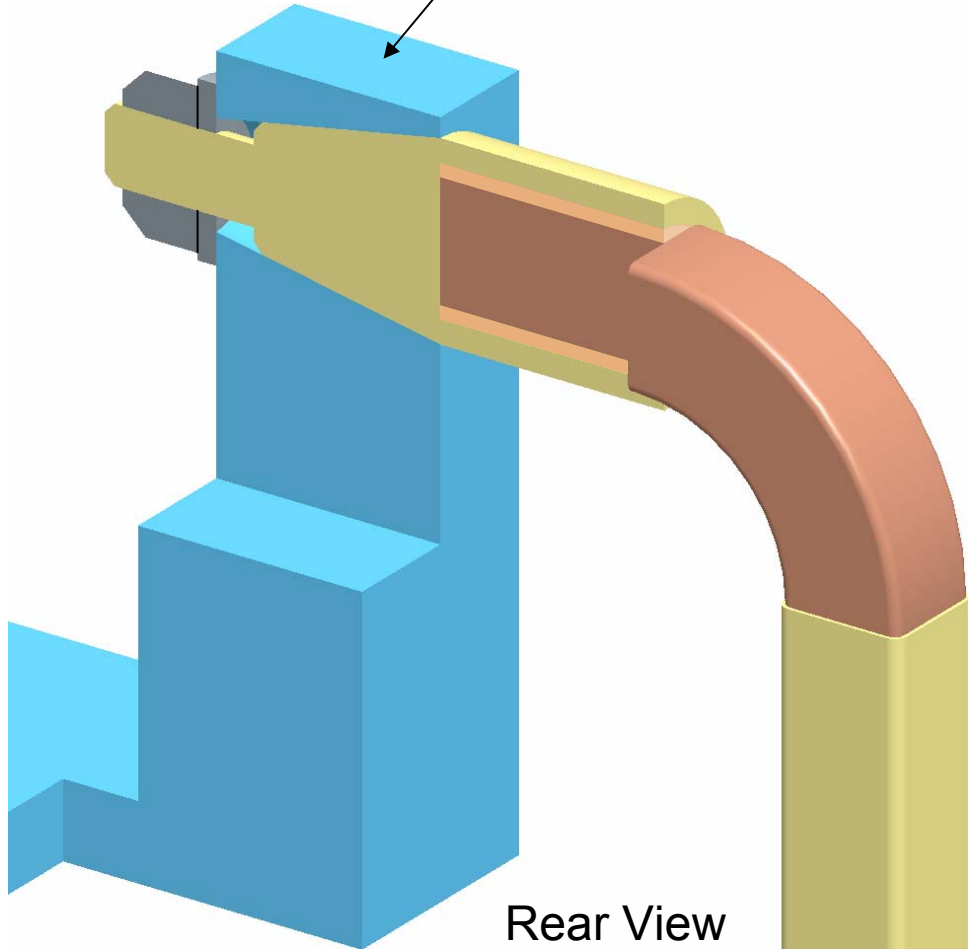

Rear View

Step - 10

Bolt cable support bracket to insulator block

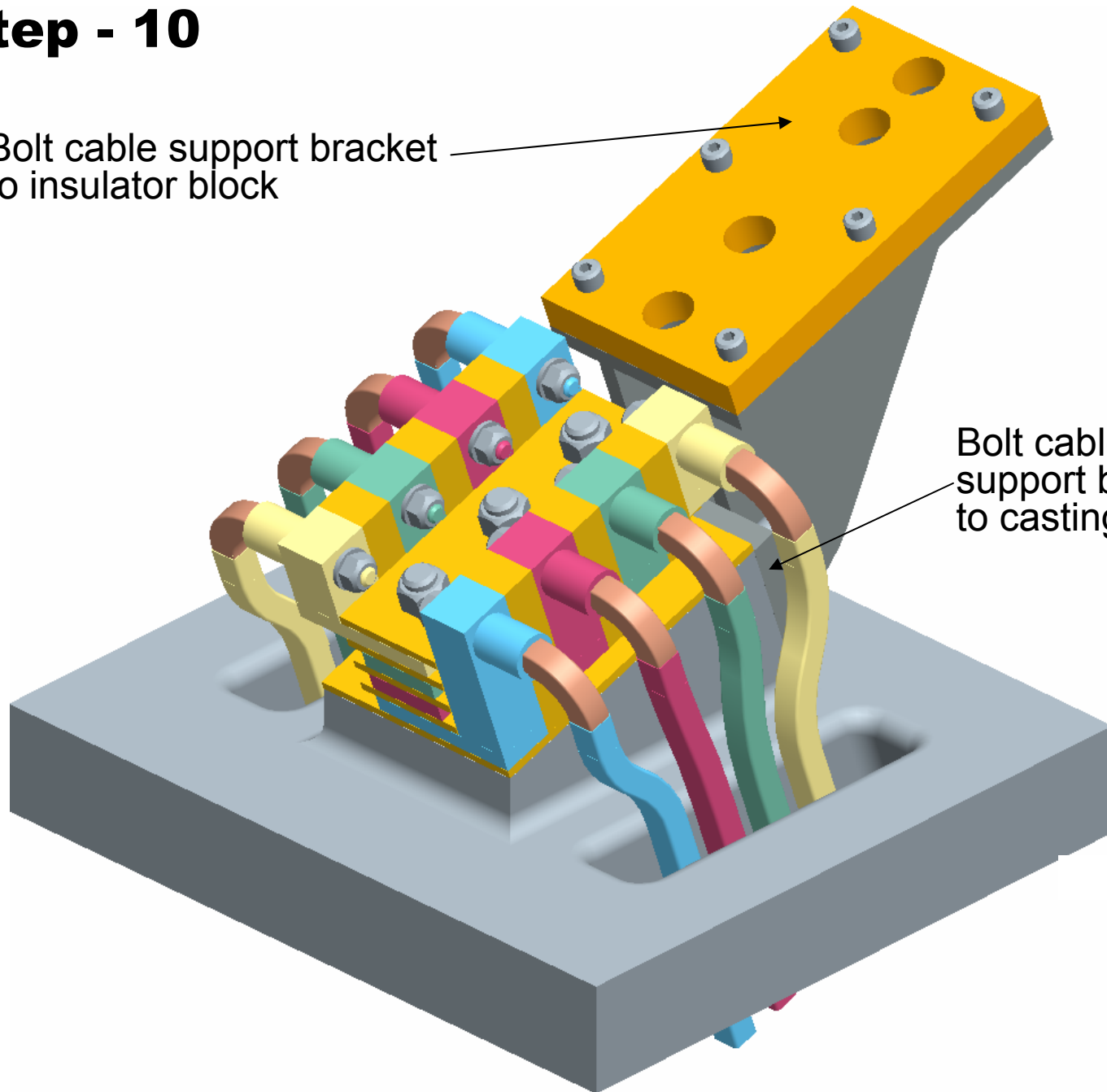

Bolt cable support bracket to casting boss

Step - 11

Insert insulator blocks
between jumpers and
cable lugs

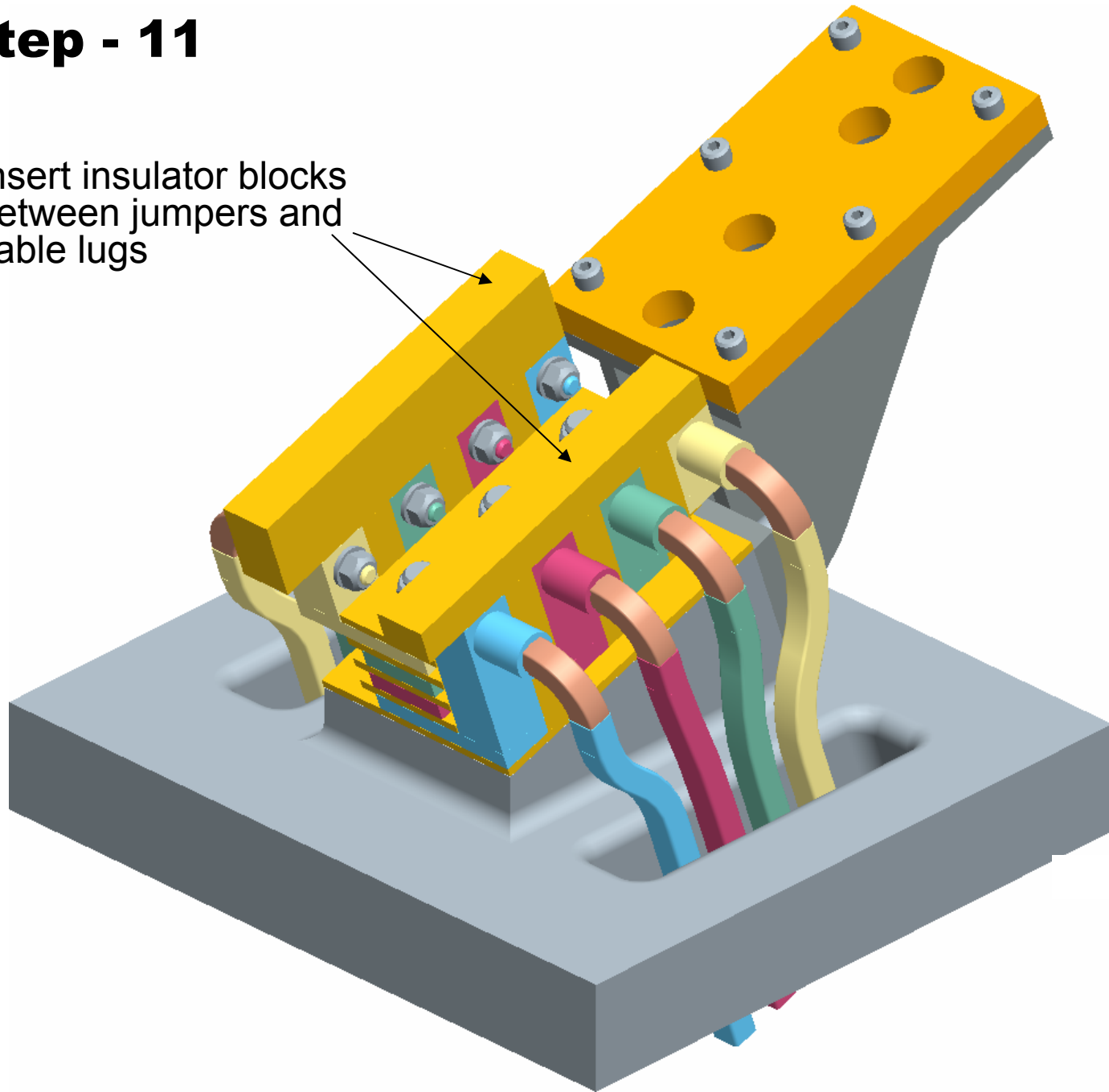

Step - 12

Insert lug plate

Insert lug terminals

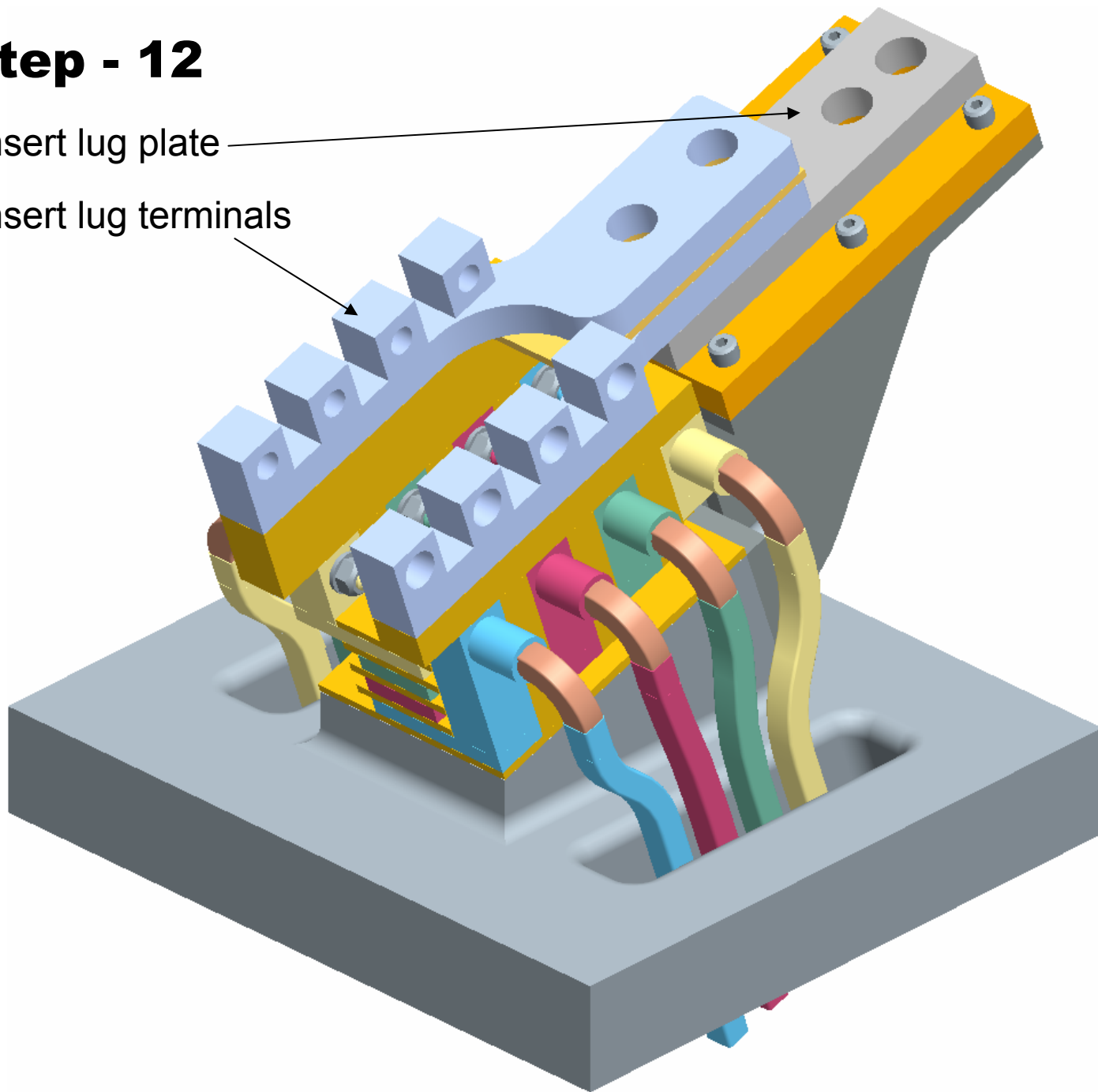

Step - 13

Insert individual leads into lug terminals and tighten nuts / belleville washers

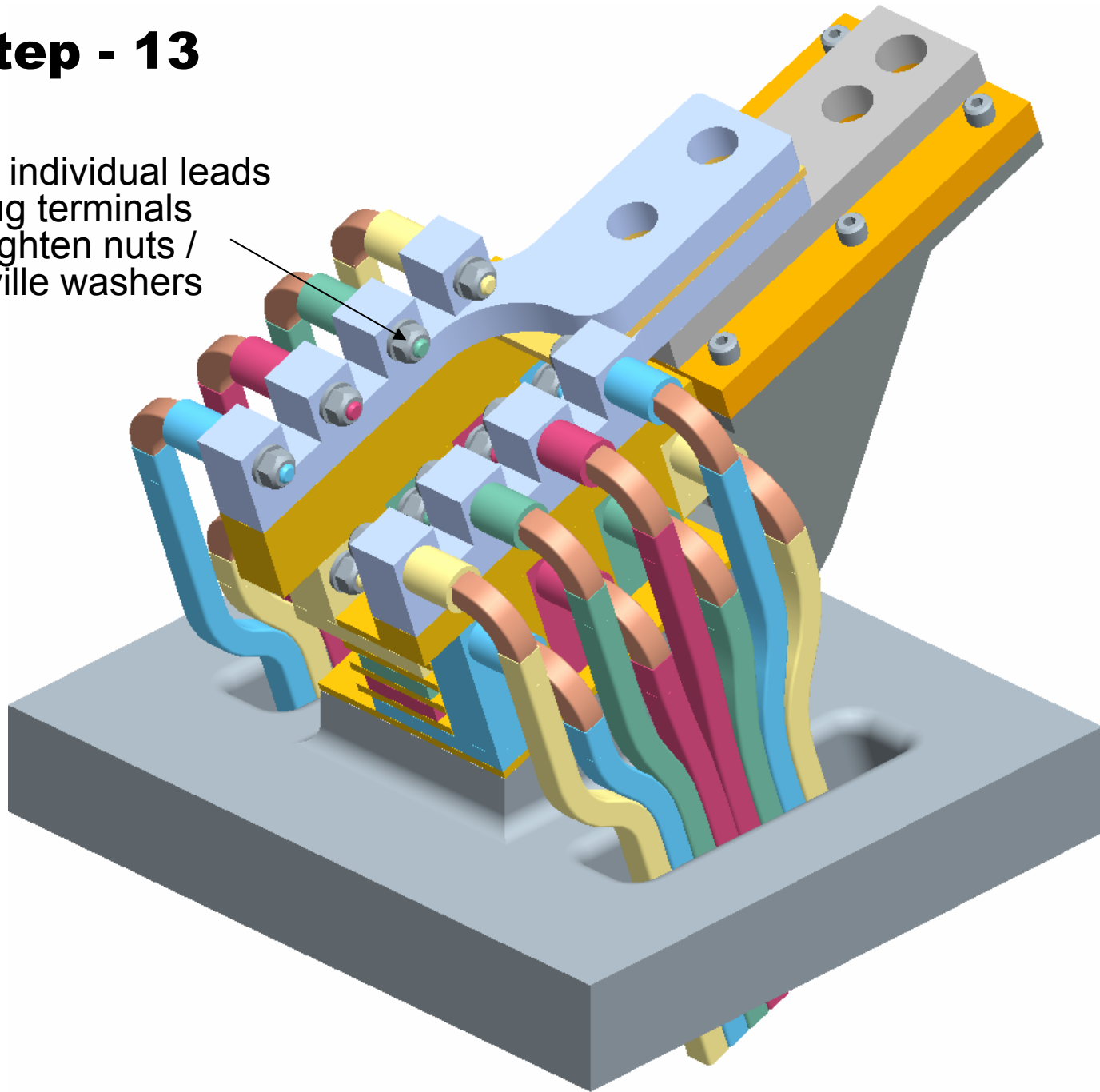

Step - 14

Align cable end piece
with threaded holes in
cable support bracket

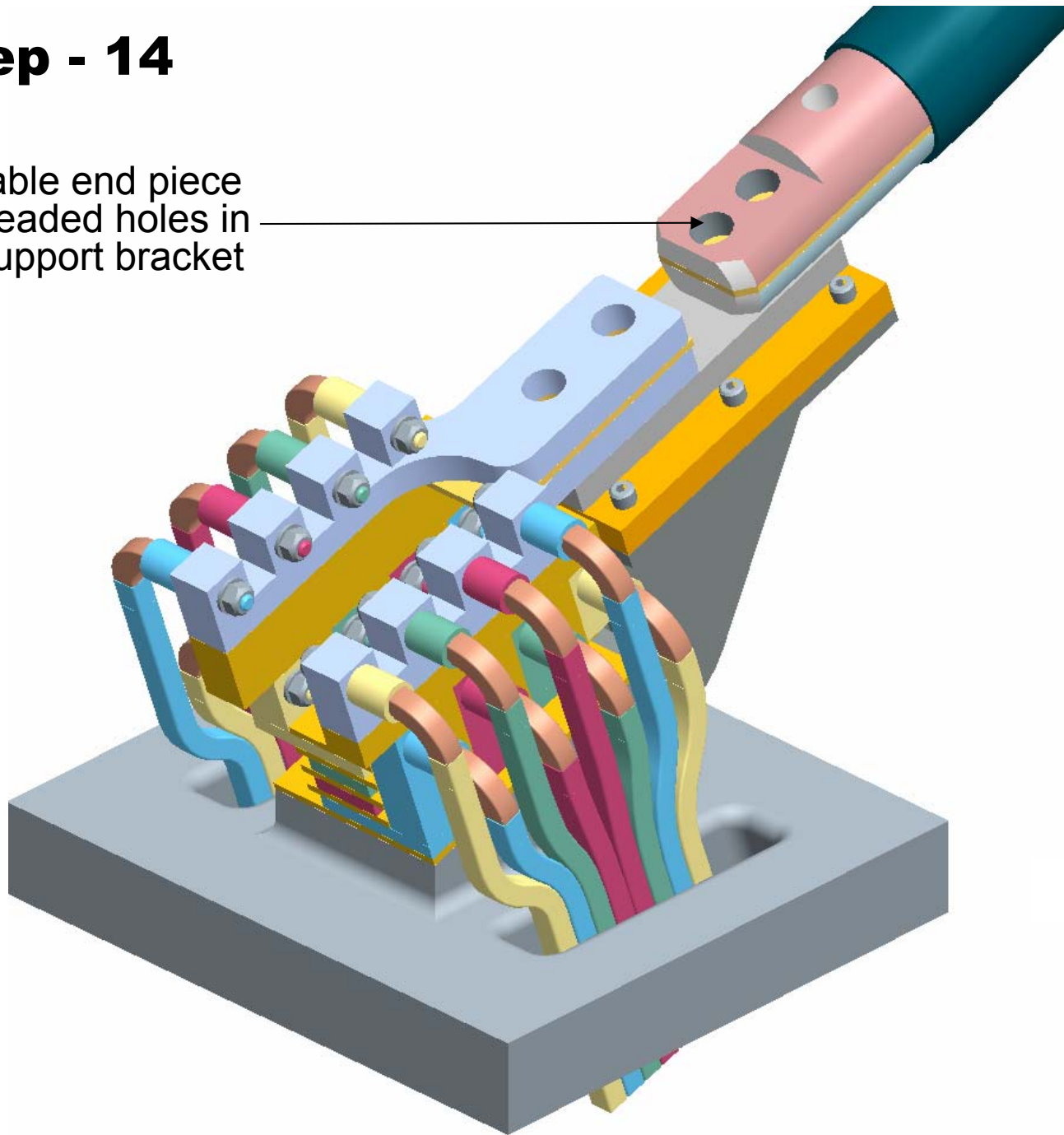

Step - 15

Install lug plate and secure bolts / belleville washers

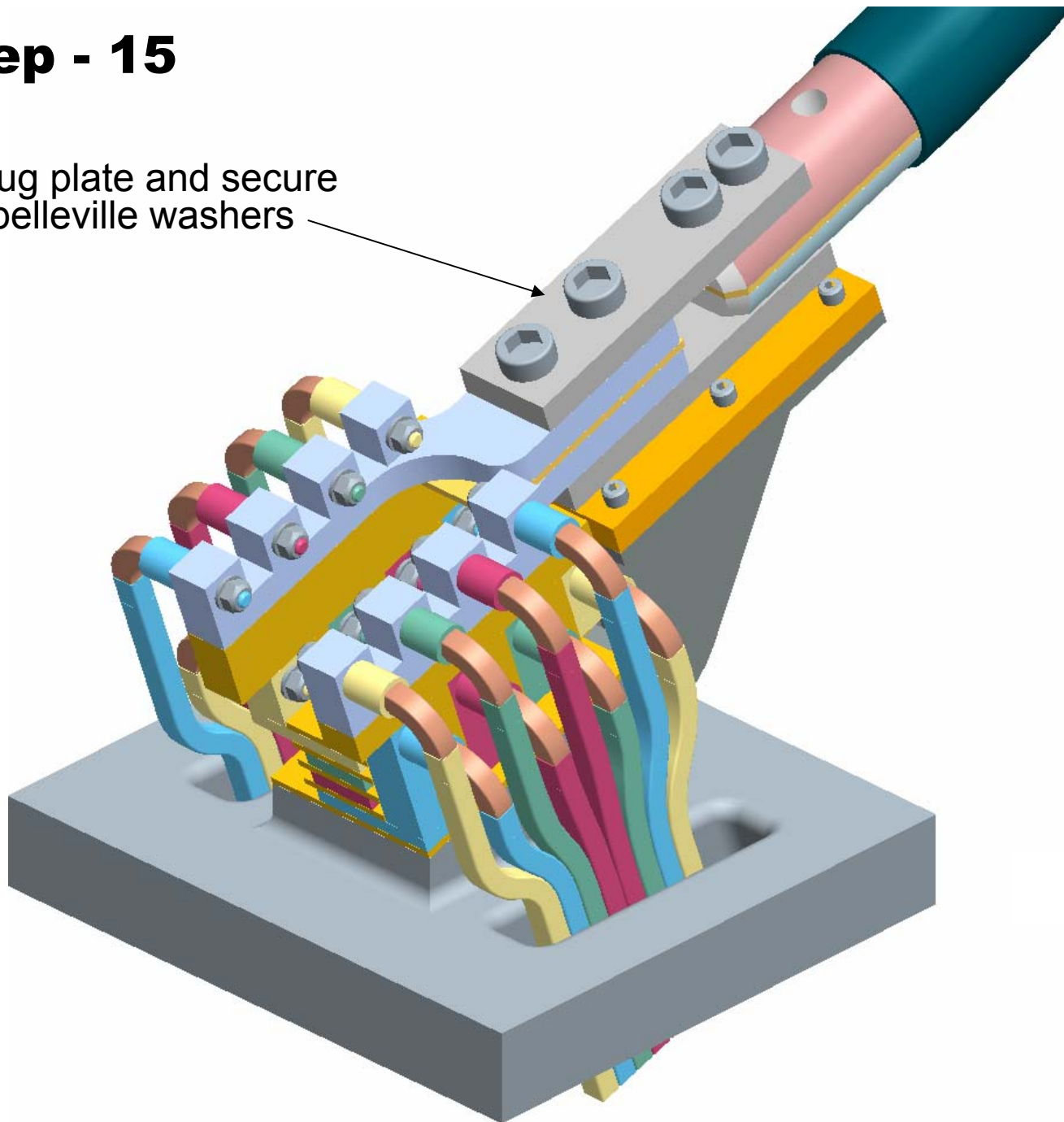

Step - 16

Install nitrogen coolant supply to cable end

Install nitrogen coolant lines from cable supply

Route along outside of copper chill plates that surround the leads

Open tube ends bathe exposed leads

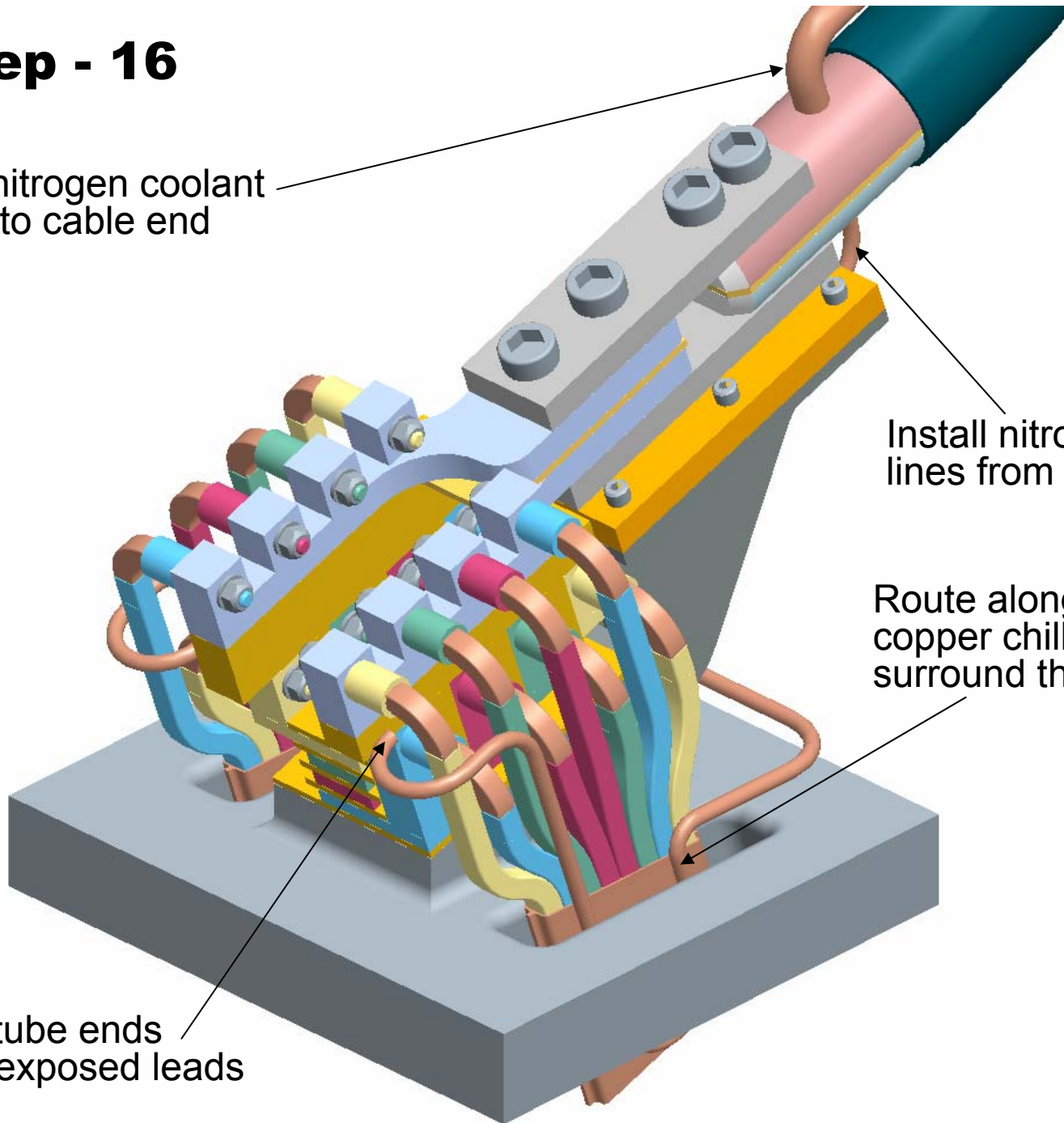

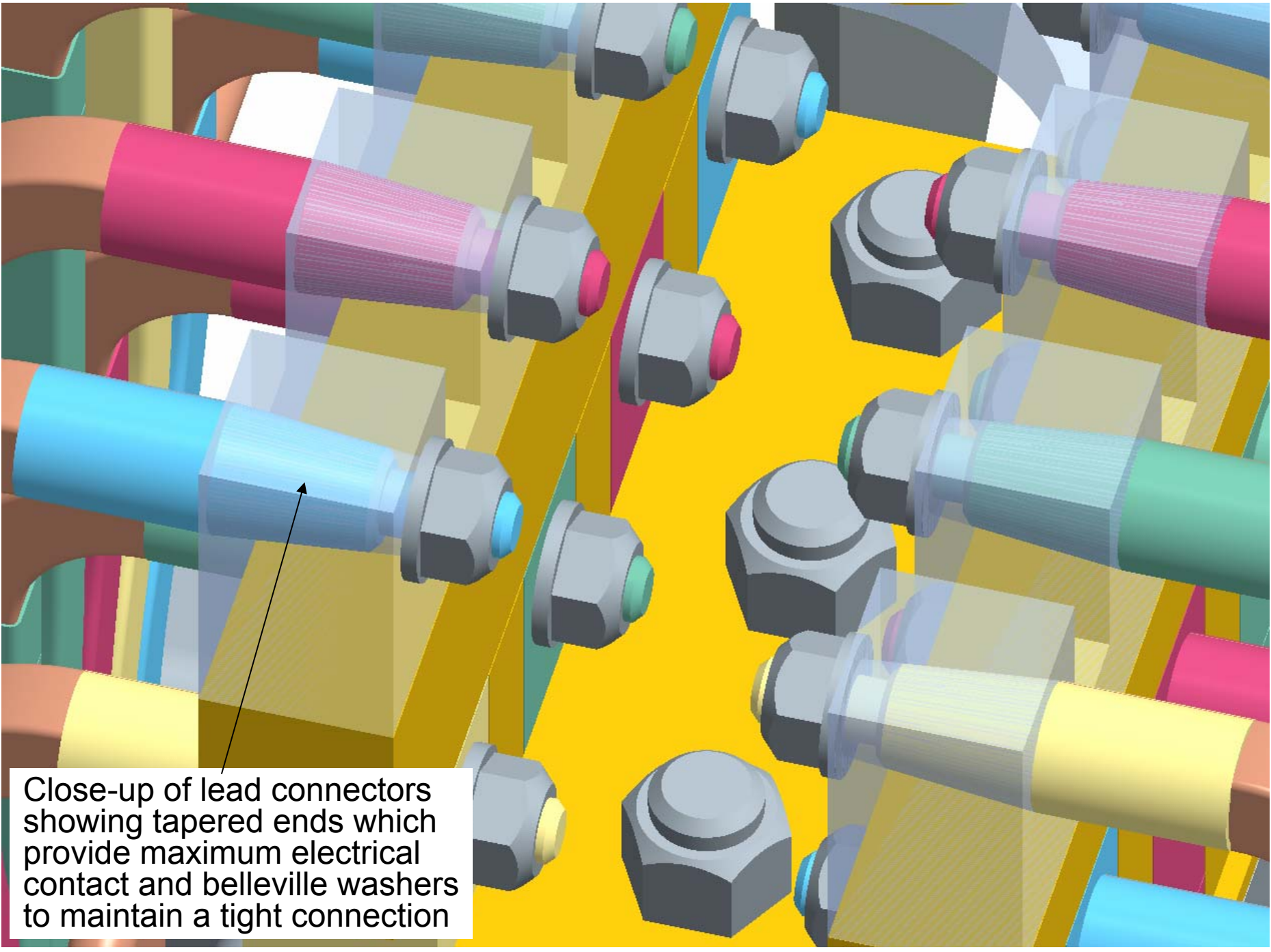

Close-up of lead connectors showing tapered ends which provide maximum electrical contact and belleville washers to maintain a tight connection

Rear view of leads assembly

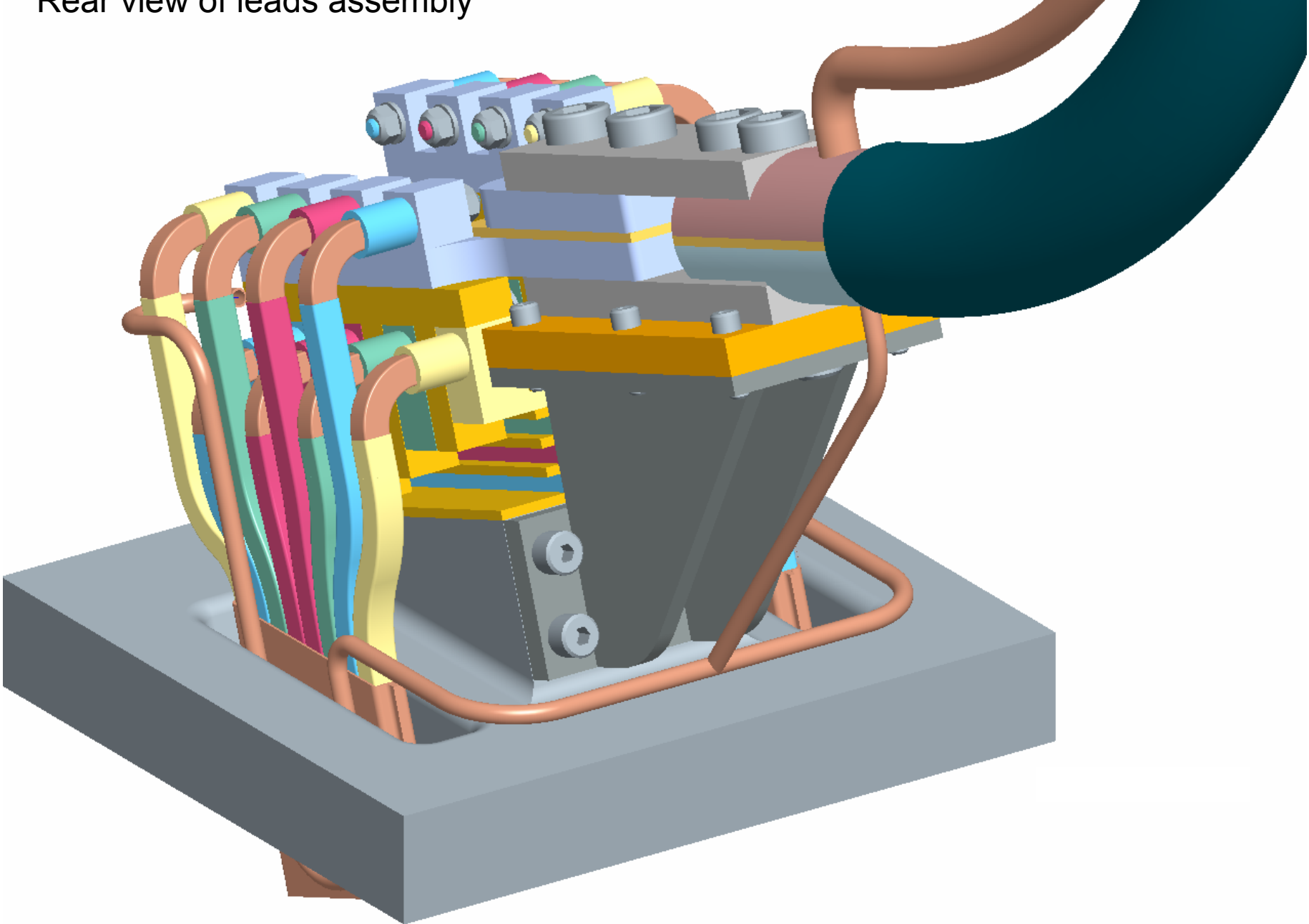

Top view of leads assembly

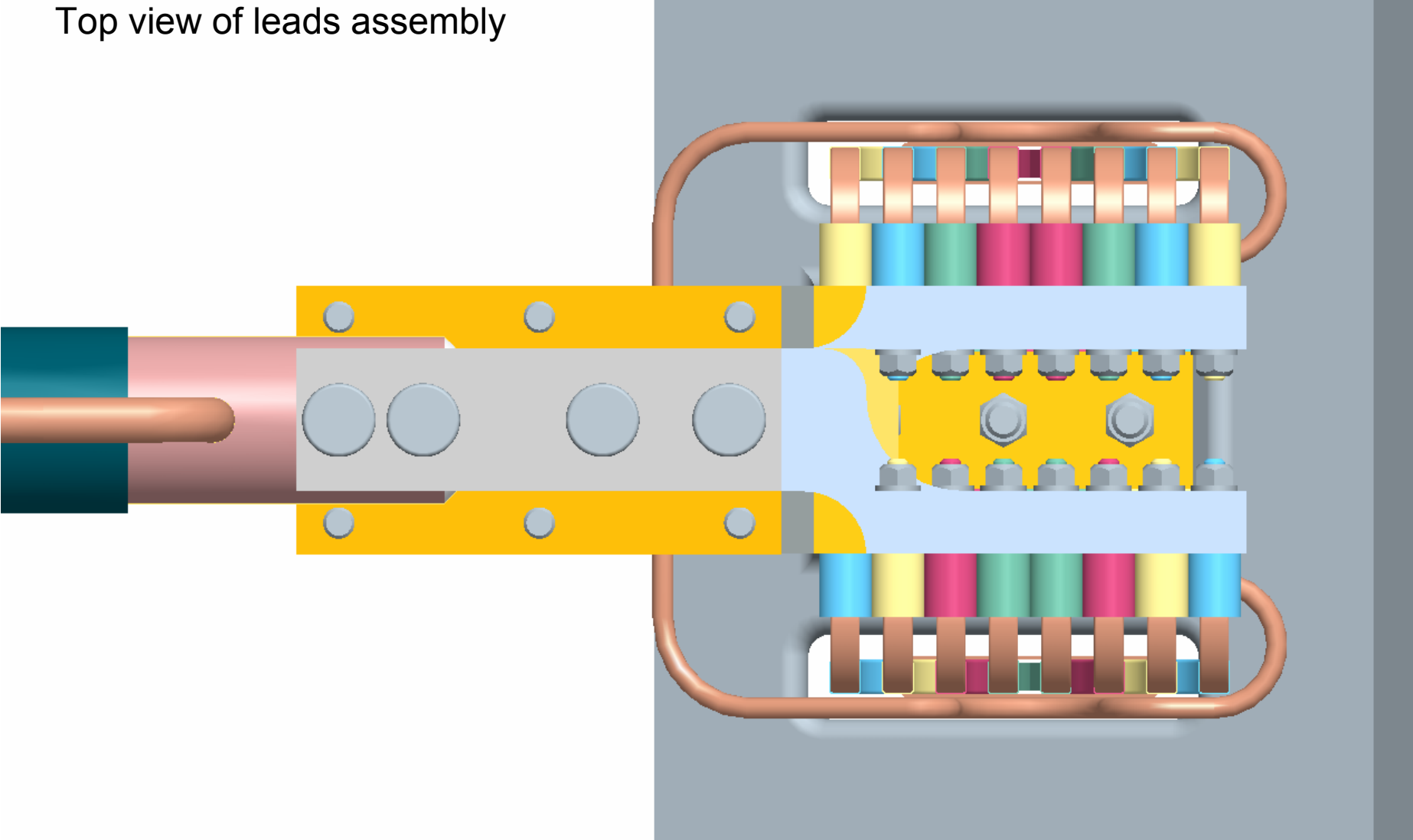

Side view of leads assembly

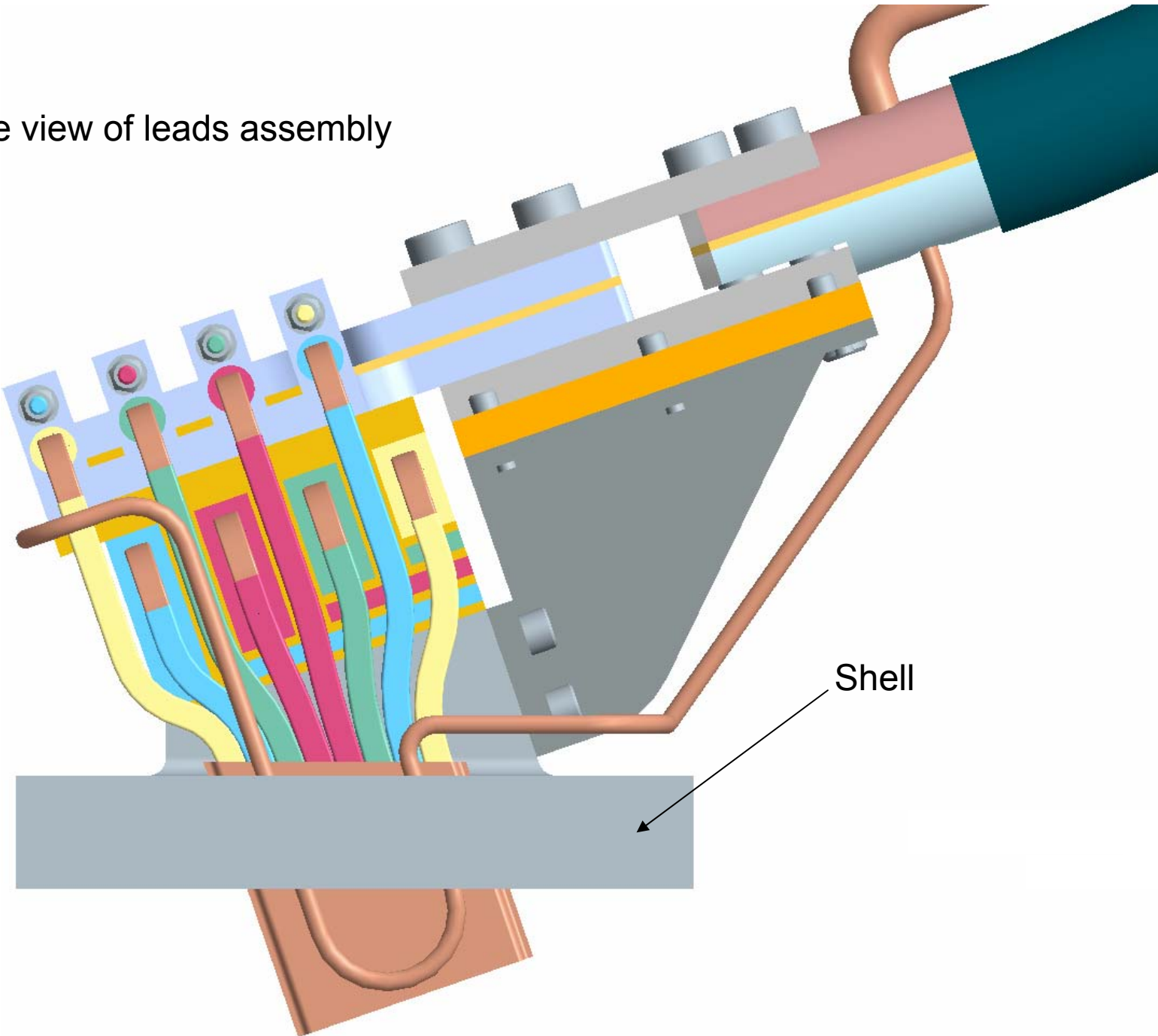

Shell

End view of leads assembly

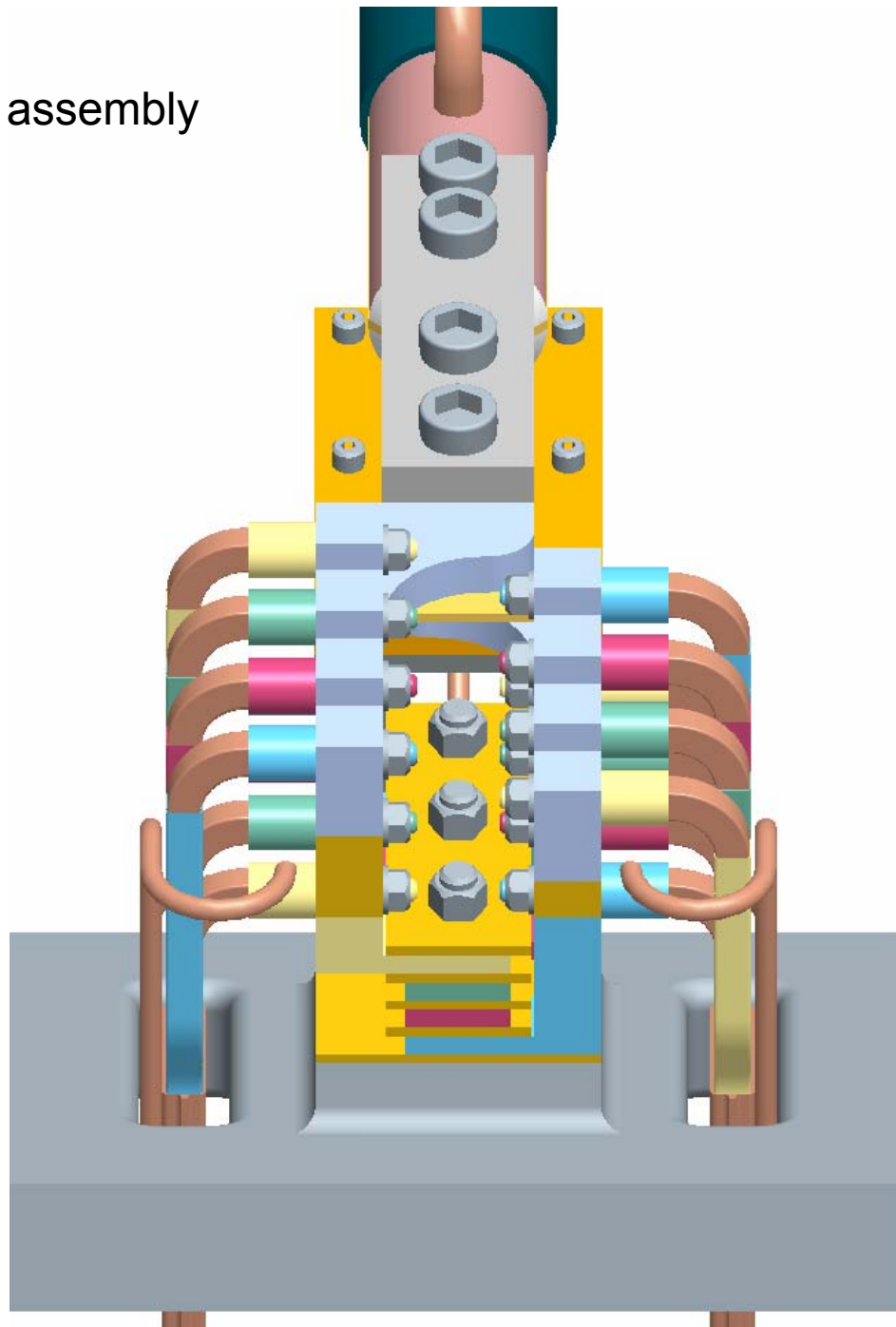

End view of leads assembly

