

- NOTES
- DRAWING PREPARED IN ACCORDANCE WITH ASME Y14.100-2004.
  - INTERPRET DIMENSIONS AND TOLERANCES PER ASME Y14.5M-1994.
  - DIMENSIONS ARE IN INCHES
  - MAGNETIC PERMEABILITY NOT TO EXCEED 1.02 AS TESTED BY A SEVERN INDICATOR. AVAILABLE FROM:  
SEVERN ENGINEERING  
AUBURN, ALABAMA 36830  
WWW.SEVERENGINEERING.COM
- [5] COATING PER PROVIDED NCSX SPECIFICATION.

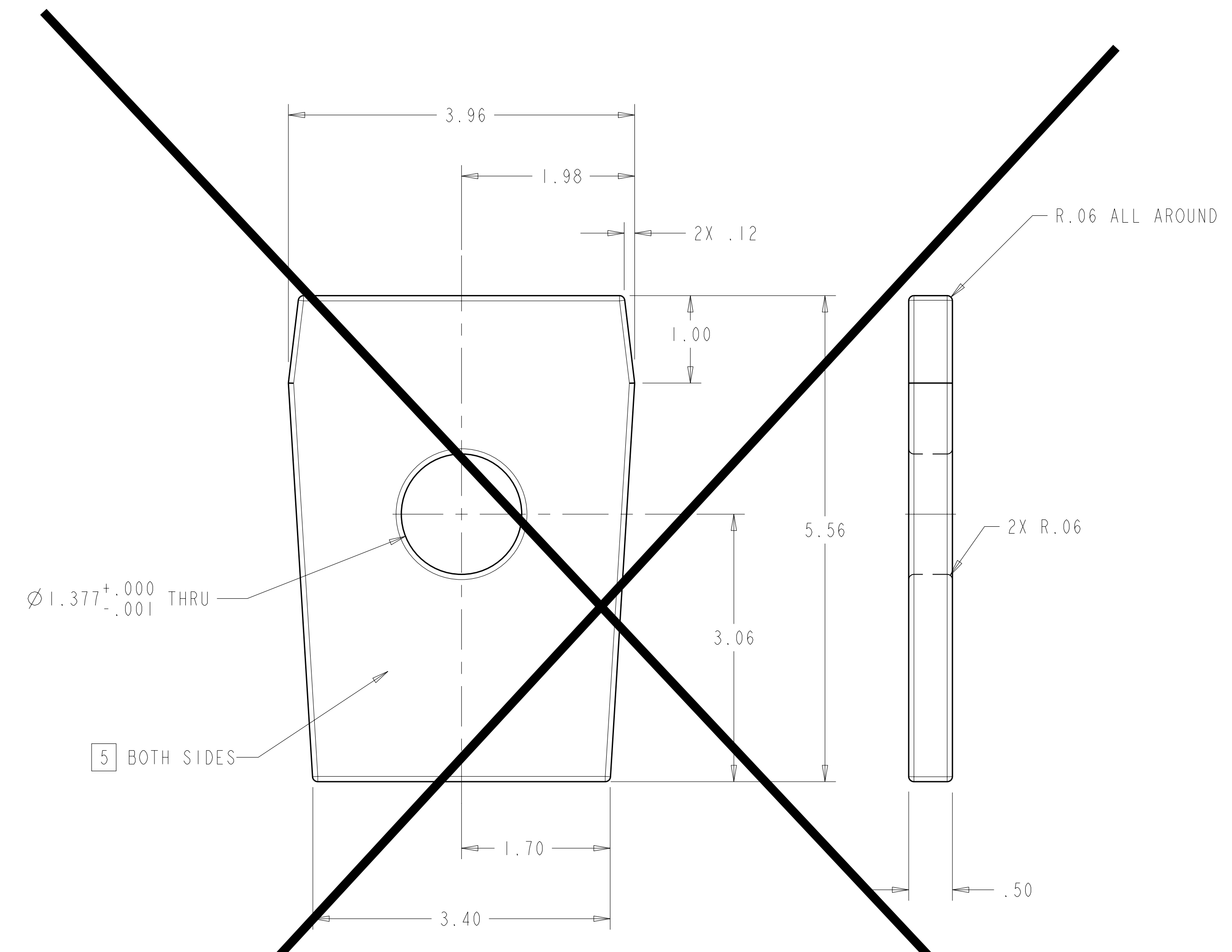

**-3 C-C SINGLE HOLE SHIM**  
SCALE 1.00

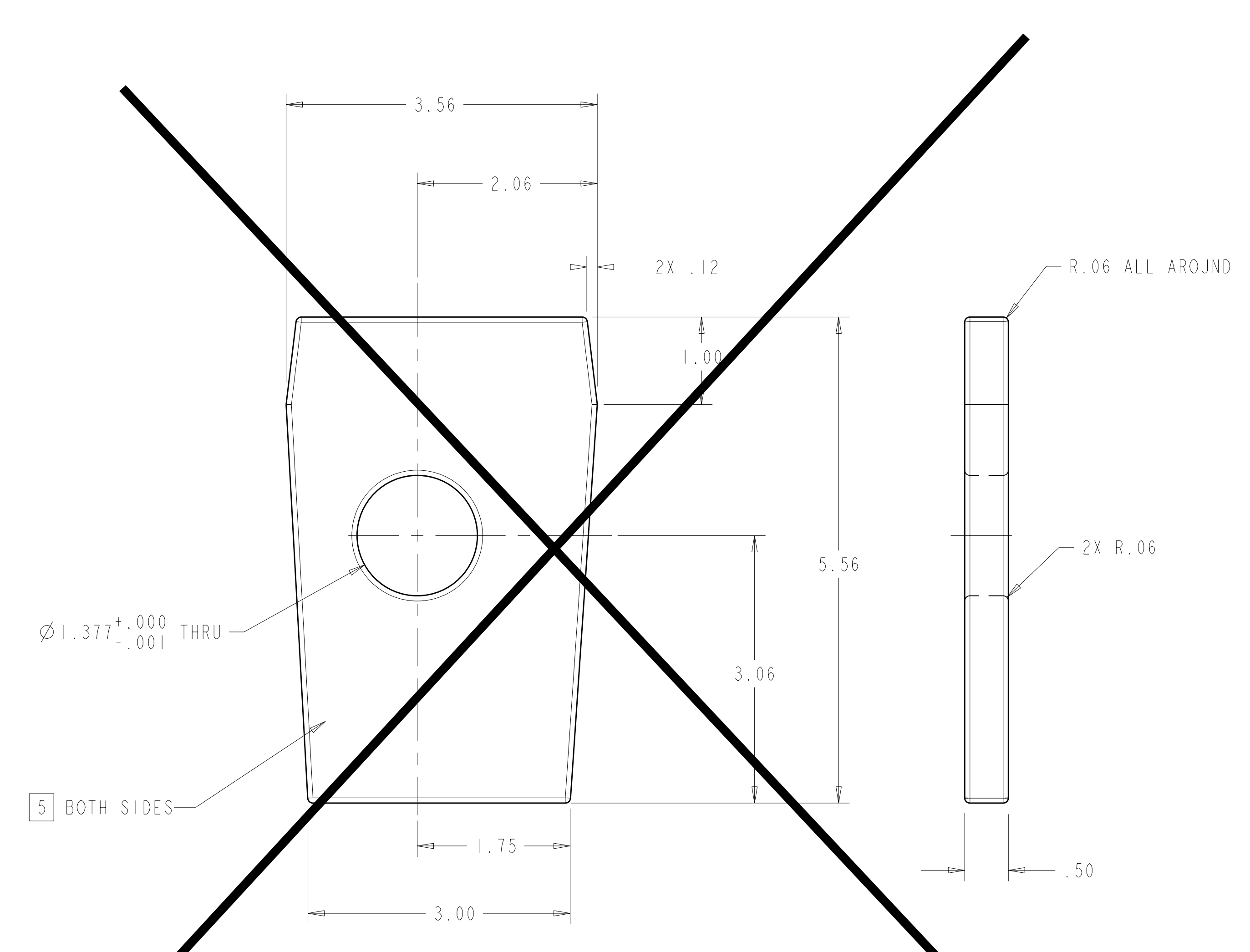

**-2 C-C SINGLE HOLE SHIM**  
SCALE 1.00

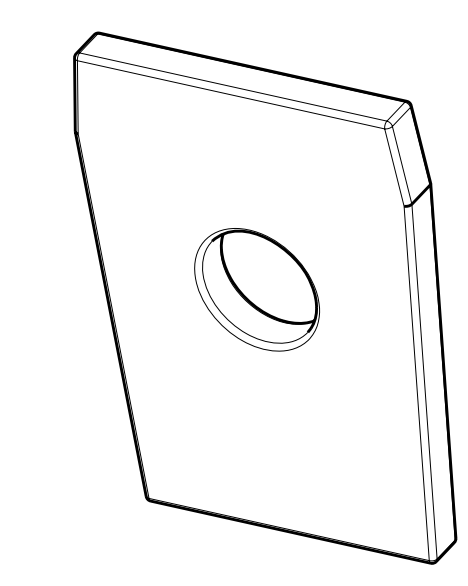

**TYP ISOMETRIC VIEW**  
SCALE .50

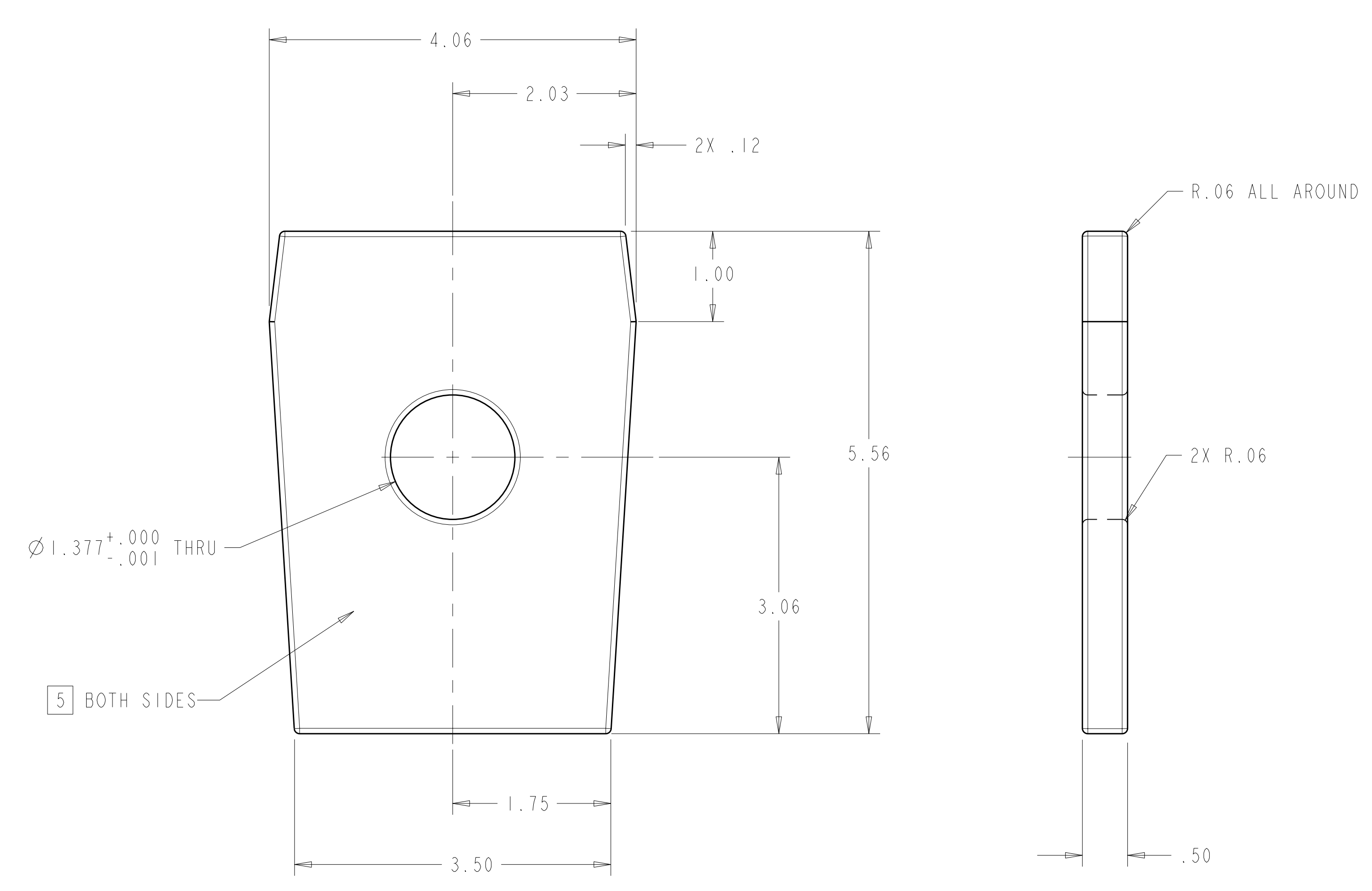

**-1 SHINGLE HOLE SHIM**  
SCALE 1.000

CAGE CODE	PART OR IDENTIFYING NO	NOMENCLATURE OR DESCRIPTION	MATERIAL	SPECIFICATION	FIND NO
AR - -	-3	C-C SINGLE HOLE SHIM	316 SST	ASTM A240	3
AR AR AR	-2	NARROW SINGLE HOLE SHIM	PLASMA ALUMINA COATED		2
- AR AR	-1	SINGLE HOLE SHIM			1
SE100-001					
SE100-002					
SE140-003					

← NEXT ASSEMBLY

PARTS LIST

NO REPRESENTATION OR WARRANTY, EXPRESSED OR IMPLIED, IS MADE AS TO THE ACCURACY, COMPLETENESS OR USEFULNESS OF THE INFORMATION OR STATEMENTS CONTAINED IN THESE DRAWINGS, OR THAT THE USE OR DISCLOSURE OF ANY INFORMATION, APPARATUS, METHOD OR PROCESS DISCLOSED IN THESE DRAWINGS MAY NOT INFRINGE PRIVATE RIGHTS OF OTHERS. NO LIABILITY IS ASSUMED WITH RESPECT TO THE USE OF, OR FOR DAMAGES RESULTING FROM THE USE OF, ANY INFORMATION, APPARATUS, METHOD OR PROCESS DISCLOSED IN THESE DRAWINGS. DRAWINGS MADE AVAILABLE FOR PURPOSES, AND ARE TO BE RETURNED UPON REQUEST OF THE FORWARDING CONTRACTOR.

**P** THIS DRAWING PRODUCED ON PRO-ENGINEER

REV	DESCRIPTION	BY	DATE	CHK	DEPT	DATE	PE	REQ	DATE	ORNL	DOE	DATE
0	ORIGINAL ISSUE	GM	04/07									
REVISION OR ISSUE PURPOSE												
REVISION APPROVAL												

SCALE NOTED	DES D WILLIAMSON 04/07	DRW G MCGINNIS 04/07	UT-BATTELLE	Oak Ridge National Laboratory managed for the DEPARTMENT OF ENERGY under U.S. GOVERNMENT contract DE-AC05-00OR22725 UT-BATTELLE, LLC. Oak Ridge, Tennessee
TOLERANCES UNLESS OTHERWISE SPECIFIED	CHK	SECT	DEPT	PROJECT NAME
FRACTIONS ±.01	FE	CR	PJ	NATIONAL COMPACT STELLARATOR EXPERIMENT
XXX DECIMALS ±.005	REO			SINGLE HOLE SHIM PLATES
ANGLES ±0°15'				
BREAK SHARP EDGES OR MAX				
FINISH .125 UNLESS OTHERWISE SPECIFIED	PPPL DRFT J SIEGEL 04/07	VERSION NO. 3+	PLANT ORNL	BLDG 5700
		RELEASE LEVEL WIP	FL 3	SHT 1
			OF 1	TYPE S
				CLASS U
				REV 0
				SEI40-040