

H
G
F
E
D
C
B
A

H
G
F
E
D
C
B
A

NOTES:

1. INTERPRET DIMENSIONS AND TOLERANCES PER ANSI Y14.5M
2. DIMENSIONS ARE IN INCHES
3. DIMENSIONS APPLY AT ROOM TEMPERATURE. OPERATING TEMP 80 K.
4. GEOMETRY IS DEFINED IN PRO ENGINEER CAD MODELS/FILES SE142-171.PRT
5. DRAWING AND MODELS COMBINED DEFINE FINISHED MACHINED PART.

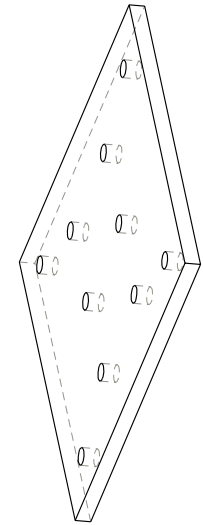
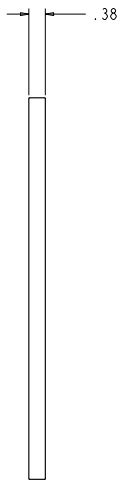
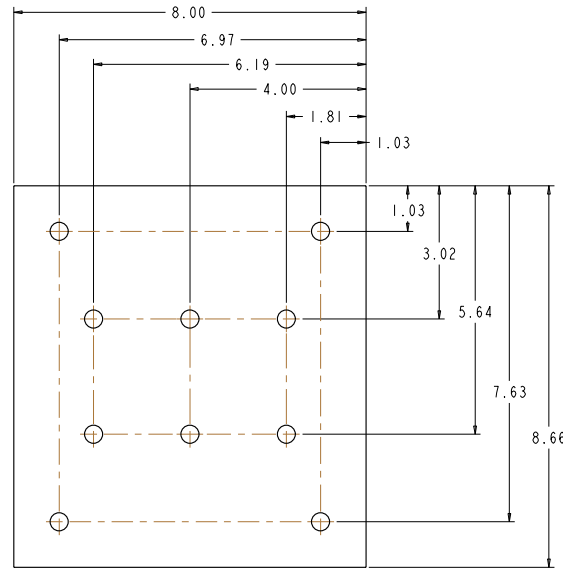

SCALE 1.00

①
SCALE 1: 1

REV	CAGE CODE	PART OR IDENTIFYING NO	NOMENCLATURE OR DESCRIPTION	MATERIAL	SPECIFICATION	FIND NO
1	SE142-171	←	ASSEMBLY			

REV	DESCRIPTION	BY	DATE	CHK	DEPT	DATE	PE	REQ	DATE	ORNL	DOE	DATE

NO REPRESENTATION OR WARRANTY, EXPRESSED OR IMPLIED, IS MADE AS TO THE ACCURACY, COMPLETENESS OR RELIABILITY OF THE INFORMATION OR STATEMENTS CONTAINED IN THESE DRAWINGS. ON THE USE OR MISUSE OF ANY INFORMATION CONTAINED HEREIN. THE METHOD OR PROCESS DISCLOSED IN THESE DRAWINGS MAY NOT BE APPLICABLE TO ALL SITUATIONS. THE USER SHALL BE RESPONSIBLE FOR OBTAINING NECESSARY PERMISSIONS FROM THE APPLICABLE AGENCIES AND FOR OBTAINING NECESSARY INFORMATION TO AVOID THE USE OF THIS INFORMATION FOR OTHER PURPOSES, AND NOT TO BE RELEASED FROM THE OBTAINING CONTRACTOR.

P THIS DRAWING PRODUCED ON PRO-ENGINEER

SCALE NOTED DES P J FOGARTY 8-29-95
 TOLERANCES UNLESS OTHERWISE SPECIFIED
 FRACTIONS XX DECIMALS 0.01
 ANGLES 30/15
 BREAK SHARP EDGES ON MAX
 FINISH UNLESS OTHERWISE SPECIFIED
 PPL DRFT J SIEGLE 8-09
 RELEASE LEVEL WIP
 DRAWING APPROVALS DATE

UT-BATTELLE Oak Ridge National Laboratory managed by the DEPARTMENT OF ENERGY under U.S. GOVERNMENT CONTRACT NO. AC05-84OR21400
 PROJECT TITLE: COMPACT Stellarator Experiment
 NATIONAL COMPACT STELLARATOR EXPERIMENT
 FIXTURE-ALIGNMENT BOTTOM PLATE
 VERSION NO. 1 PLANT X-10 BLDG 3700 3 1 1 S U
 SE142-171 REV D