

NO.	REVISION	BY	CH	SUP	APPROVED	DATE

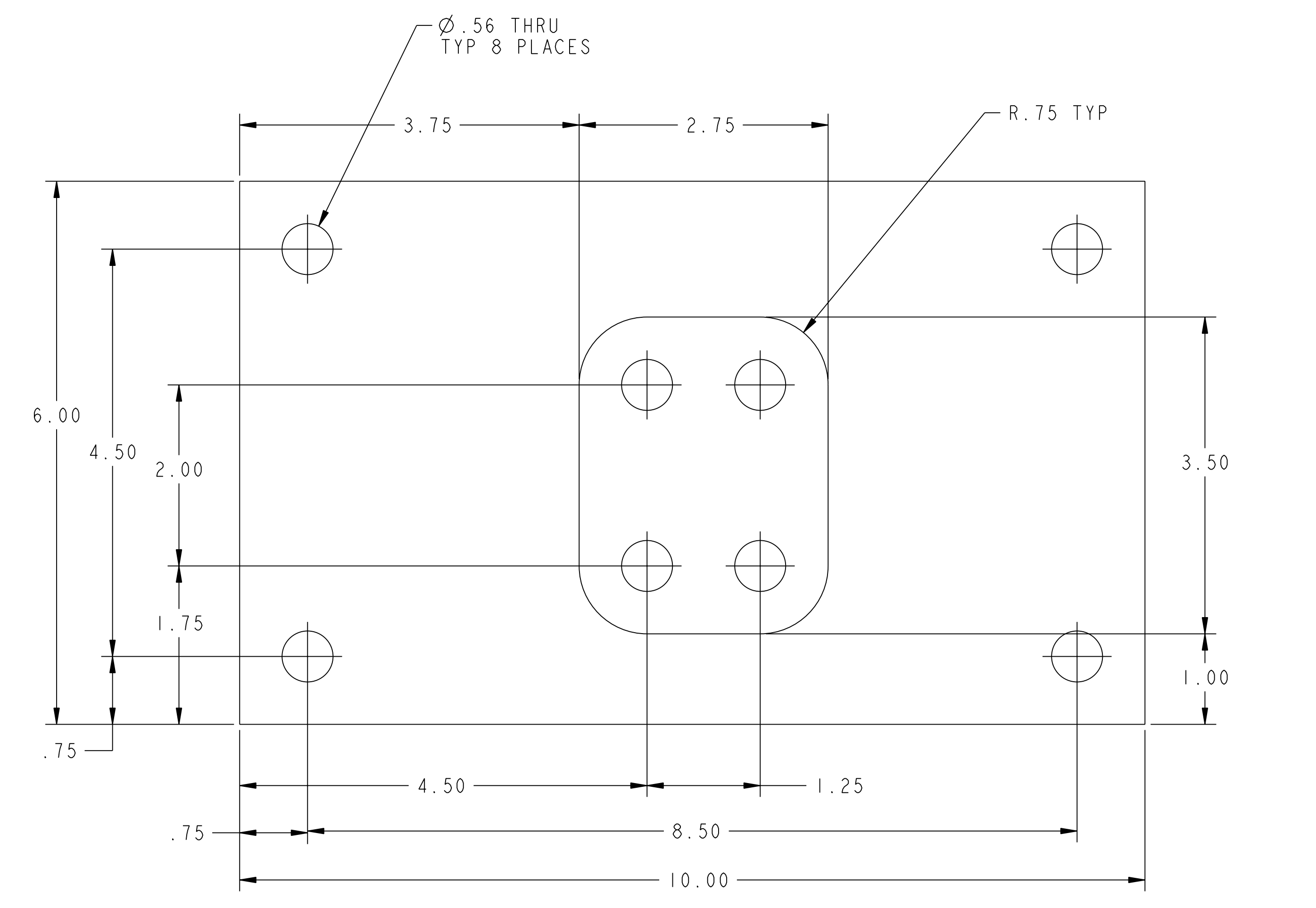

① BASE ADAPTER PLATE - TYPE A

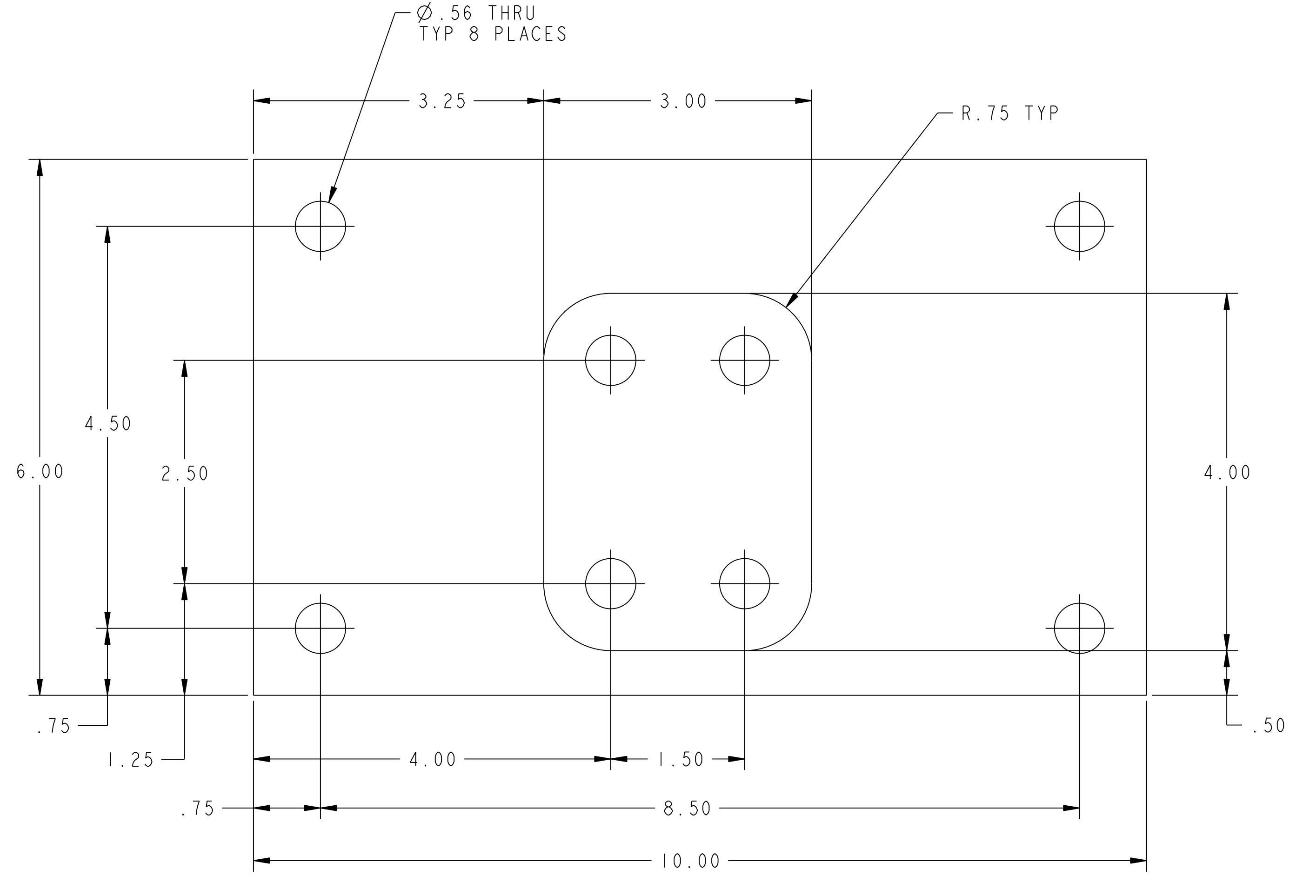

② BASE ADAPTER PLATE - TYPE B

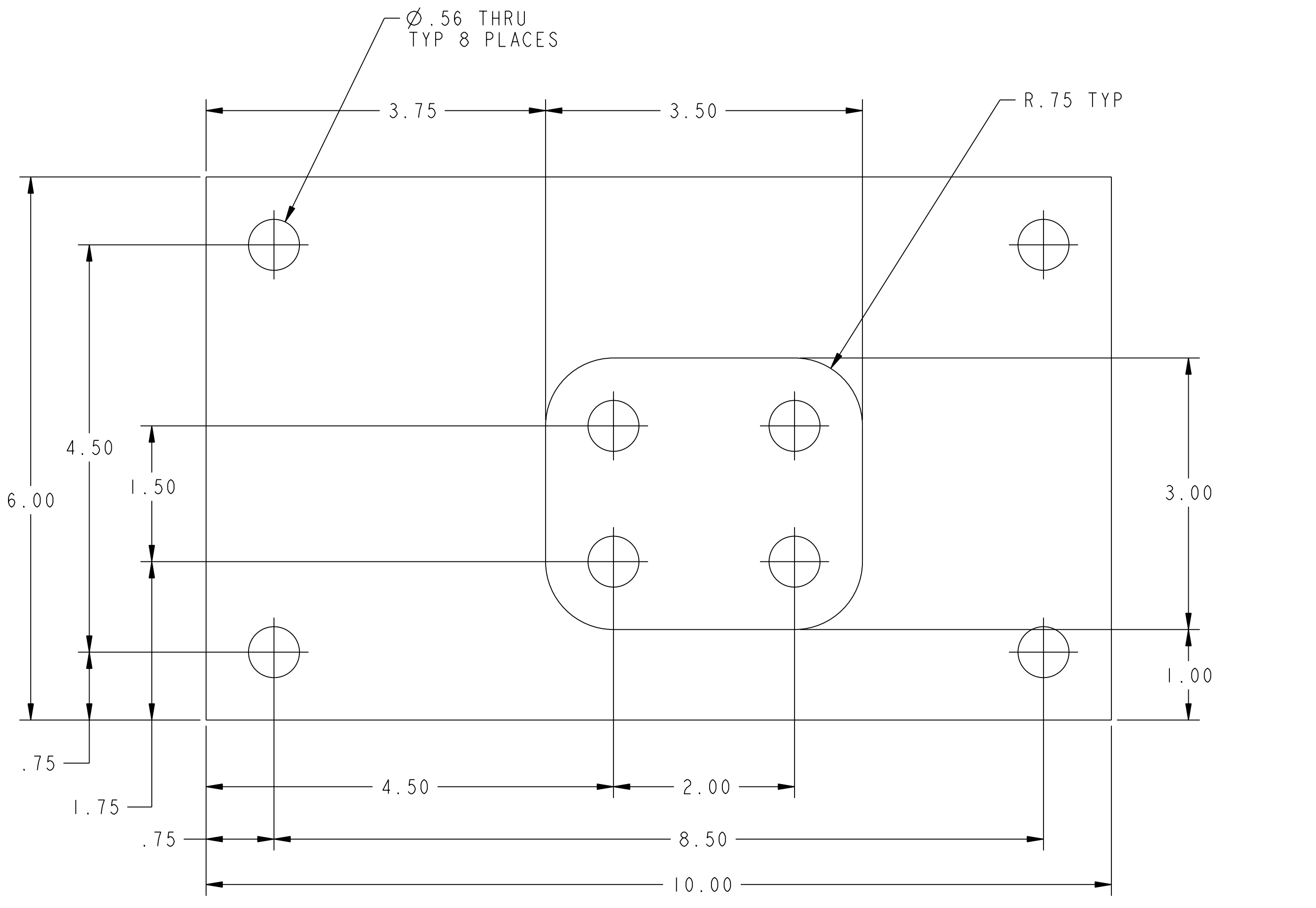

③ BASE ADAPTER PLATE - TYPE C

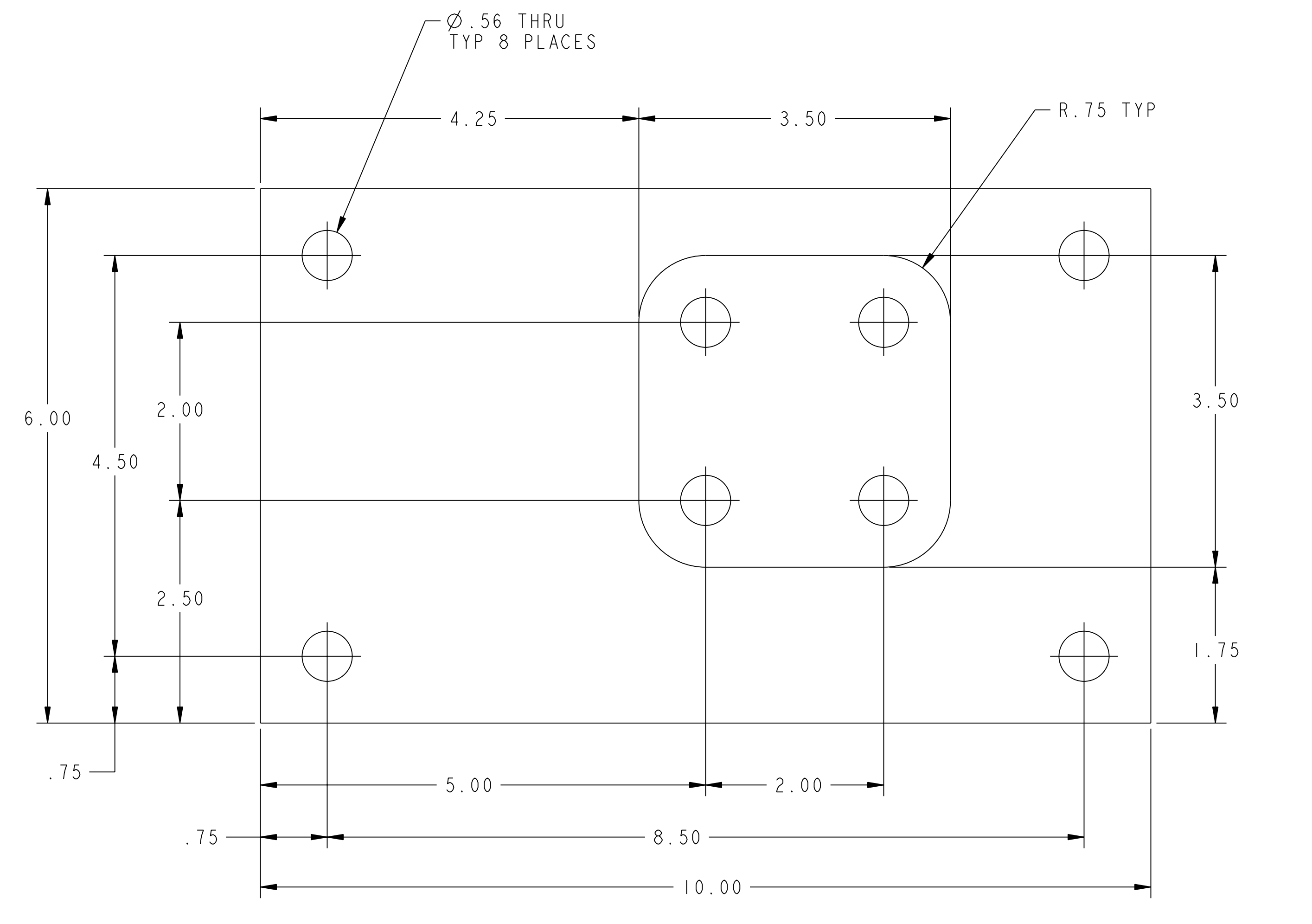

④ BASE ADAPTER PLATE - TYPE D

PART NO.	DRAWING NO	NOMENCLATURE OR DESCRIPTION	MATERIAL	QTY REQD
4	THIS DWG	BASE ADAPTER PLATE - TYPE D	ASTM A569	1
3	THIS DWG	BASE ADAPTER PLATE - TYPE C	ASTM A569	1
2	THIS DWG	BASE ADAPTER PLATE - TYPE B	ASTM A569	1
1	THIS DWG	BASE ADAPTER PLATE - TYPE A	ASTM A569	1

PARTS LIST

COMPUTER GENERATED DRAWING MANUAL CHANGES NOT PERMITTED Pro E	CENTRAL FILES: UNLESS OTHERWISE SPECIFIED	PRINCETON PLASMA PHYSICS LABORATORY PRINCETON UNIVERSITY <b>NATIONAL COMPACT STELLARATOR EXPERIMENT</b>	
DO NOT VERIFY INFORMATION BY SCALING DRAWING	DIMENSIONS ARE IN INCHES MACHINE SURFACES BREAK SHARP EDGES .005/.020	MODULAR COIL WINDING FACILITY TWISTED RACETRACK WINDING TWISTED RACETRACK BASE ADAPTER PLATES	
NEXT ASSEMBLY	TOLERANCES NON-CUMULATIVE DECIMAL-INCH FRACTIONS .XX ±.005 .XXX ±.005 ANGULAR ±.0°-15° OVER 120° ±.1°	DSN: L. MORRIS CHK: S. RAFTOPOULOS ENGR: J. CHRZANOWSKI SUPV: J. SIEGEL	DRAWING NO: <b>SE144-202</b> SHEET 1 OF 1 REV 0

WEIGHT 15.4 lbs
MODEL NAME SE144-202-1
WELDING ENGINEER

RELEASE LEVEL: Fabrication  
DWG VERSION NO:

NCSX-SE144-202

NCSX-PART-FORMAT.E