

| NO. | REVISION | BY | CH | SUP | APPROVED | DATE |
|-----|------------------------|-----|----|-----|-----------|----------|
| 1 | REVISED PER ECN # 5103 | JDR | MK | JS | M. KALISH | 04/07/06 |

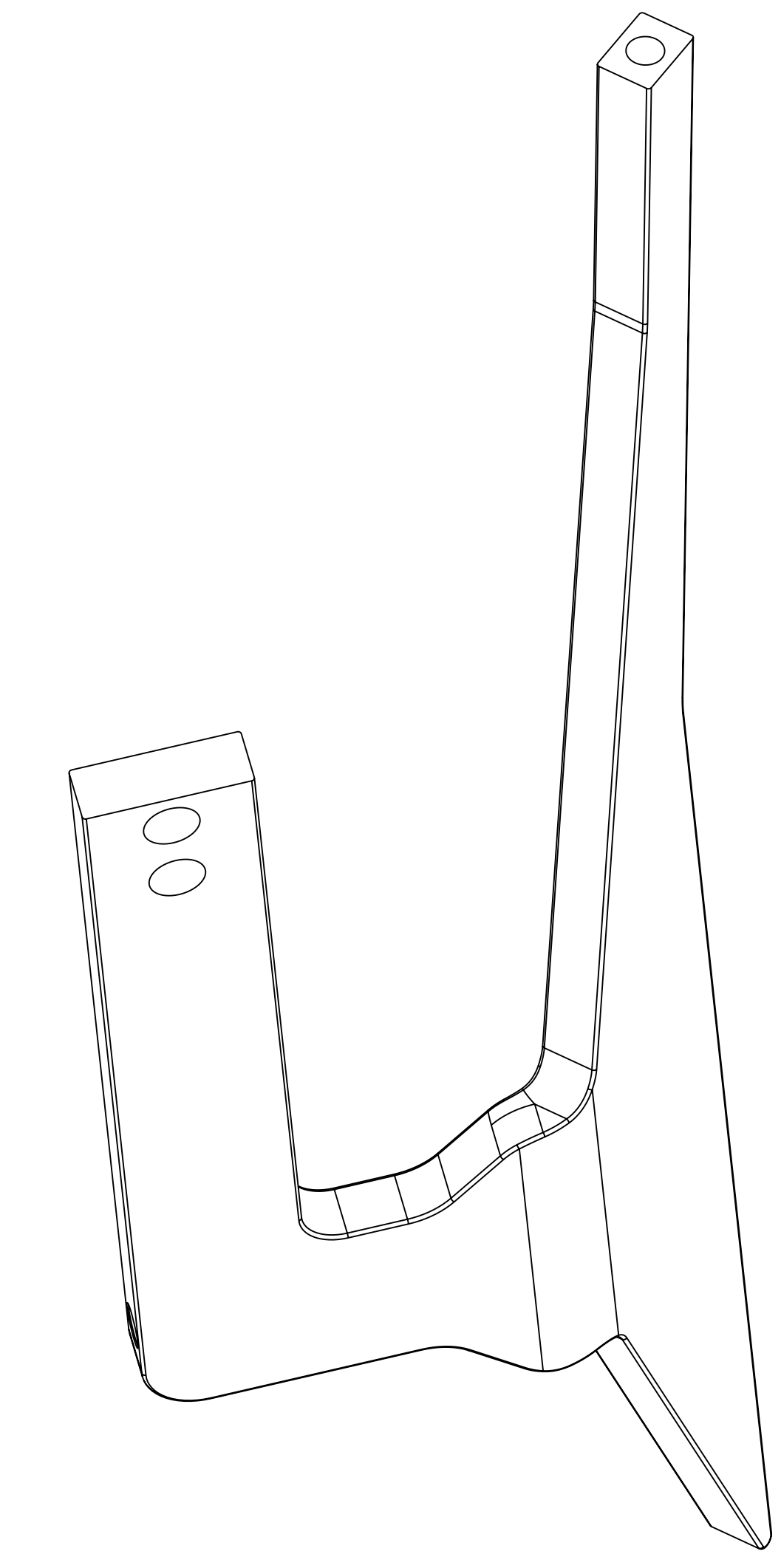
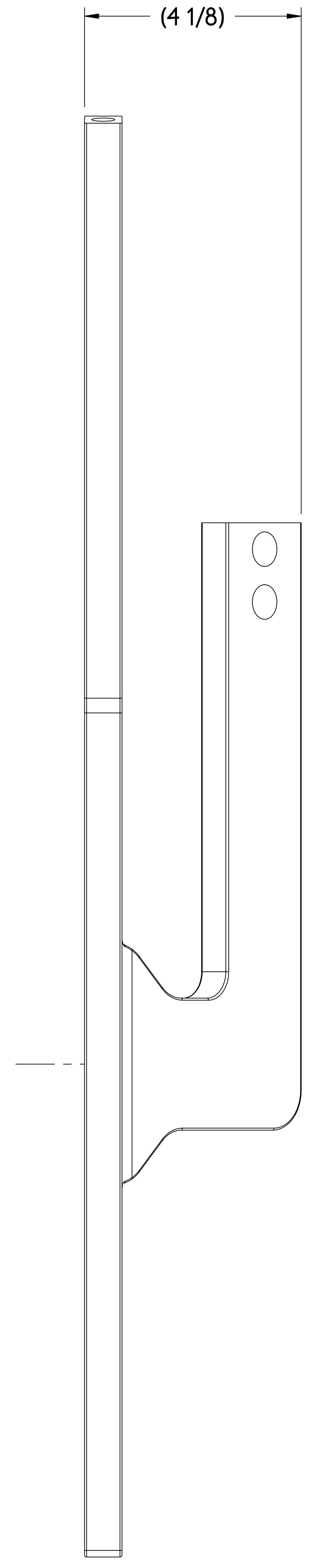
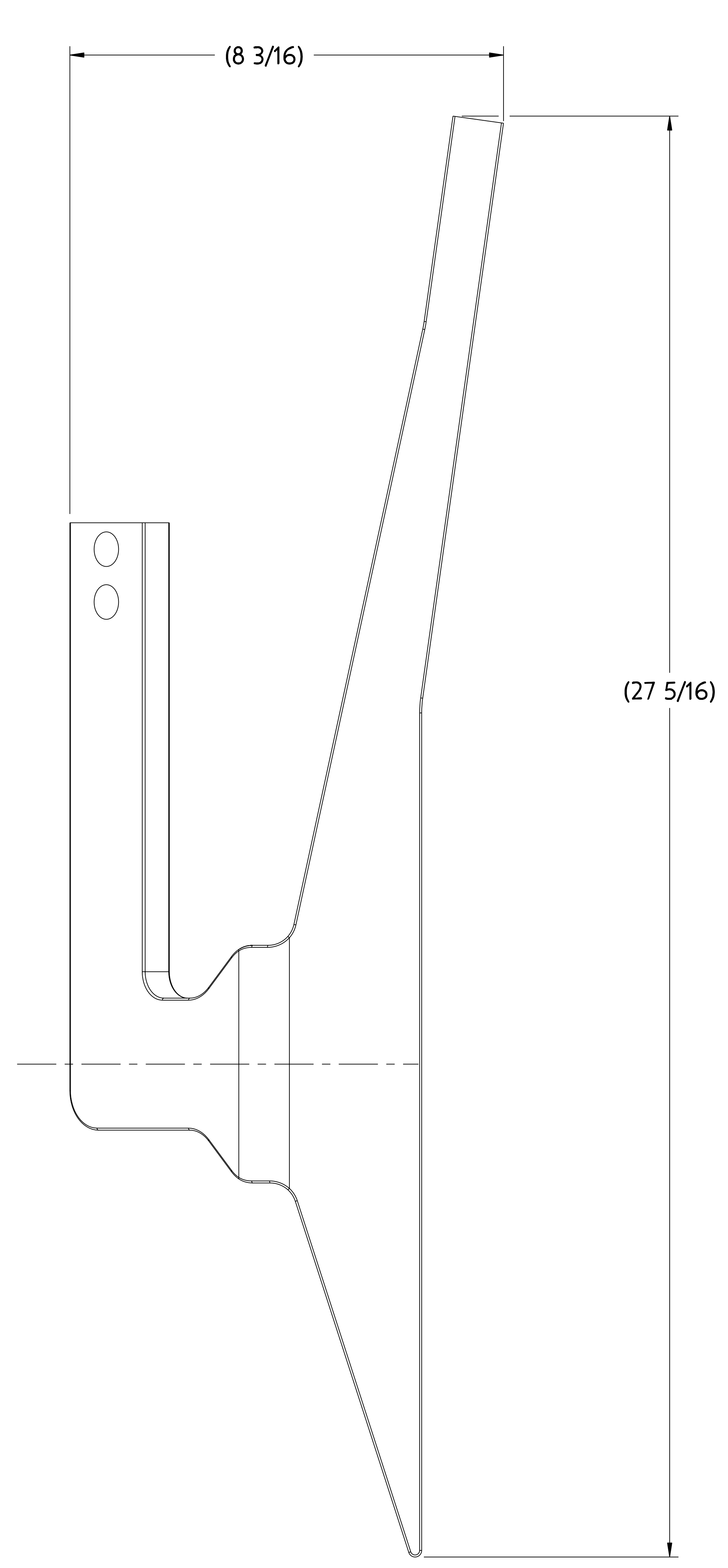
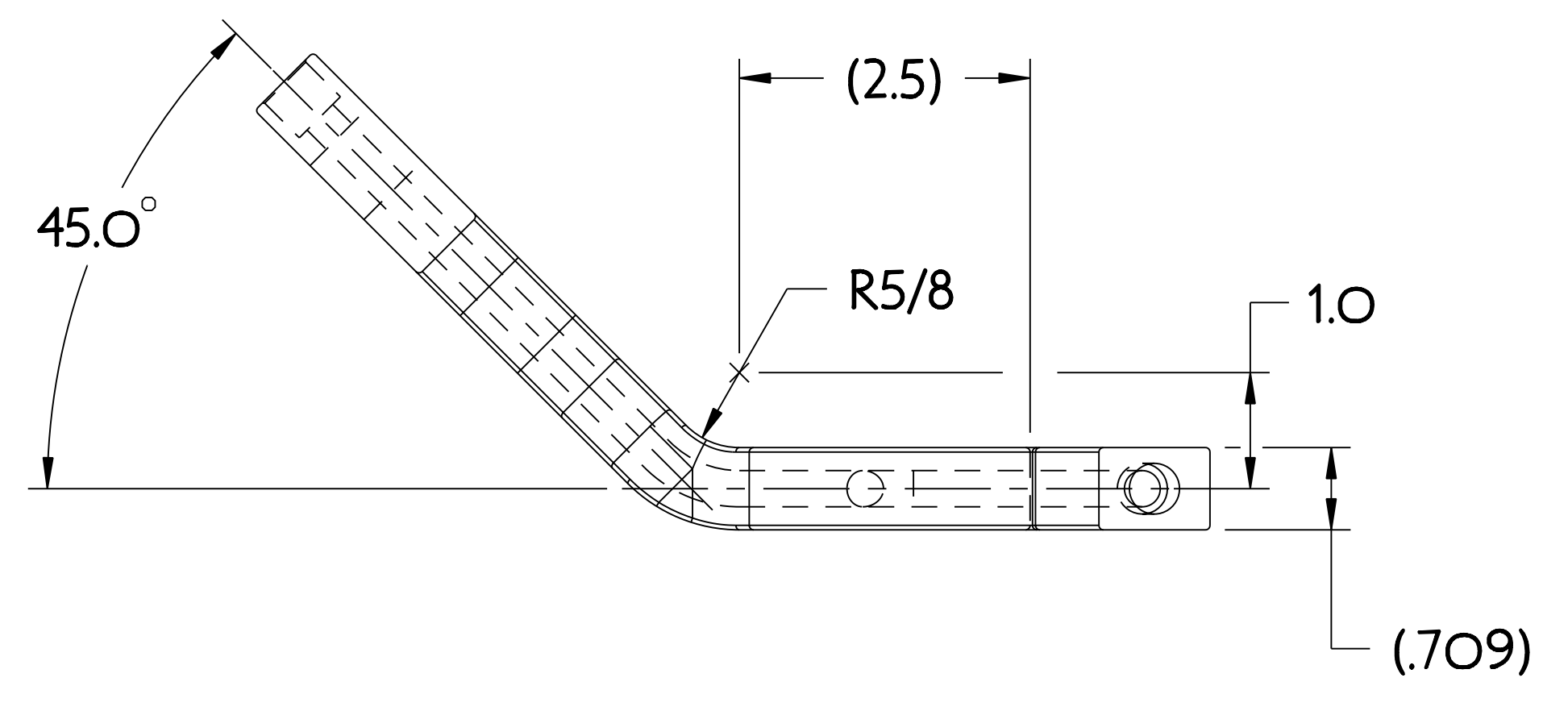

NOTE
BEND PART #SE131-081 AS SHOWN.

RELEASED FOR FABRICATION / INSTALLATION
PPPL Drafting:

RELEASE LEVEL: Fabrication
DWG VERSION NO:

| | |
|------------------|-----------|
| WEIGHT | 16.6 lbs |
| MODEL NAME | SE131-053 |
| WELDING ENGINEER | |

| PART NO. | DRAWING NO | NOMENCLATURE OR DESCRIPTION | MATERIAL | QTY | REOD |
|---|------------|---|---|---------|--------------------|
| 1 | SE131-053 | TF COIL LEAD LONG BENT RIGHT | SEE SPECIFICATION | | |
| PARTS LIST | | | | | |
| COMPUTER GENERATED DRAWING MANUAL CHANGES NOT PERMITTED Pro E | | CENTRAL FILES: UNLESS OTHERWISE SPECIFIED | PRINCETON PLASMA PHYSICS LABORATORY PRINCETON UNIVERSITY | | |
| DO NOT VERIFY INFORMATION BY SCALING DRAWING | | DIMENSIONS ARE IN INCHES MACHINE SURFACES BREAK SHARP EDGES .005/.020 | NATIONAL COMPACT STELLARATOR EXPERIMENT | | |
| SCALE 0.750 | | TOLERANCES NON-CUMULATIVE | DSN: J. RUSHINSKI | 2/01/06 | DRAWING NO: |
| NEXT ASSEMBLY | | DECIMAL-INCH FRACTIONS | CHK: M. KALISH | 2/01/06 | SE131-053 |
| | | .XX +/- .000 0"-.125" +/- .004 | ENGR: M. KALISH | 2/01/06 | |
| | | .XXX +/- .005 .125"-.125" +/- .004 | SUPV: J. SIEGEL | 2/01/06 | SHEET 1 OF 1 REV 1 |
| | | ANGULAR +/- .05 OVER .120" +/- .112 | | | |

NCSX-SE131-053