

NO.	REVISION	BY	CH	SUP	APPROVED	DATE
-----	----------	----	----	-----	----------	------

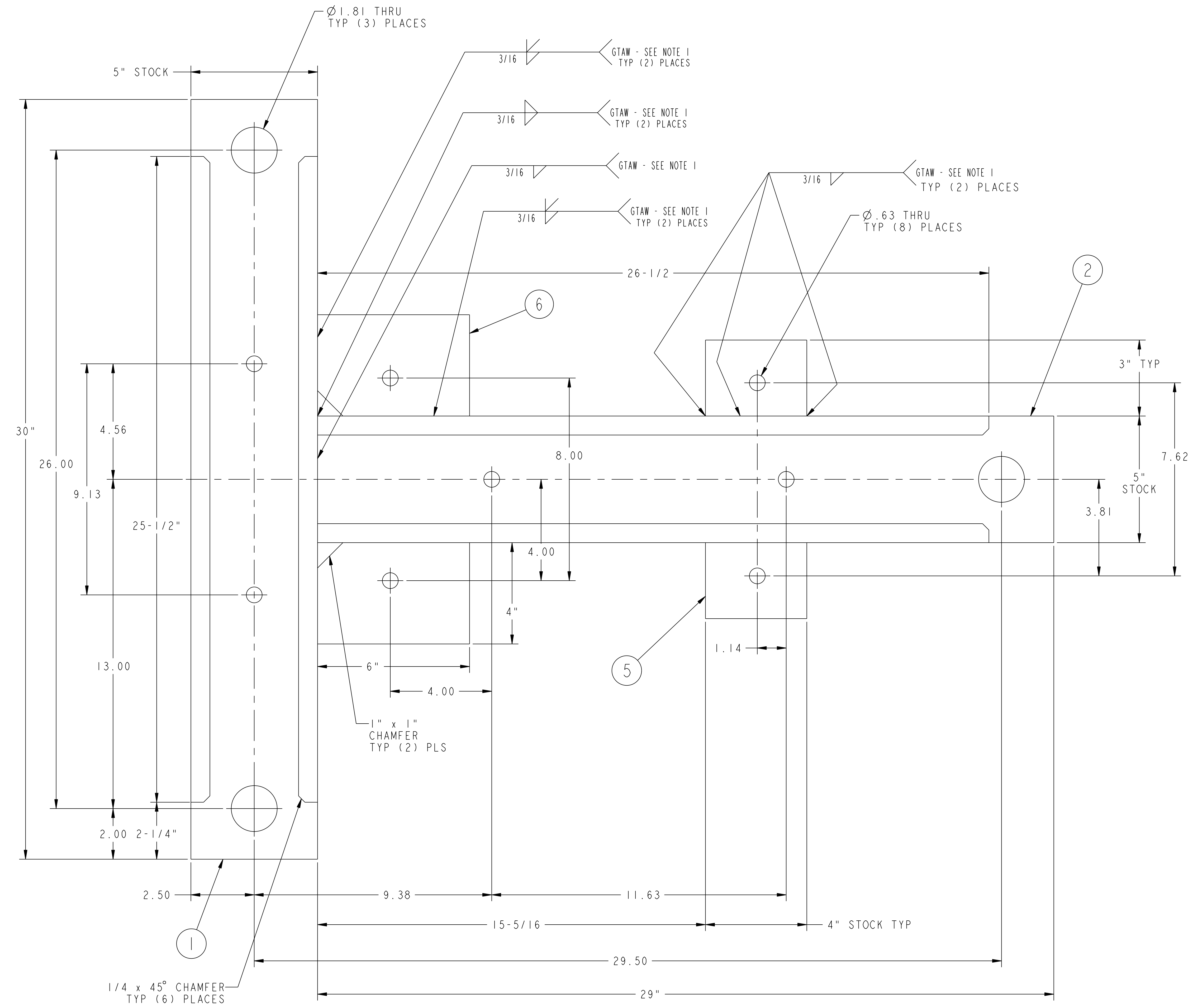

NOTES

1. WELDING SHALL BE PERFORMED IN ACCORDANCE WITH THE REQUIREMENTS OF AWS D1.1 OR PPPL PROCEDURE ENG-037. VISUAL WELD INSPECTION SHALL BE PERFORMED IN ACCORDANCE WITH THE ACCEPTANCE CRITERIA OF AWS D1.1 Section 6.
2. ALL HOLES TO BE MACHINED AFTER ALL WELDS ARE COMPLETE.

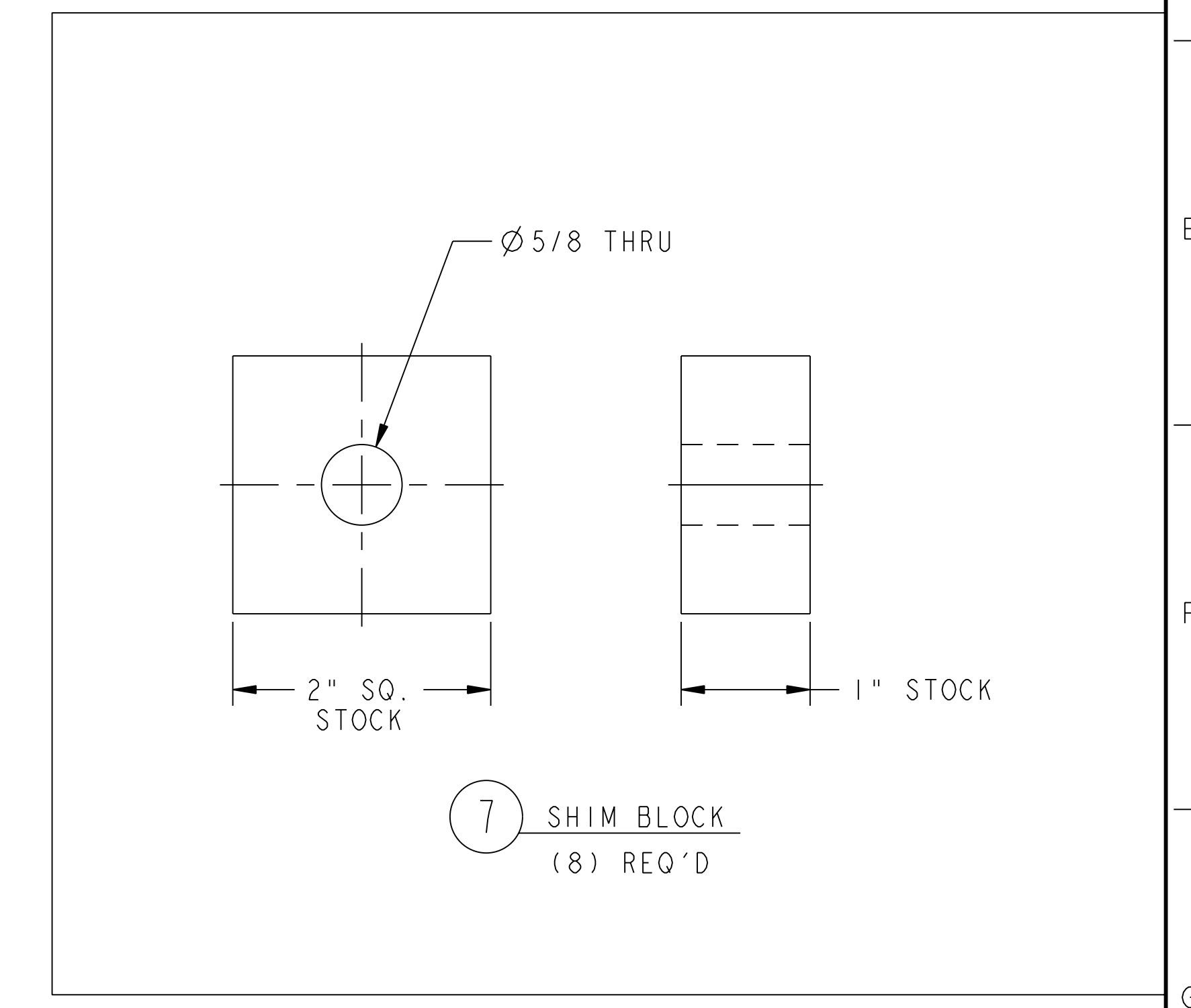

RFD-18-004 replaced either "GMAW or GTAW" welds with either "GMAW or FCAW" welds wherever appearing on this drawing. See RFD-18-004 for details)

RELEASED FOR FABRICATION / INSTALLATION
PPPL Drafting

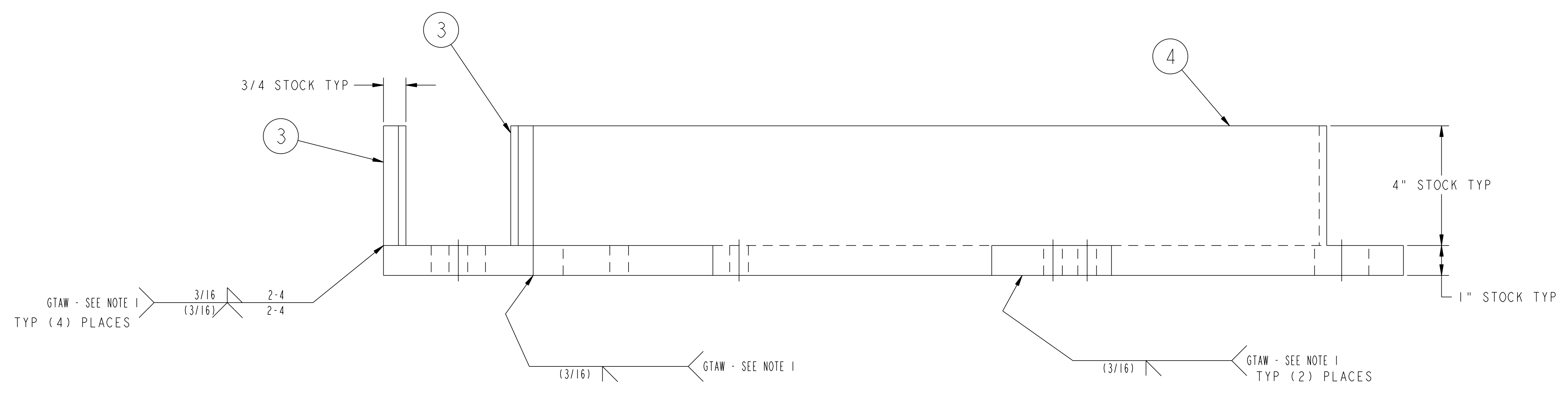

QTY	PART NO.	DRAWING NO.	NOMENCLATURE OR DESCRIPTION	MATERIAL	QTY REQD
—	7	THIS DWG	SHIM BLOCK	ASTM A36	8
2	6	THIS DWG	SUPPORT BLOCK	ASTM A36	—
2	5	THIS DWG	SUPPORT WING	ASTM A36	—
2	4	THIS DWG	REINFORCING BAR - LONG	ASTM A36	—
2	3	THIS DWG	REINFORCING BAR - SHORT	ASTM A36	—
1	2	THIS DWG	BASE BAR - LONG	ASTM A36	—
1	1	THIS DWG	BASE BAR - SHORT	ASTM A36	—
—	—	THIS DWG	SUPPORT "TEE" BAR WELDMNT	—	1

PARTS LIST

COMPUTER GENERATED DRAWING MANUAL CHANGES NOT PERMITTED Pro E	CENTRAL FILES: UNLESS OTHERWISE SPECIFIED DIMENSIONS ARE IN INCHES MACHINE SURFACES BREAK SHARP EDGES .005/.020	PRINCETON PLASMA PHYSICS LABORATORY PRINCETON UNIVERSITY NATIONAL COMPACT STELLARATOR EXPERIMENT FIELD PERIOD ASSEMBLY VACUUM VESSEL SUPPORT ASSEMBLY SUPPORT "TEE" BAR WELDMNT	
DO NOT VERIFY INFORMATION BY SCALING DRAWING	TOLERANCES NON-CUMULATIVE DECIMAL-INCH FRACTIONS .XX ±.010 0°-120° ±.010 .XX ±.030 120°-120° ±.010 .XXX ±.005 72°-120° ±.010 ANGULAR ±.0°-15° OVER 120° ±.1°	DSN: L. MORRIS 8-2-2007 CHK: M. COLE 8-2-2007 ENGR: T. BROWN 8-2-2007 SUPV: J. SIEGEL 8-2-2007	DRAWING NO: SE184-052 SHEET 1 OF 1 REV 0

RELEASE LEVEL: Fabrication
DWG VERSION NO: 11

WEIGHT
194.7 lbs

MODEL NAME
SE184-052-01

WELDING ENGINEER
G. GETTELFINGER 8-2-2007